

Smart^{Wi} Floodlight Security Camera

1080P Full-HD

100%
WIRE-FREE



Quick Start Guide

* Thanks for purchasing and using our product. Please read this quick start guide before using, and keep it for future reference.

* Manual contents are subject to change without notice in accordance with our policy of continuous product improvement.



Installation guide

1. Please consult below checklist for all the components.



Floodlight Camera

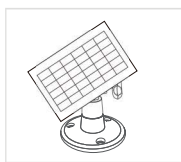

Solar Panel

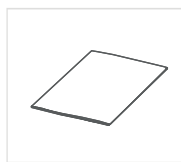

User Guide

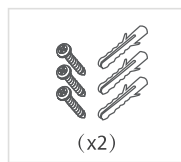

(x2)

Screw & Tools

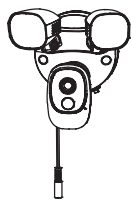

[01]x1



[02]x1



[03]x2



[04]x2



[05]x6



[06]x4

01

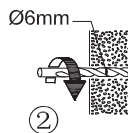
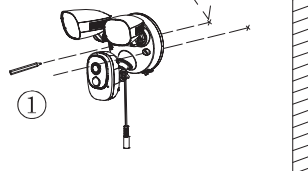
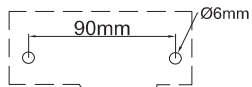

②

[05]



③

02

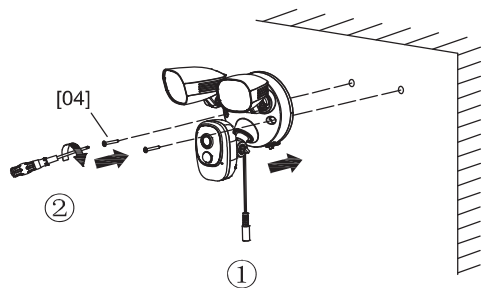

03

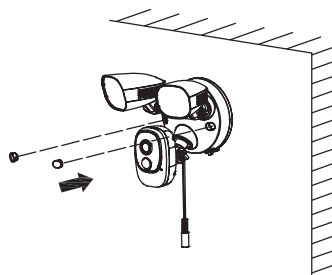

04

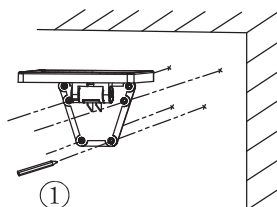

05

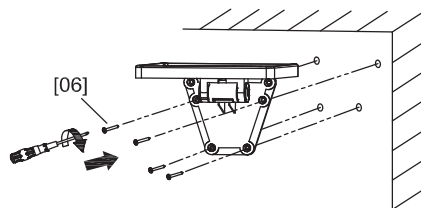

06

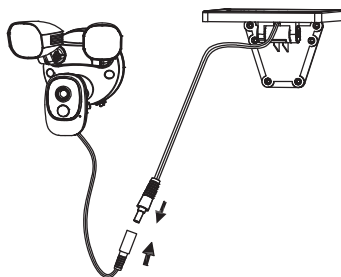
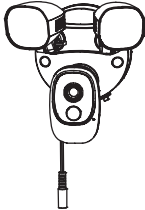
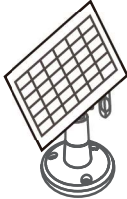
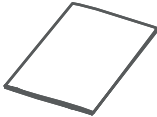
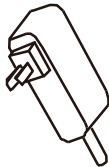



TABLE OF CONTENTS

What's in the box	1
Camera Structure Diagram	1
Battery charging	2
Download APP	2
Wi-Fi set up	2
Run a test	3
Live View Interface	4
Smart history palayback-Micro SD Card	5
Menu settings	6
Frequently asked questions	7

1. WHAT'S IN THE BOX

Please check the box for each of the following items before installing your cloud camera:

				
Floodlight Camera	Solar Panel	User Guide	Power Adapter (Optional)	Screw & Tools

2. CAMERA STRUCTURE DIAGRAM

English

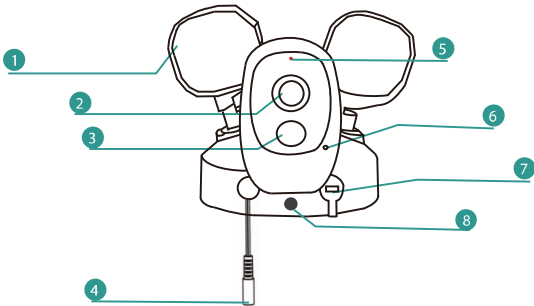

7 12V 2A Port DC 5.5*2.1MM	8 On/Off Button
9 SD Card Slot	10 Reset Button

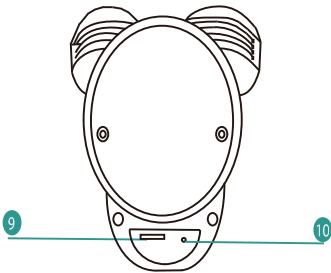

3. BATTERY CHARGING

- 1.)The batteries inside the Battery camera not fully charged in accordance with transportation safety regulations.
- 2.)Please make sure install the battery solar powered floodlight camera during the day under the sunshine for charging first.
- 3.)The built-in rechargeable battery and solar panel provide non-stop power once installed . It can also use 12V 2A power adapter to charge about 8-10 hours prior to installation.

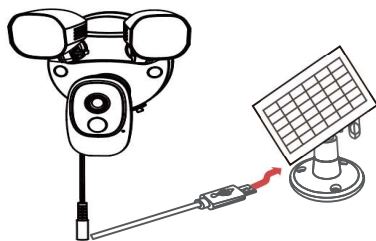

4. DOWNLOAD APP

- 1.)Download and install the '[CloudEdge](#)' app from Google PlayTM or the App StoreTM.
- 2.)The App is also available by scanning the QR code down below, using your QR code scanner in your smart phone.

NOTE: Google PlayTM is a trademark

of Google Inc. App StoreTM is a service mark of Apple Inc.

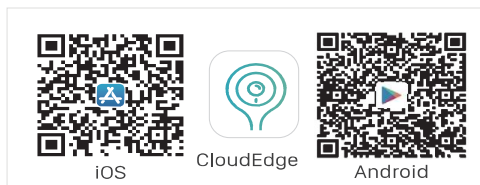

5. Wi-Fi SET UP

Before you start the Wi-Fi configuration, please note below:

- 1). The Battery camera works with 2.4 GHz Wi-Fi, but not with 5 GHz Wi-Fi.
- 2). Avoid using special characters or symbols like)(@~!#\$%^&*..., either in your Wi-Fi name or password.
- 3). Perform the configuration near your Wi-Fi router.

3.1.)Press the On/Off button (8), the LEDS(1) will on, wait until LED indicator light(5) blink and open app to add the camera.

Note: If the indicator light(5) not blink, Please hold the Reset button(10) for 5 seconds until you see the indicator light(5) blink red light.

Then Open APP follow these steps in the app to add it to network.

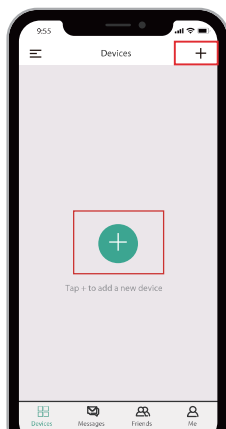

1. Tap "+" to add device

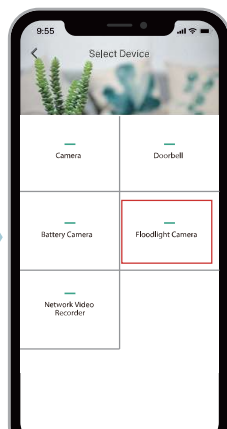

2. Select "Floodlight Camera"

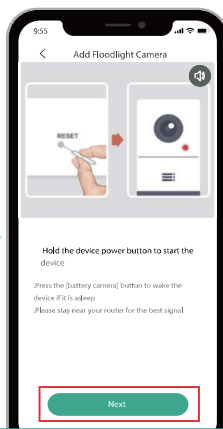

3. Camera On ,then click "Next"

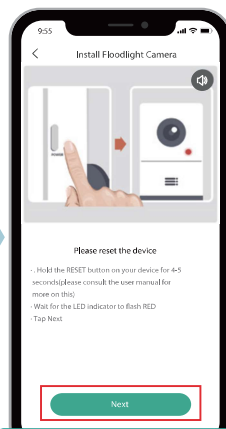

4. Reset if light not blink

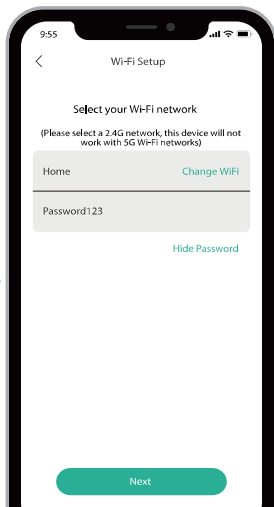

5. Input Wi-Fi Password

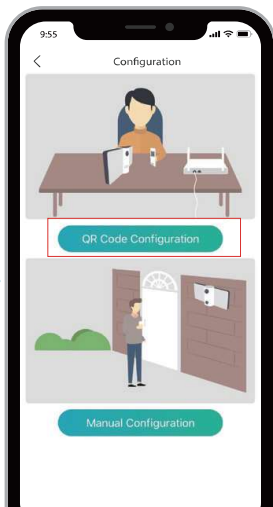

6. QR Code Configuration



7. Scan the QR code

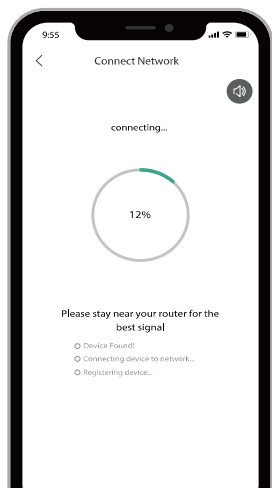

8. Wait for connection

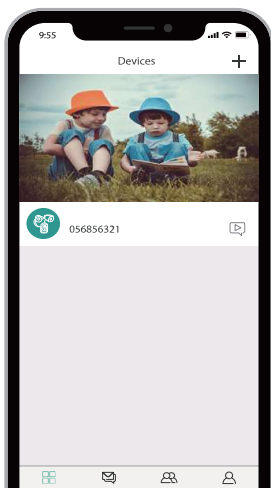

9. Adding camera complete

6. BATTERY CHARGING

After setup, tap on the live view window in the app for a test. Then take your cloud camera to the installation spot and run a test there. Make sure the installation spot is covered by strong 2.4 GHz WiFi signal.

Note:

if the video quality from the cloud camera outside is not as good as it was indoors, you may need to move your router closer to your installation spot, or use a WiFi extender.

7.LIVE VIEW INTERFACE

- 1

Quit Live View
- 2

Settings Menu
- 3

Battery Status
- 4

Volume On/Off
- 5

HD/SD Switch
- 6

Full Screen Display
- 7

Stream Bit Rate
- 8

Wi-Fi Signal Status
- 9

Make a Screenshot
- 10

Speak to the Vistor
- 11

Start Recording
- 12

Human Detection On/Off

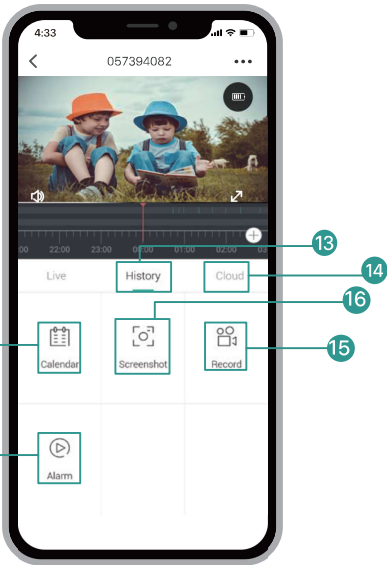
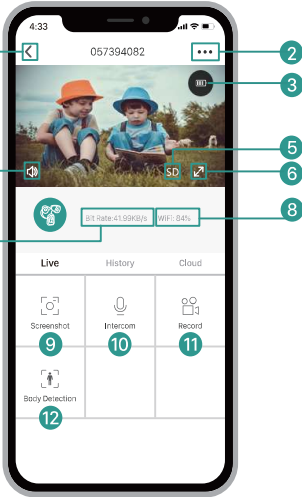

- 13

Notification History
- 14

Cloud
- 15

Local Recording
- 16

Make a Screenshot
- 17

View Recording History
- 18

View Alarm History

8. Smart Playback and Multi-View Function

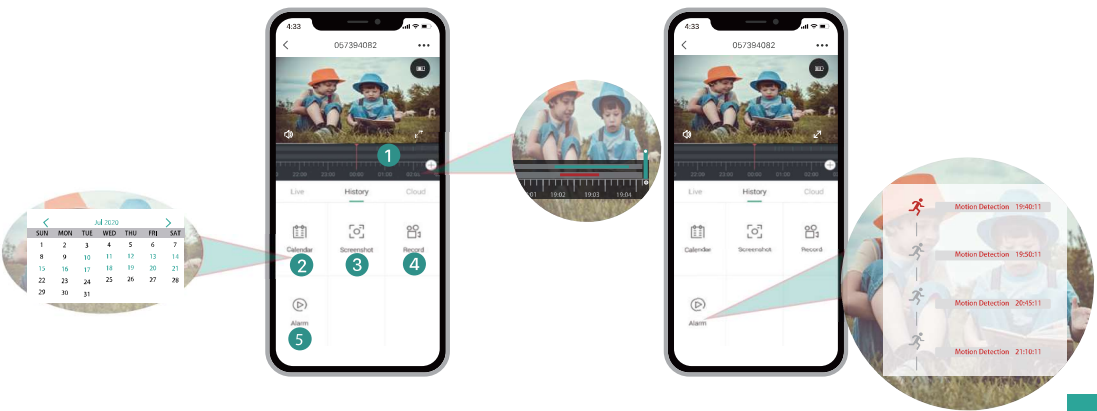

1 Time Line

Drag the time line to left or right to check the recorded video

– The green bar means recorded video length;The red bard means alarm recorded length

2 Calendar

Check video distory by dates, the gree number means motion detected

3 Screenshot

Tap to capture a photo and save to [Me->Pictures & Videos](#)

4 Record

Tap to record local video and save to [Me->Pictures & Videos](#)

5 Alarm

Check motion detection recored video easily by time

6 Cloud

Note:Cloud history playback is the same as SD Card. When subscribe Cloud Storage service, SD Card functions stop

Cloud Storage Subscription Cost				
Storage Day	Alert Recording		7/24 Days Recording	
	Monthly	Yearly	Monthly	Yearly
3 Days	\$2.99	\$30.00	\$3.99	\$40.00
7 Days	\$4.99	\$50.00	\$6.99	\$70.00
30 Days	\$15.99	\$160.00	\$21.99	\$220.00

9. MENU SETTINGS

1

2

3

4

5

6

7

8

9

10

11

Settings

15710787206

Device Name

FC1 Floodlight Cam

Receive Notifications

Device Share

Device Information

Basic Function

Alarm Setting

SD Card

Cloud Server

Device Version

Delete Device

1

2

3

4

5

6

7

8

9

10

11

1 Back to Live View Interface

2 Edit Device Name

3 Enable Alarm Notifications

4 Device Share--Share No Limitation

5 Device Basic Information

6 Basic Function

7 Alarm Setting

8 SD Card Information

9 Cloud Storage Subscription

10 Check latest firmware version and OTA

11 Delete product

Motion Detection Setting

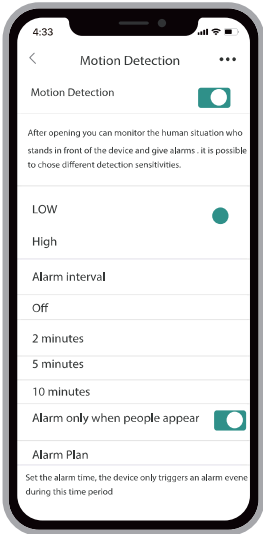

Basic Function

- 1.Status Light--Turn On/Off LED indicator
- 2.Rotate View--Turn the live view upside down

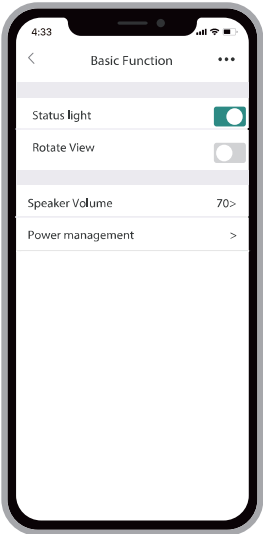

SD Card Setting

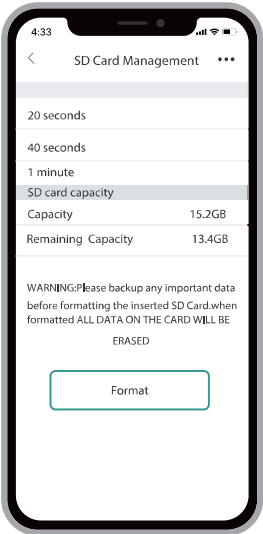

10.FREQUENTLY ASKED QUESTIONS

Q1: I cannot set up the cloud camera to my WiFi network?

A1: ①. Device works with 2.4GHz WiFi only, but not support 5GHz WiFi. ② WiFi signal is not strong enough, try to keep the cloud camera near the WiFi router when setting up. ③. The WiFi password is wrong. Please check if there are special characters in the password, or the network is specially encrypted.

Q2: How do I know if I have 2.4G or 5G WiFi?

A2: Please check the user manual of your Router or call the network operator for help.

Q3: Can I only view my cloud camera when I am on the same WiFi network, or can I view it over internet from anywhere?

A3: You can view the cloud camera from anywhere, as long as your cloud camera is connected to the internet and you have internet connection on your smart device.

Q4: Do any of the recordings get saved to the cloud? Or is it mainly saved in the built-in SD card?

A4: It supports SD card recording as well as cloud storage. You can activate the cloud storage service in app.

Q5: What happens when the SD card is full?

A5: When the memory card is full, the cloud camera automatically erases the oldest footage.

Q6: Does it work with Google Home or Alexa?

A6: This model does not support Google Home or Alexa.

Q7: Why does it lose connection to WiFi?

A7: Please check the network connection of your smart device and the WiFi router. If the network signal is not strong enough, you may need to move your router closer to the device, or use an extender.

Q8: Can motion detection be disabled?

A8: Yes. Recording is triggered by detected motions. You can adjust the sensitivity or disable motion detection in the setting menu.

Q9: Can I use 2 or more cloud camera's in the same house?

A9: Yes. You can add more than one device at the same house.

Q10: How can I share this product?

A10: The person you shared must register an account. After that there are two way to share the cammera: Method 1: Scan the QR Cord ; Method 2 : Input the person you shared APP account.

Q11: What's the capacity of the Battery? Is it the solar panel include?

It is built-in 4x 18650 batteries with 12000mAh capacity and solar panel included for charging. Once installed, do not worry about battery out of.

Q12: What's the view angle of this camera?

A12: This camera wide angle view is 120 degree

Q13: How long is my cloud camera covered under warranty?

A13: We provide a 12-month warranty on all our products after purchase (with some exceptions).

Unfortunately we cannot treat products that have become defective due to incorrect use, fall damage, water damage, etc.

11.FCC Statement

This device complies with part 15 of the FCC rules. Operation is subject to the following two conditions: (1) this device may not cause harmful interference, and (2) this device must accept any interference received, including interference that may cause undesired operation.

Changes or modifications not expressly approved by the party responsible for compliance could void the user's authority to operate the equipment.

NOTE: This equipment has been tested and found to comply with the limits for a Class B digital device, pursuant to part 15 of the FCC Rules. These limits are designed to provide reasonable protection against harmful interference in a residential installation. This equipment generates uses and can radiate radio frequency energy and, if not installed and used in accordance with the instructions, may cause harmful interference to radio communications. However, there is no guarantee that interference will not occur in a particular installation. If this equipment does cause harmful interference to radio or television reception, which can be determined by turning the equipment off and on, the user is encouraged to try to correct the interference by one or more of the following measures:

- Reorient or relocate the receiving antenna.
- Increase the separation between the equipment and receiver.
- Connect the equipment into an outlet on a circuit different from that to which the receiver is connected.
- Consult the dealer or an experienced radio/TV technician for help.

Radiation Exposure Statement

This equipment complies with FCC radiation exposure limits set forth for an uncontrolled environment. This equipment should be installed and operated with minimum distance 20cm between the radiator and your body.