



MONUMENT PELLET GRILL

USE AND CARE MANUAL

S1251801T



Please read this entire manual before installation and use of this pellet fuel-burning appliance.

Failure to follow these instructions could result in property damage, bodily injury or even death.

Contact local building or fire officials about restrictions and installation inspection requirements in your area.

Save these instructions.

THIS Pellet Grill IS DESIGNED FOR OUTDOOR USE ONLY

SAVE THESE INSTRUCTIONS FOR FUTURE REFERENCE



WWW.MONUMENTGRILLS.COM

Guide directory

1. Safety warning	page 3-4
2. Certification sticker	Page 5
3. Exploded View	Page 6
4. Single part list	Page 7
5. Fixing elements	Page 7
6. Mounting steps	Page 7--18
7. Use of smoked stove	Page 19-20
8. Button function description	Page 21-23
9. Troubleshooting common faults	Page 23

1.Safety warning

※Please read the entire manual carefully before assembling and using the smoker, and install and use it as required. The company will not be responsible for property damage, personal injury or even death caused by failure to follow the instructions.

※About carbon monoxide poisoning: All cooking ovens or cooking utensils produce organic gases (such as carbon monoxide) when burning materials (such as wood, gas or charcoal). Carbon monoxide can impair the ability of the blood to deliver oxygen, which can lead to loss of consciousness or death. If you have headaches, dizziness, weakness, nausea, vomiting, nasal congestion, lethargy or confusion in your use, please seek medical advice.

※Be sure to use the device in an open area outside and away from inflammable and explosive materials (minimum 40 inches).

※ This equipment is equipped with an ignition system. Do not use gasoline, gasoline fuel, kerosene, barbecue charcoal or special ignition liquid to ignite.

※Please use the grounding socket that meets the local safety regulations. If you need to reinstall the socket, please follow the local electrical code.

※ Dangerous voltage can cause shock, burns or death. In case of equipment failure, please follow the instructions or contact the local after-sales personnel for maintenance. Please cut off the power before maintenance.

※ During the use of the device, there is a high temperature in the local position. Do not move the device at will, and pay attention to the elderly and children. Beware of burns.

※Please clean up the remaining fuel after each use, because the fuel may expand and clogging the feeding mechanism.

※Please use the wood pellets for the smoker to ensure that the particle diameter is not more than 0.3 inches and the length is not more than 1.2 inches. If the particles are too large, the equipment may be extinguished due to poor feeding.

※FCC Part 15

NOTE: This equipment has been tested and found to comply with the limits for a Class B digital device, pursuant to Part 15 of the Federal Communications Commission (FCC) rules. These limits are designed to provide reasonable protection against harmful interference in a residential installation. This equipment generates, uses and can radiate radio frequency energy and, if not installed and used in accordance with the instructions, may cause harmful interference to radio communications. However, there is no guarantee that interference will not occur in a particular installation. If this equipment does cause harmful interference to radio or television reception, which can be determined by turning the equipment off and on, the user is encouraged to try to correct the interference by one or more of the following measures:

- Reorient or relocate the receiving antenna.
- Increase the separation between the equipment and receiver.

- Connect the equipment into an outlet on a circuit different from that to which the receiver is connected.
- Consult the dealer or an experienced radio/TV technician for help.

This device complies with Part 15 of the FCC rules. Operation is subject to the following two conditions: (1) this device may not cause harmful interference, and (2) this device must accept any interference received, including interference that may cause undesired operation.

WARNING: Changes or modifications, to this equipment not expressly approved by the party responsible for compliance could void the user's authority to operate the equipment.

FCC RF Radiation Exposure Statement

Caution: This Transmitter must be installed to provide separation distance of at least 20cm from all persons.

2. Certification label

 5012274		MONUMENT	
		Product name	Pellet Grill
		Model Number	S1251801T
		Serial Number	XXXXXX
Certified to UL SUBJECT 2728		Fuel input rating	1.98lb/H
Certified to ULC/ORD-C2728		Electrical Rate	120V/60Hz/0.25 kW
Refer to Intertek's Directory of Building Products for detailed information			
If Fire Occurs: Call Fire Department Do Not Try To Move Appliance, Try To Smother Fire, Or Put Water On The Fire Keep The Appliance Clean – See Instruction Manual For Cleaning And Proper Operation			
Minimum clearance from side and back of unit to combustible construction: 23.6" (600mm) from sides and 39.4" (1000mm) from back. Suitable for installation on combustible floors.			
CAUTION Improper Use Can Cause Uncontrolled Fire. To Reduce Fire Risk This Appliance Is Intended To Burn (Less than 0.3 inches in diameter ; Length <1.2 inches) pellets Fuel Only. Designation Operate Only Per Manufacturers Instructions Never Use Gasoline Or Lighter Fluid Always Store Wood Pellets Away From Heat-Producing Appliances And Other Fuel Containers			
Use Outdoors Only			
Read the instructions before using the appliance.			
Warning : Accessible parts may be very hot. Keep young children away.			
factory	Monument Grill LLC	address	3 Atlantic Street, Plainsboro, NJ 08536, United States
Contact information	1-800-913-8999		
Made in China			

3. Exploded View

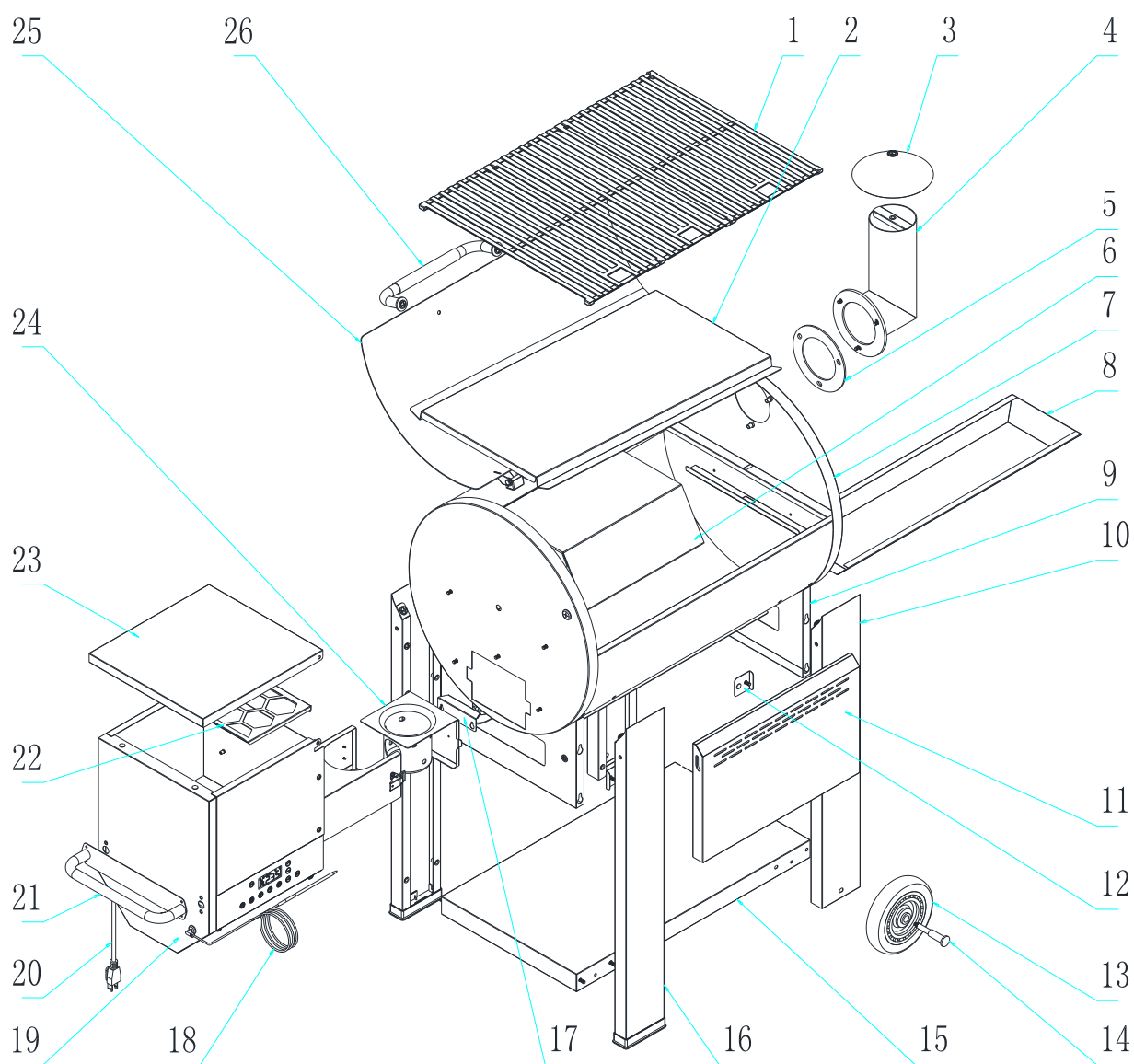

4. Single part list

Seq. NO.	Appellation	Qty	Seq. NO.	Appellation	Qty
1	Cast iron grill	3	16	Long legs	2
2	Oil guide plate	1	17	Burning chamber handle	1
3	Chimney cover assembly	1	18	Barbecue probe	1
4	Chimney assembly	1	19	Control box assembly	1
5	Chimney insulation cotton	1	20	power cable	1
6	Fire board	1	21	Control box handle assembly	1
7	Furnace assembly	1	22	Control box screen	1
8	Ash tray	1	23	Control box cover	1
9	Frame support plate	2	24	Combustion chamber assembly	1
10	Short leg	2	25	Cover panel	1
11	Shelf	1	26	Upper cover handle assembly	1
12	Shelf cover	2			
13	6 inch transparent wheel	2			
14	axle	2			
15	Body floor	1			

5. Fixing elements

A	B	C	D
 x36	 x4	 x15	 x4

6. Mounting steps

Make sure your grill is assembled properly. Detailed assembly instructions are packed with each grill giving specific assembly procedures for each model. Follow these instructions carefully to ensure the correct and safe assembly of the grill.

Caution: Although we take every effort to ensure that the assembly process is as easy as possible, it is inherent with fabricated steel parts that corners and edged can cause cuts if improperly handled during assembly procedures. Be careful while handling any parts during assembly. It is strongly recommended that you protect hands with a pair of work gloves.

STEP 1

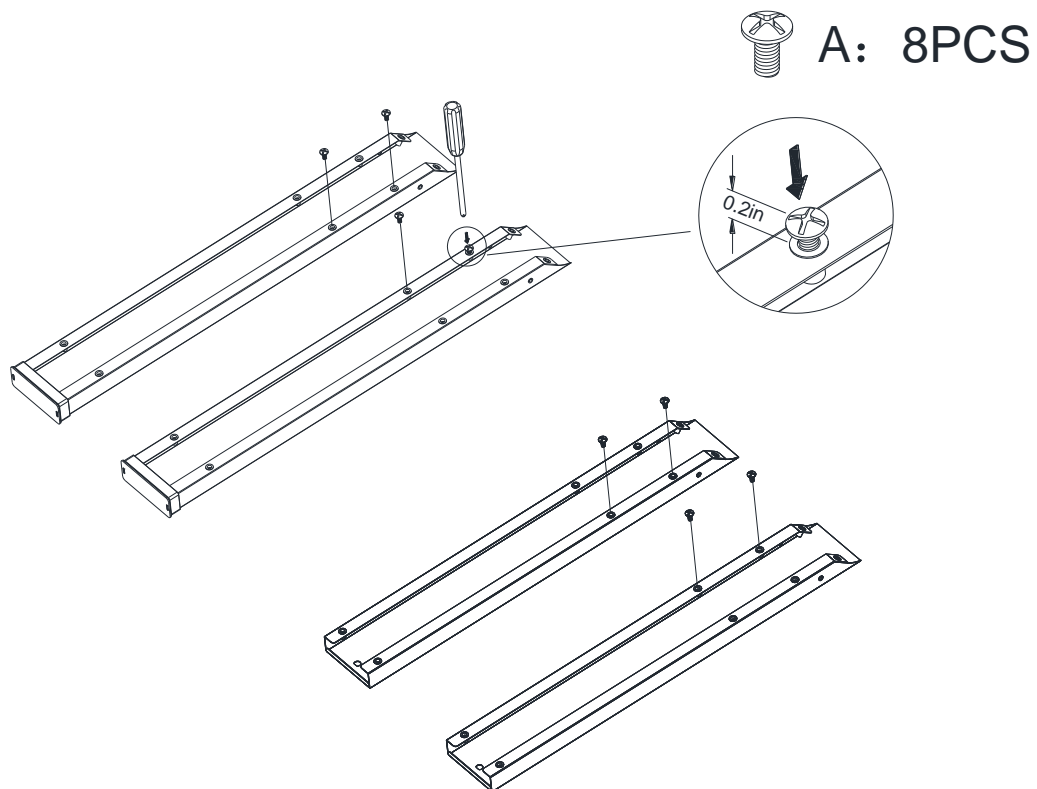

STEP 2

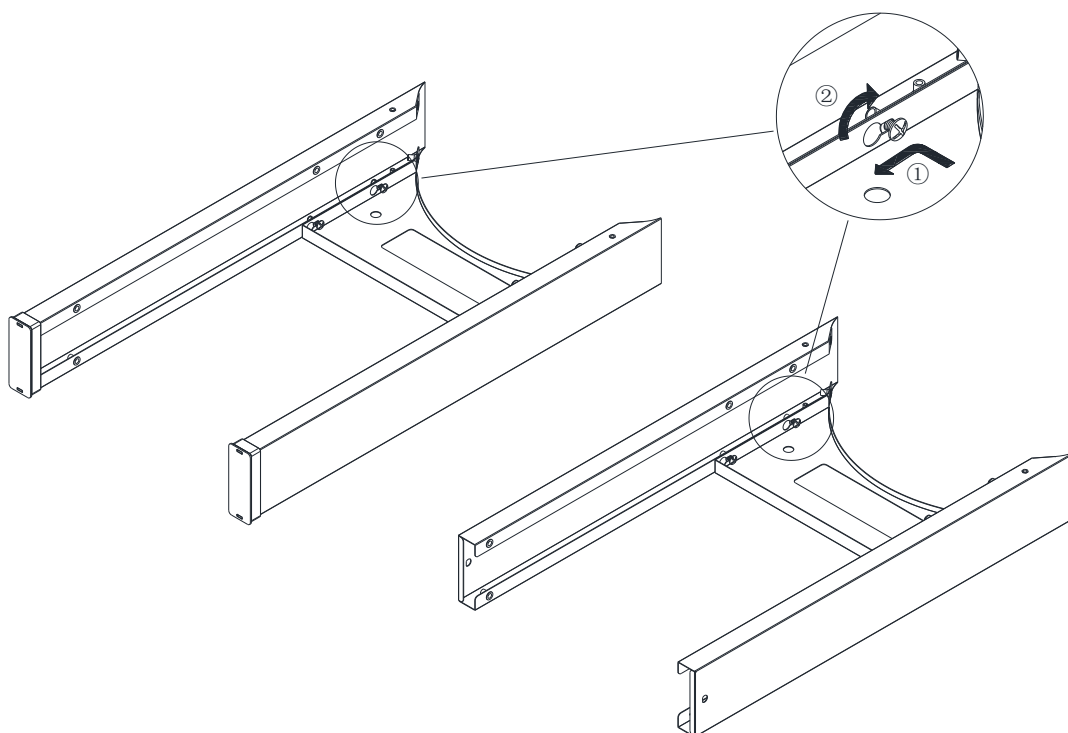

STEP 3



A: 4PCS

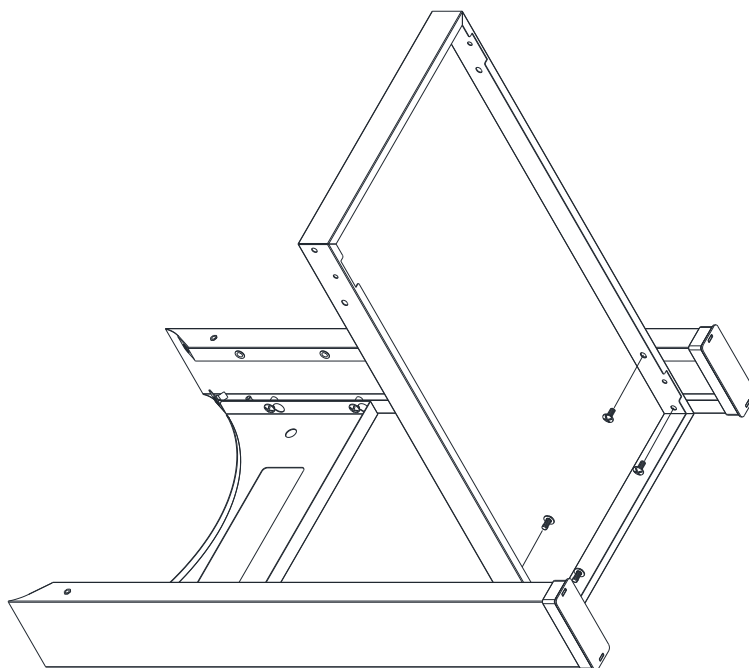

STEP 4



A: 4PCS

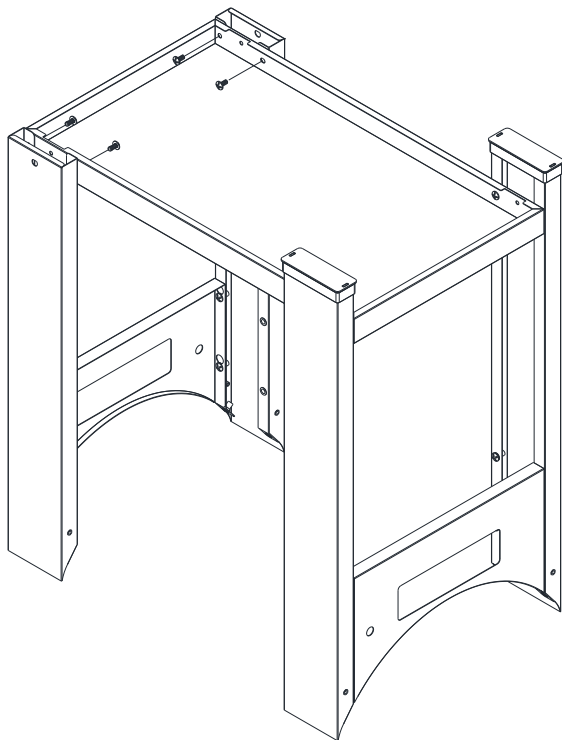

STEP 5

The screws have been
pre assembled

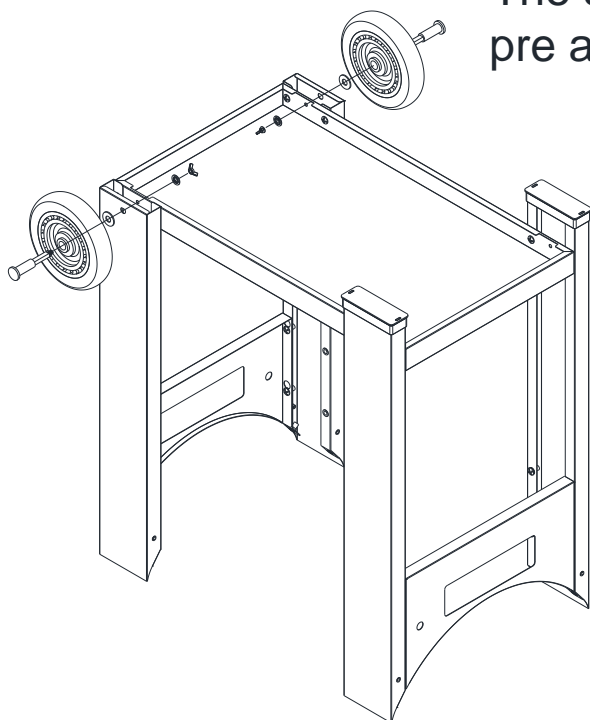

STEP 6



A: 2PCS

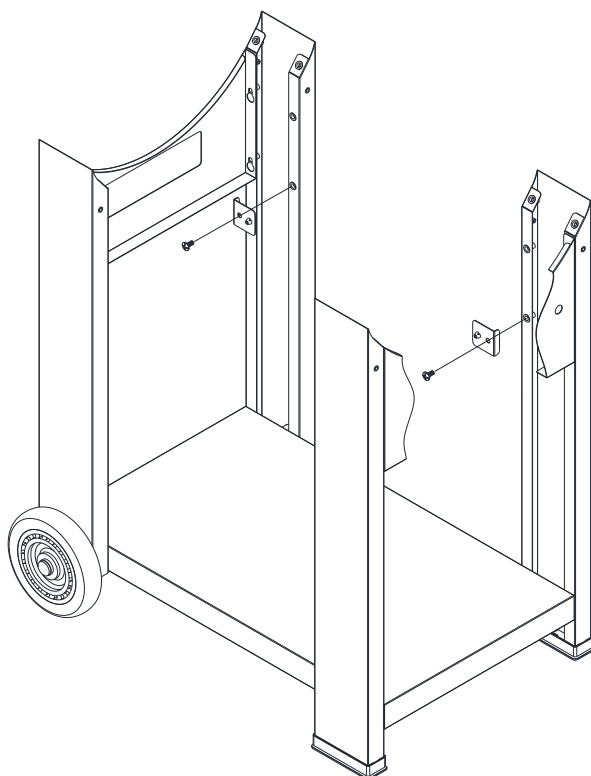

STEP 7

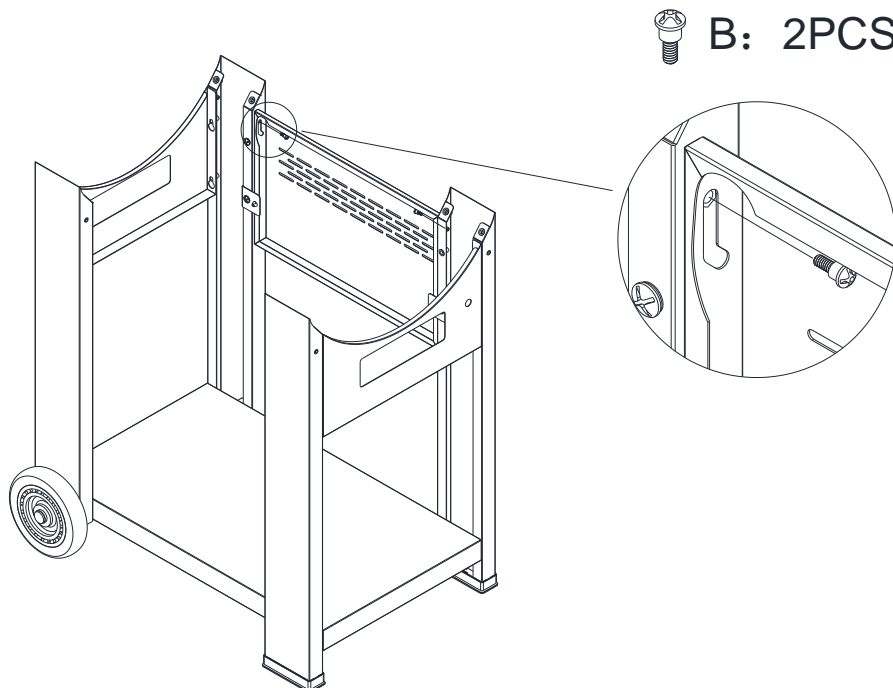

STEP 8

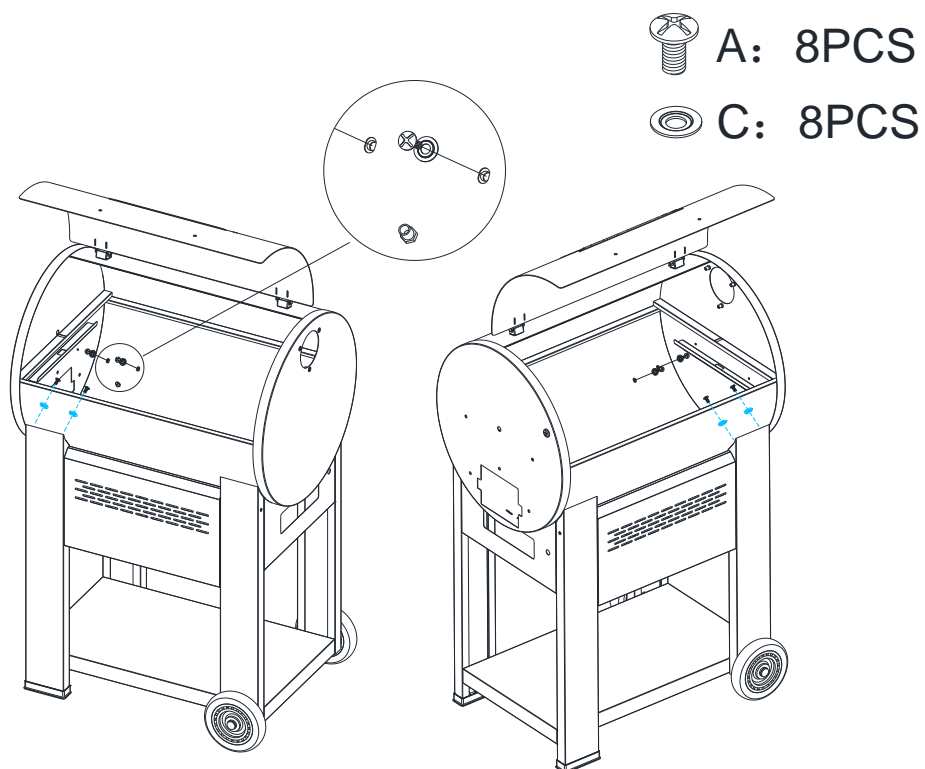

STEP 9

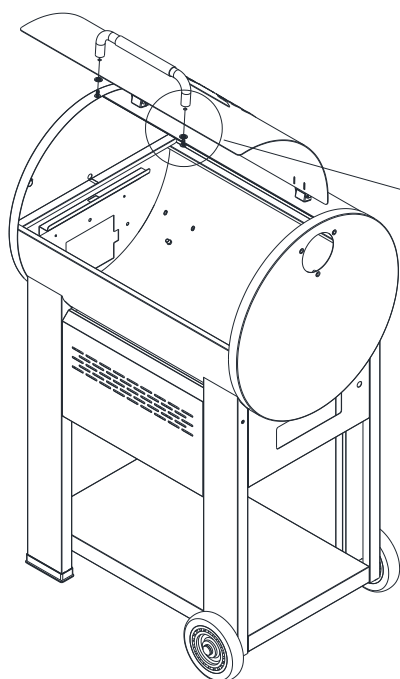

 A: 2PCS

 C: 2PCS

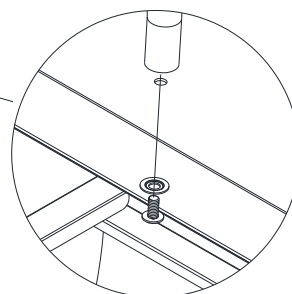

STEP 10

The screws have been
pre assembled

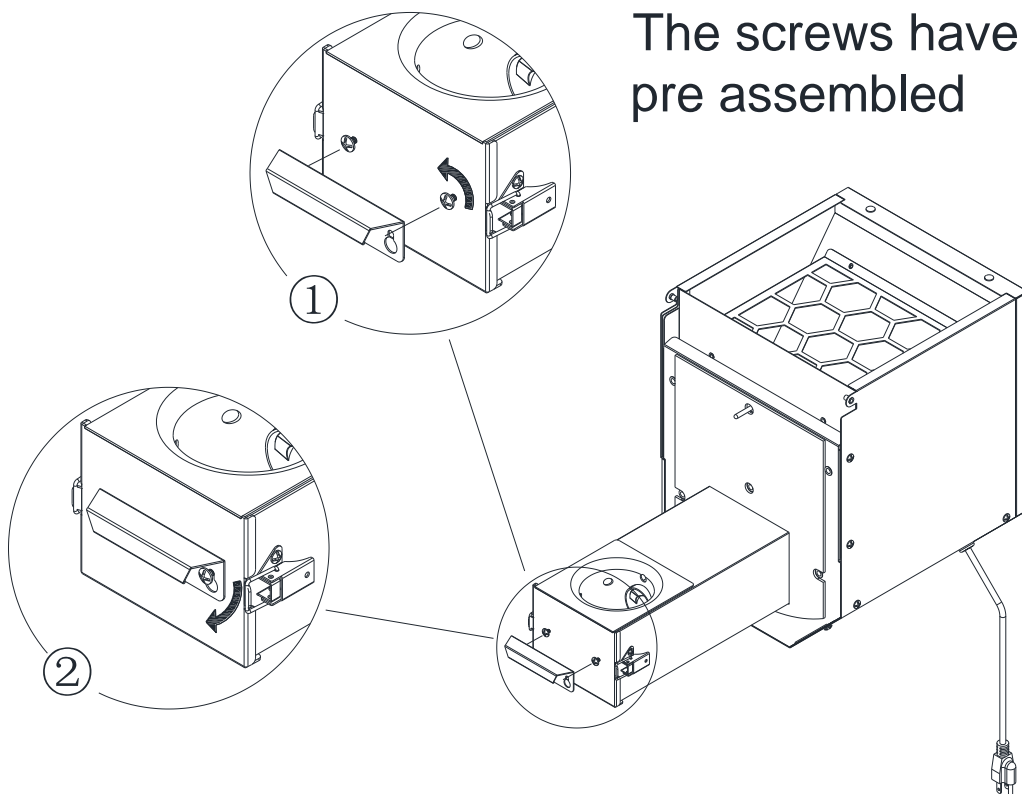

STEP 11

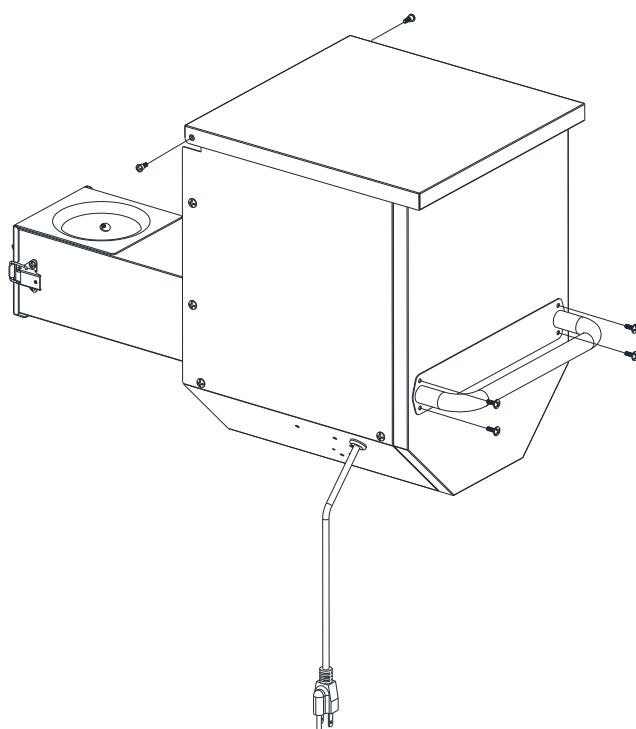

 B: 2PCS

 D: 4PCS

STEP 12

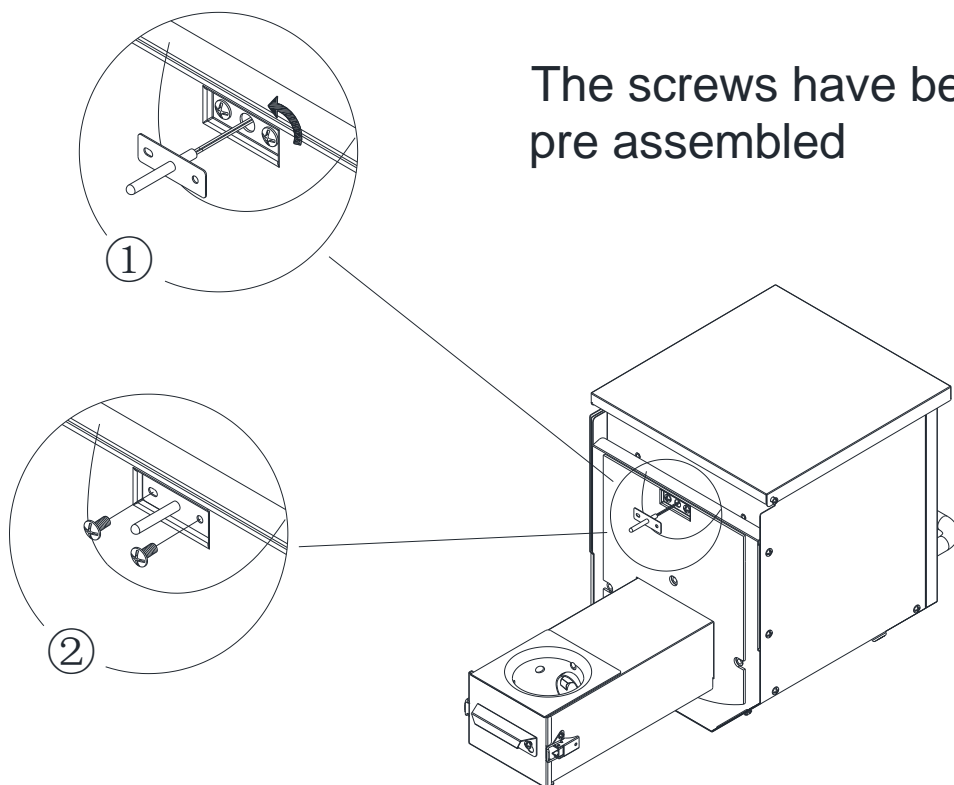

The screws have been
pre assembled

STEP 13

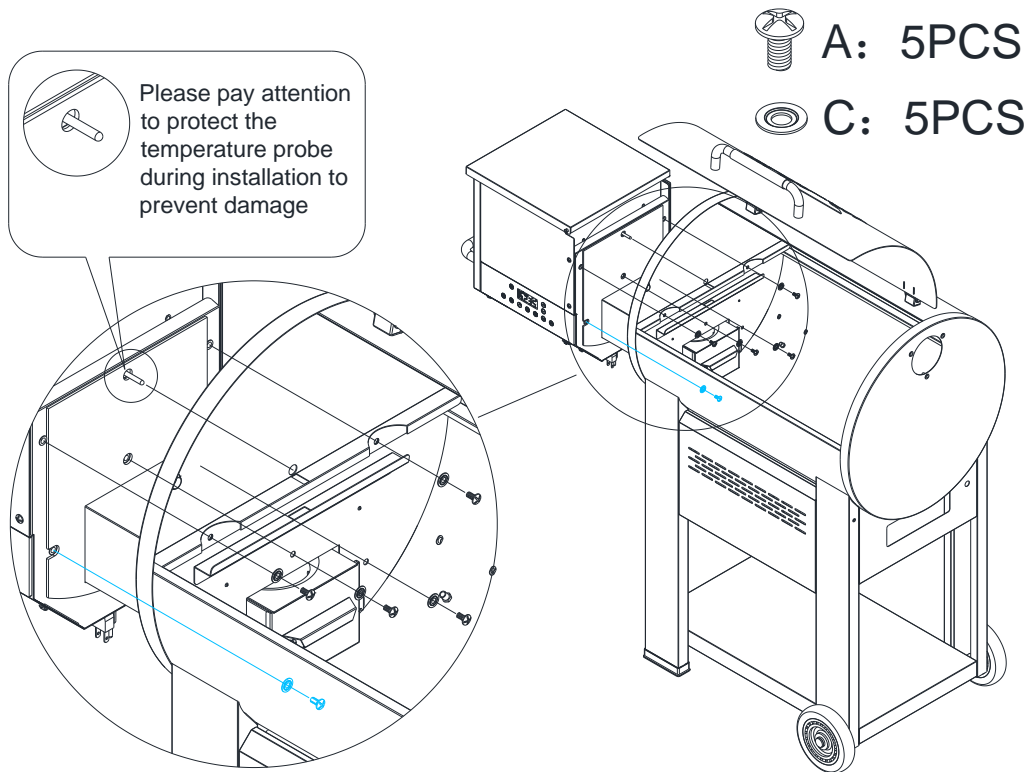

STEP 14

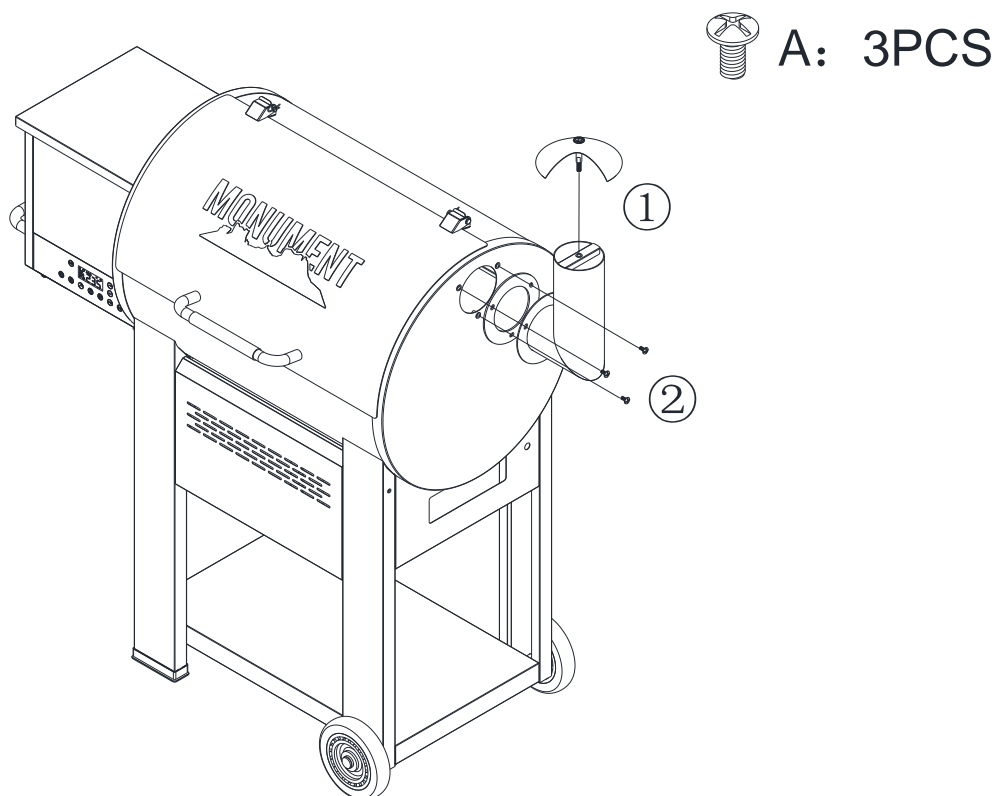

STEP 15

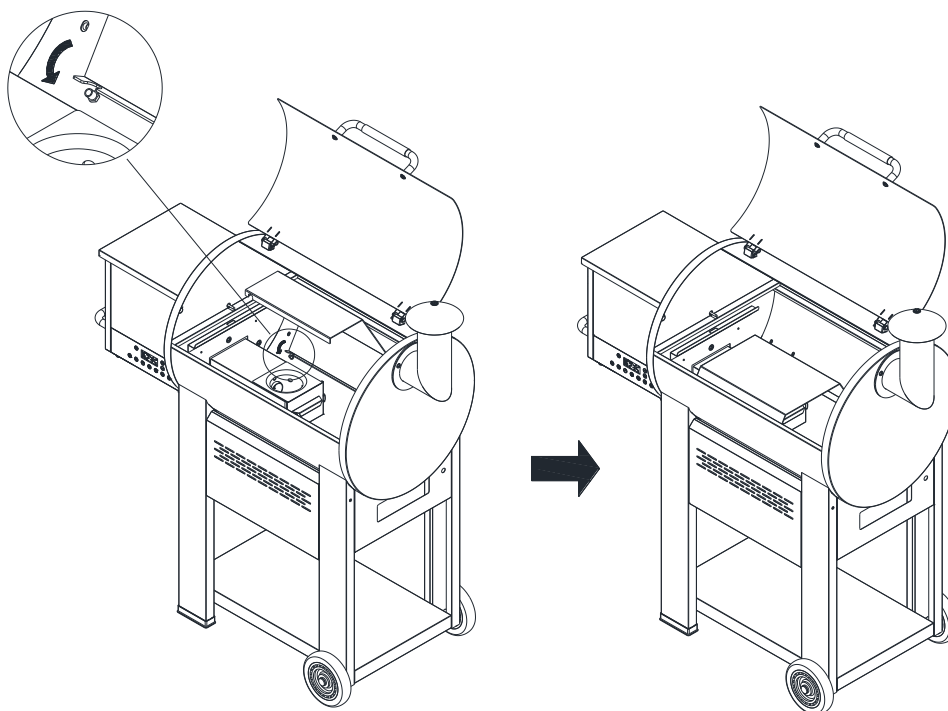

STEP 16

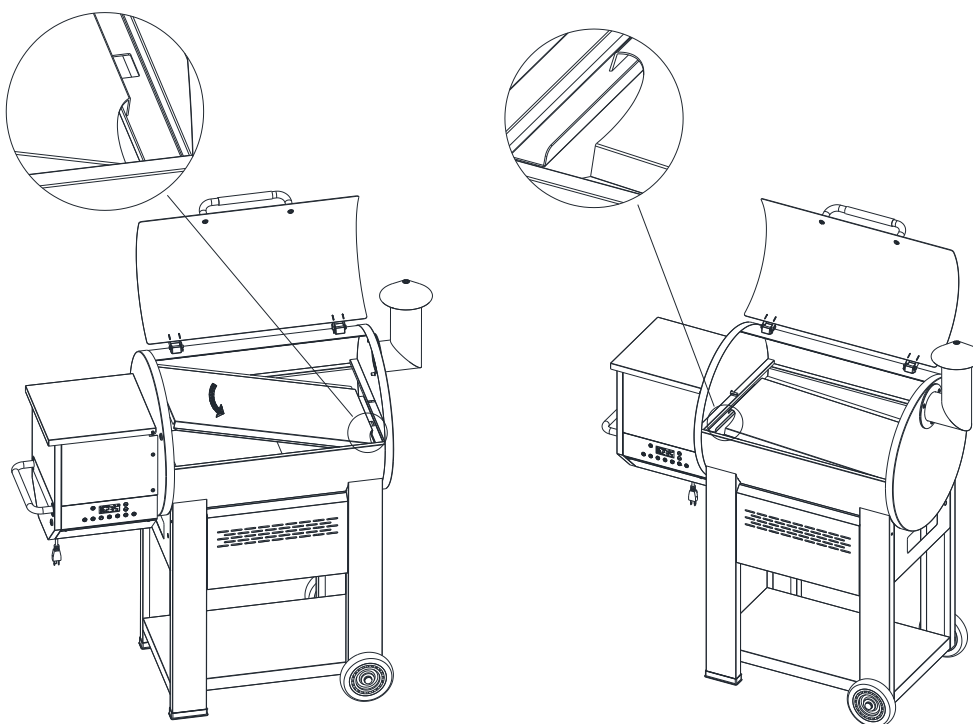

STEP 17

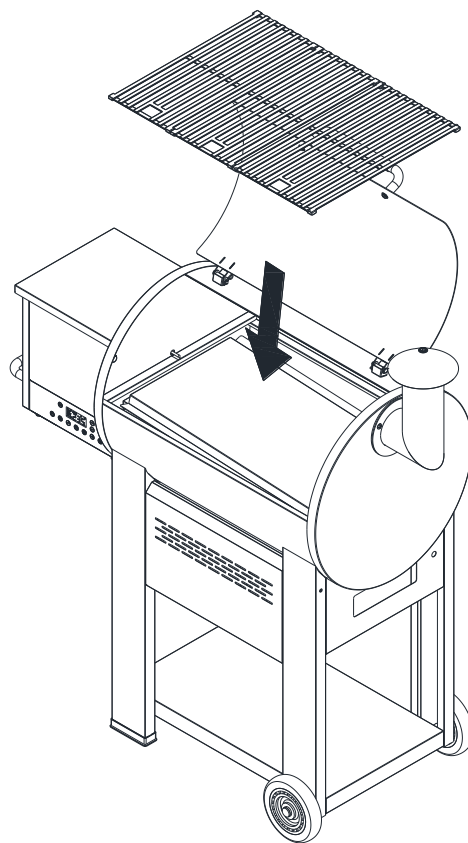

STEP 18

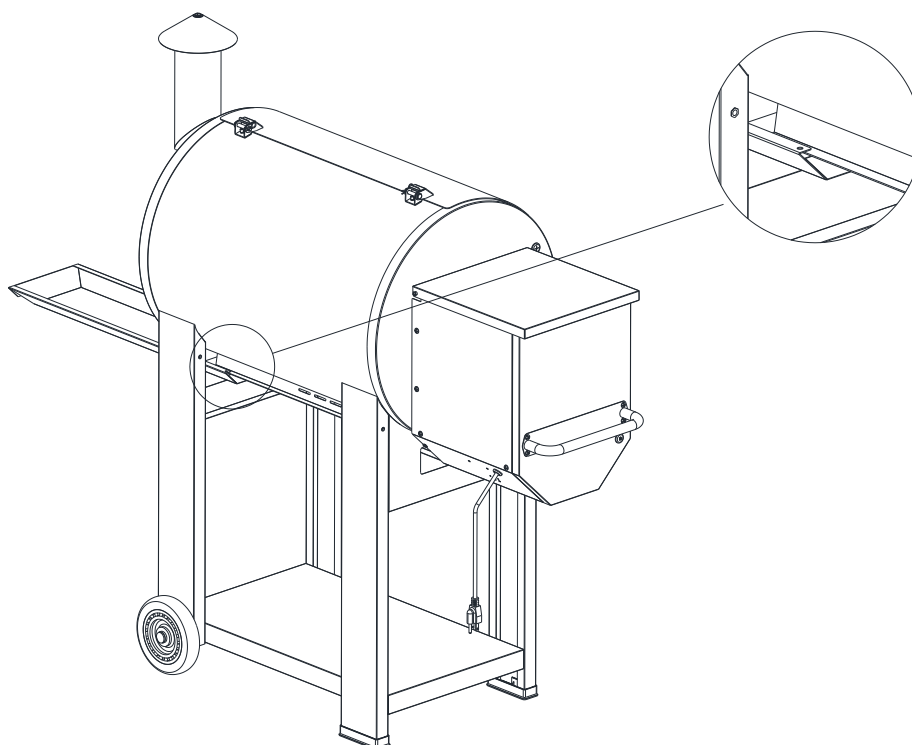

STEP 19

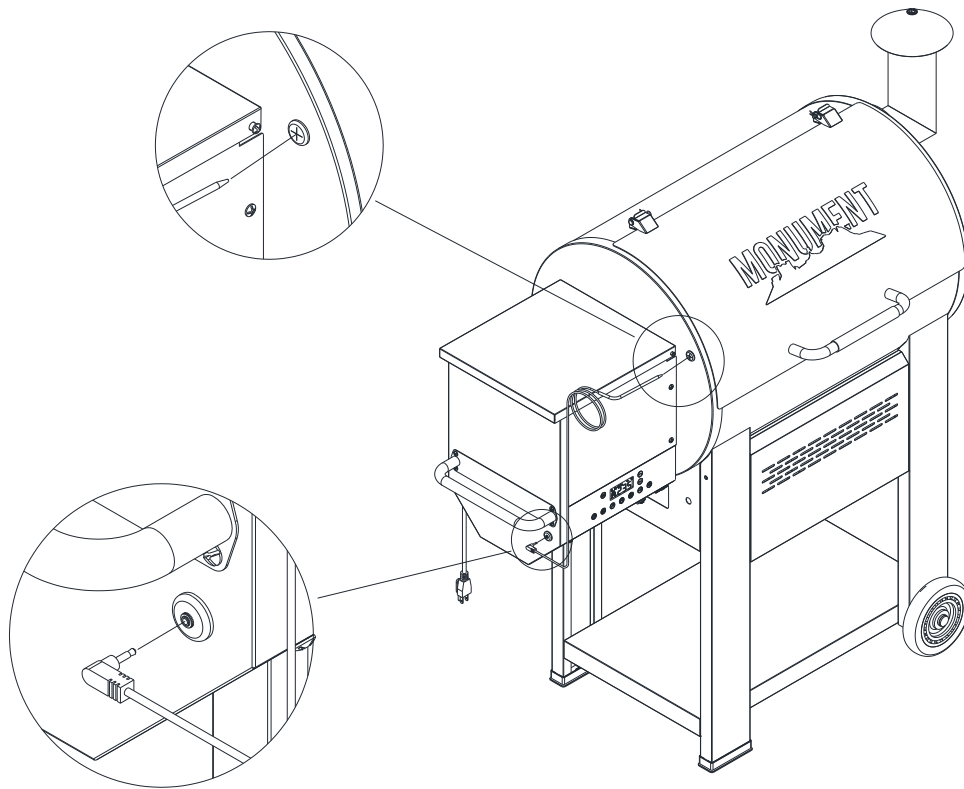

STEP 20

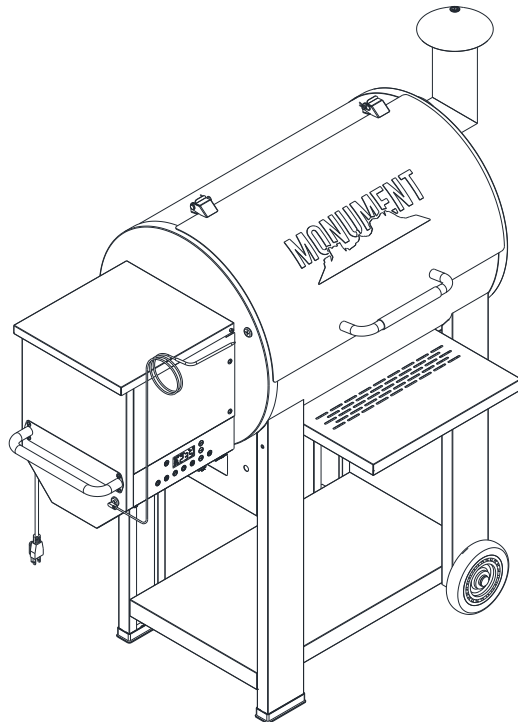

7. Use of smoked stove

7.1 Placement of equipment

The smoke oven should be placed in an open and ventilated place, at least as shown in the surrounding fixed facilities, and away from inflammable and explosive materials.

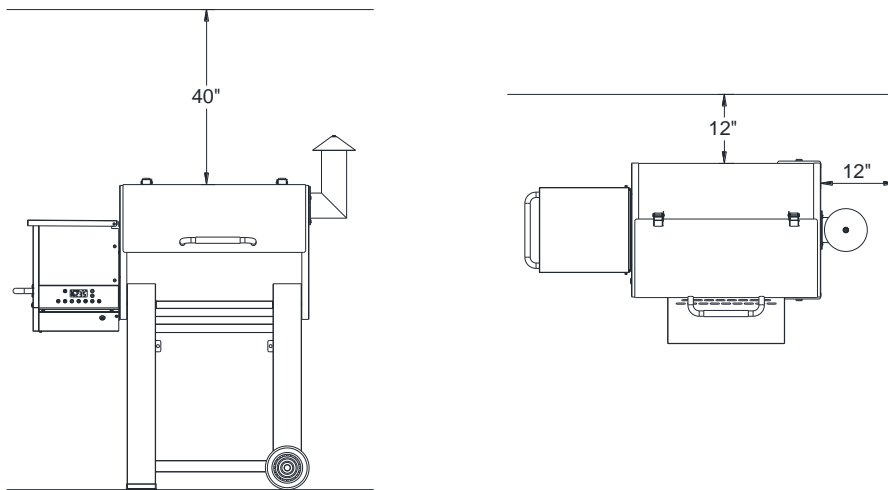

7.2 Fuel selection

The smoked stove should use standard wood pellet fuel. This kind of fuel can be purchased in local surrounding stores. Users can purchase fuel of different materials according to personal preference, but the particle size of fuel should not exceed 1.2"x0.3" . Large fuels may cause the equipment to go out due to poor feeding.

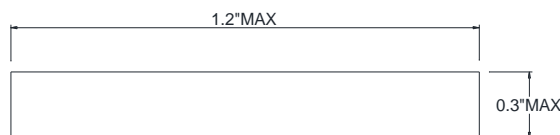

7.3 Confirmation before power on

Before powering on the equipment, you should re-confirm the surrounding power environment, and the socket and plug are not wet or the wiring is bare.

7.4 Button interface

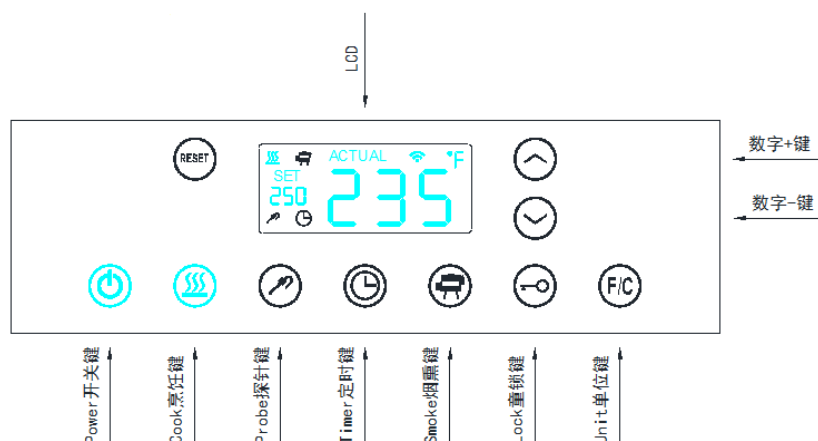

7.5 Ignition instructions

Clean the remaining ash in the combustion chamber before each ignition. Then pour new fuel into the control box, not to exceed the control box screen (about 2/3), and then put a small amount of new fuel into the combustion chamber. The fuel is pyramid-shaped to cover the best layer of the ignition rod 1~2. . Then place the fire plate, the oil guide plate and the grilling net in turn, close the lid, turn on the Power button, and select the desired mode.

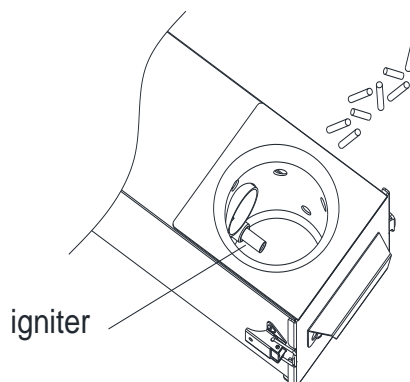
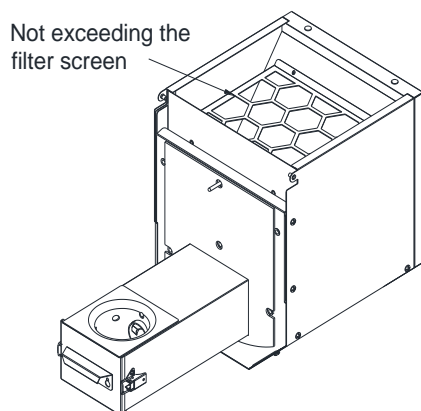

The device starts to ignite. White smoke will be emitted during the ignition of the fuel, and personnel can stay away from the operating equipment after waiting for the ignition to complete.

It should be noted that in order to save electricity, the ignition rod will only work when the Cook or Smoke mode is selected for the first time after power-on. In other cases, it does not work. Therefore, if the fuel is not ignited, the power should be turned off first. Key, then turn the Power button back on and select the appropriate mode to re-ignite.

7.6 Device shutdown

After the barbecue is over, please turn off the equipment safely:

First of all, please open the top cover of the control box, remove the excess fuel from the box, and keep it for future use.

Then, let the equipment continue to work for 5 to 10 minutes to drain the fuel in the feeder; Next, click the Power button to turn it off, but don't unplug the power immediately. At this point, the cooling fan will continue to work for 5 minutes until the fuel is burned out and extinguished.

Finally, please unplug the power supply and store the oven in a cool, ventilated place, avoiding sun exposure and heavy rain.

8. Button function description

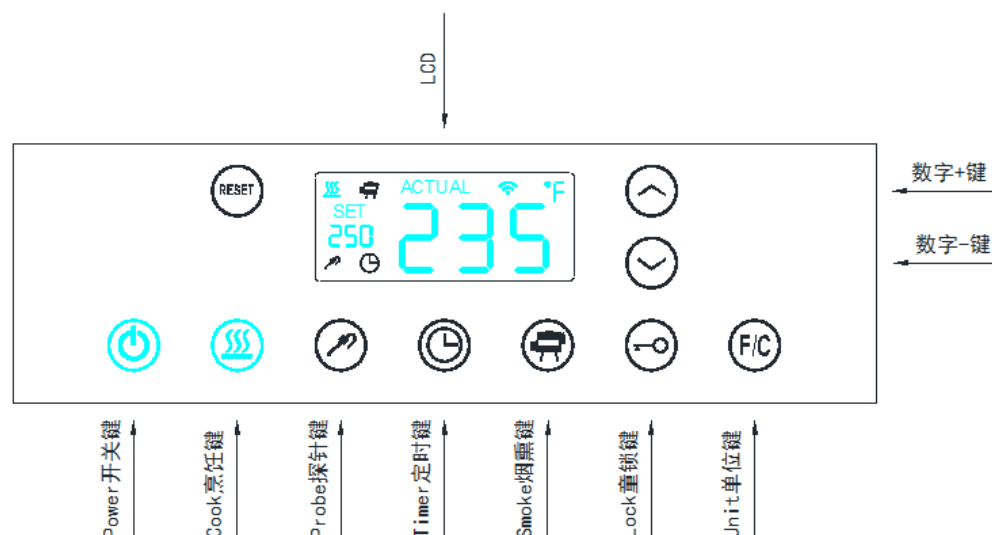

The key is the device key, the key is turned on, other keys can be operated, the key is closed, the device is in the stop state, other key operations are invalid, and the corresponding keys in the APP have the same function.





This button is the cooking button. When it is turned on, it enters the normal cooking mode. The corresponding icon on the LCD screen lights up. The user can select the default setting or set the cooking temperature by itself. (The SET area of the LCD screen will display correspondingly.)



The button is a smoked button. When it is turned on, it enters the smoke mode. The corresponding icon on the LCD screen lights up. The user can select “1 (small smoke)” or “2 (too smoke)” file (LCD SET area will be There is a corresponding display), the app will automatically synchronize with the device. The device can only choose one mode to work in the cooking button and the smoke button. No matter which mode is selected, the other mode will be automatically turned off.



The button is the probe opening key (the external barbecue probe needs to be connected). When the probe is turned on, the probe is enabled, the corresponding icon on the LCD screen is lit, the user can select the default setting, or set the cooking temperature by himself (the LCD SET area will be Corresponding display), the app will automatically synchronize with the device. The corresponding key in the app has the same function. After the setting is completed, the device starts to work. After the set temperature is reached, the device will beep. You can press any button to cancel the beep. If there is no 2 minutes. The operation will automatically stop. Press and hold for 3 seconds to exit this mode. Display priority is higher than  and 



This button is the timed key. When it is turned on, it enters the countdown

mode. The corresponding icon on the LCD screen lights up.

Select the default setting, you can also set the countdown time yourself (the LCD screen SET area will have corresponding display), the App will automatically synchronize with the device, the corresponding key in the App has the same function, the device starts working after the setting is completed, after the set time, the device The beep will prompt, you can press any key to cancel the buzzer, if there is no operation for 2 minutes, it will stop automatically. Press and hold for 3 seconds to exit this mode. When this key is enabled, the display priority is higher than 🔑



This key is the key to the child lock. When it is turned on, it enters the child lock mode. At this time, the operation of any key is invalid, mainly to prevent children from misoperation. The button needs to be pressed for 3 seconds to unlock. After unlocking, other buttons can be used again. The app will automatically sync with the device, and the corresponding keys in the app have the same function.



This button is the unit switching button. The Fahrenheit temperature is displayed by default. It can display Celsius temperature after lighting, or switch back to Fahrenheit. The corresponding icon on the LCD will automatically switch. The app will automatically synchronize with the device, and click the temperature display position in the center of the App interface to achieve unit switching.



This button is a digital up button, and each time you click, the number "+1" is completed.



This button is a digital drop button, and each time you click, the number "-1" operation is completed.

Every time the above keys are successfully operated, the device will have a "beep" sound, please pay attention.

If the sensor in the furnace is poorly connected or damaged, the LCD panel will display "Err" and the device will not work.

The fan will continue to operate for 5 minutes to prevent fuel re-ignition each time the key is turned on for shutdown.

If the temperature of the sensor in the furnace is lower than 120 ° F for 15 minutes, the device will beep for 2 minutes to indicate that the combustion is

extinguished. Press any key to cancel the buzzer. If there is no operation for 2 minutes, it will stop automatically.

9. Troubleshooting common faults

Fault description	Troubleshooting	Troubleshooting
The equipment is not on fire	Fuel is not ignited	Try to re-ignite
	The fuel particles are too large to enter the feeder	Replace small pellet fuel
	Feed screw stop	Check if the circuit is abnormal or replace the feed motor
	Ignition rod is not heated	Check if the circuit is abnormal or replace the ignition rod
LCD displays "Err"	In-furnace sensor failure	Check or replace the furnace sensor
Beep alarm	The barbecue probe reaches the set temperature	Press any key to cancel the buzzer
	Timing arrival time	Press any key to cancel the buzzer
	Smoker is extinguished	Refueling
	Grilled probe is not connected	Connecting barbecue probe
	Poor connection or damage to the furnace sensor	Replace the furnace sensor