

FACE RECOGNITION  
TEMPERATURE CONTROL ACCESS SYSTEM

FR50T  
User Manual

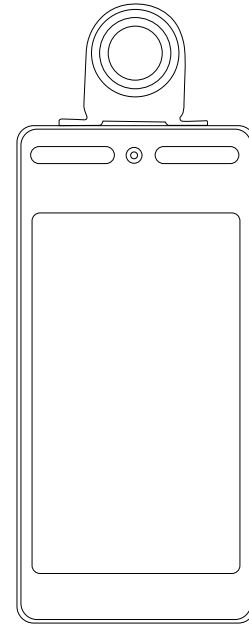

Specification

Model	FR50T
Screen	5.0 inch touch screen, 720 * 1280 Touch screen with virtual button
OS	Android 9.0 CPU: 4 core, 1.5G
Memory & Storage Capacity	1GB+8GB
Communication	Wi-Fi (2.4G), Bluetooth, LAN port
Temperature capture	Accuracy: 0.1°C Deviation: ±0.2°C (indoor) Best range: 0.4m-0.5m
Camera	2.0MP, 1080P
Interface	USB, Wiegand / Access Control
Housing	Ultra-thin edge design, Full-metal case
Supplement Light	White LED soft light
Weight	TBD
Dimension	TBD
Power supply	DC12V, 2A
Tripod	Optional
Working temperature	Environment temperature: 5°C ~ 45°C

Features

Accurate InfraRed  
temperature capture

Measurement Deviation:  
±0.2°C (indoor)  
Effective range:  
0.4 - 0.5m



Face Detection

Accuracy rate ≥99.9%  
Detection range: 0.4~1m  
Capture time <200ms

5 inch touch screen

Temperature captured display  
Voice alert for unusual  
personnel

Network Setup Instruction

Turn on the device. Connect to local Wi-Fi network.

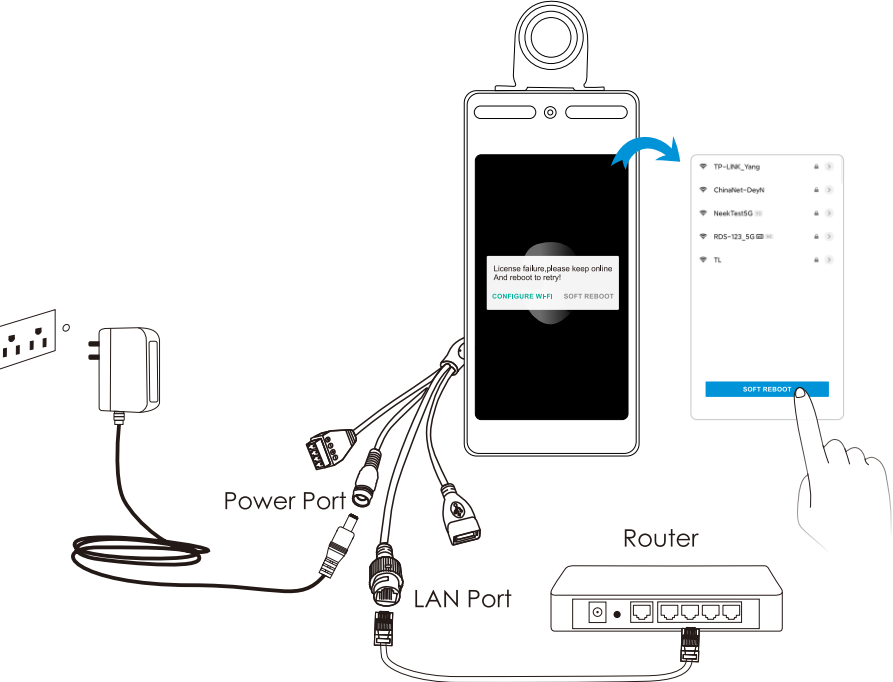

**Note:** The network must have WAN connection

PC Setup

1. Open internet browser. Input below address in address bar  
[http://t01.memoyun.com:8080/font\\_visgateplu s/#/Login](http://t01.memoyun.com:8080/font_visgateplu s/#/Login)

2. Input account name and password

Login Please

tuling

.....

Login

3. Device binding

Add device

Input device number

Input device name

Select device direction

☐ None ☒ Entrance ☐ Exit

Select group

please select

Cancel Sure

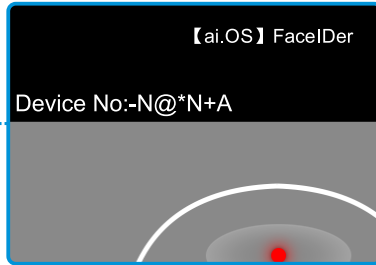

Installation

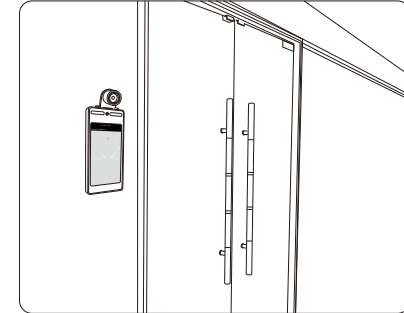

Wall-mount

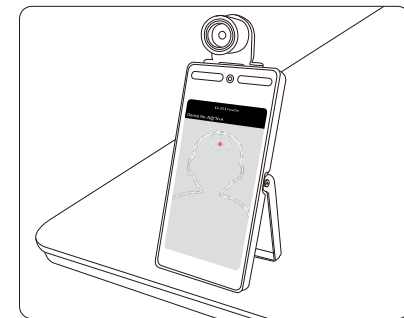

Desktop

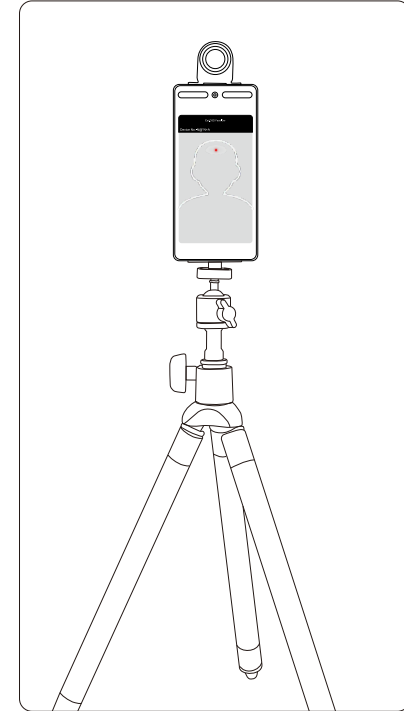

Tripod

## Warning:

This device complies with Part 15 of the FCC Rules. Operation is subject to the following two conditions: (1) this device may not cause harmful interference, and (2) this device must accept any interference received, including interference that may cause undesired operation.

changes or modifications not expressly approved by the party responsible for compliance could void the user's authority to operate the equipment.

NOTE: This equipment has been tested and found to comply with the limits for a Class B digital device, pursuant to Part 15 of the FCC Rules. These limits are designed to provide reasonable protection against harmful interference in a residential installation. This equipment generates, uses and can radiate radio frequency energy and, if not installed and used in accordance with the instructions, may cause harmful interference to radio communications. However, there is no guarantee that interference will not occur in a particular installation. If this equipment does cause harmful interference to radio or television reception, which can be determined by turning the equipment off and on, the user is encouraged to try to correct the interference by one or more of the following measures:

- Reorient or relocate the receiving antenna.
- Increase the separation between the equipment and receiver.
- Connect the equipment into an outlet on a circuit different from that to which the receiver is connected.
- Consult the dealer or an experienced radio/TV technician for help.

NOTE: This device and its antenna(s) must not be co-located or operation in conjunction with any other antenna or transmitter

## RF Exposure Statement

To maintain compliance with FCC's RF Exposure guidelines, This equipment should be installed and operated with minimum distance of 20cm the radiator your body. This device and its antenna(s) must not be co-located or operation in conjunction with any other antenna or transmitter