

10. Disconnect the cable from the Airborne unit; it will retract automatically.

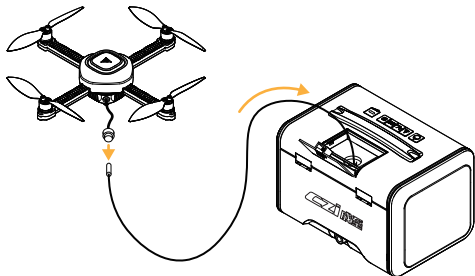

11. Place the Airborne unit into its protective sleeve and return it to the Ground Station. Close the cover.

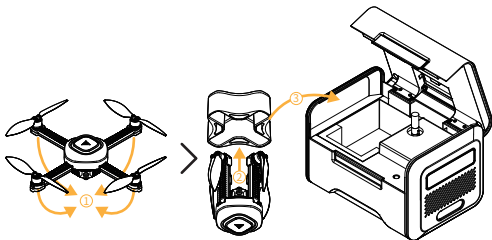

12. Long-press power button to shut down, disconnect power.

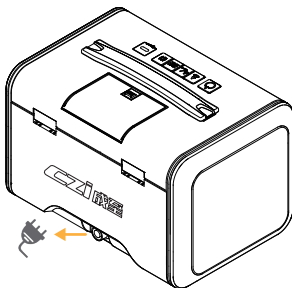

APP Control

Scan the QR code below to download the corresponding system app.

Propeller Guard Installation Tutorial

Attach the propeller guard as illustrated, then fasten it with the locking clip.

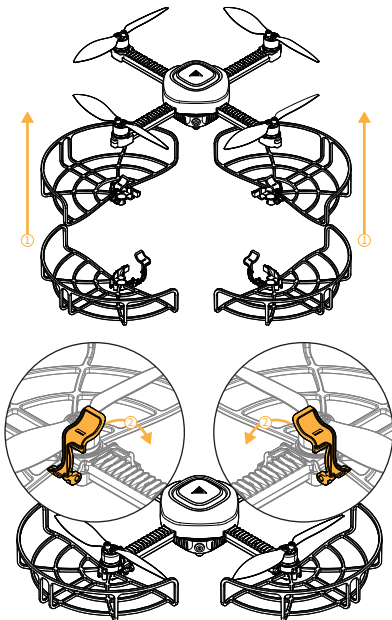

Product Maintenance

1. Disconnect the power source when the system is not in use.
2. Unplug all power connectors before cleaning.
3. Use a dry cloth to wipe surfaces. Store the device in a cool, dry place.
4. Regularly clean the cooling vents on both the Airborne and ground units to ensure proper ventilation and avoid overheating.

Packing List

CZ10 Full System	1
Power Adapter	1
User Manual (with Warranty Card)	1
Replacement Propeller Set (2 CW + 2 CCW)	1
Propeller Guard Set	1
RTK Module	1

产品合格证

本产品经检验符合技术标准

Product Certificate of Conformity

This product has passed inspection
and meets all technical standards.

产品名称	系留浮空灯 Hover Light
产品型号 MODEL	CZ10
检验员 QC	

产品保修卡

广州成至智能机器科技有限公司, 致力于为用户提供优质的产品服务!

自购买产品之日起7日内, 发生性能故障的, 可退货、换货或维修;

自购买产品之日15日内, 发生产品性能故障的, 可换货或维修;

产品三包有效期内发生性能故障的, 可享受免费维修服务。

当您需要我们提供技术支持及了解更多产品信息时, 请联系我们!

联系电话: 400-008-8306

地址: 广州市天河区广汕一路银湖创意园龙林中街5号广州成至智能机器科技有限公司

Product Warranty Card

CZI is committed to providing users with quality product services!

Within 15 days from the date of purchase of the product,
performance failures occur, can be returned, exchanged or repaired;
product warranty validity period of performance failures occur,
you can enjoy free repair services.

When you need us to provide technical support and learn more
product information, please contact us!

TEL : +86-400-008-8306

Web Site: <https://czi.com.cn/en>

成至技术支持

www.czi.com.cn

服务热线：400-008-8306

如您对说明书有任何疑问或者建议

请通过以下电子邮箱联系我们：

czzn@czi.com.cn

ChengZhi Support

www.czi.com.cn

Service hotline: 400-008-8306

If you have any questions or suggestions
about the instructions, Please contact us
through the following email address:

czzn@czi.com.cn



Made in China