

说明书

材质：封面封底128g铜版纸四印刷

内页70g书写纸双面黑白印刷

尺寸：210x142mm

装订方式：骑马钉装订

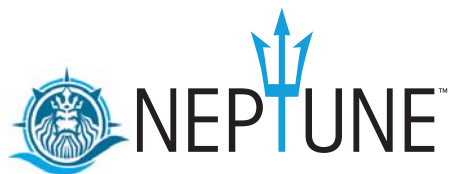

User Guide

MODEL: NTSB150



⚠ WARNING

ENG - This product is designed to be installed on wood stud, solid concrete or cinder block walls. Before installing make sure the supporting surface will support the combined load of the equipment and hardware. Screws must be tightly secured. Do not overtighten screws or damage can occur and product may fail. Never exceed the Maximum Load Capacity. Always use an assistant or mechanical lifting equipment to safely lift and position equipment. Be careful not to pinch fingers when operating the mount. For support please call customer care at 1-800-865-2112.

ENG Symbols



ENG **WARNING**



ENG Screws must get at least three full turns and fit snug.



ENG Skip to step.

ENG Tools Needed for Assembly.

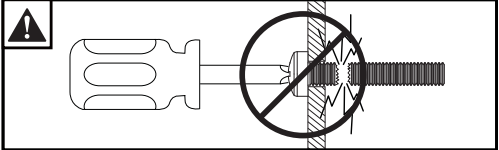
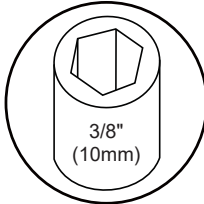
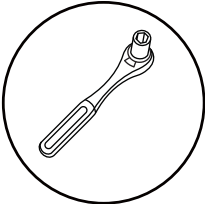
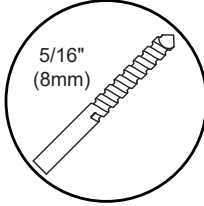
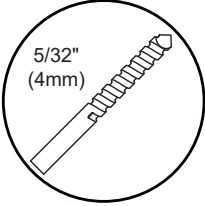
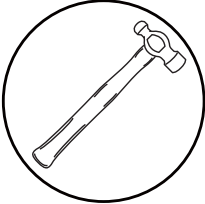
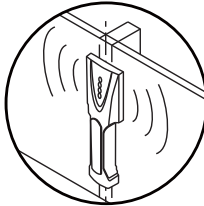
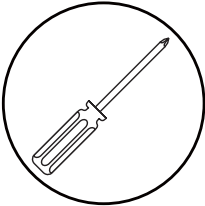
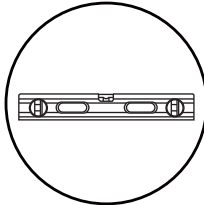
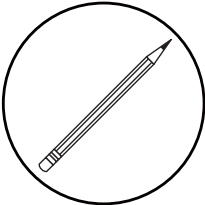

ENG Do not overtighten screws.

⚠

ENG To properly tighten screws: Tighten until screw head makes contact, then tighten another 1/2 turn. Do not overtighten screws.

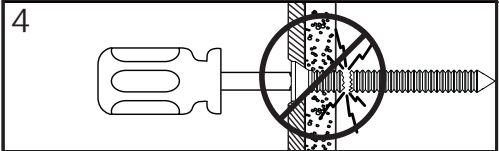
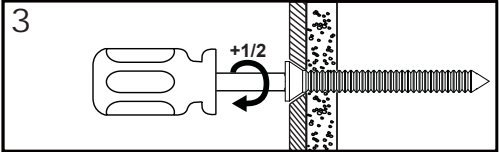
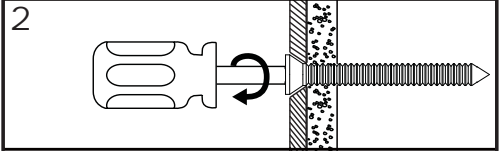
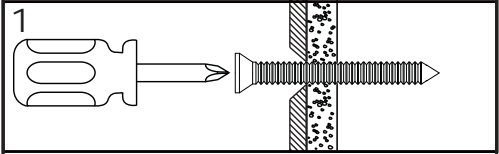

GENERAL SAFETY PRECAUTIONS

⚠ WARNING

RISK OF ELECTRICAL SHOCK

To reduce the risk of electric shock, do not disassemble the unit under any circumstances. No user serviceable parts inside. All product services should be done by the Peerless-AV certified service personnel.

Read before operating equipment

Thank you for purchasing our product. Before using it, please read this user manual carefully and follow the instructions correctly for safe operation. Please keep this manual handy for future reference. Also, please be sure to always include this user manual in the packaging when transferring or transporting this product to a different location.

Batteries Installed Warning

CAUTION - Danger of explosion if batteries are incorrectly replaced. Replace only with the same or equivalent type. The batteries shall not be exposed to excessive heat such as sunshine, fire or the like.

CAUTION:

These servicing instructions are for use by qualified service personnel only. To reduce the risk of electric shock, do not perform any servicing other than that contained in the operating instructions unless you are qualified to do so.

1. Read these instructions.
2. Keep these instructions.
3. Heed all warnings.
4. Follow all instructions.
5. Do not defeat the safety purpose of the polarized or grounding type plug. A polarized plug has two blades with one wider than the other. A grounding type plug has two blades and a third grounding prong. The wide blade or the third prong are provided for your safety. If the provided plug does not fit into your outlet, consult an electrician for replacement of the obsolete outlet.
6. Protect the power cord from being walked on or pinched particularly at plugs, convenience receptacles, and the point where they exit from the apparatus.
7. Refer all servicing to qualified service personnel. Servicing is required when the apparatus has been damaged in any way, such as power-supply cord or plug is damaged, does not operate normally, or has been dropped.
8. Only use attachments/accessories specified by the manufacturer.
9. In case of emergency such as fire or electric shock caused by the product, immediately contact 911 or proper emergency police/fire service agencies in your country.
10. Follow instructions for wall, shelf or ceiling mounting as recommended by the manufacturer.
11. Use properly rated power voltage. Use of non-rated voltage may cause fire, electric shock and severe damages to the product.
12. Do not open the cabinet under any circumstances. High voltage inside of this product may cause electric shock.
13. Do not, under any circumstances, modify or disassemble this product as it may cause fire, electric shock, or severe damages to the product. Also any unauthorized modifications made to the product automatically void product warranty.
14. Never touch antenna lines, wires, if applicable, power cables or power plugs in such circumstances as lightning and thunder as it may cause electric shock.
15. Any severe physical impact on the product may cause certain components to fall out of place within and break, which may cause fire or electric shock. In such event, do not operate the product. Contact the manufacturer for support.
16. Periodically clean dust off the power plug, to keep it clean and dry, ensuring proper and safe operation of the product.
17. Do not destroy, process, or place the product close to any heating device; do not bend or twist power cords, power plugs, cables, or wires with excessive force; do not place any heavy object on the product as all of the above may cause damages to the product and result in fire or electric shock.
18. Do not touch power plugs with wet hands.
19. Always make sure to plug in the power plug firmly and completely. Incompletely placed power plugs may cause fire or electric shock due to built up heat emission.

20. Do not use any non-rated power sockets or power strips with many other devices jointly plugged in. The wire of non-designated capacity may cause fire due to built up heat emission. Try to use a single, directly dedicated and rated GFI power socket for the product for safe operation.
21. In case of product malfunction or unusual events such as electrical burning smell, smoke, or loss of content signals on soundbar due to internal overheating, immediately turn off and unplug the power and contact the manufacturer.
22. Do not install the product at such unstable locations as moving objects, constantly vibrating props, or uneven surfaces. Improper installation may cause products to fall off. Follow mounting instructions properly for safe operation of the product.
23. Do not install the product near any poisonous gas or chemically unstable atmosphere as it may cause fire.
24. Do not install the product near any strong magnetic or electrical current field. It may cause fire, electric shock, or severe damages to the product. The product may be subject to any electromagnetic radiation, causing failure.
25. Do not leave any fire source, such as candles, close to or on the product as it may be a cause for fire or damages to the product.
26. Do not move or transport the product with any cables (power cables, content connectivity cables) plugged in to the source devices. Damages may occur to the cables, plugs, or jointing connectors of the cables due to forcible bending and stress, which may cause damages to the waterproof seal of the product, making it subject to fire, electric shock, or shorted circuit.
27. When unplugging, always grab the plugs of power cords or cables. Improper pulling of the cords or cables may cause damages to the waterproof seal of the product, making it subject to fire, electric shock, or shorted circuit.
28. Do not climb on the product.
29. Do not use any other power cords or connection cables than what is provided with the product or from the manufacturer directly. Use of untested, unauthorized, or substituted power cords or connection cables may be a cause for malfunction, fire, electric shock, or severe damages to the product. Also such use of improper or undesignated power cords or connection cables will void product warranty.
30. Always leave the power Off when plugging or unplugging the power cords or connection cables to avoid electric shock or damages to the product.
31. Do not use any chemical such as paint thinner or benzene to clean the product's exterior. It may cause scratches on the surface, erasing proper indications, identification labels, or instructions on the exterior, which may be a cause for misuse and improper operation of the product.
32. Never power wash or spray water at the front grill of the soundbar. While the speaker gaskets are IP55 rated and won't allow ingress of water to the electrical components, doing so may cause damage to the drivers and void the warranty.
33. Statement according to FCC part 15.21:
Changes or modifications not expressly approved by the party responsible for compliance could void the user's authority to operate the equipment.



This equipment is a Class II or double insulated electrical appliance. It has been designed in such a way that it does not require a safety connection to electrical earth.



A triangle with a lightning arrow in : Remind you of probable high voltage here in case of electric shock



A triangle with an exclamation mark in : Remind you that the parts here are very important, If replacement etc, is needed , please refer to relevant technical specifications

Where a plug on the power supply cord is used as the disconnect device, the socket-outlet shall be easily accessible



Cet appareil est un appareil électrique de classe II ou à double isolation. Il est conçu de manière à ne pas nécessiter de connexion sécurisée à la terre électrique.



Un triangle avec des flèches lumineuses: pour vous rappeler qu'il peut y avoir une tension élevée ici, en cas d'électrocution



Un triangle marqué d'une note: il est important de vous rappeler que les pièces sont ici, voir les spécifications techniques pertinentes si elles doivent être remplacées, etc.

Lorsque la prise sur le cordon d'alimentation est utilisée comme dispositif de déconnexion, la prise doit être facilement accessible

FCC CAUTION

To assure continued compliance and possible undesirable interference, ferrite cores may be used when connecting this TV to video equipment; maintain at least 400mm (15.75 inches) spacing to other peripheral devices.

FCC STATEMENT

This equipment has been tested and found to comply with the limits for a Class B digital device, pursuant to Part 15 of the FCC Rule. These limits are designed to provide reasonable protection against harmful interference in a residential installation. This equipment generates, uses and can radiate radio frequency energy and, if not installed and used in accordance with these instructions, may cause harmful interference to radio communications; however, there is no guarantee that interference will not occur in a particular installation. If this equipment does cause harmful interference to radio or television reception, which can be determined by turning the equipment off and on, the user is encouraged to try to correct the interference by one or more of the following measures:

1. Reorient or relocate the receiving antenna.
2. Increase the separation between the equipment and receiver.
3. Connect the equipment into an outlet on a circuit different from that to which the receiver is connected.
4. Consult the dealer or an experienced radio/TV technician for help.

This device complies with Part 15 of the FCC Rules. Operation is subject to the following two conditions:

- This device may not cause harmful interference.
- This device must accept any interference received, including interference that may cause undesired operation.
- When using the product, maintain a distance of 20cm from the body to ensure compliance with RF exposure requirements.

IC STATEMENT

This device contains licence-exempt transmitter(s)/receiver(s) that comply with Innovation, Science and Economic Development Canada's licence-exempt RSS(s). Operation is subject to the following two conditions:

- (1) This device may not cause interference.
- (2) This device must accept any interference, including interference that may cause undesired operation of the device

L'émetteur/récepteur exempt de licence contenu dans le présent appareil est conforme aux CNR d'Innovation, Sciences et Développement économique Canada applicables aux appareils radio exempts de licence.

L'exploitation est autorisée aux deux conditions suivantes :

- (1) L'appareil ne doit pas produire de brouillage;
- (2) L'appareil doit accepter tout brouillage radioélectrique subi, même si le brouillage est susceptible d'en compromettre le fonctionnement.
- (3) Lors de l'utilisation du produit, maintenir une distance de 20cm du corps pour assurer le respect des exigences d'exposition RF.

Relevant Information

Record your soundbar's model and serial number here for future reference. Keep this user manual in an accessible location in the event settings need to be changed or service is desired.

Note: Your soundbar's serial number can be found on the box and on the rear input panel.

Model Number _____

Serial Number _____

Parts (Before beginning, make sure you have all parts shown below).

Parts List		
	Description	Qty
A	soundbar	1
B	hook-on bracket	2
C	wall plate	1
D	mount bracket	2
E	rain cover	1
F	remote control	1
G	M6 x 60mm wood screw	2
H	expansion anchor	2
I	M6 X 15mm phillips screw	2
J	M4 x 10mm phillips screw	2
K	M3 x 6mm thumb screw	3
L	HDMI cable	1
M	power cable	1

B (2)
hook-on bracket

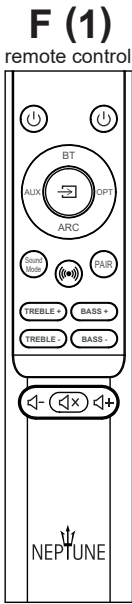
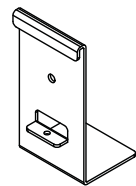

A (1)
soundbar

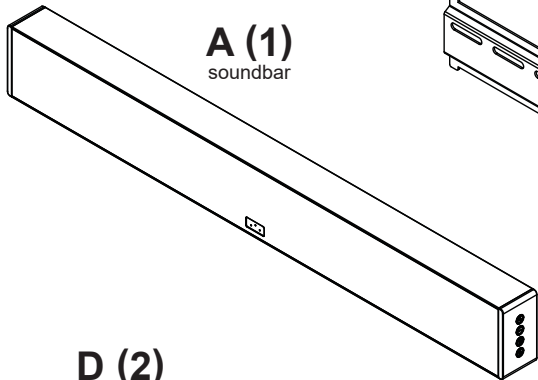

C (1)
wall plate

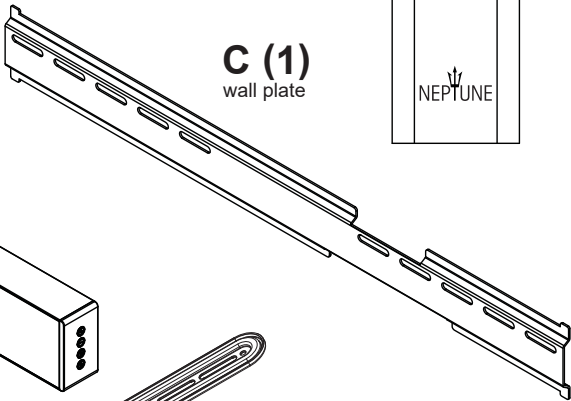

D (2)
mount bracket



E (1)
rain cover

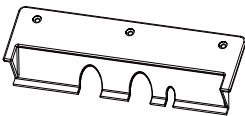

G (2)
M6 x 60mm wood screw

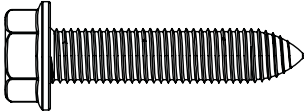

I (2)
M6 x 15mm



J (2)
M4 x 10mm



K (3)
M3 x 6mm



H (2)
expansion anchor

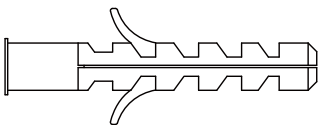

L (1)
HDMI cable

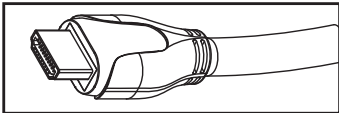

M (1)
power cable

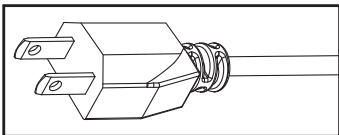

Button and Port Function

External Button Navigation

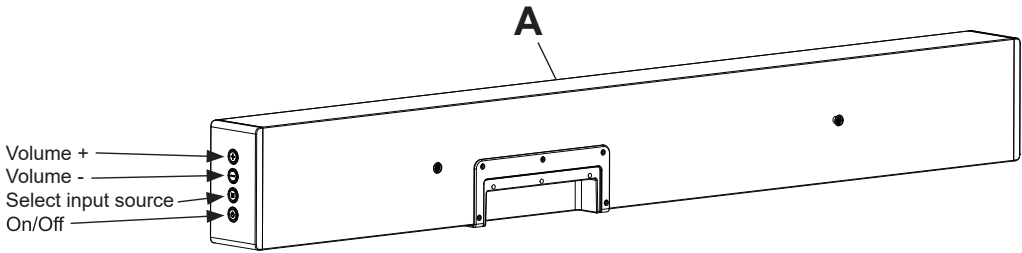

IO Compartment

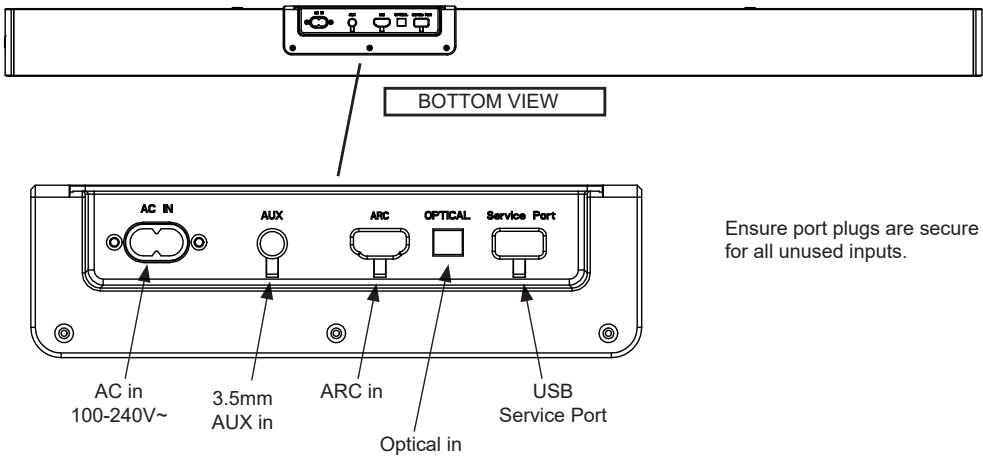

Install rain cover after connecting cables to all ports.

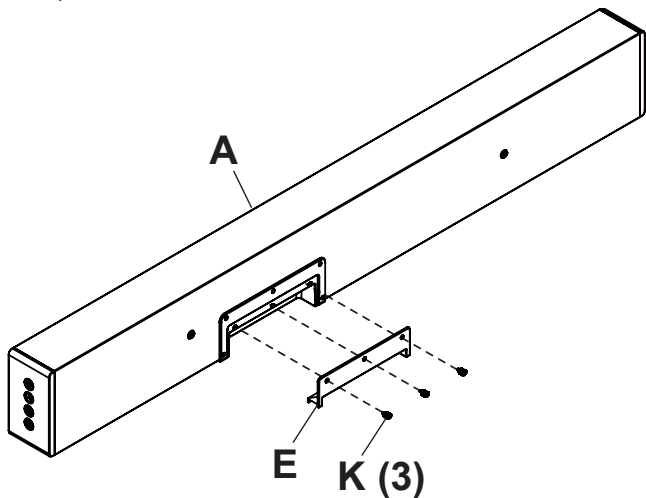
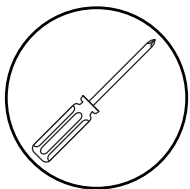

1

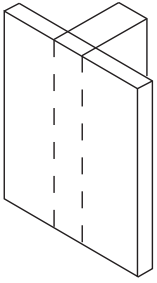

Wood stud wall.



1a

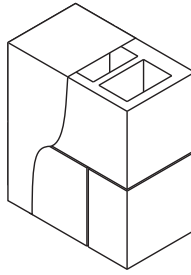

Concrete/Cinder block.

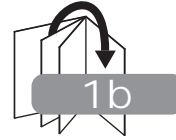

1b

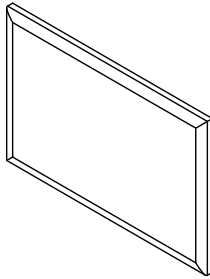

Display.



1c-1

1a

⚠ WARNING

ENG - When installing Peerless wall mounts on a wood stud wall covered with gypsum board (drywall), verify that the wood studs are a minimum of 2" x 4" nominal size. Do not install over gypsum board thicker than 5/8".

1a-1

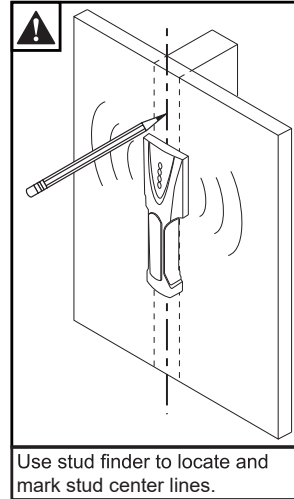
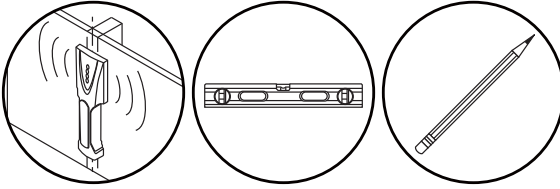

1a-2

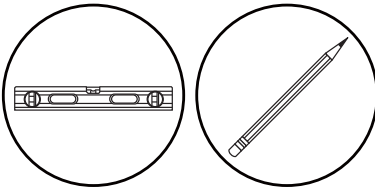

Level wallplate. Mark mounting holes on stud center lines.

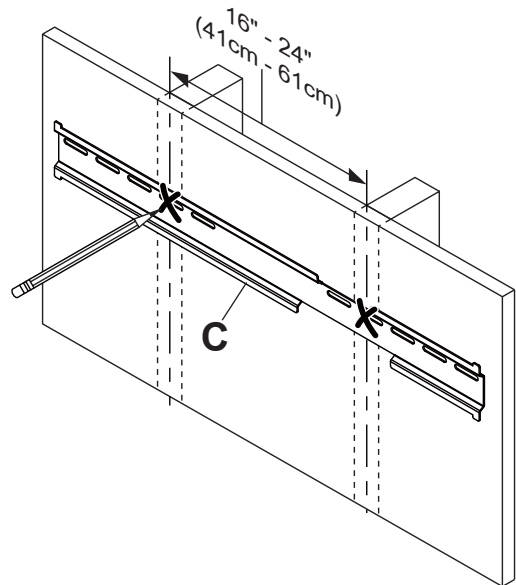

1a-3

Drill mounting holes into supporting surface
(2.5" (64mm) minimum depth required).

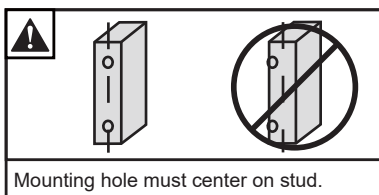
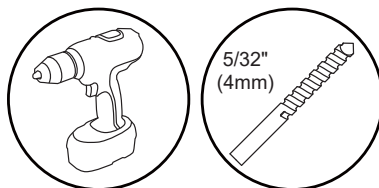
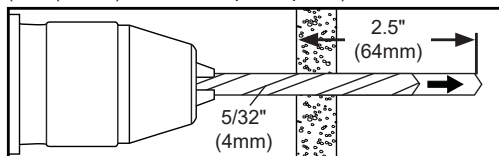

1a-4

Level wallplate. Install using wood screws provided.

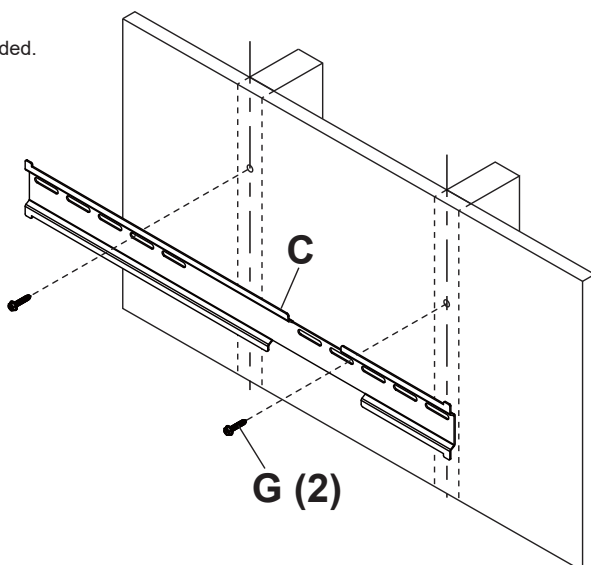
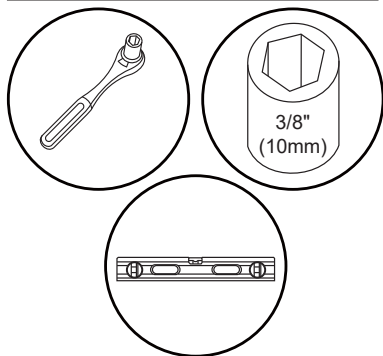
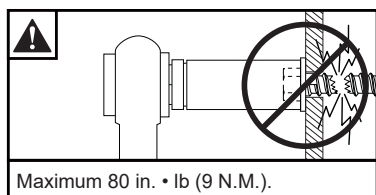

1a-5

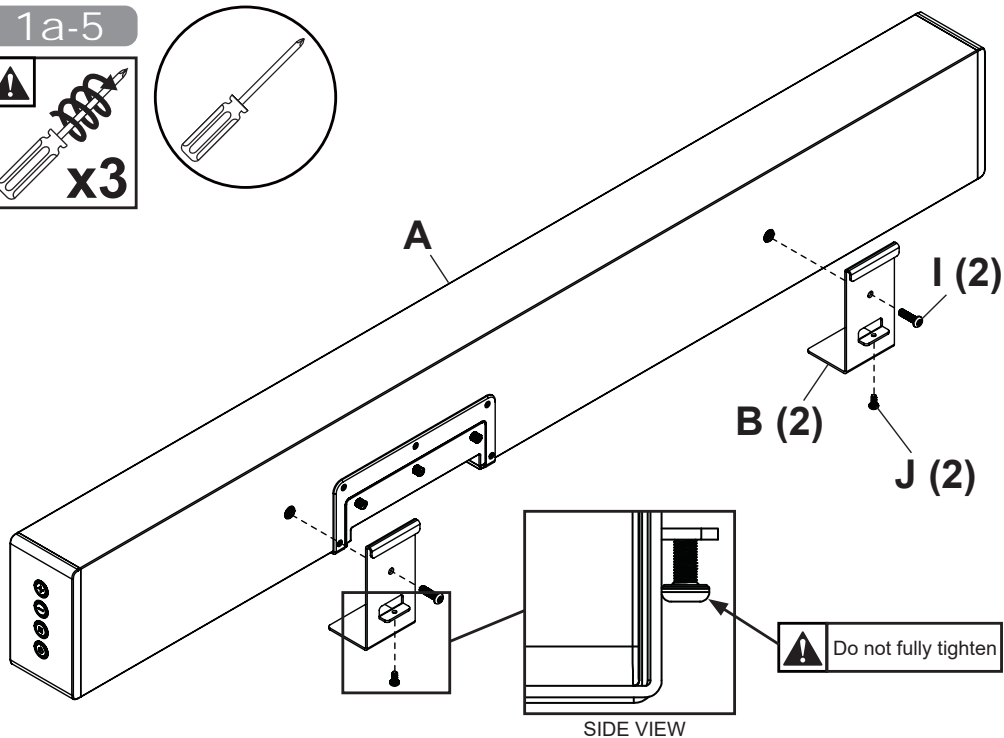
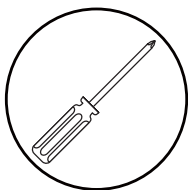

1a-6

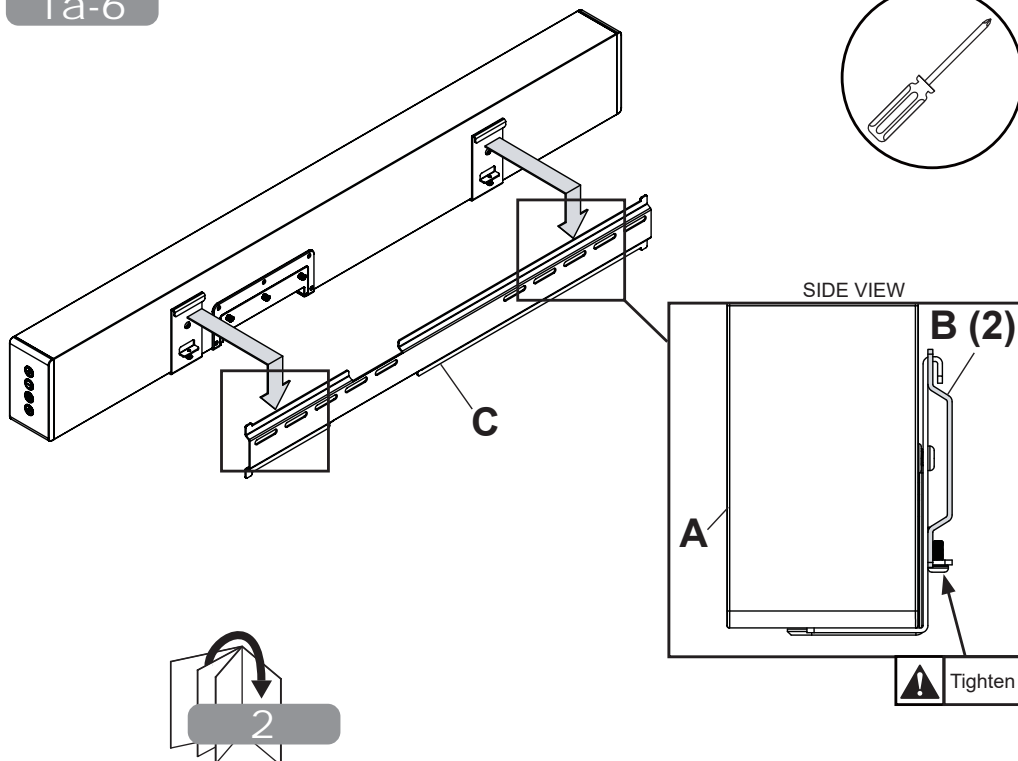
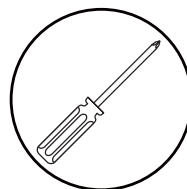

1b

⚠ WARNING

ENG - When installing Peerless wall mounts on a concrete wall, the wall must be at least 8" thick with a minimum compressive strength of 2000 psi. When installing Peerless wall mounts on a cinder block wall, the cinder blocks must meet ASTM C-90 specifications and have a minimum nominal width of 8". Do not drill into mortar joints! Be sure to mount in a solid part of the block, generally 1" (25mm) minimum from the side of the block. It is suggested that a standard electric drill on slow setting is used to drill the hole instead of a hammer drill to avoid breaking out the back of the hole when entering a void or cavity. Never attach concrete expansion anchors to concrete or cinder block covered with plaster, drywall or other finishing material.

1b-1

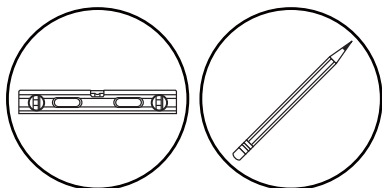

Level wallplate. Mark mounting holes.

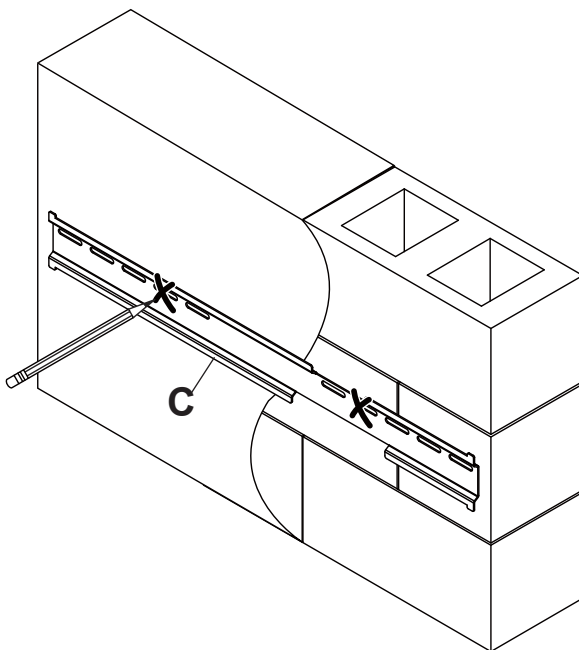

1b-2

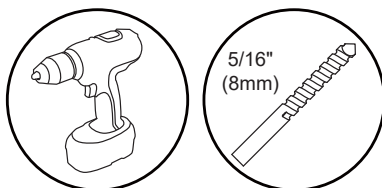

Drill mounting holes into supporting surface (2.5" (64mm) minimum depth required).

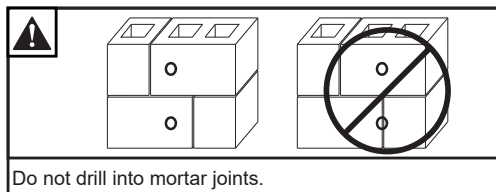
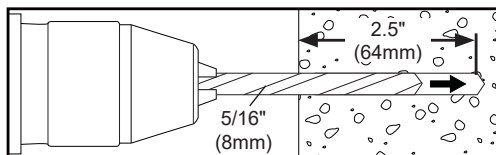

Do not drill into mortar joints.

1b-3

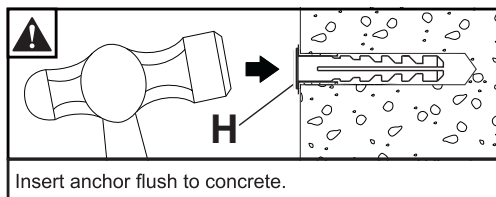
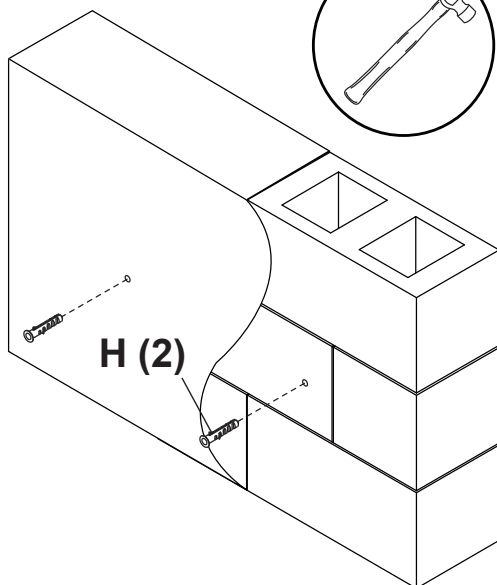

1b-4

Level wallplate. Install using concrete anchors and wood screws provided.

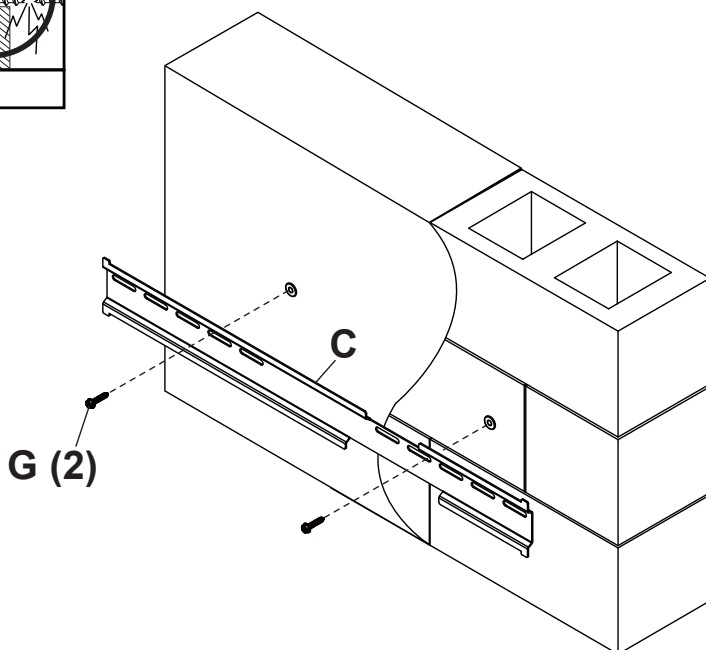
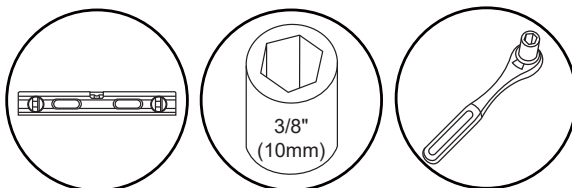
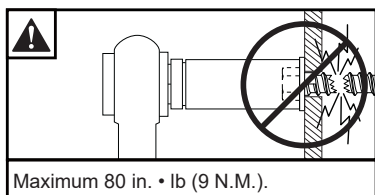

1b-5

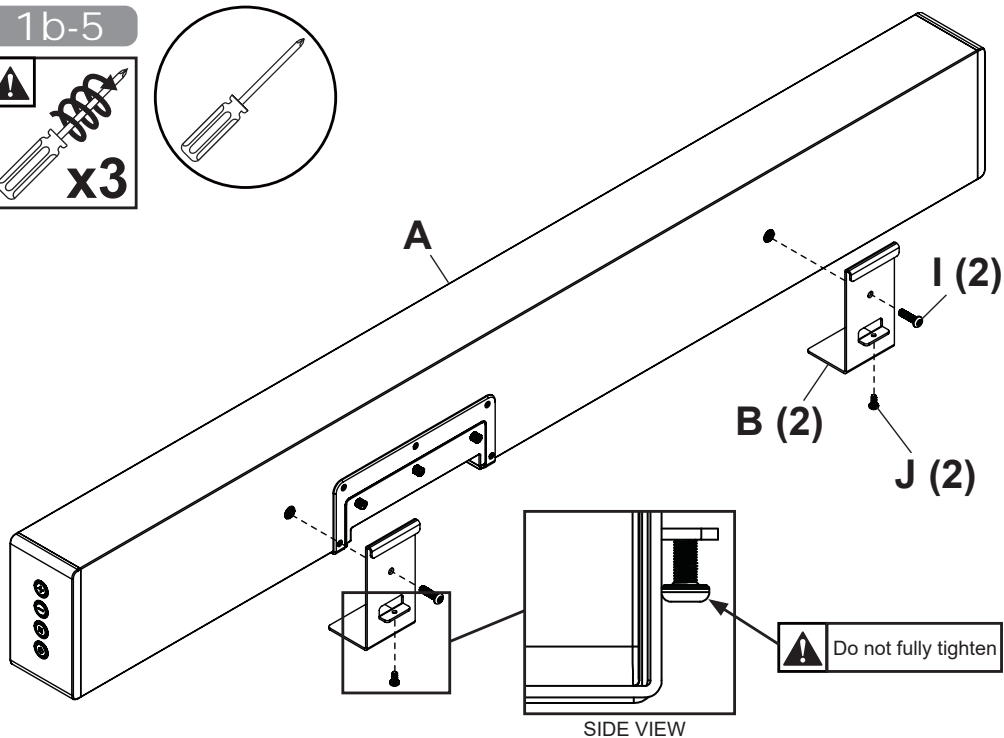
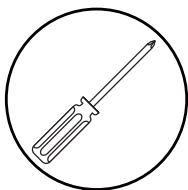

1b-6

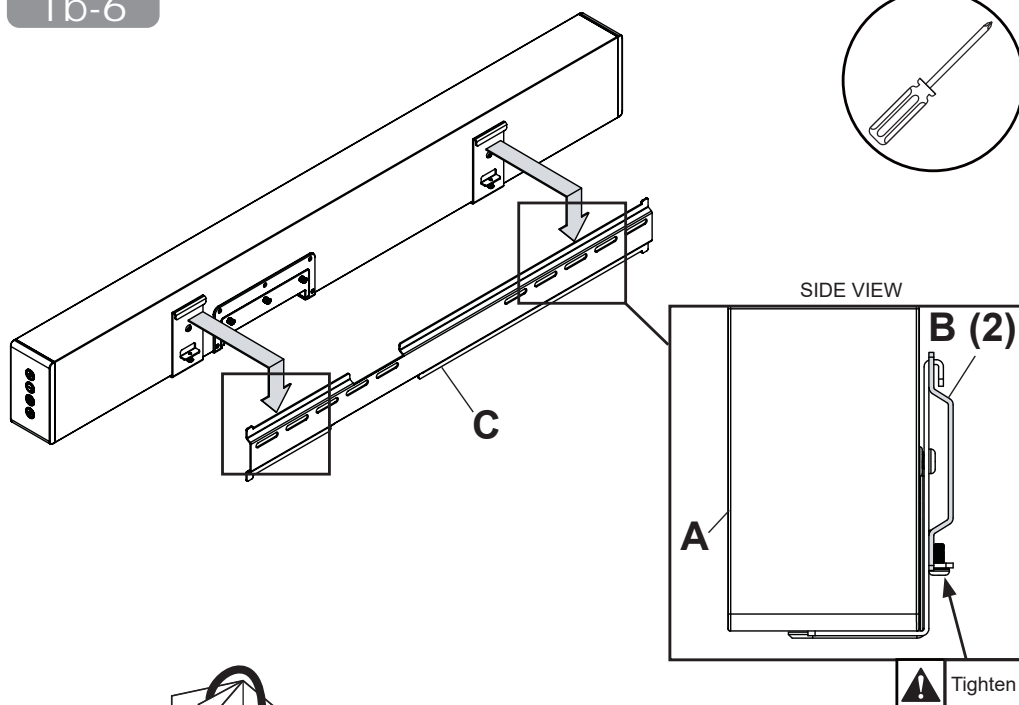
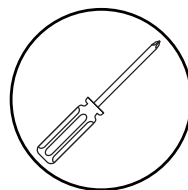

1c-1

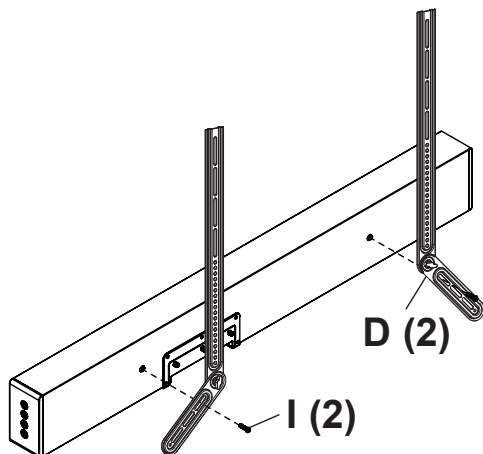
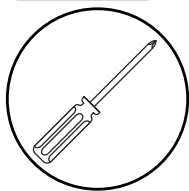

1c-2

Position display screen-side down on a flat, clean surface.
Position soundbar grill-side down below display. Attach
mount brackets as shown.



⚠ CAUTION

Must replace waterproof plugs for inputs
not being used to maintain IP rating and
uphold warranty.

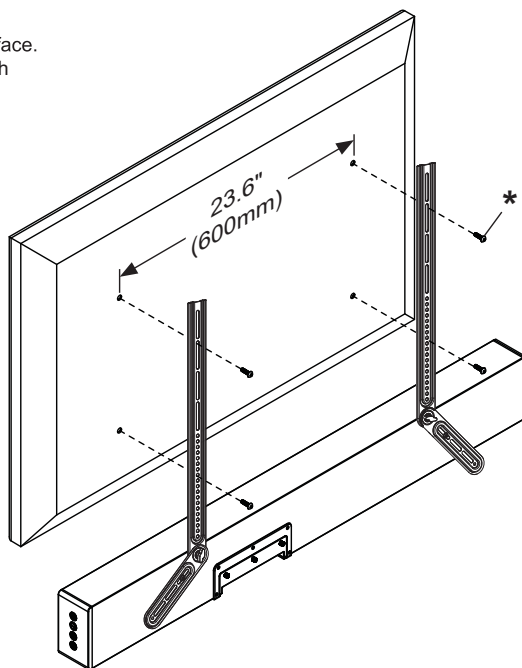

*Hardware included for installing soundbar only. To
attach display, use hardware included with display
mount.

Battery Installation and Replacement

1. Twist to the left to open the battery cover.
2. Install the CR2032 battery into the battery card slot in the rear housing. The positive pole faces up.
3. Twist to the right to fasten the battery cover.

⚠ CAUTION

Incorrect usage of batteries can result in leaks or bursting. Manufacturer recommends the following battery use:

1. Do not mix battery brands.
2. Do not combine new and old batteries. This can shorten the battery life or cause liquid leakage of the batteries.
3. Remove dead batteries immediately to prevent battery acid from leaking into the battery compartment.
4. Do not touch exposed battery acid as it may injure skin.
5. Remove the batteries if you do not intend to use the remote control for a long period of time.

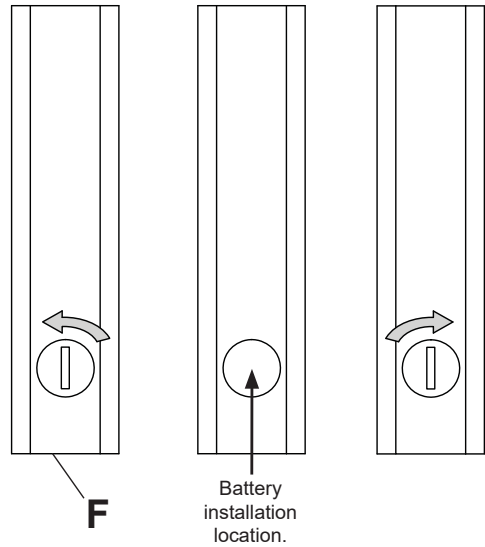

Cable Management and Soundbar Orientation

For Digital Connection:

- 1a. Connect the provided HDMI cable to the HDMI-ARC port on the TV and connect the other end of the HDMI cable to the ARC port of the Soundbar.
~OR~
- 1b. Plug the other end of the optical cable into the optical port on the soundbar. Make sure that there are no excessive bends or pinch points when connecting the optical cable.
2. Plug the soundbar's power cable into the nearest outlet.
3. **Note:** No interface is in use on the soundbar. Keep the interface dust plug closed.

For Analog Connection:

1. Connect the soundbar's AUX to the TV's earphone port on the TV using a 3.5mm audio cable.
2. Plug the soundbar's power cable into the nearest outlet.
3. **Note:** If the TV is an RCA interface, a male-to-male 3.5mm RCA stereo audio cable will be required.

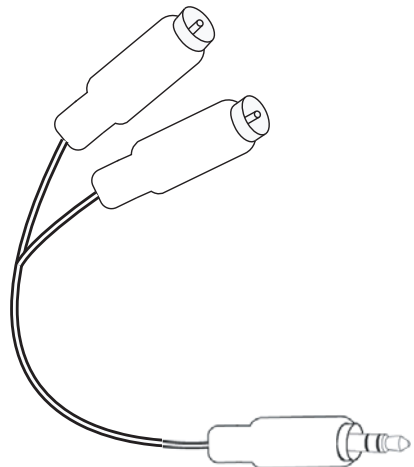

3.5mm male to male RCA stereo audio cable.

OPERATING INSTRUCTIONS

Using The Remote Control

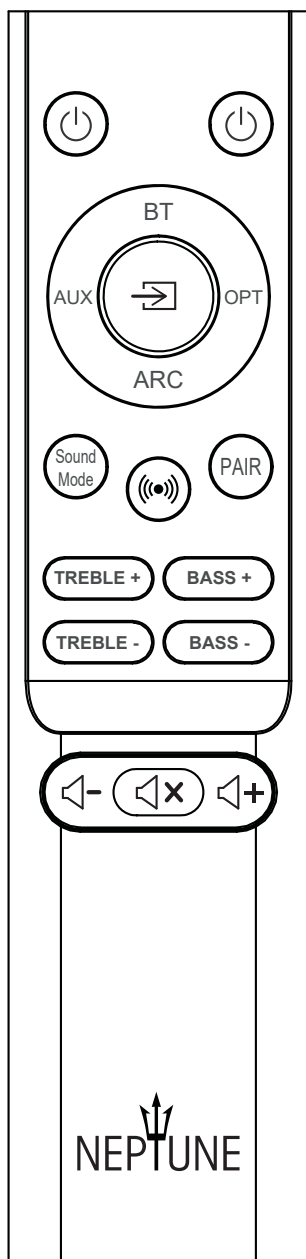

1. Turn on the TV.
2. Plug in the power cable and the soundbar will turn on automatically, in ARC mode by default, with "ARC" displayed in the lower right corner. Your soundbar will begin to play the audio coming from your display. If you don't hear any audio coming from the soundbar, check that ARC is enabled on the TV. To use a different source, select it's discrete button and it will appear in the lower right corner of the soundbar.
3. To listen to a Bluetooth® enabled device, press the BT button.
4. When the soundbar is switched to the Bluetooth input a "BT" will flash in the lower right corner on the soundbar. Make sure that Bluetooth function is enabled on the device that is being connected and that the device is within Bluetooth range (33'). Scan for devices on your Bluetooth enabled device and select "Neptune Soundbar" from the list of devices. Once the device is connected to the soundbar, "BT" will cease blinking and remain steady. Start playing content from your Bluetooth enabled device.

Remote control functions

- ⏻ (Green) – Powers the soundbar On
- ⏻ (Red) – Powers the soundbar Off
- BT - Bluetooth input
- AUX – 3.5mm AUX input
- OPT - Digital Audio input
- ➡ - Select input source via toggle
- ARC - HDMI ARC input
- Sound Mode - Select the sound scene mode (NEWS/MUSIC/MOVIES)
- Channel Mode - Dolby Digital / PCM Toggle
- PAIR - Connect/Disconnect the Bluetooth
- Mute – Toggles the mute on and off
- Bass - – Decreases the bass level
- Bass + – Increases the bass level
- Volume + – Increases the output level
- Volume - – Decreases the output level
- Treble - – Decreases the treble level
- Treble + – Increases the treble level

TIPS

Troubleshooting

Distorted Audio	<ul style="list-style-type: none"> • Verify source gain level is not exceeding unison. • Verify the the 3.5mm audio plug is fully inserted.
No Audio	<ul style="list-style-type: none"> • Verify that the soundbar is plugged into an outlet that has power. Ensure that the audio signal cable is connected to the audio-out port on the TV. Make sure that the source volume is not muted and that the volume level is not at zero. Aim the remote at the soundbar and select the desired input of the source that is playing. • Add enabling ARC audio output on TV if an HDMI connection is being used.
Problem Connecting a Bluetooth Enabled Device	<ul style="list-style-type: none"> • Aim the remote at the front of the soundbar and hit the Bluetooth icon. • Make sure Bluetooth is enabled on the device that is being connected and that it's within 33ft. of the soundbar. • Complete a device scan on the device that is being connected and select "Neptune-Soundbar" from the list of devices. • If "Neptune Soundbar" is not present on the list, turn the Bluetooth on the device off. Turn the Bluetooth on the soundbar off by switching to the AUX input. Turn the Bluetooth on the soundbar back on by pressing the Bluetooth button on the soundbar remote. Turn the Bluetooth on your device back on and perform another scan.

PRODUCT SPECIFICATIONS

Specifications subject to change without notice.

Sound Bar	
Product Description	3.0CH Soundbar
Power Consumption	75W
SPL	85db
Crossover	Digital Signal Processing (DSP)
Drivers	30W (x3)
Tweeters	15W (x3)
Input Voltage	100-240V ~ 50/60Hz
Audio Inputs	AUX, BT5.3, ARC, OPTICAL, USB (only update)
Frequency Response	70Hz - 20kHz
Product Dimensions	45" x 5.51" x 3.11" (1143 x 140 x 79mm)
Operating Temperature Range	-22° - 122°F (-30°C - 50°C)
Vesa Mounting Pattern	600mm wide pattern
Product Weight	12.79lb (5.8kg)



Manufactured under license from Dolby Laboratories.
Dolby, Dolby Audio, Pro Logic, and the double-D symbol
are trademarks of Dolby Laboratories Licensing Corporation.

ENG This page intentionally left blank.

ENG	Warranty	ESP	Garantía	FRN	Garantie	DEU	Garantie	NEL	Garantie
ITL	Garanzia	ČES	Záruka	SLK	Záruka	POR	Garantia	TÜR	Garanti

www.neptuneTV.com



Peerless-AV
2300 White Oak Circle
Aurora, IL 60502, USA
info@peerless-av.com

(800) 865-2112
(630) 375-5100

Peerless-AV Latin America
Av. de las Industrias 413
Parque Industrial Escobedo
General Escobedo N.L.,
México 66062

+52 (81) 8384-8300