



WMic-T1

FCC ID: 2AUZR-WMIC-T1

User Manual



Thank you for choosing Synco WMic-T1
Please read this manual carefully before use and follow all
instructions mentioned herein.

Contents

| | |
|---|---|
| ● Features Introduction..... | 1 |
| ● Caring For Your Synco WMic-T1 Microphone..... | 1 |
| ● Components Introduction..... | 2 |
| ● Package List..... | 3 |
| ● How to Install the Batteries..... | 4 |
| ● Indicator Light..... | 4 |
| ● Operation and Usage..... | 5 |
| ● Specification..... | 6 |

■ Features Introduction

- ① UHF wireless transmission, high-fidelity sound;
- ② Real-time noise reduction, ensuring a higher signal-to-noise ratio;
- ③ Compatible with smartphones, digital SLR cameras, camcorders, recorders, personal computers;
- ④ DSP(Digital signal processing) technology, minimizing noise in wireless transmission system;
- ⑤ 16 switchable channels for recording without environmental interference;
3-Pin XLR Connector
- ⑥ Adjustable volume;
- ⑦ Different status lights for real-time checking;
- ⑧ Both the receiver and transmitter are powered by two AA batteries;

■ Caring For Your Synco WMic-T1 Microphone

- ① Please keep the product in a dry, clean, dust-free environment.
- ② Keep corrosive chemicals, liquids and heat source away from the product to prevent mechanics damage.
- ③ Use only a soft and dry cloth for cleaning the product.
- ④ Malfunction may be caused by dropping, impact of external force.
- ⑤ Do not attempt to disassemble the product. Doing so voids warranty.
- ⑥ Please have the product checked or repaired by authorized technicians if any malfunctions happened.
- ⑦ Failure to follow all the instructions may result in mechanics damage.
- ⑧ Warranty does not apply to human errors.

Components Introduction

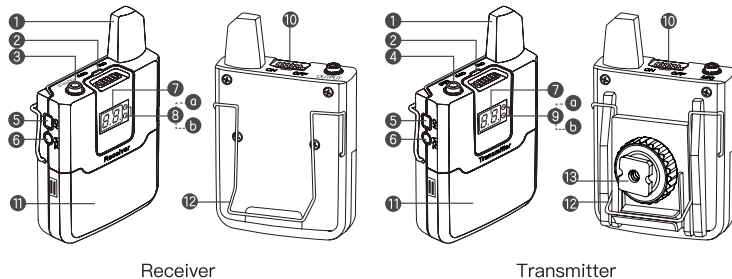

| | |
|---------------------------|-----------------------------|
| ① Antenna | ⑧ Receiving Status Light |
| ② Battery Indicator | ⑨ Transmitting Status Light |
| ③ 3.5mm Audio Output Port | ⑩ Power Button |
| ④ 3.5mm Mic Input Port | ⑪ Battery Cover |
| ⑤ Channel Button | ⑫ Belt Clip |
| ⑥ Volume Button | ⑬ Cold Shoe Adapter |
| ⑦ Screen Display | |

Package List



How to Install the Batteries?

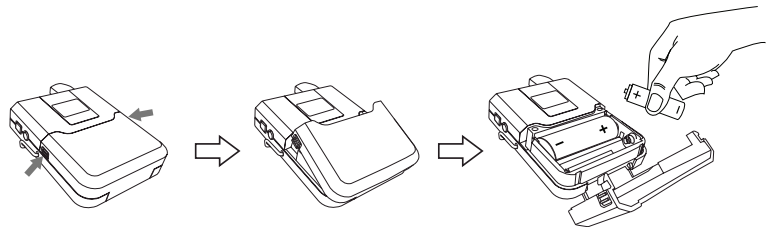

1. Battery Requirement: 2pcs * AA batteries
2. Press the two clips to open the receiver/transmitter battery cover
3. Insert two batteries according to the positive and negative electrode
4. Close the battery cover

Indicator Light

| | | |
|-------------------|----------------------|-------------------------|
| Audio | Red Light Keeps on | Normal Recording Status |
| | Red Light Flickers | Audio Distortion |
| IR/RF | Red Light Keeps on | Channel Matches |
| | Red Light Flickers | Channel Doesn't Match |
| | Green Light Flickers | Sound Input |
| Battery Indicator | Red Light Flickers | Low Battery Power |

Operation and Usage

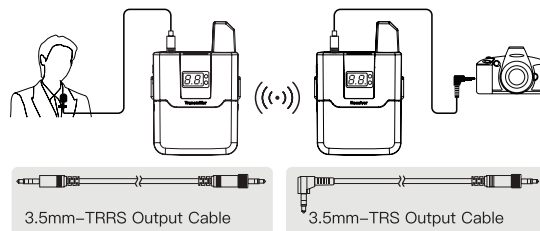

| Receiver | Transmitter |
|--|--|
| <ol style="list-style-type: none"> 1. Attach the cold shoe adapter to the receiver, and mount them on the camera/photographic equipment. 2. Plug one end of the 3.5mm audio cable into the receiver's "LINE OUT" socket and the other end into the camera's "MIC" interface. 3. Push the power button to turn on the device, and the battery light turns red. | <ol style="list-style-type: none"> 1. Insert the 3.5mm audio input cable into MIC socket of the transmitter 2. Push the power button to turn on the device, and the indicator light turns red. 3. Clip the receiver on your belt or put it in the pocket. |

- Long press "Channel" button, to change channel number.
- Press "Volume" button to adjust the sound volume.

Specification

Transmitter

| | |
|-----------------------------|-----------------------------|
| Channel | 16 |
| Frequency Range | UHF 570MHz-590MHz |
| Oscillation Mode | PLL Frequency Synthesis |
| Working Distance | ≥ 50m |
| Transmit Power | 13.5dBm |
| Carrier Frequency Error | 0.005% |
| SNR | >70dB |
| Harmonic Radiation | -32dBm |
| Modulation Mode | FSK |
| Maximum Frequency Deviation | ± 65KHz |
| Dynamic Range | 92 dB |
| Antenna | 1/4 Wavelength Wire Antenna |
| Maximum Input Level | 250mV |
| Input Impedance | 2.2KΩ |
| Input Gain Adjustment | 1-5 levels adjustable |
| Audio Output | 3.5mm |
| Battery | AA 1.5V x 2, 120mA |
| Dimensions | 96x60x18.8 (mm) |
| Net Weight | 55g (without battery) |
| Working Temp. | -10°C ~ +50°C |
| Storage Temp. | -20°C ~ 60°C |

Receiver

| | |
|--------------------|----------------------------------|
| Channel | 16 |
| Frequency Range | UHF 570MHz-590MHz |
| Oscillation Mode | PLL Frequency Synthesis |
| Receiving Mode | Superheterodyne |
| Working Distance | ≥ 50m |
| SNR | >70dB |
| Dynamic Range | 92 dB |
| Received Power | 13.5dBm |
| Image Rejection | 45dBm |
| Antenna | 1/4 Wavelength Wire Antenna |
| Noise Control | Built-in Setting Parameters |
| RF Sensitivity | When inputting 10dBu, S/N ≥ 45dB |
| Output Level Range | 1-5 levels adjustable |
| Frequency Setting | Manual IR Sync |
| Audio Output | 3.5mm |
| Output Impedance | 400Ω |
| Battery | AA 1.5V x 2 |
| Dimensions | 96x60x18.8 (mm) |
| Net Weight | 55g (without battery) |
| Working Temp. | -10°C ~ +50°C |
| Storage Temp. | -20°C ~ 60°C |

Guangzhou Zhiying Technology Co., Ltd



Block 15th, No.200 Fangcun Avenue East, Liwan District, Guangzhou,
China, 510000



support@syncoaudio.com



www.syncoaudio.com



<https://www.facebook.com/syncomicrophones>

FCC Warning

This device complies with part 15 of the FCC Rules. Operation is subject to the following two conditions:

(1) This device may not cause harmful interference, and (2) this device must accept any interference received, including interference that may cause undesired operation.

Any Changes or modifications not expressly approved by the party responsible for compliance could void the user's authority to operate the equipment.

Note: This equipment has been tested and found to comply with the limits for a Class B digital device, pursuant to part 15 of the FCC Rules. These limits are designed to provide reasonable protection against harmful interference in a residential installation. This equipment generates uses and can radiate radio frequency energy and, if not installed and used in accordance with the instructions, may cause harmful interference to radio communications. However, there is no guarantee that interference will not occur in a particular installation. If this equipment does cause harmful interference to radio or television reception, which can be determined by turning the equipment off and on, the user is encouraged to try to correct the interference by one or more of the following measures:

- Reorient or relocate the receiving antenna.
- Increase the separation between the equipment and receiver.
- Connect the equipment into an outlet on a circuit different from that to which the receiver is connected.
- Consult the dealer or an experienced radio/TV technician for help.

* RF warning for Portable device:

The device has been evaluated to meet general RF exposure requirement. The device can be used in portable exposure condition without restriction.