

Anti-Lost Device

User Manual



Thank you for choosing the smart anti-lost alarm based on BT 4.0.
Please read this manual carefully before use to avoid any damage caused by improperly.

Anti-Lost Alarm

Thank you for choosing this smart Anti-lost alarm product based BT Version 4.0 technology with the BT connection between the Anti-lost alarm device, which is tied to your valuable belongings or kids, and free mobile application installed on your phone, you can find your belongings or kids and etc. within effective range of the device.

This product uses CR2032 button battery easy to buy and replace the battery.

1.Product Overview



- 1.Button
- 2.Indicator
- 3.Speaker/hole for disassembling

2. Application

Avoid losing your valuable belongings, kids, pets or etc.
Remind you that your personal belongings in case you forget them.
Remind you once your important document is took away or out of certain range set by you.

3.Specifications

Size: 47*35*10mm
Weight: 8g
Battery type: CR2032 button battery
Battery warranty: \approx 6 months
BT: 4.0
Effective meters: \approx 12m
Anti-lost alarm effective range (\approx 20m)
Buzzer: \geq 80db
App Name: e-Tracker
Compatible operating systems: iOS 7.0 system or above and Android 4.3 system or above
Other functions: Take photo

4.Functions and Operations

4.1.Switch On/Off

Switch On: Press the button and hold for 3 secs until you hear the bell ringing and the indicator flash twice
Switch Off: Press the button and hold for 3 secs until you hear the bell ringing.

4.2.APP Installation

- a. Android System: Please search the " e-Tracker " in Google Play and install on your mobile phone.
- b. IOS System: Please search the " e-Tracker " in App Store and install on your mobile phone.
- c. Scan the QR code and download



IOS



Android (Googleplay)



Android (Myapp)

4.3.Connection

Turn on the APP "eTracker", it will connect with the Anti-lost Alarm device automatically:

- no icon: press the upper right button to research the device
📶 : it is lost connection with the device, please press the 📶

icon and connect again: 📶 : it is connect with the device successfully

4.4.Deletion

Slide the 📶 or yellow icon to the left or right side, it will be deleted successfully.

4.5.Anti-lost alarm setting

a.Anti-lost alarm: Connect with the smart phone through specified App software by BT connection; Putting the devices with the easy-lost & valuable belongings together; when your easy-lost & valuable belongings out of the distance, the devices will ring and light flash to alarm.

b.Finding belongings: In the state of connecting, press the button of the devices twice, your phone will alarm; press the 📶 button on the App, the devices will ring and light flash to find your belongings.

c.Canceling the Alert: Click the 📶 button, the devices stop ringing and flashing; click the blank space of the APP and the phone will stop to ring.

4.6.Photograph

Press the "Photograph", it will turn to camera mode, press the button to take photo.

4.7.Location

Locating list: To show where the Anti-lost alarm is;

Lost History: Record the site where your belongings lost before.

4.8.General setting

Map switch: Choose Google or Baidu map

Do Not Disturb Mode: Turn on the switch, the APP will not alarm even if lost connection with the Anti-lost Alarm device
Rename the APP:Users can change the name of the APP freely

5.Battery replacement

5.1 There is a disassemble place on the bottom of Anti-lost alarm, directly rear with a fingernail to remove and then replaced with new battery

5.2 Assemble

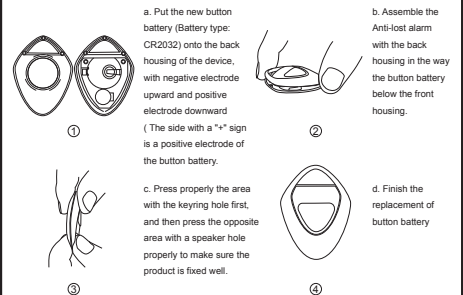

6.Accessories

Anti-lost alarm
User manual

7.FCC Statement

Changes or modifications not expressly approved by the party responsible for compliance could void the user's authority to operate the equipment.

This equipment has been tested and found to comply with the limits for a Class B digital device, pursuant to Part 15 of the FCC Rules. These limits are designed to provide reasonable protection against harmful interference in a residential installation. This equipment generates uses and can radiate radio frequency energy and, if not installed and used in accordance with the instructions, may cause harmful interference to radio communications. However, there is no guarantee that interference will not occur in a particular installation. If this equipment does cause harmful interference to radio or television reception, which can be determined by turning the equipment off and on, the user is encouraged to try to correct the interference by one or more of the following measures:

- Reorient or relocate the receiving antenna.
 - Increase the separation between the equipment and receiver.
 - Connect the equipment into an outlet on a circuit different from that to which the receiver is connected.
 - Consult the dealer or an experienced radio/TV technician for help
- This device complies with part 15 of the FCC rules. Operation is subject to the following two conditions (1) this device may not cause harmful interference, and (2) this device must accept any interference received, including interference that may cause undesired operation.