

**MINI PRINTER**  
Quick Start Guide  
(Ver.1.1)

## ■ Package



Printer



User Manual



Printing Paper



USB Cable

## ■ Product View

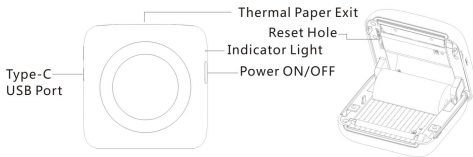

## ■ How to Use

### **Power ON/OFF**

Long press 2 seconds to Power ON/OFF

- Indicator light on: Normal running/ Full charged
- Indicator light flash quickly: Error running (Lack of paper, Low battery Indicator, Printing head overheating)
- Indicator light flash slowly :Charging

### **Charge**

Please plug the device into the USB cable and connect it to 5V $\overline{\text{---}}$ 1A adapter or the computer for charging before the first time.

- When the indicator light flashes quickly during charging, check if it means lack of paper, then load the printed paper to ensure normal charging.

\*The product is sold without a power adapter. In the user manual stated if consumers use a power adapter for power supply, they should buy a matching power adapter that has obtained CCC certification and meets the standard requirements.

## **Reset**

When the device does not respond, try to insert the pin/toothpick into the reset hole for 3 seconds and then release.

## ■ Download “iLabel” APP



User can scan below QR or search “iLabel” in APP Store/Google Play to download.



(Android 4.3 or above and iOS 9.0 or above)



After power on, double click the button to print QR code, scan the code to download “iLabel” APP.

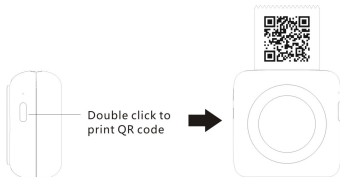

## ■ Connect to print

1. Turn on the phone Bluetooth and the APP, allows applications to gain access (photos, media, files etc) of the phone.
2. Then register and login in the APP, connect the device by scan the same QR code printed before.

## ■ Replace the Thermal Paper

1. Follow the arrow direction to slide and open the device.

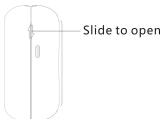

2. When replacing, insert the thermal paper. Please attention, the new thermal paper needs to expose the length of the paper 2cm, so that the machine can automatically absorb paper when loading the paper.

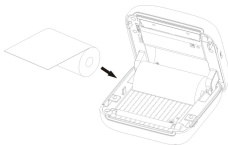

3. Cover the device.

※ **Do not touch the print head to avoid scalding when changing the printing paper after printing.**

## ■ Parameter

Product Dimension: 85\*85\*44mm

Print Type: Thermal Printing

Thermal Paper Specification: 57\*D30mm (Standard)

Capacity: 1000mAh Lithium Battery

Charging Time: About 2~3 Hours

Input: 5V=1A

Charging Port: Type-C

## ■ Safety Precautions



- This product is with built-in lithium battery, please do not use it higher than 40 °C, do not close to the fire and other sources of heat, do not placed in the hot sun.
- Do not remove, impinge, puncture or modify the battery. Do not use the battery for other purposes.
- Do not put the product in fire or water to avoid short circuit of the battery causing fire or burns.
- Please do not use this product in high humidity or dusty areas
- Please gently insert or unplug the charging cable to prevent excessive force from damaging the charging interface.

## ■ Frequently Asked Questions

Q: No connectable devices were found when adding devices?

A: When adding the device, please check whether the power of the device is enough to work.

**Q: The device can not print. How to do?**

A: ① Confirm whether the Bluetooth of the mobile phone is on, and exclude the possibility of others connecting to this device.

② Check whether the thermal paper has been used up, timely replacement of the printing paper.

③ Printing head is overheating, if overheating, please let the printing head cool before trying to print.

④ Restart the device, if still can not solve, please use the pin inserted into the reset hole for reset.

**Q: Why is it all white papers instead of content?**

A: It may be caused by the incorrect installation of the thermal paper. Please re-installation.

**Q: Why the printed getting lighter?**

- A: ① Check whether the device is low battery.  
② Check whether the printing head and wheel is covered with carbon ink, please wipe with alcohol softly.



**Q: Why does the adhesive paper fail to print out?**

- A: Please pull the adhesive paper out 2cm.

**FCC STATEMENT :**

This device complies with Part 15 of the FCC Rules. Operation is subject to the following two conditions:

- (1) This device may not cause harmful interference, and
- (2) This device must accept any interference received, including interference that may cause undesired operation.

Warning: Changes or modifications not expressly approved by the party responsible for compliance could void the user's authority to operate the equipment.

NOTE: This equipment has been tested and found to comply with the limits for a Class B digital device, pursuant to Part 15 of the FCC Rules. These limits are designed to provide reasonable protection against harmful interference in a residential installation. This equipment generates uses and can radiate radio frequency energy and, if not installed and used in accordance with the instructions, may cause harmful interference to radio communications. However, there is no guarantee that interference will not occur in a particular installation. If this equipment does cause harmful interference to radio or television reception, which can be determined by turning the equipment off and on, the user is encouraged to try to correct the interference by one or more of the following measures:

Reorient or relocate the receiving antenna.

Increase the separation between the equipment and receiver.

Connect the equipment into an outlet on a circuit different from that to which the receiver is connected.

Consult the dealer or an experienced radio/TV technician for help.

RF warning statement:

The device has been evaluated to meet general RF exposure requirement. The device can be used in portable exposure condition without restriction.