

LD0801英文说明书

单页尺寸:75mmX140mm

纸张材质:100g铜版纸

工艺:折页

A4 Portable Thermal Printer

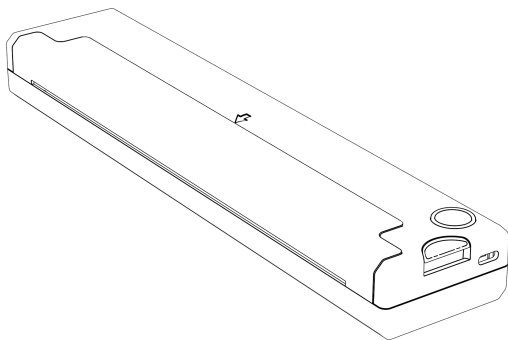

Scan the QR code to
get the latest e-manual.

1. Specifications

Product Name	A4 Portable Thermal Printer
Model Number	LD0801
Net Weight	475g / 16.8oz
Size	265*30.5*58mm 10.4*1.2*2.28 inches
Printing Width	210mm / 8.3 inches
Type	Thermal Print
Input Voltage	DC 5V/2A
Battery Capacity	1200mAh
Auto Shut Down Time	30 mins
Standby Time	About 30 days
Full Charge Time	75 mins
Resolution	203DPI
Charge Port	Type-C

2. Product Structure

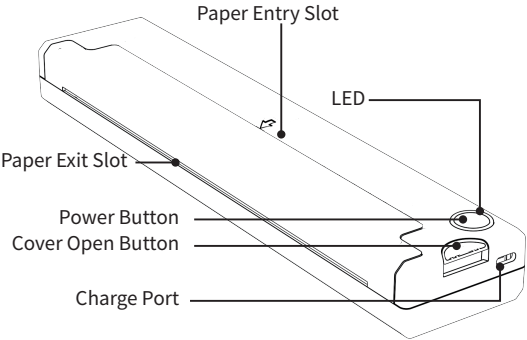

3. Packing List



Printer



USB Cable



Pouch

4. Power Button

① Turn On

In the turn off state, long touch the power button about 2 seconds and the printer will be turned up.

② Turn Off

In the turn on state, long touch power button about 2 seconds and the printer will be turned off.

5. Loading Media

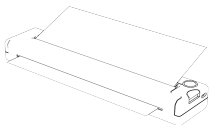
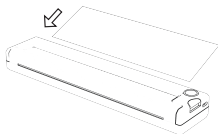

Put the paper into the paper entry slot in parallel. Printer will feed a distance automatically after it detects the paper. After the paper feeding stops, it means that the paper is loaded successfully and get ready if the printer sound once.

※ Please note that the content will be printed on the downward side. The side with black mark is the thermal paper side.

6. Removing Media

※ Don't pull the paper out forcefully while the printer cover is closed, or it may cause damage. Please remove the paper according to follow steps.

1. Press the open button, then lift the printer cover upward.
2. Remove media.

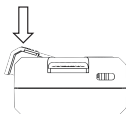
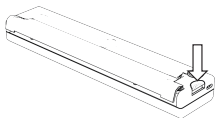

7. Download the App

The app is "iPrint", it's available for free on iOS and Android. Get started by downloading the app from the App Store and Google Play.

8. Mobile Phone Printing Operation

- ① Turn on the the printer;
- ② Open the APP;
- ③ Turn on the Bluetooth of your mobile;
- ④ Click **select equipment**, select PR88-XXXX;

The APP's most frequent features for the A4 printer are "**Photograph**" and "**Document Print.**" You can check the APP's other features on the mobile.

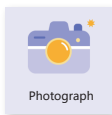

Photograph

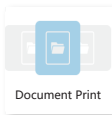

Document Print

9. Windows PC Printing Operation

- ① Download the driver, URL: https://bit.ly/LD0801_driver
- ② Unzip the file, the installation file name is **NEWYES A4 Printer LD0801 Windows Driver setup.exe**
- ③ Connect the printer with the computer by the Type C cable.
- ④ Double click the exe file.
- ⑤ Choose the port **USB001** to install.
- ⑥ Open the printing document then select the printer "**BNB B20**" to print the document.

10. Troubleshooting

Your printer is very reliable, but occasionally problems may occur. This chapter provides information on some

common problems you may encounter and how to solve them. If you encounter problems that you can not resolve, contact your dealer for assistance.

10.1 Printer Not Working

Problem Description	Problem Reason	Solution
LED not light, printer not working	Printer no power	Please use a special charging line to charge
	Printer consumables do not match	Please replace the consumables immediately and continue printing with the official consumables
	Circuit board damage	Contact with the dealer.

10.2 Troubles Occur During Printing

Problem Description	Problem Reason	Solution
Printing process stops printing	Battery power is too low.	Please charge the device.
Paper jam occurs during printing	When the paper is automatically fed, there is a deviation, resulting in paper jam.	Please open the cover, remove the jammed paper, and place the paper in parallel into the feed port.
Print font missing, with white lines.	Uneven paper	Please print with flat paper.
	You might print on the wrong side.	The side with black mark is the thermal paper side. And you should put it faced down.

The printer cannot automatically absorb paper.	The cover is not properly closed.	Please check that the cover is in place.
--	-----------------------------------	--

11. Important Safety Instructions

1. Water or other liquid should not spill into the printer, also the printer should not be exposed to the rain, or else may cause printer damage.
2. Do not open the printer cover while the printer is printing, otherwise the printer may work improperly.
3. Too high or too low temperature/relative humidity will lead to the decrease of print quality.
4. Do not store printing paper in high temperature or direct sunlight, please keep it in a place to avoid the light.
5. Be sure to use the specified battery and power charger provided by our company, do not disassemble the printer to replace the non-official battery, or may cause fire, explosion or damage to the printer.

12. One Year Warranty

The company's product warranty period is one year from the date it was delivered to you.

Our company only provides a limited warranty for the product's main components, not accessories during the product warranty period. If the product is damaged due to artificial damage (including but not limited to product production date identification or bar code being torn, altered, improper disassembly, modification, repair, dropping, and failing to operate as outlined in the instruction manual, etc.), no free warranty is provided. If the product fails during the warranty period, please contact the seller or NEWYES customer service staff to send it for repairs.

The company reserves the right to interpret this product's terms of service. For after-sales services, contact us at: **service@newyes.com**

FCC STATEMENT :

This device complies with Part 15 of the FCC Rules.

Operation is subject to the following two conditions:

(1) This device may not cause harmful interference, and

(2) This device must accept any interference received, including interference that may cause undesired operation.

Warning: Changes or modifications not expressly approved by the party responsible for compliance could void the user's authority to operate the equipment.

NOTE: This equipment has been tested and found to comply with the limits for a Class B digital device, pursuant to Part 15 of the FCC Rules. These limits are designed to provide reasonable protection against harmful interference in a residential installation. This equipment generates uses and can radiate radio frequency energy and, if not installed and used in accordance with the instructions, may cause harmful interference to radio communications. However, there is no guarantee that interference will not occur in a particular installation. If this equipment does cause harmful interference to radio or television reception, which can be determined by turning the equipment off and on, the user is encouraged to try to correct the interference by one or more of the following measures: Reorient or relocate the receiving antenna.

Increase the separation between the equipment and receiver.

Connect the equipment into an outlet on a circuit different from that to which the receiver is connected.

Consult the dealer or an experienced radio/TV technician for help.

FCC Radiation Exposure Statement:

This equipment complies with FCC radiation exposure limits set forth for an uncontrolled environment. This equipment should be installed and operated with minimum distance 20cm between the radiator & your body.