

# Smart Switch User Manual



Alexa TUTORIAL

Google Home TUTORIAL

## Notes Before Installation

- 1.Wi-Fi only support a 2.4GHz network (802.1 b/g/n)
- 2.Only support one way/single pole circuit, not compatible with 2-way.
- 3.With Neutral wire or without Neutral wire.
- 4.This product has no relay function.
- 5.Basic electrical wiring knowledge or experience is required , or please consult to a profesional electrician.pay attention to power-off installation.
- 6.ON/OFF button also can be used as reset button. Long press any key for 10 seconds to reset your smart switch to factory defaults only do this if you are sure you want to erase all your settings.

1

## Functional features:

- 1. Ultra-low power consumption. The power consumption of the switch itself is less than 0.05W
- 2. The switch has a timing function, which can be set to open or close at a certain time.
- 3. Power-on state setting function
  - (1) Power failure. The switch is always turned off when power is turned on after power failure.
  - (2) Power on, the switch is always on when power is turned on after power failure.
  - (3) Power-off memory: every time the power is cut off and then energized, the switch always remembers the state before the power is cut off.
- 4. Indicator light control function
  - (1) Turn off the indicator light. No matter whether the switch is on or off, the indicator light is off.
  - (2) The indicator light indicates the state of the switch. When the switch is turned on, the indicator light is turned off, and when the switch is turned off.
  - (3) The indicator light indicates the position. When the switch is turned on, the indicator light is turned off, and when the switch is turned off, the indicator light is turned on.
- 5. Multi-control correlation function.
- 6. Intelligent voice speaker control functions, such as Amazon speaker, Google speaker, etc.

2

## 1.Download App and Register

### 1.1 How to download App?

Scan the QR code below or search for "Smart Life" in the IOS APP store or Google play.



IOS & Android System

3

### 1.2 Setting Smart Life APP, How to Register and Login?

Download or Scan the QR Code and install Smart Life App. Once download or Scan the QR Code, register your account.

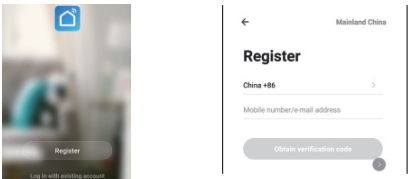

- 1.3 Enter your phone number or email which you prefer and select the country you live in.
- Obtain verification code. → Enter verification code.
- Set Password.

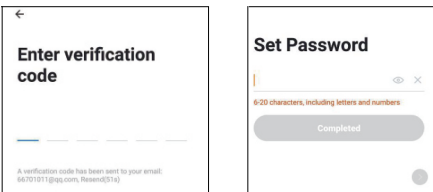

4

### 1.4 Create "Family"

Enter the family name and select the room. Family created sucessfully.

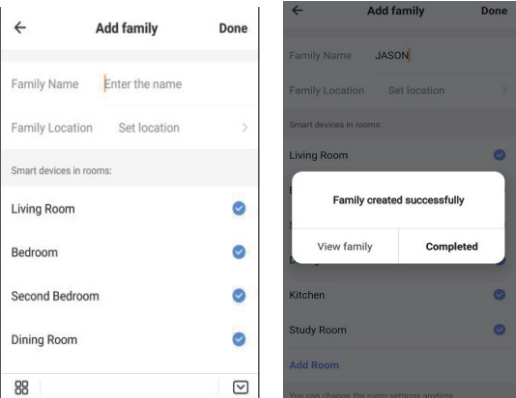

5

## 2. Wiring Diagram

Please select the wiring method according to the actual situation.

**Note:** Disconnect the power supply before wiring.

### 2.1 EU switch wiring method.

2.1.1 Neutral wire is required on the switch according to the following diagram wiring.

- 1-Neutral wire.
- 2-Live wire.
- 3-Switch.
- 4.5.6.7-Lighting,They're between L1,L2,L3,L4 and Neutral wire.

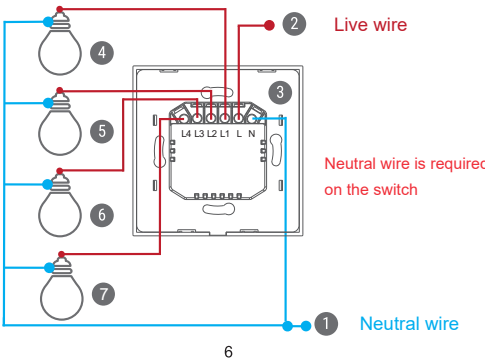

6

### 2.1.2 No neutral wire is required on the switch according to the following diagram wiring.

- 1-Neutral wire.
- 2-Live wire.
- 3-Switch.
- 4-Capacitor,it must to be connected to L1 and Neutral wire.
- 5.6.7.8-Lighting,They're between L1,L2,L3,L4 and Neutral wire.

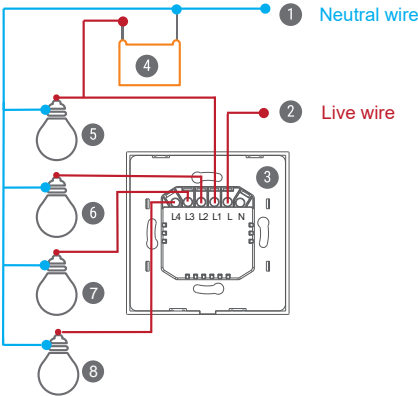

7

### 2.2 US touch switch wiring method.

2.2.1 Neutral wire is required on the switch according to the following diagram wiring.

- 1-Neutral wire.
- 2-Live wire.
- 3-Switch.
- 4.5.6.7-Lighting,They're between L1,L2,L3,L4 and Neutral wire.

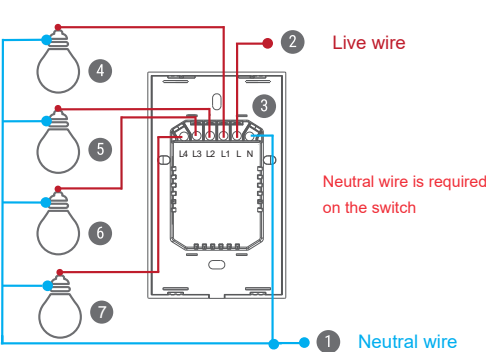

8

### 2.2.2 No neutral wire is required on the switch according to the following diagram wiring.

- 1-Neutral wire.
- 2-Live wire.
- 3-Switch.
- 4-Capacitor,it must to be connected to L1 and Neutral wire.
- 5.6.7.8-Lighting,They're between L1,L2,L3,L4 and Neutral wire.

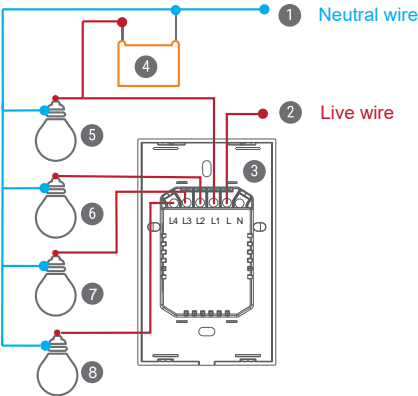

9

## 3. APP Pairing Switch

### Bluetooth Mode (Default Setting)

3.1 Please turn on your phone's Bluetooth and Wi-Fi.

3.2 Power on the switch.The switch indicator light will automatically enter the fast flashing status when it is powered on.

**Note:**

- a. If the switch is not connected to the APP for 3 minutes, the indicator will be always on.
- b. The indicator stops flashing, please long press the button for (about 10 seconds) until the indicator enters a flashing status.
- c. Whether the indicator light is flashing or slow flashing, Bluetooth pairing connection can be used.

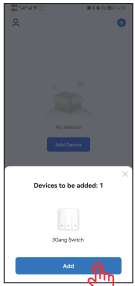

11

3.3 Open your smart life app, and a pop-up window named "device to be added:1" will pop up at the bottom, and click "Add".

**Note:**

If there is no pop-up window in the app interface, just restart the app.

3.4 Enter the WiFi account and password, click "NEXT" and wait for the connection to be completed, then click "Done" to complete the connection.

**Note:**

Wi-Fi only support a 2.4GHz network (802.1 b/g/n).

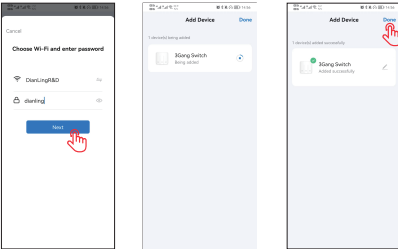

12

This device complies with part 15 of the FCC Rules. Operation is subject to the following two conditions: (1) This device may not cause harmful interference, and (2) this device must accept any interference received, including interference that may cause undesired operation.

Any Changes or modifications not expressly approved by the party responsible for compliance could void the user's authority to operate the equipment.

**Note:** This equipment has been tested and found to comply with the limits for a Class B digital device, pursuant to part 15 of the FCC Rules. These limits are designed to provide reasonable protection against harmful interference in a residential installation. This equipment generates uses and can radiate radio frequency energy and, if not installed and used in accordance with the instructions, may cause harmful interference to radio communications. However, there is no guarantee that interference will not occur in a particular installation. If this equipment does cause harmful interference to radio or television reception, which can be determined by turning the equipment off and on, the user is encouraged to try to correct the interference by one or more of the following measures:

- Reorient or relocate the receiving antenna.
- Increase the separation between the equipment and receiver.
- Connect the equipment into an outlet on a circuit different from that to which the receiver is connected.
- Consult the dealer or an experienced radio/TV technician for help.
- This equipment complies with FCC radiation exposure limits set forth for an uncontrolled environment. This equipment should be installed and operated with minimum distance 20cm between the radiator & your body.