Instruction Manual

SMART WIFI BULB

Thank you for purchasing our product

1 | BEFORE YOU BEGIN

Make sure your mobile device is running:

- iOS 8.1 & higher or
- Android 4.4 & higher

Verify your network and ensure your mobile device is connected to a:

- **2.4 GHz** WIFI channel



2 | DOWNLOAD THE SMARTLIFE APP

- App store
- Google Play
- QR Code (scan from next page)

SEARCH



OR

SCAN WITH YOUR PHONE



3 | REGISTER/LOGIN

- Launch the SMARTLIFE Application
- To register, enter your mobile phone number or email address
- Create a password and login to the App. or Login if you already have an account

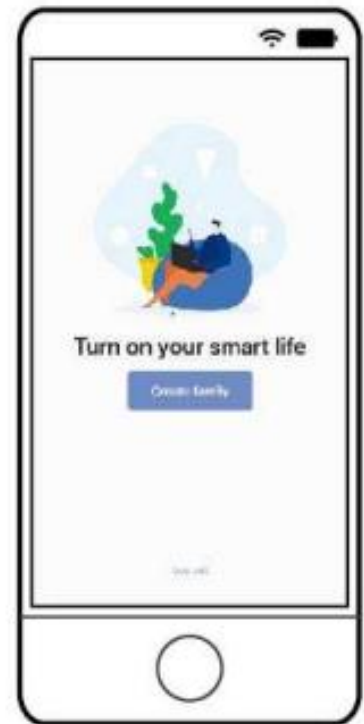

4 | SETUP YOUR PRODUCT

- Install your bulb
- Click on Add Device or "+"
- Select your product type
- Click on "CONFIRM" when bulb flashes rapidly
- Follow the instructions within the App.
- You're good to go!

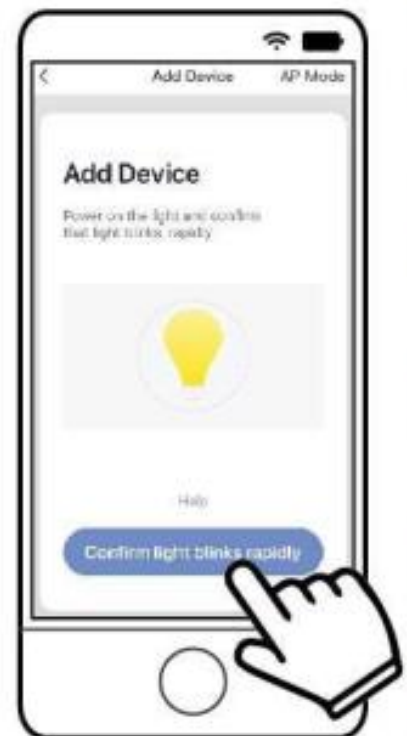
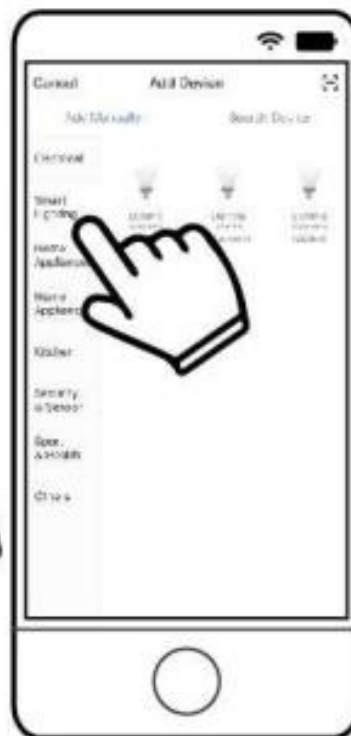
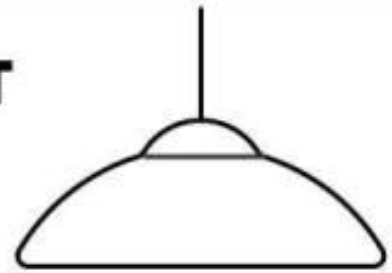

5 | RESET

In case your bulb is not flashing follow these steps

- Click on "HELP"
- Follow steps 1 to 3 until the bulb flashes

STEP 1: Power ON, wait 10 seconds before powering OFF

STEP 2: Keep turning ON/OFF repeatedly

STEP 3: Click on Confirm when bulb is flashing

- You're good to go!



6 | SETUP VOICE ASSISTANCE



- Open the Google home app
- Select "Home Control" from your menu
- Select "+" on the bottom right hand side
- Search for "SMARTLIFE"
- Follow the instructions to establish the link

THINGS YOU CAN SAY:

"Hey Google, turn the bedroom light(s) on"

"Hey Google, turn the kitchen light(s) off"

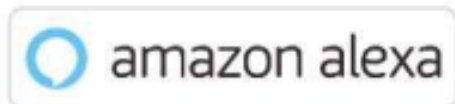

- Open the Amazon Alexa app
- Select "Skills" from your menu
- Search for "SMARTLIFE" and select "Enable"
- Follow the instructions to establish the link

THINGS YOU CAN SAY:

"Alexa, dim the living room light(s) to 50%"

"Alexa, turn the living room table lamp off"

FCC Notice:

This device complies with Part 15 of the FCC Rules. Operation is subject to the following two conditions:

- (1) This device may not cause harmful interference, and
- (2) This device must accept any interference received, including interference that may cause undesired operation.

Any Changes or modifications not expressly approved by the party responsible for compliance could void the user's authority to operate the equipment.

NOTE: This equipment has been tested and found to comply with the limits for a Class B digital device, pursuant to part 15 of the FCC Rules. These limits are designed to provide reasonable protection against harmful interference in a residential installation. This equipment generates, uses and can radiate radio frequency energy and, if not installed and used in accordance with the instructions, may cause harmful interference to radio communications. However, there is no guarantee that interference will not occur in a particular installation. If this equipment does cause harmful interference to radio or television reception, which can be determined by turning the equipment off and on, the user is encouraged to try to correct the interference by one or more of the following measures:

- Reorient or relocate the receiving antenna.
- Increase the separation between the equipment and receiver.
- Connect the equipment into an outlet on a circuit different from that to which the receiver is connected.
- Consult the dealer or an experienced radio/TV technician for help.

RF exposure warning

This equipment complies with FCC radiation exposure limits set forth for an uncontrolled environment. This equipment should be installed and operated with minimum distance 20cm between the radiator & your body.

IC Caution:

This device complies with Industry Canada licence-exempt RSS standard(s). Operation is subject to the following two conditions:

- (1) This device may not cause interference, and
- (2) This device must accept any interference, including interference that may cause undesired operation of the device.

Le présent appareil est conforme aux CNR d'Industrie Canada applicables aux appareils radio exempts de licence. L'exploitation est autorisée aux deux conditions suivantes:

- (1) l'appareil ne doit pas produire de brouillage, et
- (2) l'utilisateur de l'appareil doit accepter tout brouillage radioélectrique subi, même si le brouillage est susceptible d'en compromettre le fonctionnement.

RF exposure warning

This equipment complies with IC radiation exposure limits set forth for an uncontrolled environment. This equipment should be installed and operated with minimum distance 20cm between the radiator & your body.

Cet équipement est conforme aux limites d'exposition aux radiations de la IC définies pour un environnement non contrôlé. Cet équipement doit être installé et utilisé à une distance minimale de 20 cm entre le radiateur et votre corps.