EW1001

Product Instruction

Project No: EW1001

Description: Smart Writing Pad

Version: 01

Release Date: 2019-5-31

Document#: EW-PI-EW1001PT-01

	Responsible	Signature	Date
Issue By	Louis Dai		2019-5-31
Review By			
Approve By			

Update History

Ver	Revised Content	Effective Date	By
V1.0	First Release	2019.5.31	Louis

1. Product Description

Based on Passive EMR technology, Transforming the input and write of real handwriting into electronic data by using a matching electromagnet pen. Electronic data can be real-time transmitted to smart terminal devices such as mobile phones, PAD and so on through Low Energy Bluetooth, the smart writing board supports also offline notes, the offline writing data can be stored into flash memory in smart board, those writing data can be uploaded into mobile terminal devices after Smart board connected with mobile terminal devices by BLE. With large storage capacity, it can store up to 100 pages of offline notes data under specified writing condition, With CHLCD display screen, real-time display of writing notes, and the writing notes on CHLCD can be erased easy by keys on smart board or application SW, at the meanwhile, the notes can be kept on application SW but be erased on CHLCD, or all notes are erased on both of CHLCD and Application SW at simultaneously. The appearance of the product adopts a fashionable and concise style, whole product is packed in holster which is rich in scientific and technological sense, but also guarantees high reliability.

1.1 Appearance

1.1.1





**Operation Guide:**

1. Press and hold the Power Key over than 4S, the device will enter pairable state, the blue LED will fast blink;
2. Enable the BT connection on your phone, then open your Demo App installed on your mobile phone as below illustration:

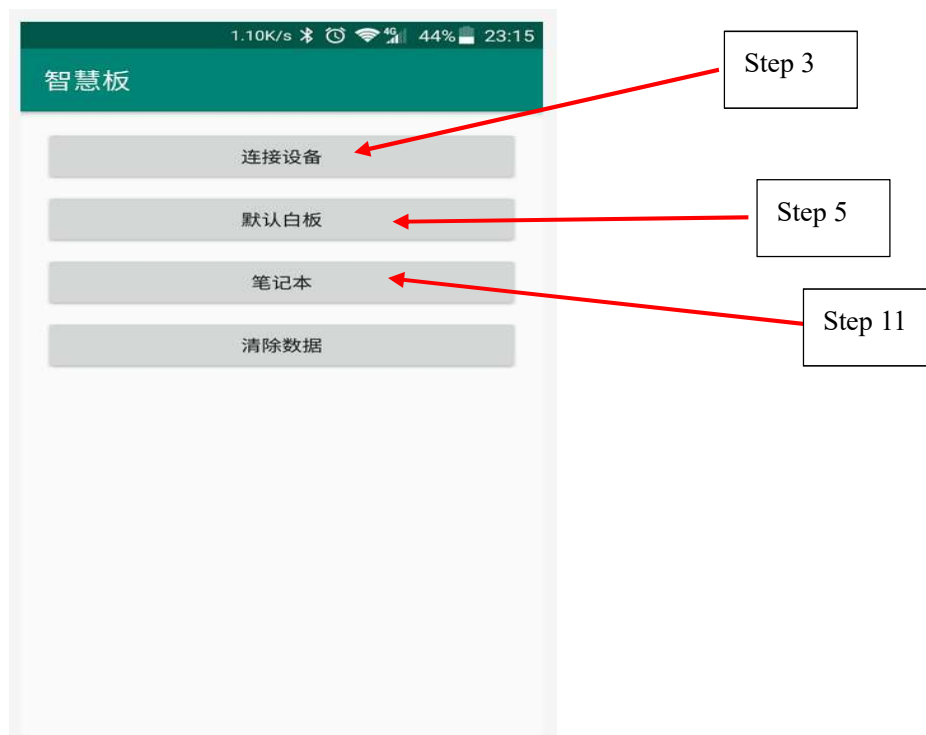

3. Click the "Connection Device" (连接设备) button, Demo App will automatically search pairable device and display the MAC ID of pairable device on the screen;
4. Click the MAC ID, and then the APP will automatically connect this device with your phone and show you the

device status after connection successfully;

5. Press the “back” button of your phone, return back to initial interface of APP, click the “default Canvas” (默认白板), APP switch to below screen, now you can start your drawing;

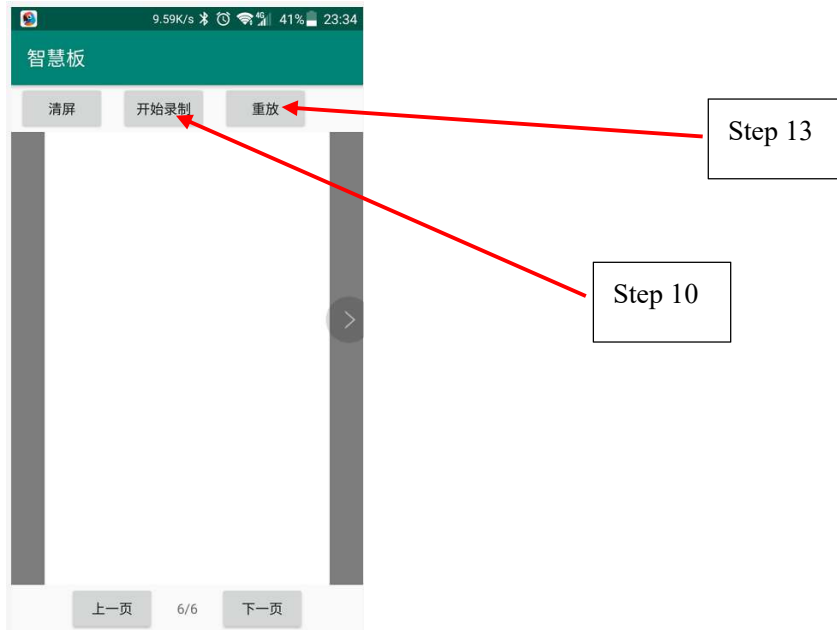

6. Press and hold the power key for 2S, the device will power on and the blue LED will slow blink;
7. Press and hold the power key for 2S under power on state, the device will power off and the red LED will flash once;
8. Erase Key
 - a) Power On State, Press this key, erase CHLCD display and all strokes on current page of APP canvas;
 - b) Power Off State, Press this key, erase CHLCD display;
9. Erase and Save Key
 - a) This is workable only under power on condition;
 - b) Power on and online state
Press this key, erase CHLCD display but keep all strokes on APP, and APP will create one new page;
 - c) Power On and offline state
Press this key, save offline notes and erase CHLCD display, Purple LED will flash that means offline notes are saved successfully;
10. Click the “Start Record” (开始录制) button, you can start to record one note with voice;
11. You can review your offline notes from here;
12. You can playback your “voice note” from this directory of your phone: /document management/phone/NotesVideo;
13. Click “Playback” button (重放), you can review the writing process of each stroke in details;

FCC Warning

This device complies with part 15 of the FCC Rules. Operation is subject to the following two conditions: (1) This device may not cause harmful interference, and (2) this device must accept any interference received, including interference that may cause undesired operation. Any Changes or modifications not expressly approved by the party responsible for compliance could void the user's authority to operate the equipment. This equipment has been tested and found to comply with the limits for a Class B digital device, pursuant to part 15 of the FCC Rules. These limits are designed to provide reasonable protection against harmful interference in a residential

installation. This equipment generates uses and can radiate radio frequency energy and, if not installed and used in accordance with the instructions, may cause harmful interference to radio communications. However, there is no guarantee that interference will not occur in a particular installation. If this equipment does cause harmful interference to radio or television reception, which can be determined by turning the equipment off and on, the user is encouraged to try to correct the interference by one or more of the following measures:

- Reorient or relocate the receiving antenna.
- Increase the separation between the equipment and receiver.
- Connect the equipment into an outlet on a circuit different from that to which the receiver is connected.
- Consult the dealer or an experienced radio/TV technician for help. The device has been evaluated to meet general RF exposure requirement. The device can be used in portable exposure condition without restriction.