

4G IoT Wireless Gateway (GW0300B) User Manual

Specification:

- Input Voltage: 9V~36VDC
- Rated current: 500mA/12V
- Cellular:
 - LTE FDD: B2, B4, B5, B12, B13, B14, B66, B71
 - WCDMA: B2, B4, B5
- Wi-Fi 801.11b/g/n; BLE4.2

Environment Requirements:

- Operating temperature: -10°C ~ 55°C
- Battery Charging Temperature: 0 ~ 45°C
- Battery Discharging Temperature: -20 ~ 60°C
- Battery Storage Temperature: -20 ~ 45°C (Storage period ≤ 3 months)
-10 ~ 25°C (3 months < Storage period ≤ 6 months)
- Relative Humidity: 95%, non-condensing

Dimension:

- 179mm × 121mm × 48mm

Interface Definition:

- PWR Interface

Interface	Pin Number	Pin Name	Description
PWR1	1	V+	Positive power supply, 9~36V
	2	V-	Negative power supply, ground
PWR2	1	V+	Positive power supply, 9~36V
	2	V-	Negative power supply, ground

- CAN Interface

Interface	Pin Number	Pin Name	I/O	Description
CAN	1	CAN-H	I/O	High-level CAN bus line
	2	CAN-L	I/O	Low-level CAN bus line
	3	RTN	-	Can ground loop

- RS422 Interface

Interface	Pin Number	Pin Name	I/O	Description
RS422	1	RX-A	I	Receive data positive
	2	RX-B	I	Receive data negative
	3	TX-A	O	Transmit data positive

	4	TX-B	O	Transmit data negative
--	---	------	---	------------------------

Filed Installation :

- Install the 4G antenna and Wi-Fi/BLE antenna on the gateway. The gateway is attached to the side of the control cabinet by four strong magnets or hang on the gateway bracket, and the antennas is attached to the top of the control cabinet.
- When the gateway is installed by four strong magnets, the installation height of gateway is less than 2m.
- The dimension of gateway bracket is as below.

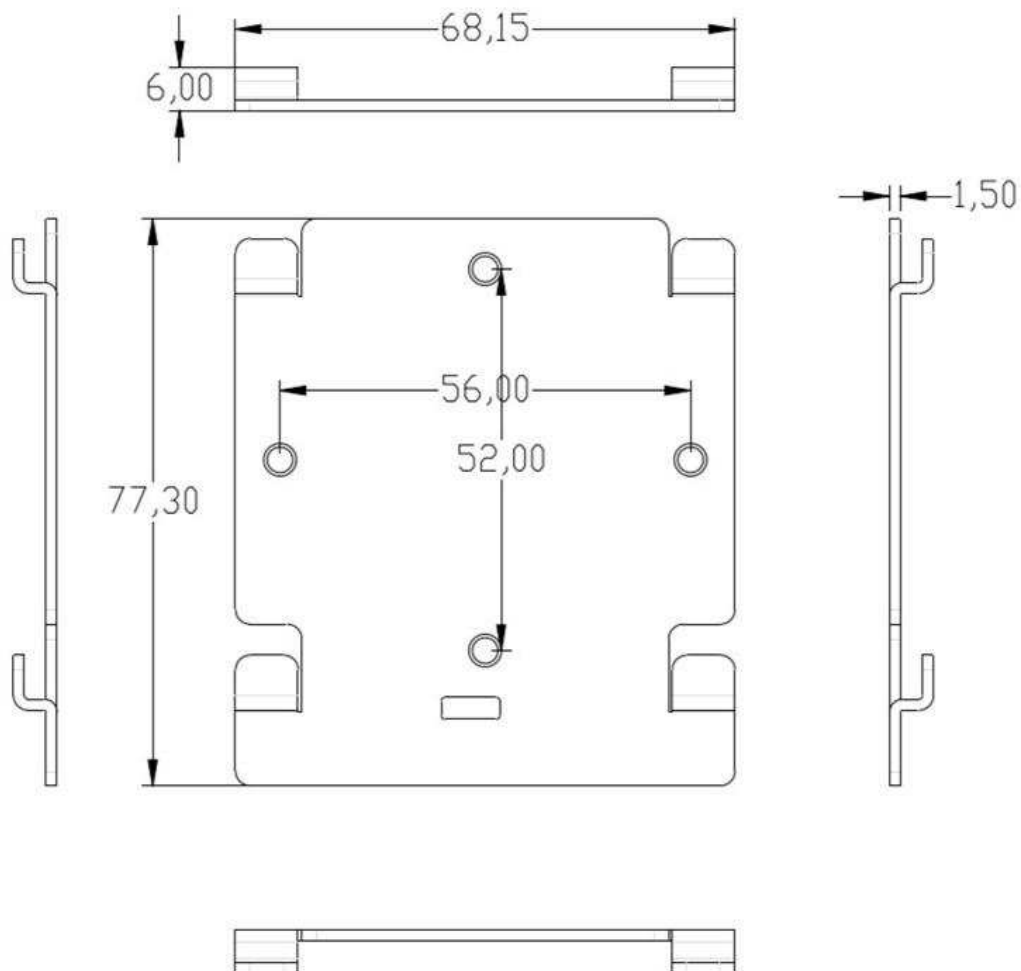

The bracket is fixed on the wall with 4pcs M3*18 countersunk head tapping screws and 4pcs M4*20 plastic expansion screw columns.

- Follow the Otis ONE system wiring diagram for wiring operations.

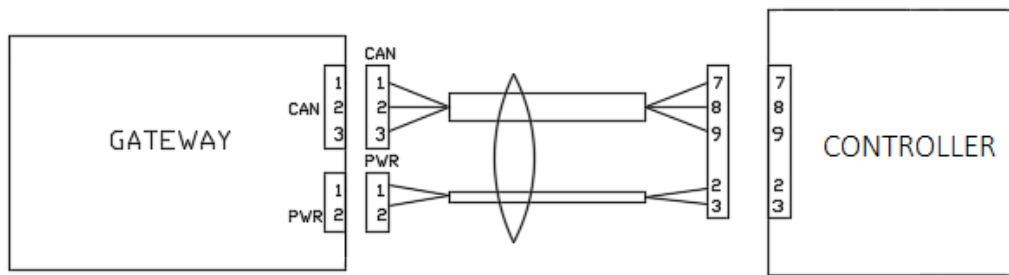

Commissioning Operation Instructions:

- Download “Smart SVT” APP.



- Log in, the machinist need to log in with their account.



- Enter the elevator unit ID in the unit search bar

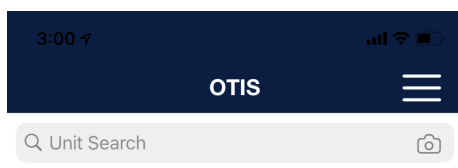

- Find and select the target elevator from the search results, then click the "Add Gateway" button.

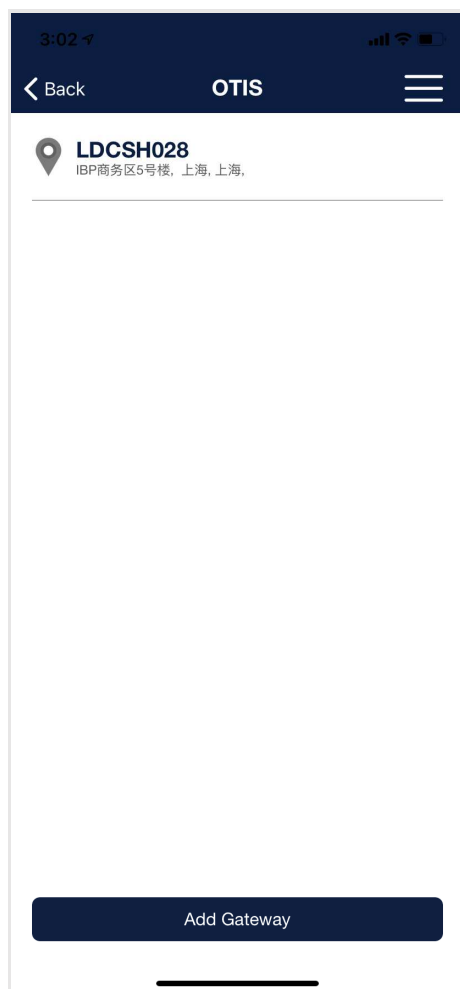

- Select commission interface type.

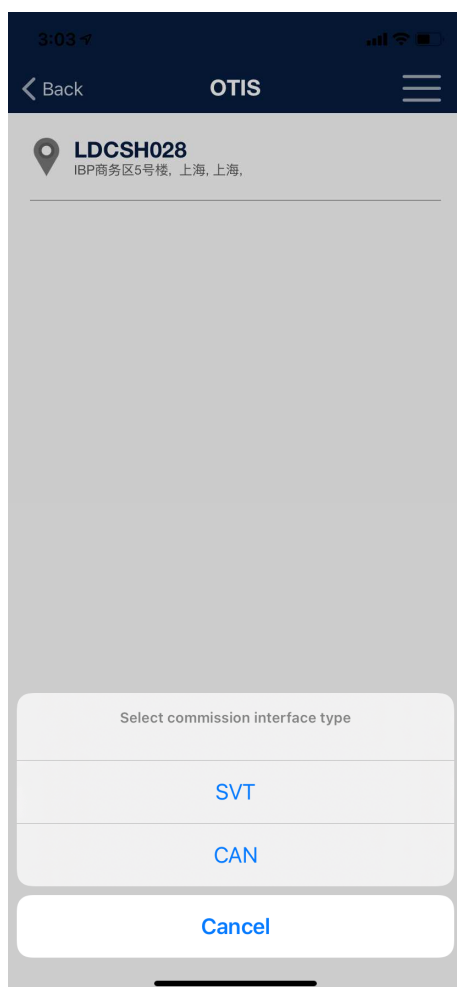

- Commission Gateway: Scan Gateway bar code on the front label of the gateway or manually enter the Serial Number, manually enter the elevator manufacturing date and GPS coordinates, then click the "Add Gateway" button.

The screenshot shows the 'Commission Gateway' screen of the OTIS mobile application. The interface is dark-themed with white text and icons. At the top, there is a status bar showing the time as 3:05 and signal indicators. Below the status bar, a navigation bar contains a back arrow, the text 'Back', the 'OTIS' logo, and a hamburger menu icon. The main title 'Commission Gateway' is displayed with an information icon to its right. The form consists of three input fields, each with a label and an icon to its right: 1. 'Scan Gateway bar code for Serial Number' with a camera icon, containing the text '10000000000009'. 2. 'Manufacturing Date' with a calendar icon, containing the text '2020-11-4'. 3. 'GPS Coordinates (lat, long)' with a location pin icon, containing the text '(31.23001, 121.35192)'. At the bottom of the form is a large blue button labeled 'Add Gateway'.

- Display the gateway commission status.

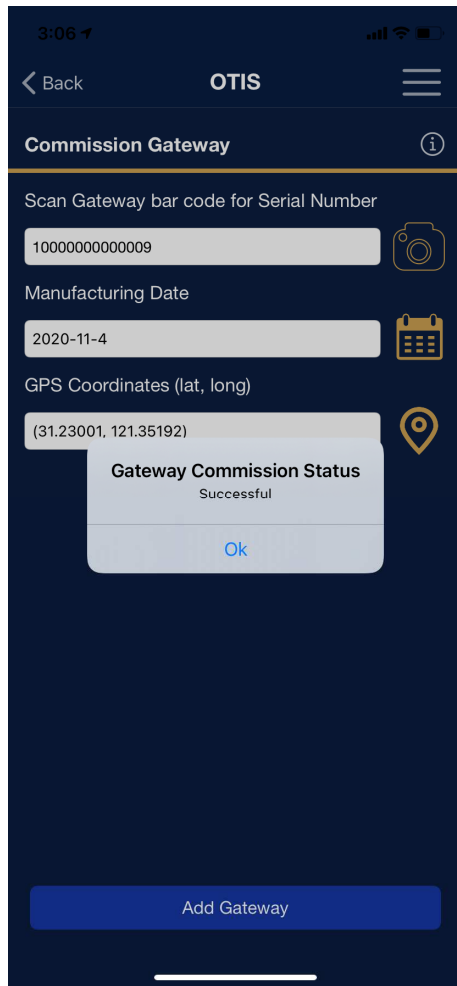

- View elevator and gateway details: gateway status, gateway and elevator connection status

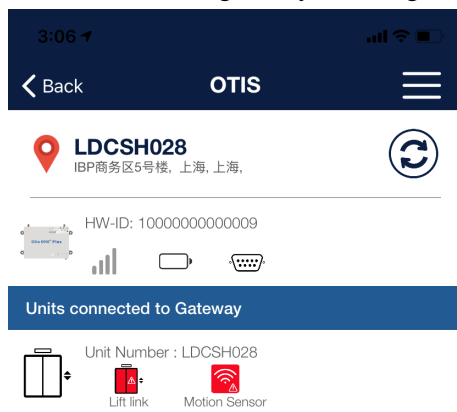

- If the gateway battery icon is green, and the gateway “DEV” LED is always on, it means the gateway configuration is successful. If the icon is gray, it means gateway configuration is failed, please reconfigure.
- The communication interface icon is displayed as SVT, which means gateway connected with and controller via RS422.
- If the lift link status icon is green, and the gateway “LINK” LED flashes, it means gateway and elevator connect successfully. If the icon is red, it means that the connection is failed.

Warnings:

§ 15.19 Labelling requirements.

This device complies with part 15 of the FCC Rules. Operation is subject to the following two conditions: (1) This device may not cause harmful interference, and (2) this device must accept any interference received, including interference that may cause undesired operation.

§ 15.21 Information to user.

Any Changes or modifications not expressly approved by the party responsible for compliance could void the user's authority to operate the equipment.

§ 15.105 Information to the user.

Note: This equipment has been tested and found to comply with the limits for a Class B digital device, pursuant to part 15 of the FCC Rules. These limits are designed to provide reasonable protection against harmful interference in a residential installation. This equipment generates uses and can radiate radio frequency energy and, if not installed and used in accordance with the instructions, may cause harmful interference to radio communications. However, there is no guarantee that interference will not occur in a particular installation. If this equipment does cause harmful interference to radio or television reception, which can be determined by turning the equipment off and on, the user is encouraged to try to correct the interference by one or more of the following measures:

- Reorient or relocate the receiving antenna.
- Increase the separation between the equipment and receiver.
- Connect the equipment into an outlet on a circuit different from that to which the receiver is connected.
- Consult the dealer or an experienced radio/TV technician for help.

*RF warning for Mobile device:

This equipment complies with FCC radiation exposure limits set forth for an uncontrolled environment. This equipment should be installed and operated with minimum distance 20cm between the radiator & your body.

Canada, ISED notice:

This device contains licence-exempt transmitter(s)/receiver(s) that comply with Innovation, Science and Economic Development Canada's licence-exempt RSS(s). Operation is subject to the following two conditions:

- (1) This device may not cause interference.
- (2) This device must accept any interference, including interference that may cause undesired operation of the device.

Canada, ISED avis:

L'émetteur/récepteur exempt de licence contenu dans le présent appareil est conforme aux CNR d'Innovation, Sciences et Développement économique Canada applicables aux appareils radio exempts de licence. L'exploitation est autorisée aux deux conditions suivantes :

- 1) L'appareil ne doit pas produire de brouillage;
- 2) L'appareil doit accepter tout brouillage radioélectrique subi, même si le brouillage est susceptible d'en compromettre le fonctionnement.

This device contains of certified module FCC ID: XMR201909EC25AFX and
IC No: 10224A-2019EC25AFX.