

*The safety solution designed just for kids
to give parents peace of mind.*



4G LTE Smartwatch for Kids

Page 1 (Front cover)

01 In the box

- WatchMeGo Smart Watch with pre-installed SIM card for Sprint 4G/LTE network
- Charging clip
- USB charging cable
- USB wall adapter
- Quick start guide
- Important information booklet

Page 2

02 Know your watch

Press and hold multi-function button for three seconds to power on the watch.



Page 3

03 Charging

Charge your WatchMeGo smartwatch before using. Use the wall adapter provided in the box with the charging clip as shown below.

Please note the watch will display a battery charging symbol when the clip has been attached properly and the watch is receiving a charge.



Page 4

04 Connecting

Step 1 - Download the app
Download the WatchMeGo app from Google Play Store or iOS App Store on your mobile phone.



Step 2 - Create a parent account
Open the app and click on "Register Now" to create your account. Provide your e-mail, phone number* and password and follow the instructions.

**the phone number will be used by the watch to communicate with the app on the parent's smartphone.*



Page 5

04 Connecting

Step 3 - Prepare the watch to pair with the WatchMeGo app
Power on the watch and confirm that it is activated and connected to the Sprint network.

Step 4 - Add the watch to the parent account.

Pair the watch with the app to add it to the parent account. The watch will display a QR code when it is ready to be paired. Use the app and follow the instructions to scan the QR code.



Page 6

05 Usage

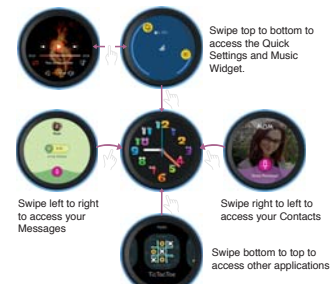

Page 7

06 How to change the watch face

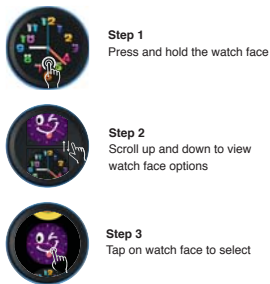

Page 8

07 SOS Function

Press the multi-function button three times to send an SOS alert.

The parent (guardian) receives an SOS alert in the app and a SMS with the current location of the watch.



Page 9

08 kidomi

kidomi Your purchase of WatchMeGo™ includes a FREE monthly subscription to kidomi the all-in-one super app for kids ages 3-13!

- Step 1**
Download the kidomi app from the Play Store or iOS App Store
- Step 2**
Create a parent account (make sure you select the "Sprint WatchMeGo" option)
- Step 3**
Setup a profile for your child(ren)
- Step 4**
Enjoy hundreds of games, activities, videos and more!

Page 10