

# Triton V1 User Guide

September 19, 2019

## Description

The Triton sensor is a positioning system for robots, it works by optically scanning the floor and recognizing features of that floor to determine its location.

## Intended use and restrictions

- The sensor is intended for use in indoor positioning of mobile robots.
- Do not use the sensor for critical applications which may pose a life- or injury-threatening risk or are highly likely to cause significant property damage in case of failure of the sensor. In addition, do not use the sensor in any weapon or military equipment.



Only use power supplies as prescribed, do not modify prescribed cabling in any way.



Do not expose the sensor to rain or wet conditions.



Do not look into the sensor window. The sensor uses invisible light that may cause damage with prolonged exposure.



The casing may become warm during operations, caution when handling during or shortly after operating. Especially in higher ambient temperatures.

## Installation

## Safety Prescriptions



Read all safety warnings and all instructions.



Ensure the sensor is installed by an electrically trained professional.



Be careful not to touch the bottom window of the sensor when unboxing. Keep the sensor window clean and avoid getting dust or dirt on it as much as possible.

- The Triton should be mounted on a plate parallel to the ground, at a height of 40 mm, measured from the bottom of the Triton casing to the ground. A viewing hole is nec-

essary, with recommended dimensions of 102x102mm and R20 rounded edges.

- Fasten the Triton with 4 M5 bolts to ensure good position, and for easy swap ability add two dowel pins.

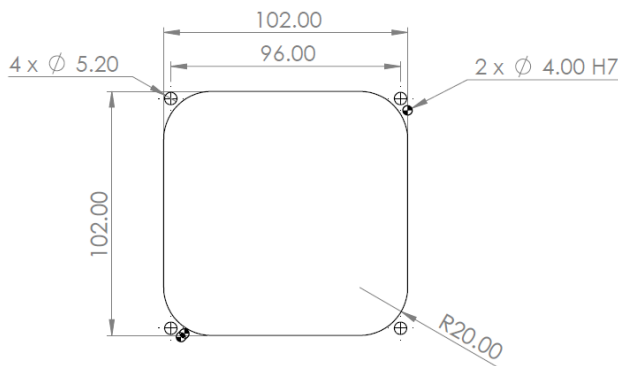

Figure 1: Mounting the sensor

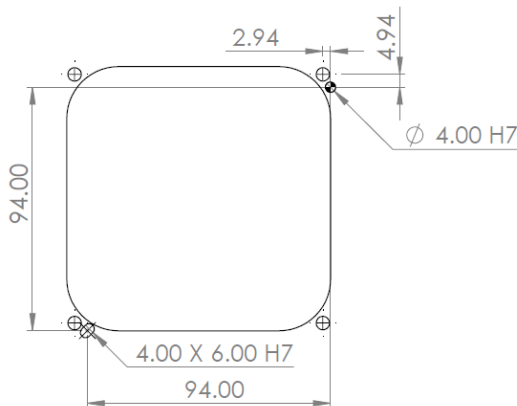

Figure 2: Adding dowel pins for accurate placement

- Connect power cable  
Port/connection  
Power usage, voltage, amp limit 10A

- Connecting ethernet cable

Port connection type

- Recommendations:

Mount as close as possible to the location where you want to know position

Mount at location where the sensor window will remain clean, e.g. do not mount close to the wheels of the AGV

## Operation

Connect your sensor to the ethernet (default IP address: 192.168.0.10) and connect to it with the Accerion control center user interface. Your sensor is now ready for use.

## Maintenance

- Keep the sensor window clean as much as possible.
- To clean the sensor window  
Remove dirt and dust with clean air  
Degrease with a clean lint free IPA wipe

## Dismantle and environment



The sensor, accessories and packaging should be sorted for eco-friendly recycling. Do not dispose in household waste.



The sensor is RoHS compliant.

be any date after the completion of the conformity assessment

## Declaration of Conformity

**Placeholder, needs to be replaced by actual text**

*The model declaration of Decision No 768/2008/EC contains:*

- *A product identification number. This number does not need to be unique to each product. It could refer to a product, batch, type or a serial number. This is left to the discretion of the manufacturer.*
- *The name and address of the manufacturer or the authorised representative issuing the Declaration;*
- *A statement that the Declaration is issued under the sole responsibility of the manufacturer.*
- *The identification of the product allowing traceability. This is basically any relevant information supplementary to point 1 describing the product and allowing for its traceability. It may where relevant for the identification of the product contain an image, but unless specified as a requirement in the Union harmonisation legislation this is left to the discretion of the manufacturer.*
- *All relevant EU legislation complied with; the referenced standards or other technical specifications (such as national technical standards and specifications) in a precise, complete and clearly defined way; this implies that the version and/or date of the relevant standard is specified.*
- *The name and identification number of the Notified Body when it has been involved in the conformity assessment procedure;*
- *All supplementary information that may be required (for example grade, category), if applicable;*
- *The date of issue of the Declaration; signature and title or an equivalent marking of authorised person; this could*

## FCC Notice

**Placeholder, needs to be replaced by actual text.**

This device complies with part 15 of the FCC Rules. Operation is subject to the following two conditions: (1) this device may not cause harmful interference, and (2) this device must accept any interference received, including interference that may cause undesired operation.

