

Let's start setting up your Etcher Laser. Please refer to the pictures below for the name of each part.

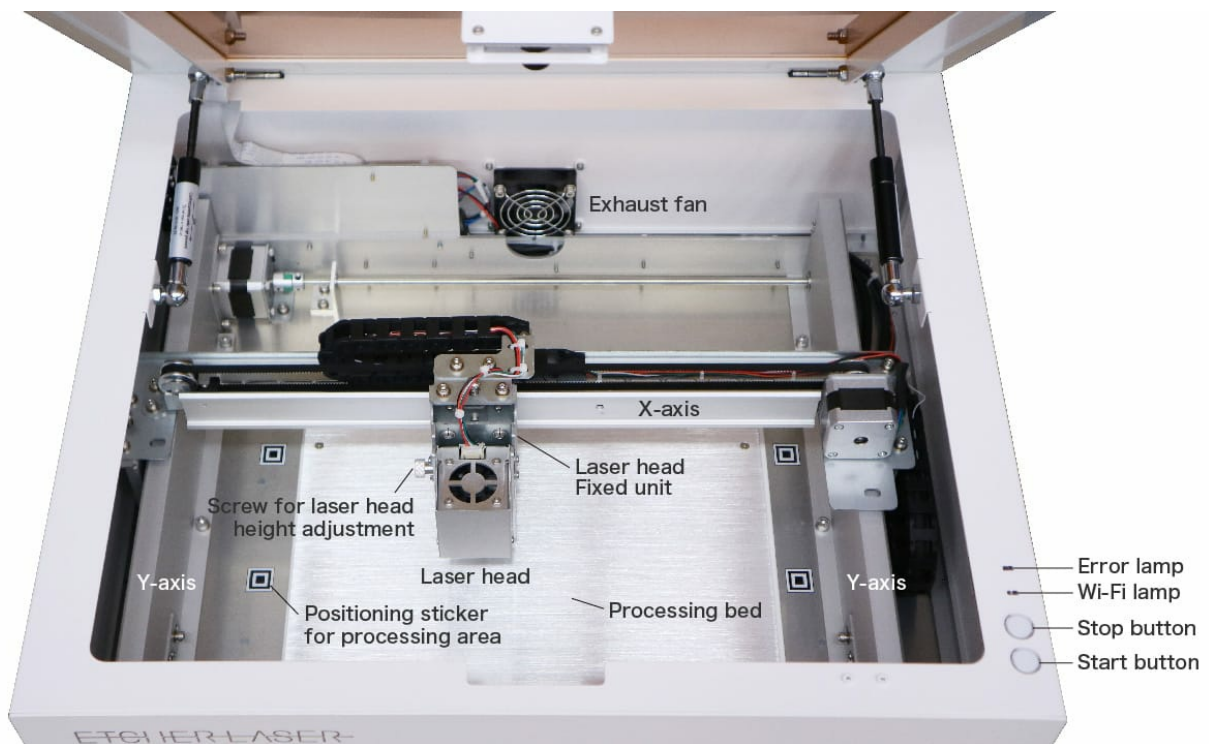

Unpacking and setting up the device

There will be one box for the main device and 1 - 3 boxes for accessories (optional).



Open the box of the Etcher Laser's main device. Remove the packing material on top and you will see the main unit.



Carefully remove the device from the box and place it on a flat and level surface. Please make sure that nothing is blocking the exhaust fan on the back side of the device and keep the main unit at least 7inch away from anything behind the device (walls, etc.).



Take out the AC Cable, USB Cable, and AC Adapter from the bottom packing material in the box.

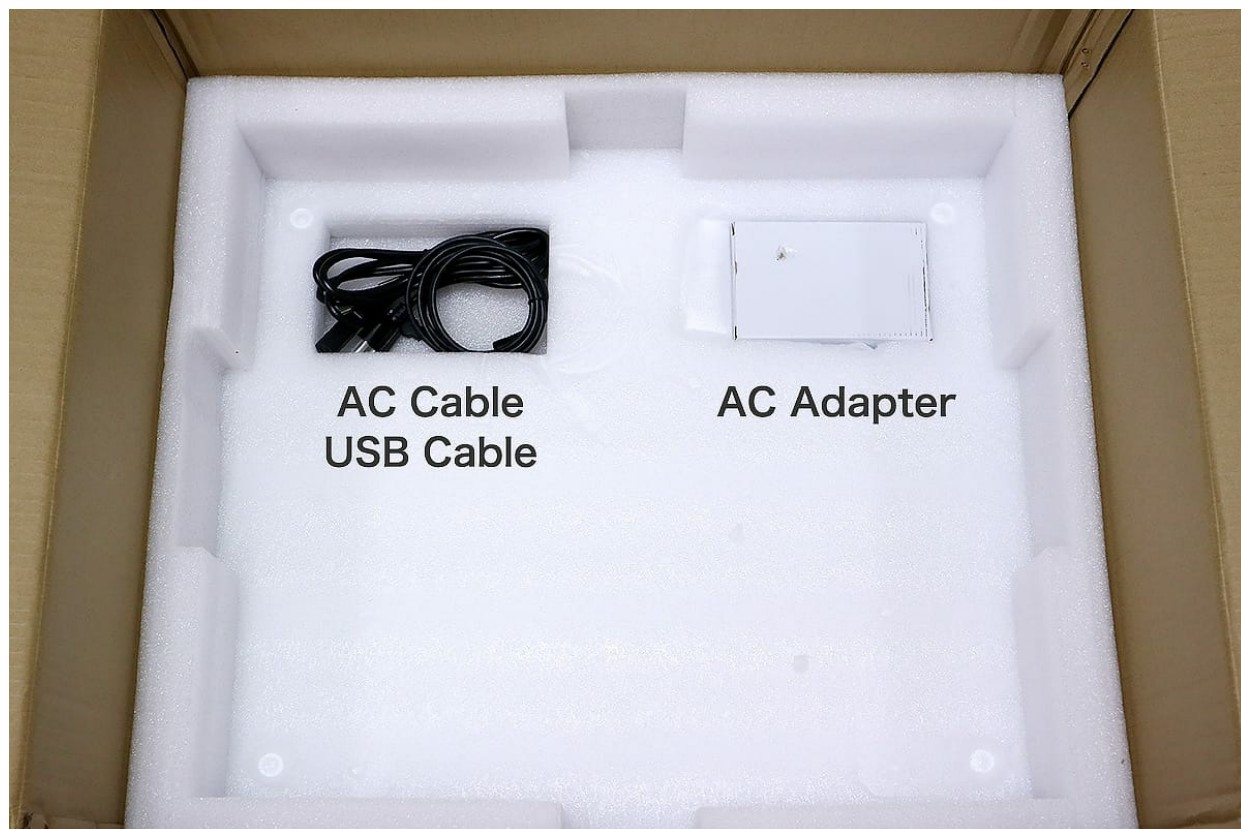

Remove the tape that is sealing the lid and the bottom cover of the Etcher Laser (4 pieces).

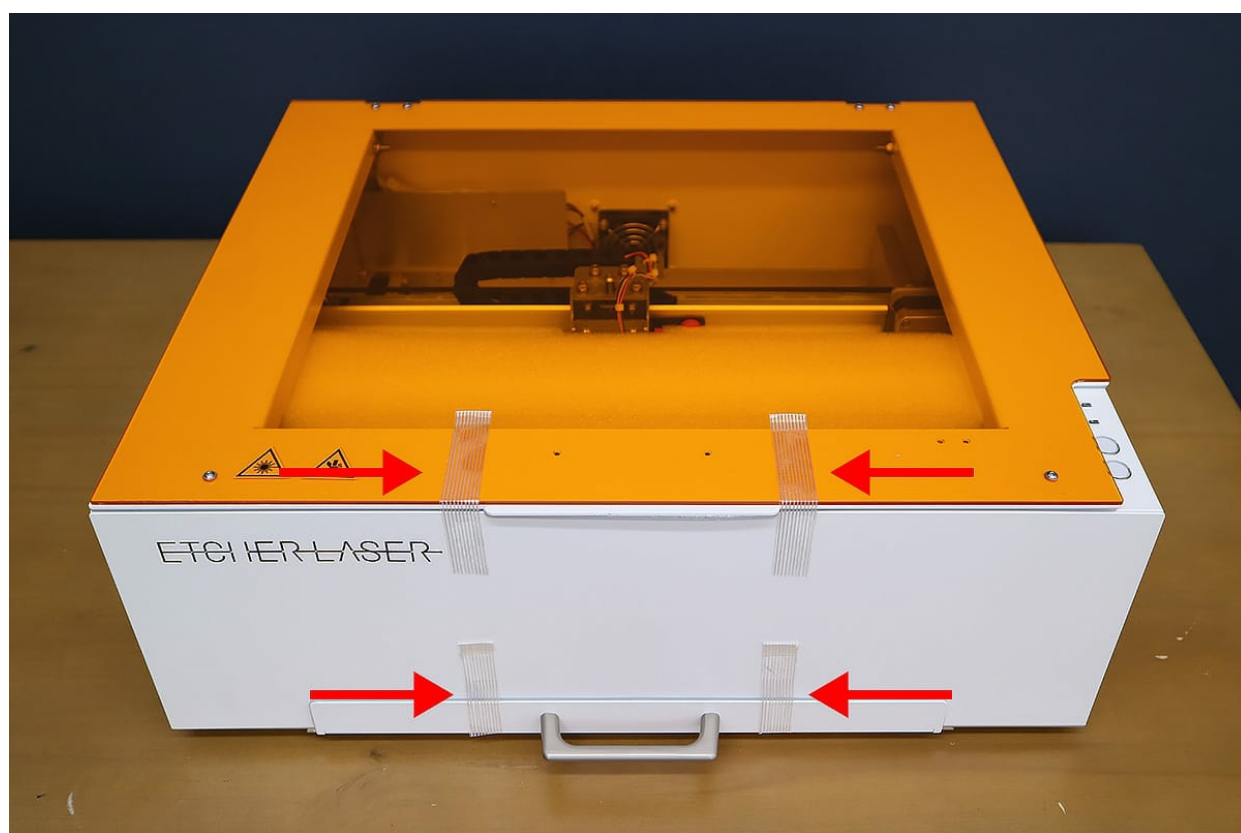

Open the lid of the Etcher Laser and remove all the packing material inside the device. Please

be careful to not damage the parts inside the packing material.

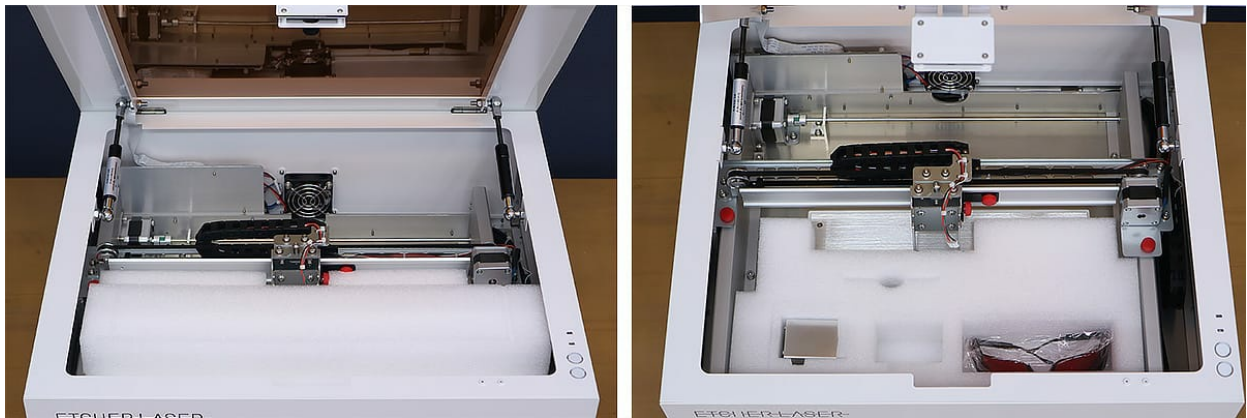

Remove the screws and plate that are holding the frames in place. There are 2 red screws on the X-axis (on the black plate) and 2 red screws on the Y-axis (right and left sides).

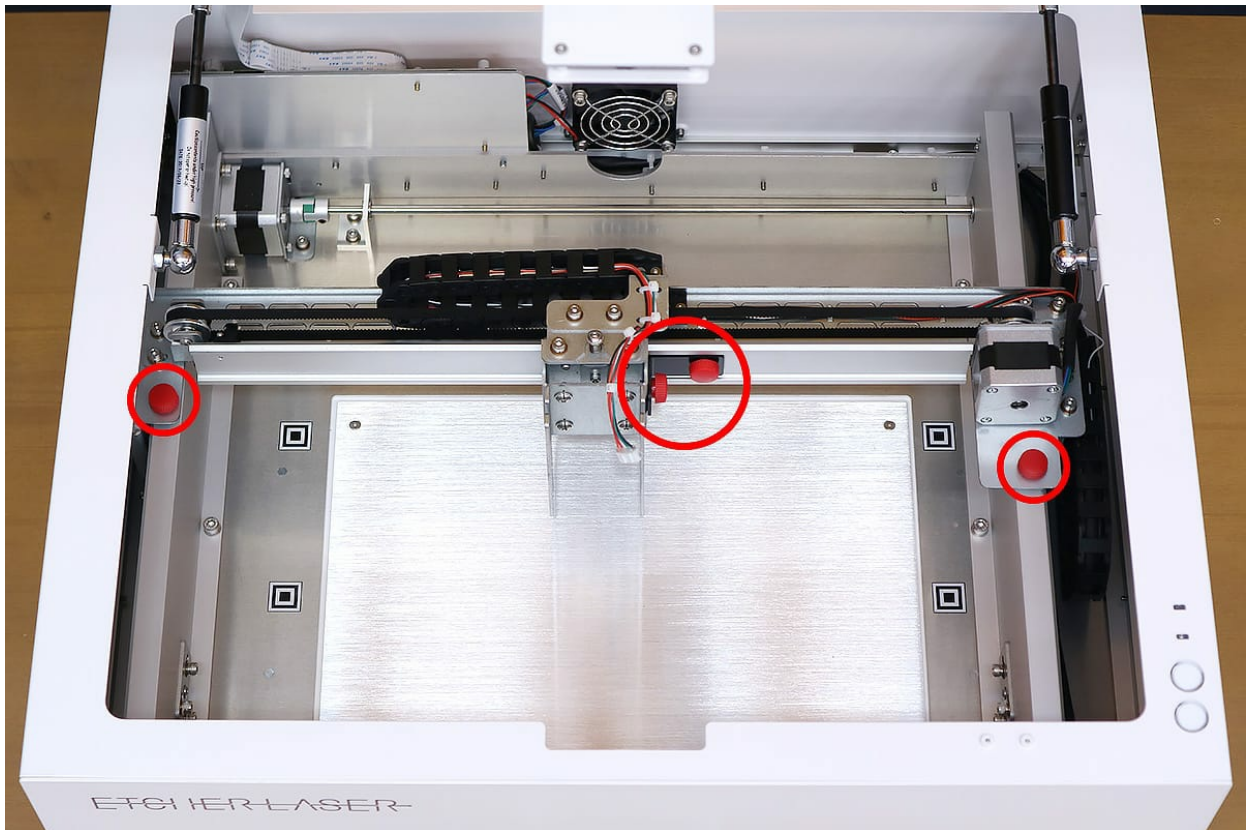

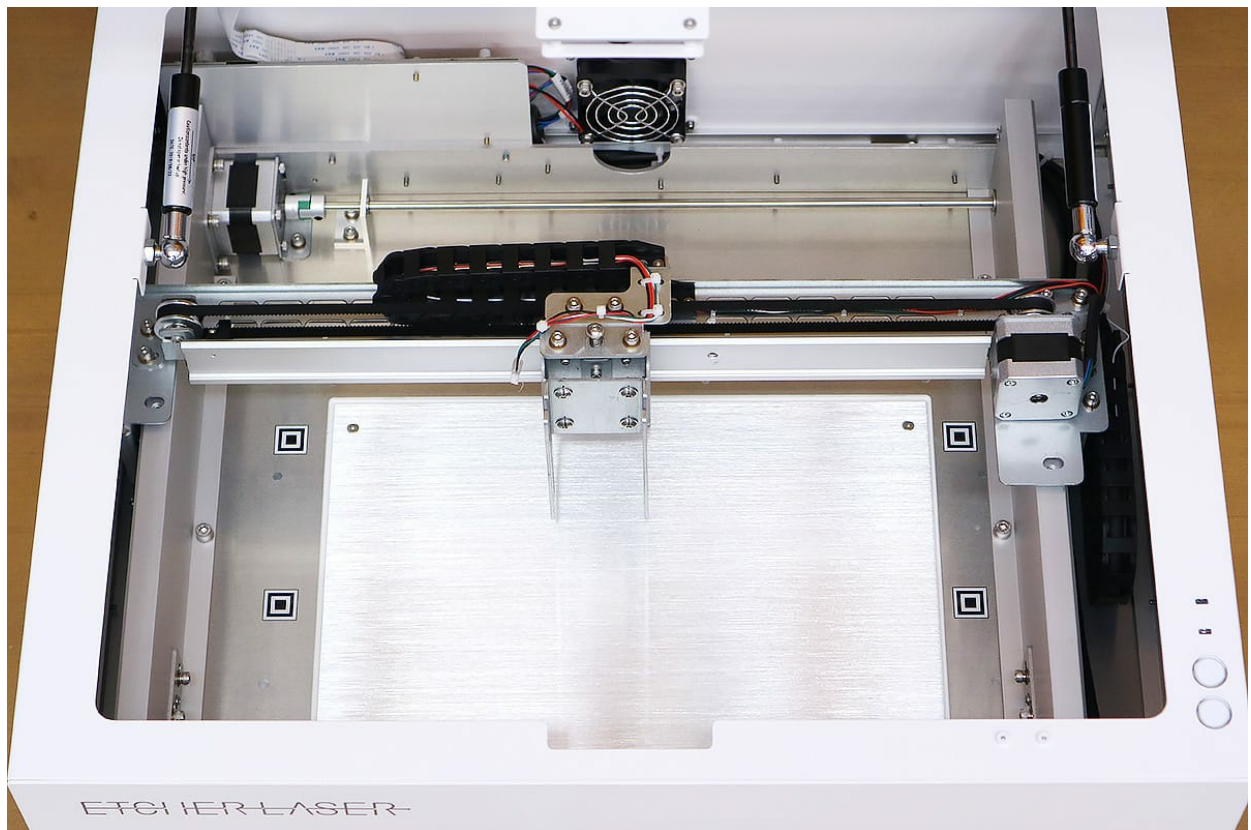

Take out the laser head from the packing material. DO NOT touch the lens on the bottom of the laser head when taking it out.

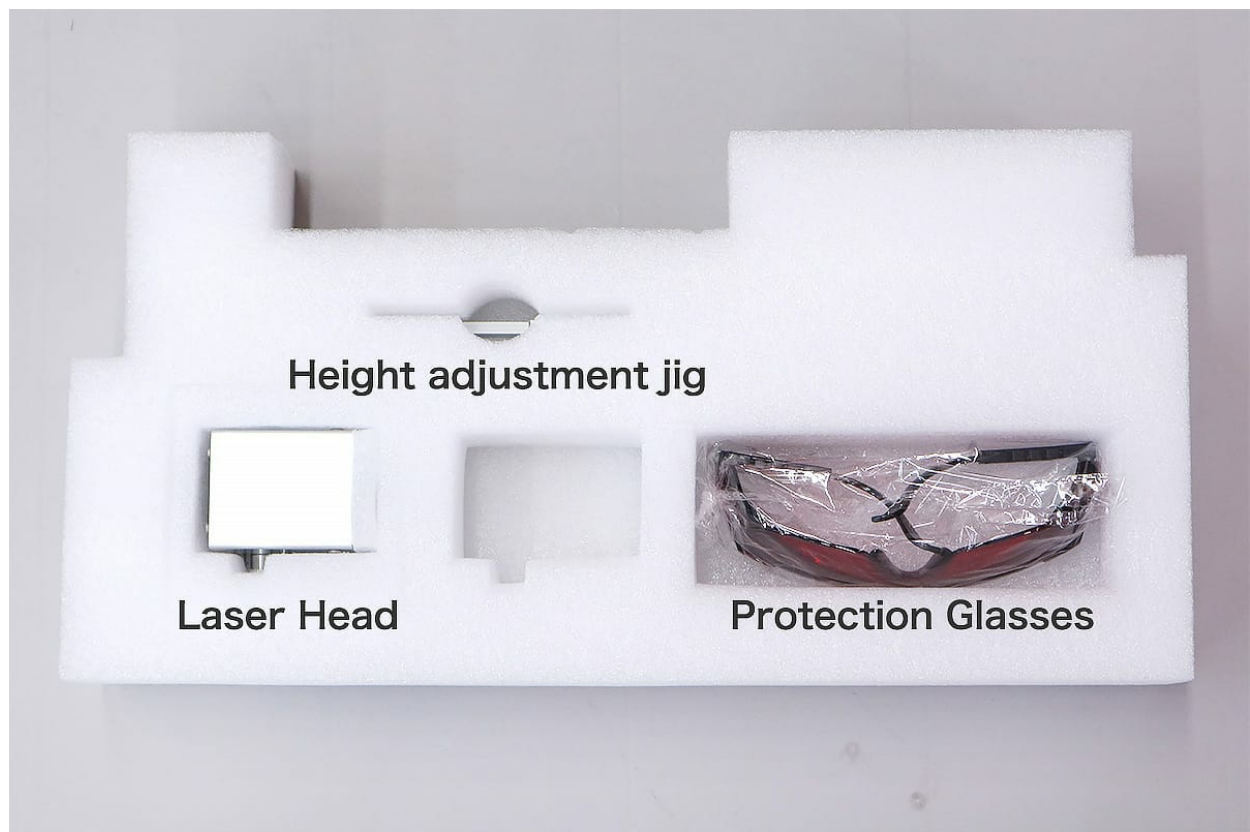

Loosen the screw for laser head height adjustment located on the left side of the laser head. Loosen it until the distance between the laser head and the screw is approximately 2mm.

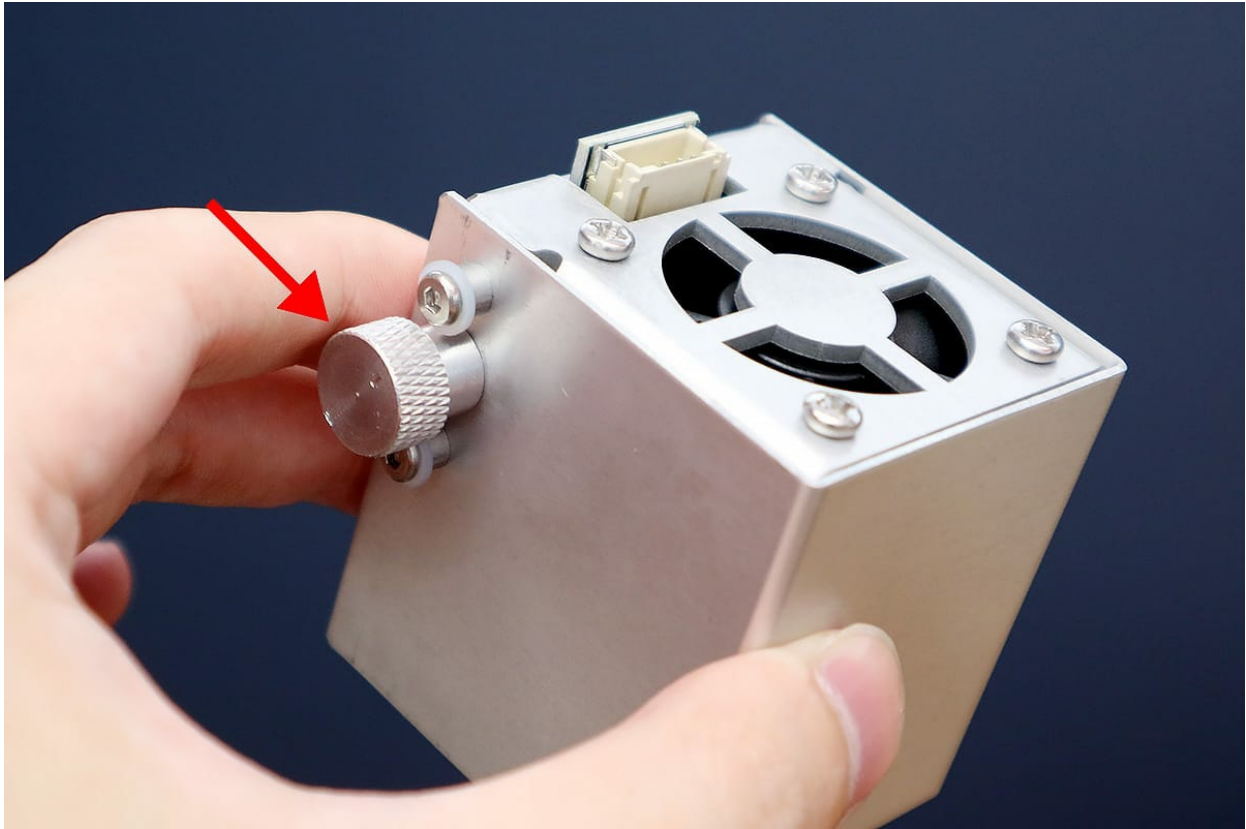

Slide the laser head from the top to the bottom of the Laser Head Fixing Unit on the X-axis, and set the position firmly by tightening the screw for height adjustment.

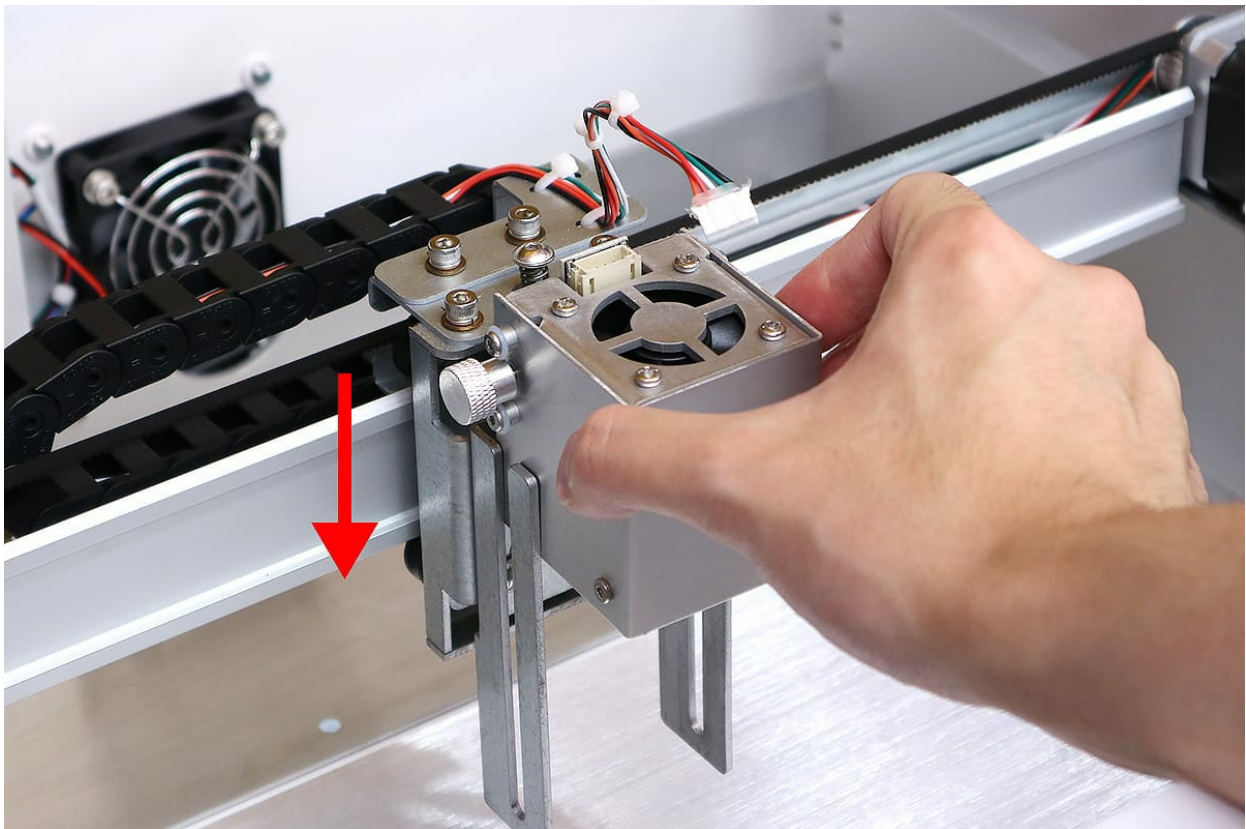

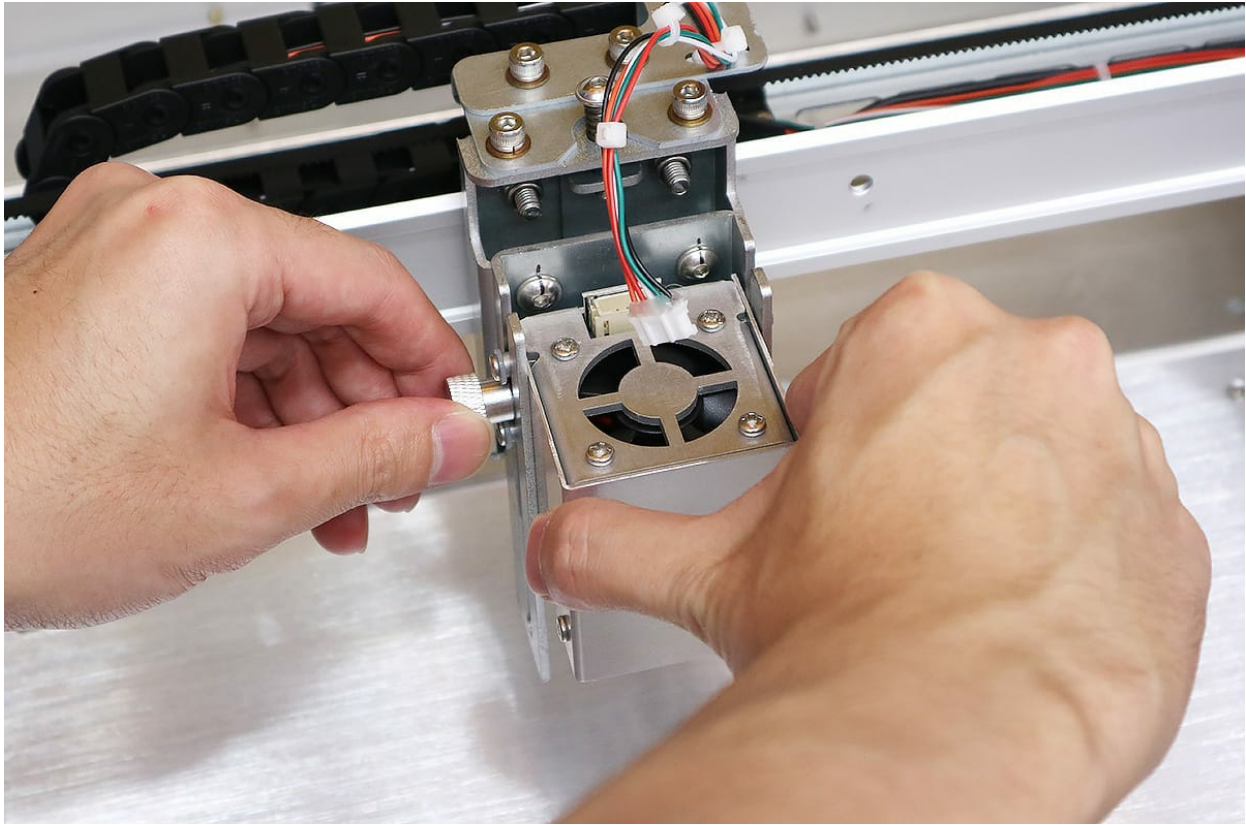

Connect the connector part of the laser head fixing unit to the terminal part of the laser head. Insert the connector firmly.

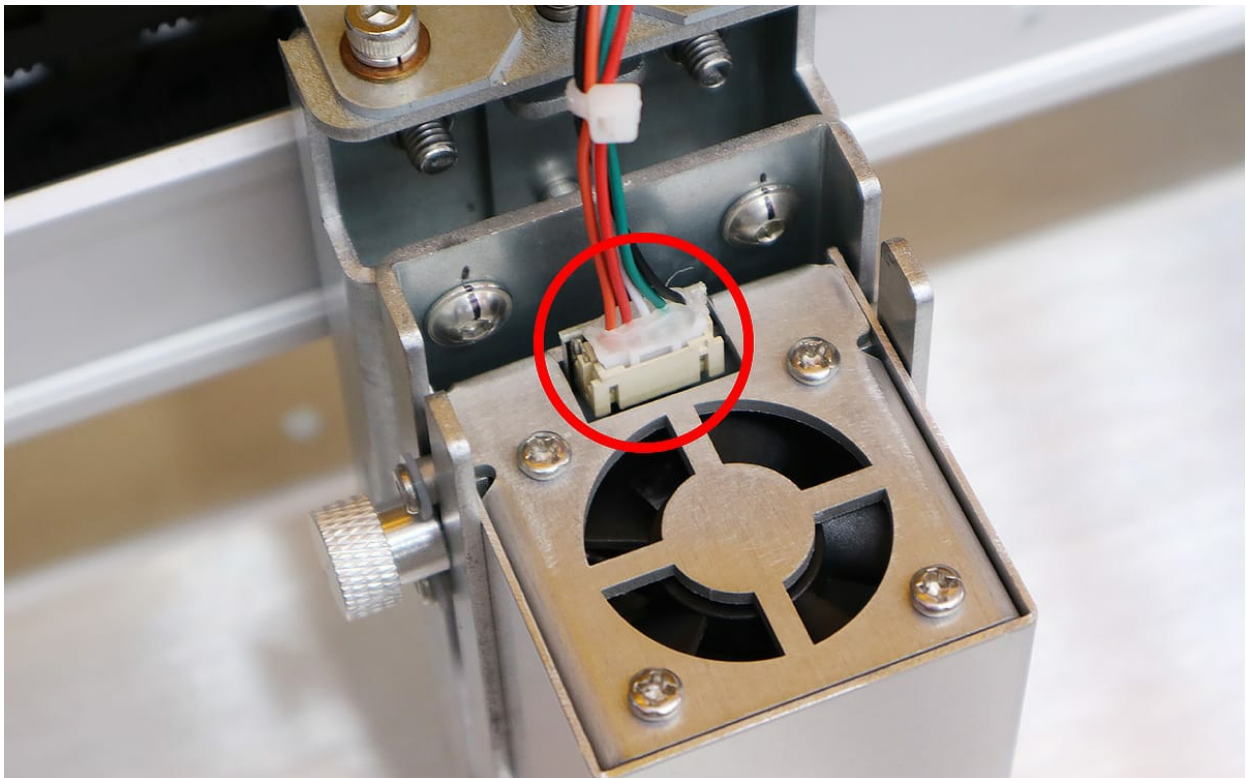

Remove the cover of the camera on the inner wall of the lid. DO NOT touch the lens of the camera.

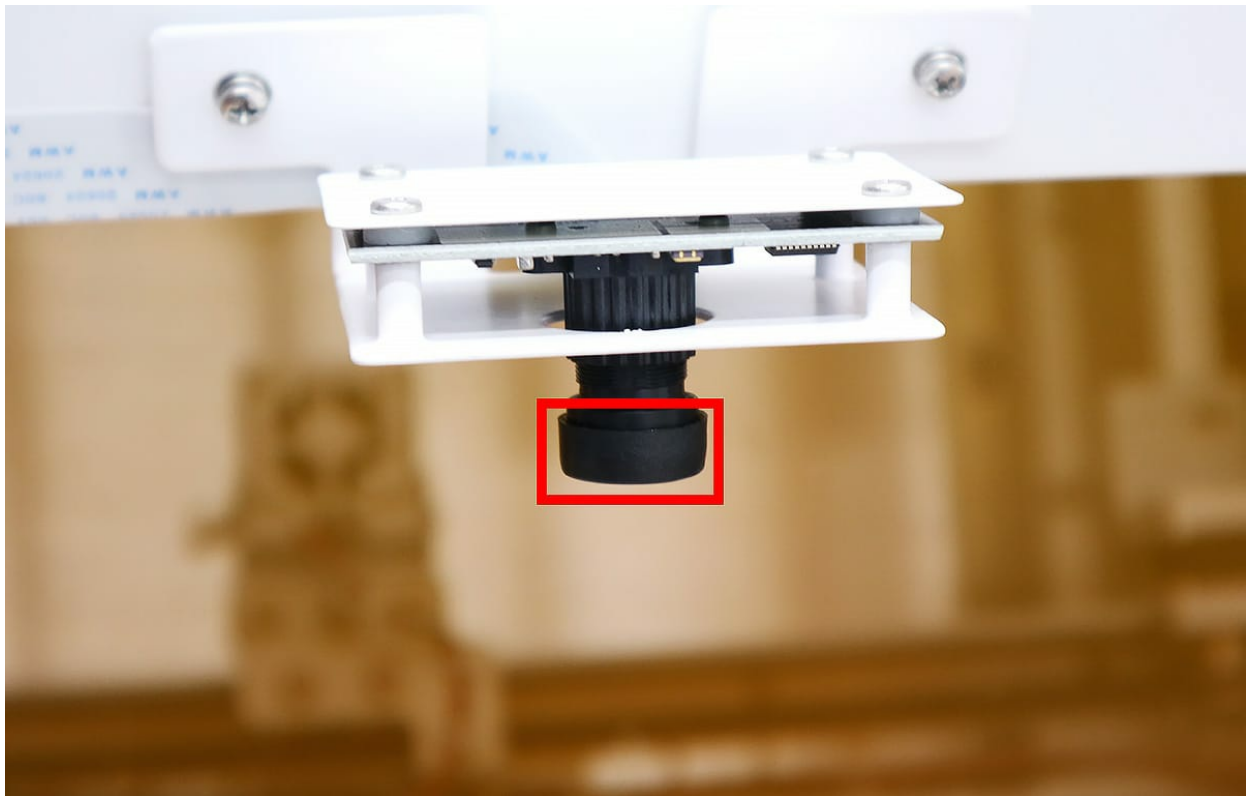

For any occasion that you need to send your device to smartDIYs Inc. to get warranty service from us, please keep all the items sent together with the devices (boxes, packing materials, screws, plates, etc).

Connecting the power supply

After confirming that the power of the Etcher Laser is switched off (the power switch's ○ part is pressed), connect the AC cable and AC adapter. After that, connect each end of the cable to the Etcher Laser and an electrical outlet.

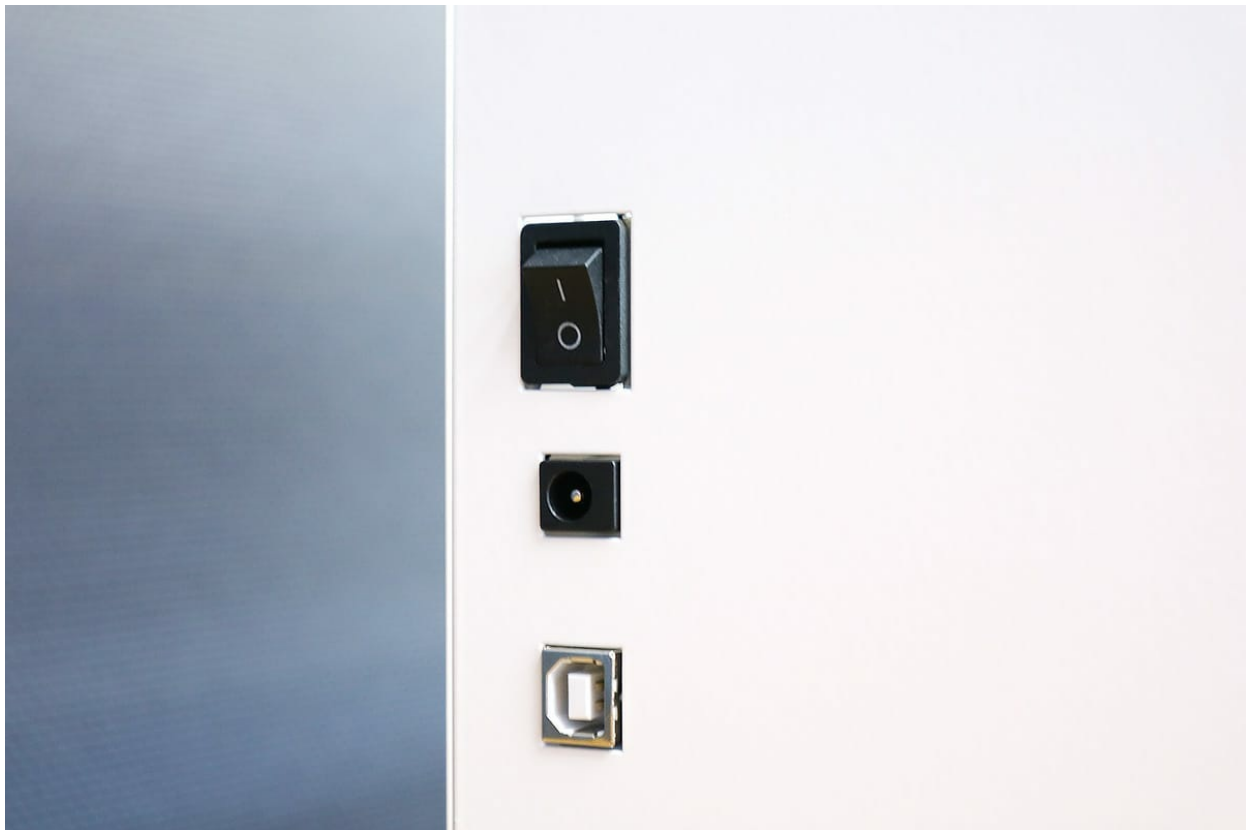

Turn on the Etcher Laser's power switch. When it is properly turned on, the light will turn on and the exhaust fan on the backside of the device will start to run.

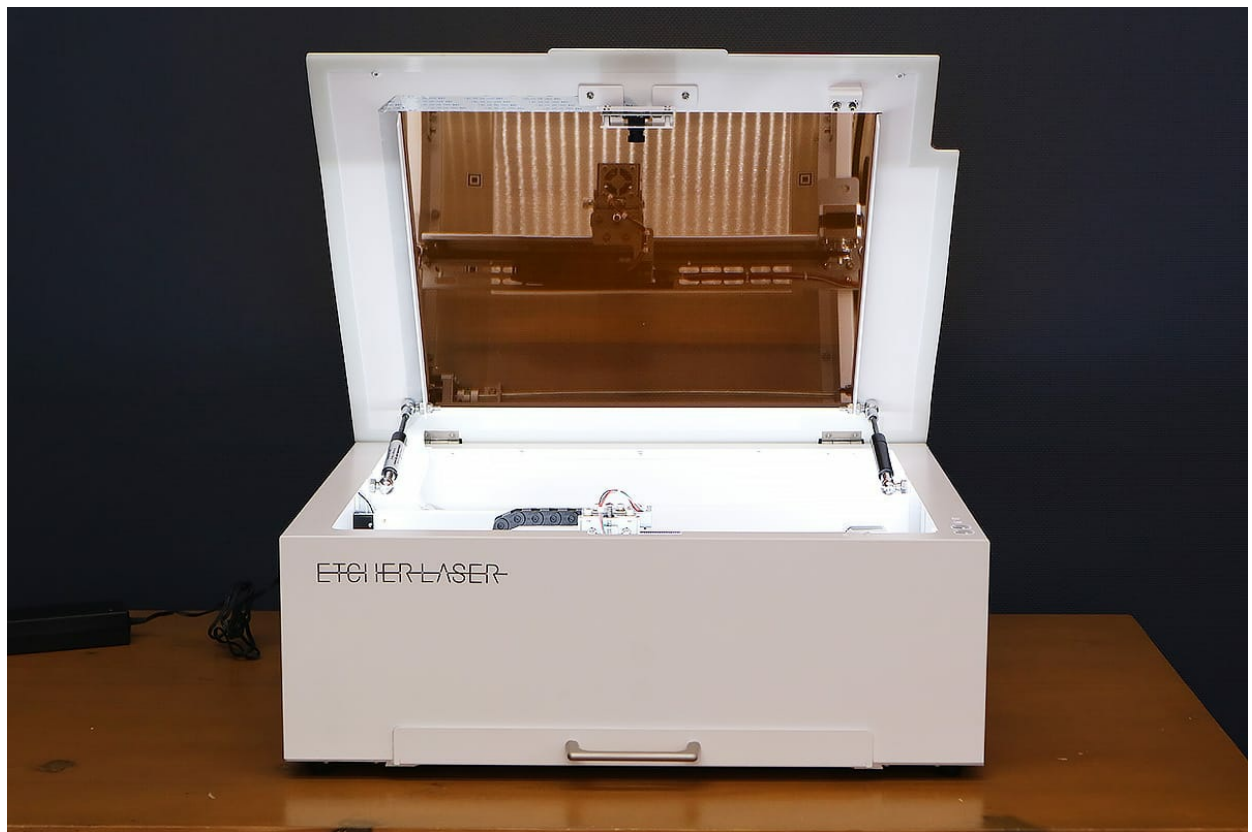

Installing the software

This section explains how to install the software (SmartDIYs Creator). Click the link below and download the installer for your OS.

*Skip this step if you have already installed the software.

- [SmartDIYs Creator](#)

Click the installer and activate.

When the window for setup appears, click the “Next” button to start the installation.

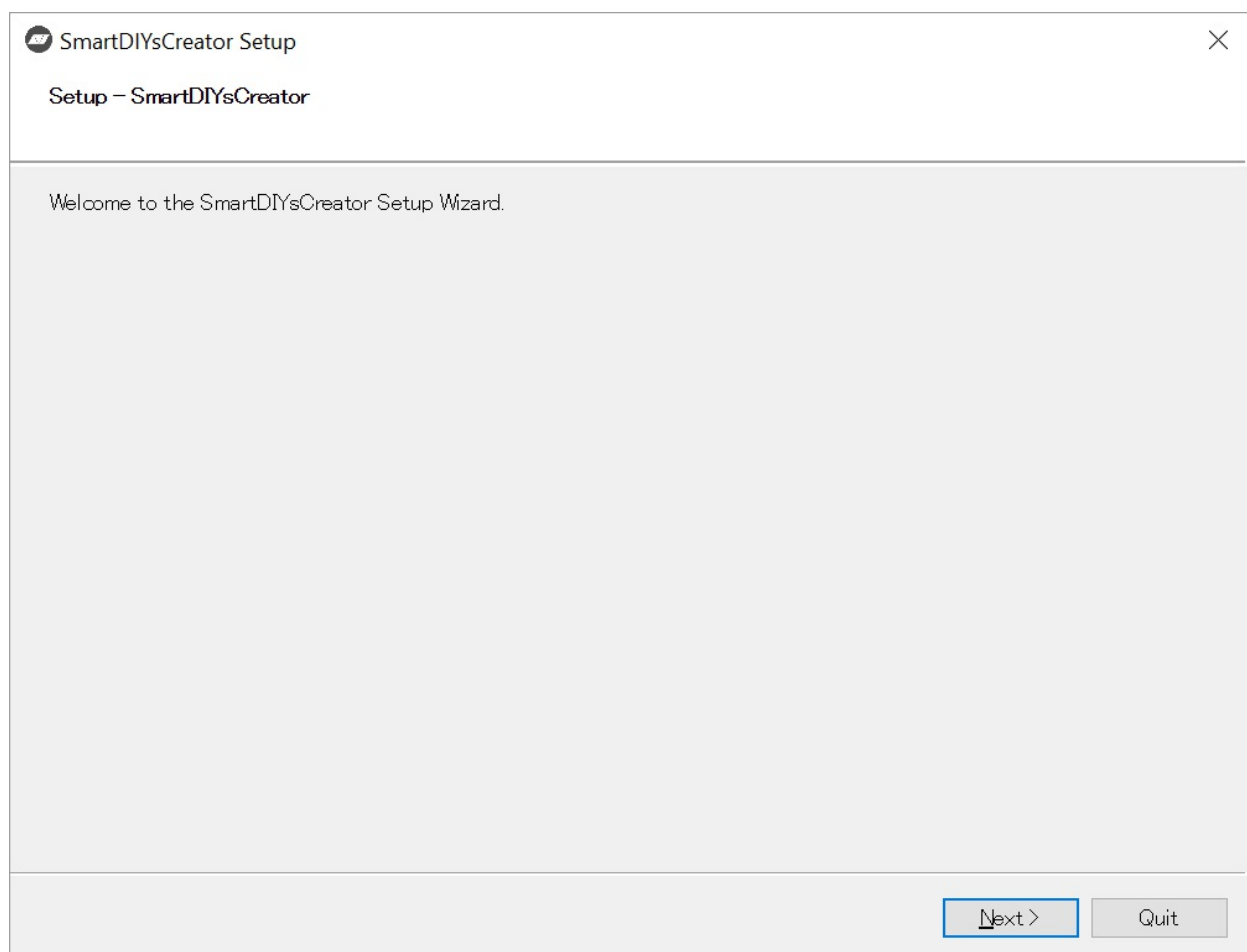

The installer will check whether SmartDIYs Creator is already installed. If it is already installed, it will automatically uninstall.

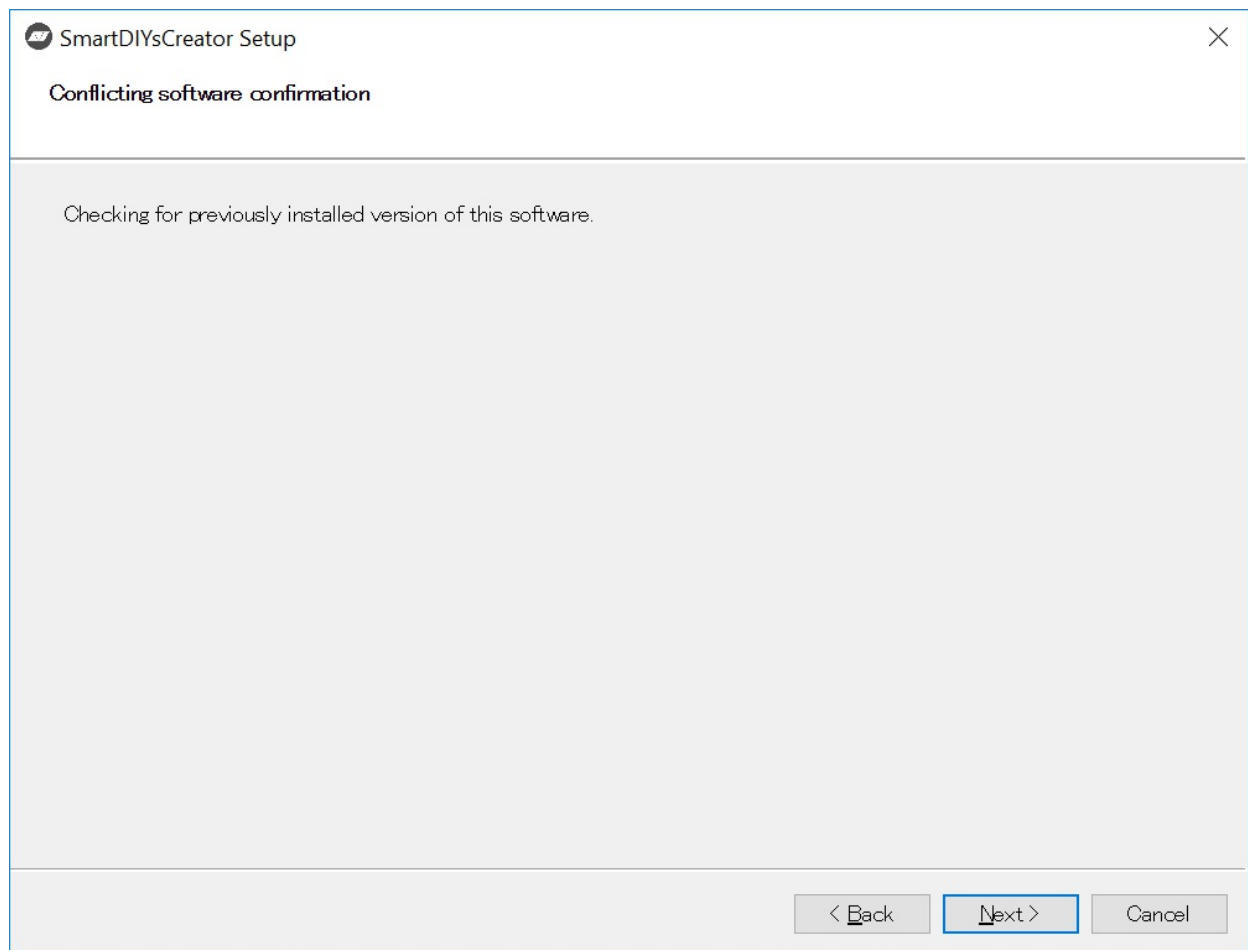

When it has finished checking, click “Next” to move on.

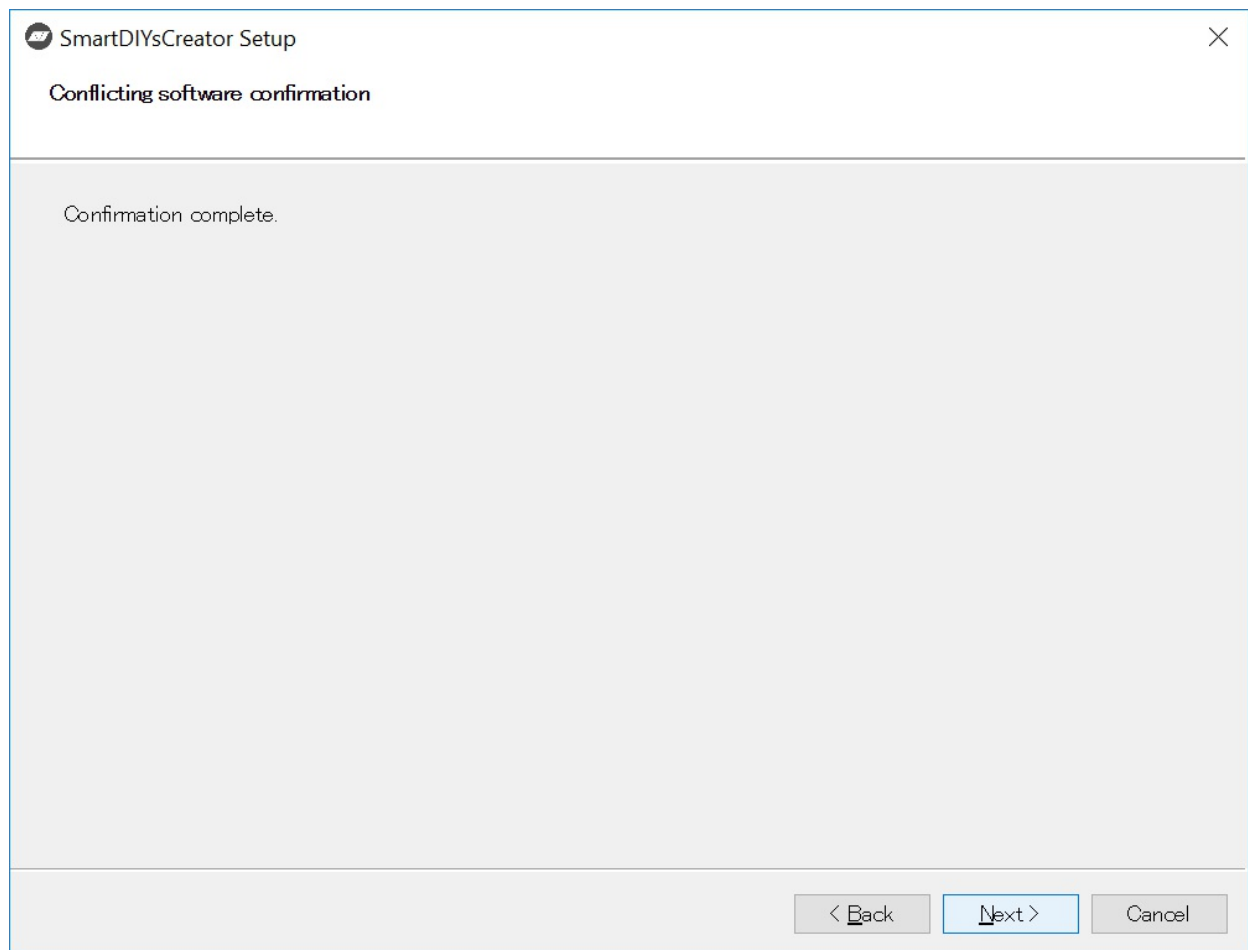

Select the folder to install the software. If you don't need or want to change the folder from the default, click "Next" to move on.

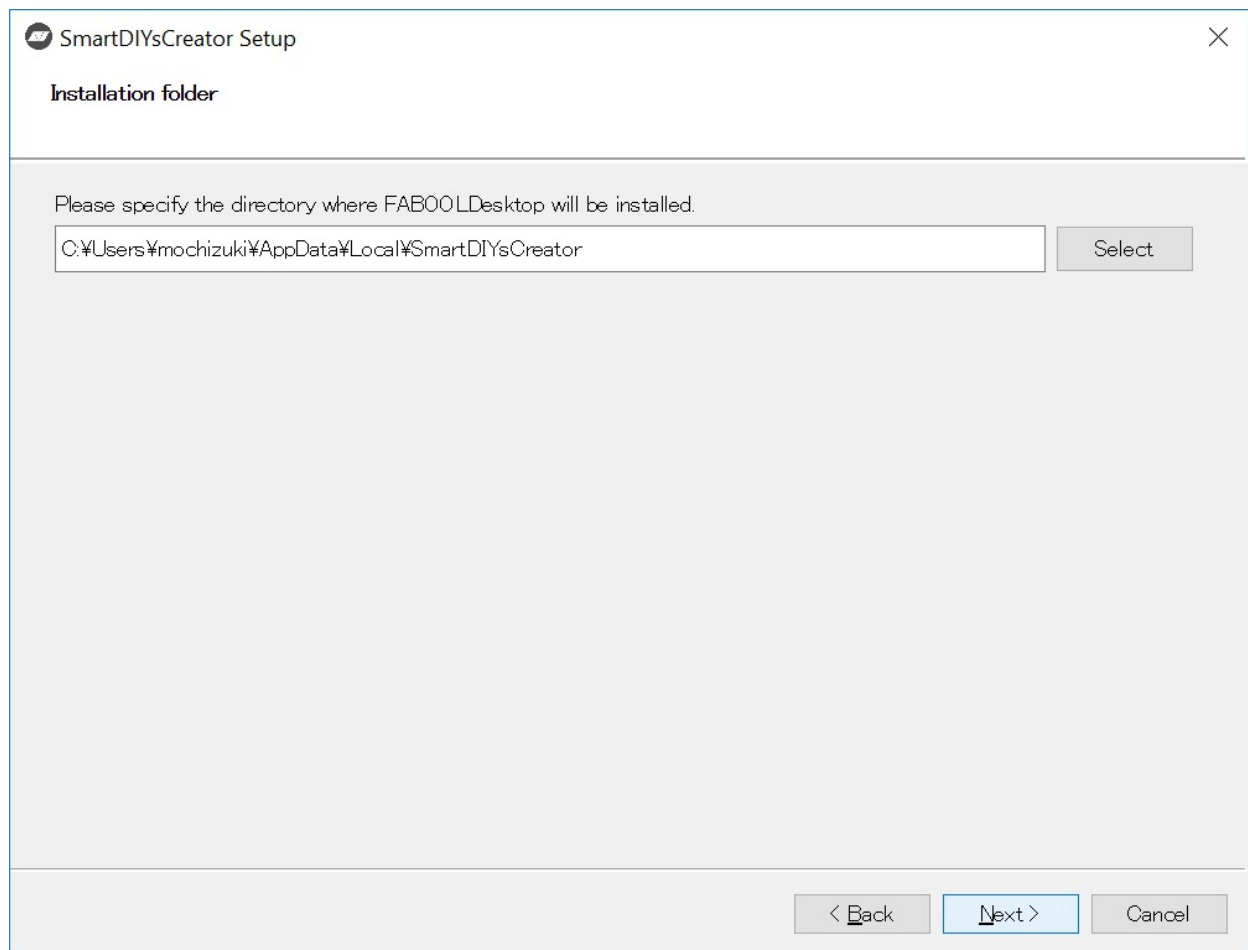

The installer will check the status of the installation.
*It might take time to check depending on your PC.

Conflicting software confirmation

Searching the driver of FABOOLSoftware.

< Back

Next >

Cancel

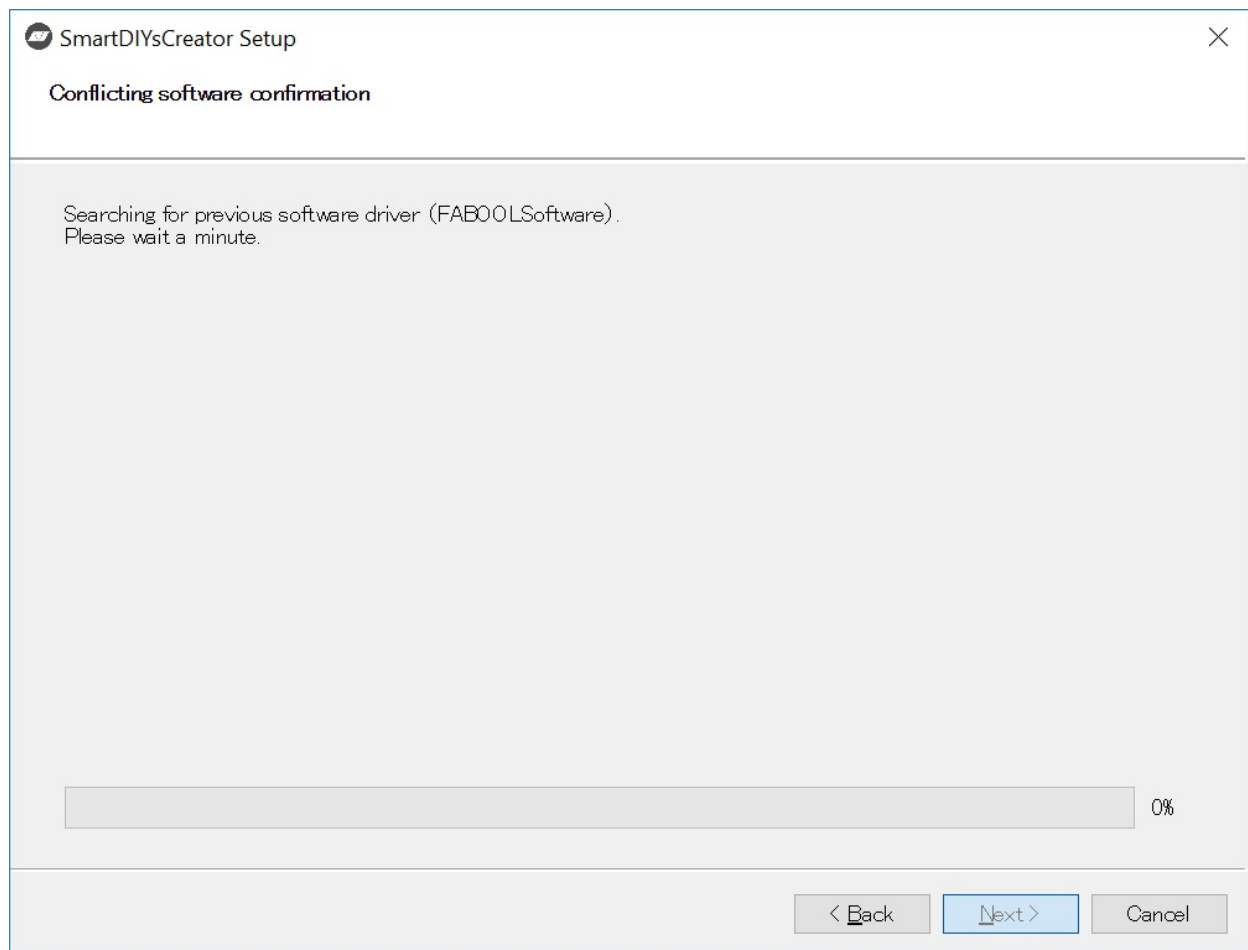

When the checking is complete, click “Next” to move on.

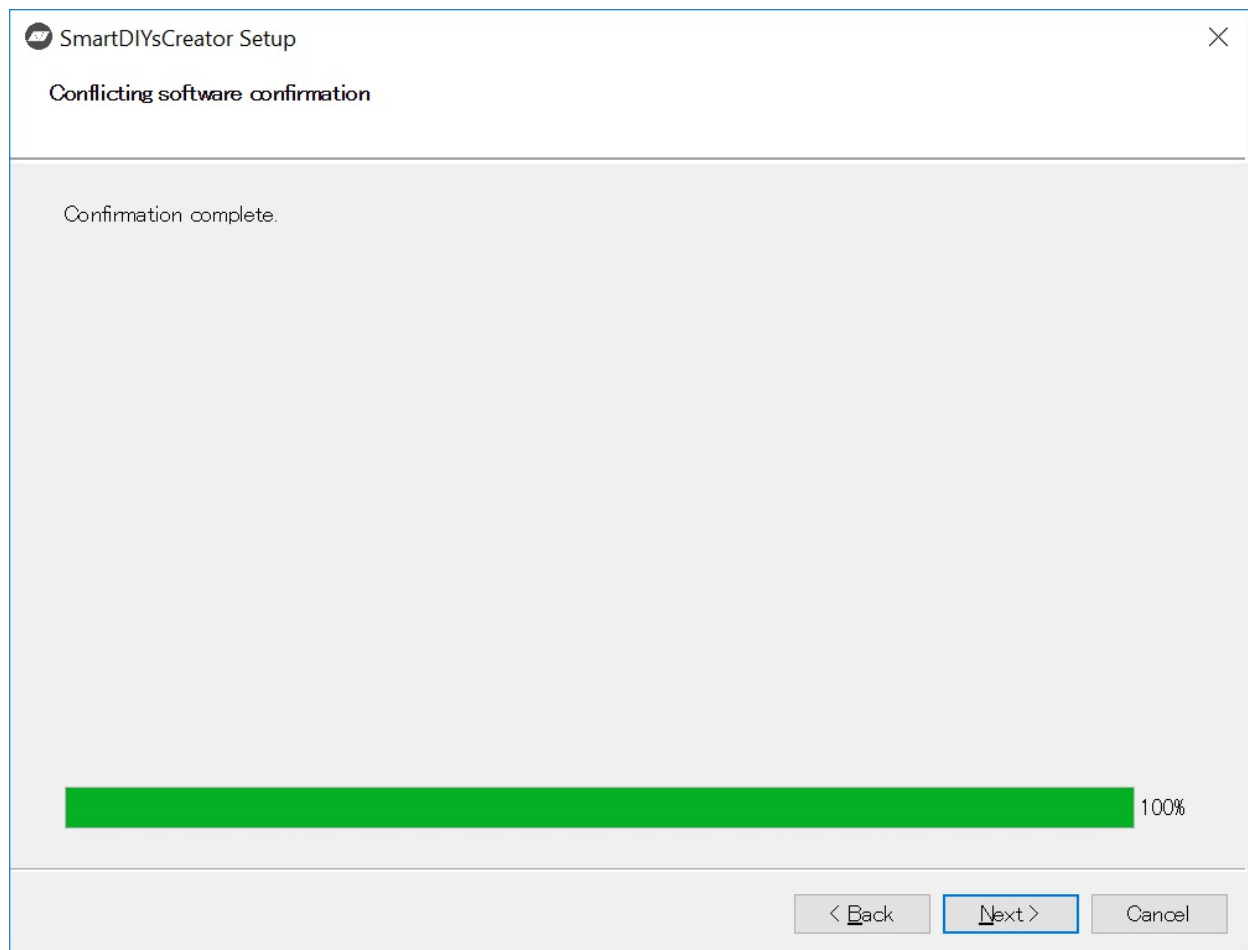

The window will show the components that are going to be installed. Make sure all the checkboxes are ticked, and click "Next" to proceed.

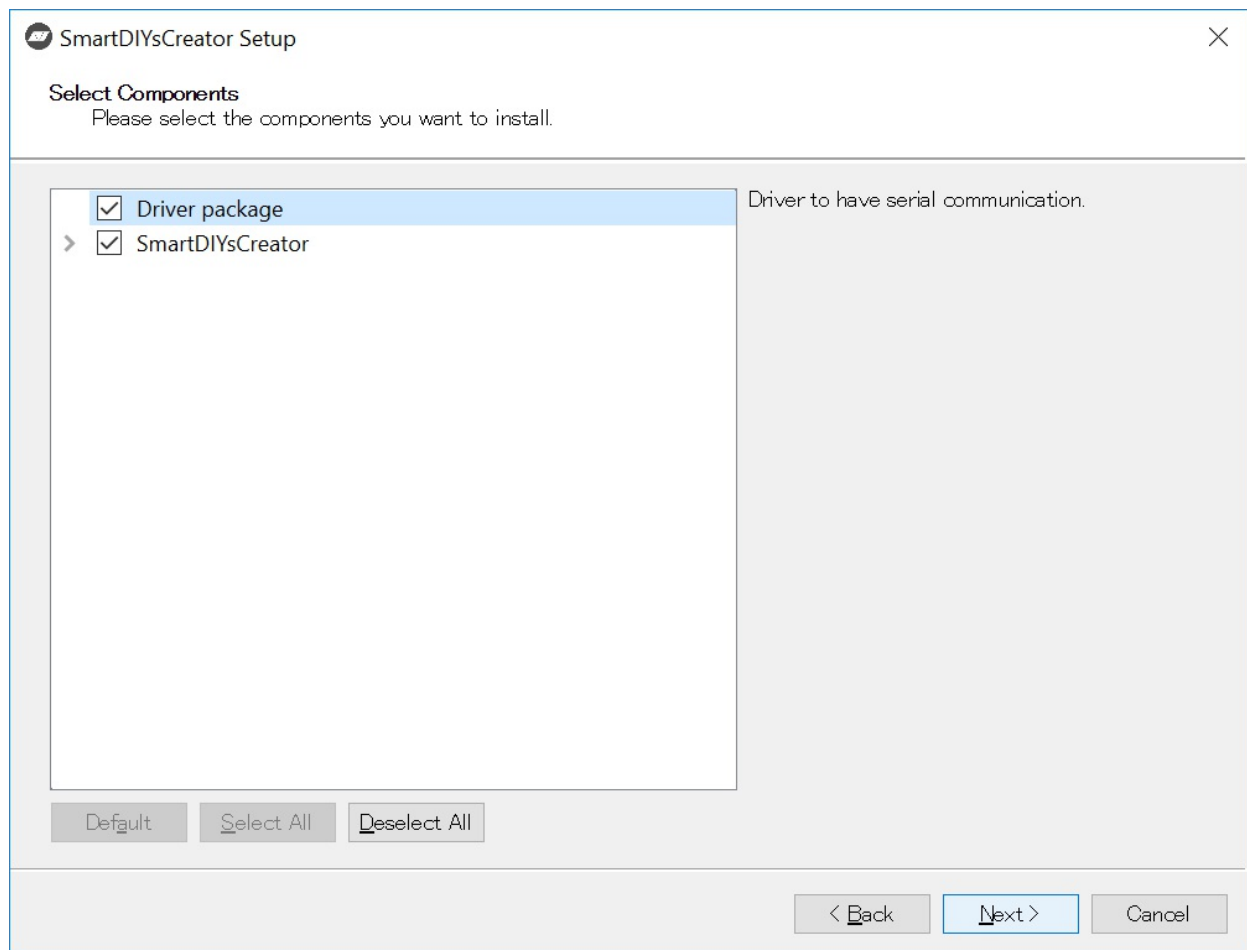

Confirm the displayed license terms, and if you agree, check "I accept the license" and click "Next" to proceed.

*If you do not accept the license, you can not complete the installation.

SmartDIYsCreator Setup

×

License Agreement

Please read the following license agreement. You must accept the terms contained in this agreement before continuing with the installation.

Software (FABOOL SOFTWARE) Terms of Use

Please read these Terms of Use ("Terms") carefully before using this site. By accessing and using the smartDIYs Co.,Ltd. ("smartDIYs" "We" "Our" "Us") websites and FABOOL Software ("Software"), you acknowledge and agree to abide by the following Terms of Use. If you do not agree to these Terms, do not use our software or download and install any materials.

1-Description of Services and Manual-

1.This Agreement aims at establishing terms for you to use our software which is used to operate the laser engraver/cutter, FABOOL Laser we provide ("Our Product").

2.You can confirm the functions, basic specifications, and installation method of the software from the following manual;

The manual: <https://www.smartdiys.com/manual/fabool-software-overview/>

2-No Assignment-

1.You are permitted to use this software ("Licence") within the scope that we have given approval.

2.This license is non-exclusive right, and neither these terms nor any of the rights and obligations arising hereunder may be assigned or transferred by you, in whole or in part, to any third party.

3.This license is effective only when you use our products that you purchased from us.

3-Licence Fees-

1.You shall pay fees ("licence fees") depending on the type of software you use by the ways we have given

☒ I accept the license.

☐ I do not accept the license.

< Back

Next >

Cancel

Click the Install button to begin the installation.

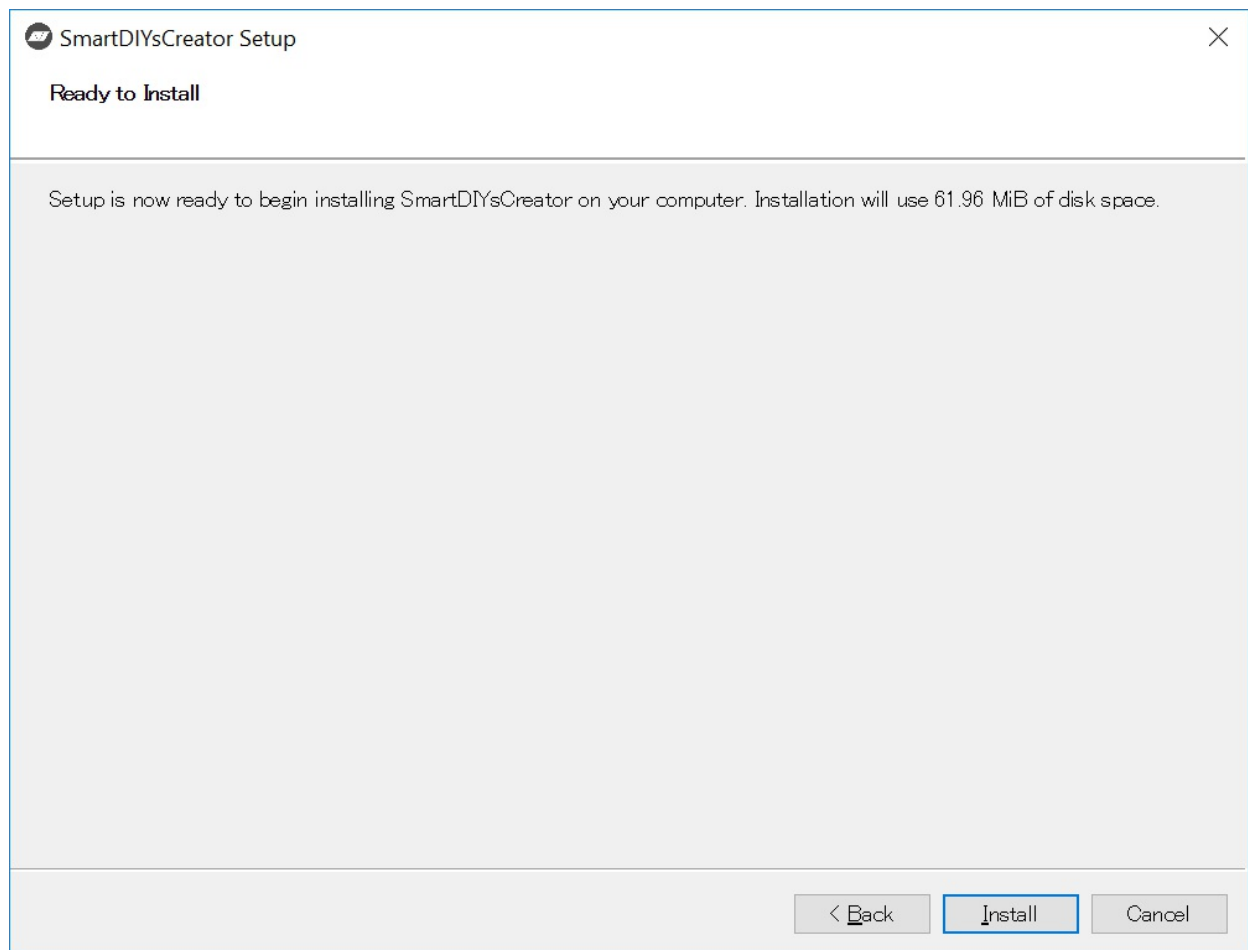

If you are using Windows, the installation of the device driver will start during installation, so click “Next” to install.

Device Driver Installation Wizard



Welcome to the Device Driver Installation Wizard!

This wizard helps you install the software drivers that some computers devices need in order to work.

To continue, click Next.

< Back

Next >

Cancel

Device Driver Installation Wizard



Completing the Device Driver Installation Wizard

The drivers were successfully installed on this computer.

You can now connect your device to this computer. If your device came with instructions, please read them first.

Driver Name	Status
✓ STMicronics (usbs...	Ready to use



< Back

Finish

Cancel

When the device driver installation is complete, click "Finish".

Device Driver Installation Wizard



Completing the Device Driver Installation Wizard

The drivers were successfully installed on this computer.

You can now connect your device to this computer. If your device came with instructions, please read them first.

Driver Name	Status
✓ STMicroelectronics (usbs...	Ready to use

< Back

Finish

Cancel

The window will show the installation is complete, so click "Finish". If "Run Application" is checked at this time, SmartDIYs Creator will open automatically.

30 day warranty

In the event of initial failure, defects, etc. due to a lack of necessary information from our company or an issue with the machine itself within the first 30 days of receiving your product, we will exchange it for a new one after confirming the status. Just pay shipping and handling.

6 month warranty

If initial failures or defects occur within the first 6 months of receiving your product, contact support within that time and we will repair or replace the defective parts. Just pay shipping and handling.

Please note that we cannot take care of any damages other than initial failures.

Disclaimer

We will not claim responsibility for damages, injuries, accidents, or fires caused by the use of this product. We also will not bear any responsibility for the following:

- Damages, injuries, accidents, or fires caused by the use of the machine or failures of parts.
- Damages, injuries, accidents, or fires caused by not following the instructions
- Damages, injuries, accidents, or fires caused by remodeling or modification of the machine and use alongside software or products not affiliated with smartDIYs.

Customer Support

For any inquiry, reach out to us from the contact form on the official website or email us to support@smartdiys.cc.

Contact support with a photo or video of the condition of the machine to help the support desk understand the situation in better detail.