

Gvoice™

Model Name:TY-769

FCC ID:2AUMSTY-769



Gvoice Delight V1



Gold Voice for You



Choose the right earplug

Choose your right earbuds for the best sound.

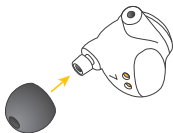

Wear

Insert the earplug into your ear;
Rotate the earbuds to make
the microphone towards to
your mouth.

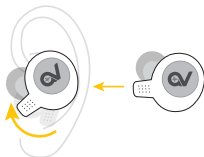

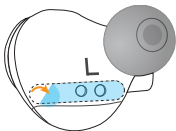

Remove the insulation sheet on the bottom of the earbuds and put the earbuds back into the charging case charge it for 30 minutes. .If the charging case shows a low battery, you need to charge the charging case.

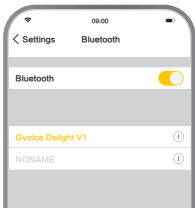

Bluetooth pairing

Turn on phone Bluetooth,Open the charging case and take out the earbuds,Find "Gvoice Delight V1" in the Bluetooth device list.If a pairing password is required, enter "0000" or "000000";After pairing success, the earbuds will be automatically paired the next time you when turn on the earbuds(when the device not deleted in the Bluetooth list).



Android / iOS
system universal QR code



Android system pairing instructions

1. After download completed, Permission to give software as required, including but not limited to "Location, Network, Open Bluetooth, Open Map" ;
2. Open the charging case;
3. The dialog box of "Gvoice Delight V1" is displayed on the screen. Click "Connect" .
4. After the connection success, the dialog box converts into a pair of earbuds and a charging box and will show the power of the earbuds and the charging box separately below.
5. Earbuds pair automatically next time after connected (Please do not delete in the Bluetooth list)



Android / iOS
system universal QR code



iOS system pairing instructions

1. After download completed, Give APP permission as required, including but not limited to "Location, Network, Open Bluetooth, Open Map";
2. Open the APP and the charging case;
3. The dialog box of "Gvoice Delight V1" is displayed on the screen. Click "Connect". (The system will boot into the settings. Find "Gvoice Delight V1" in list of Bluetooth devices available and click to connect).
4. After the connection success, the dialog box converts into a pair of earbuds and a charging box and will show the power of the earbuds and the charging box separately below.
5. Earbuds pair automatically next time after connected (Please do not delete in the Bluetooth list).



Button function description



When calling

Tap twice on the left or right ear Gvoice Delight V1, answer the phone.



Long press for 3 seconds Gvoice Delight V1, Refuse to answer the call.



During a call



Tap twice the left or right earbud to end the call.



When playing music



Tap twice left or right earbud:
Pause/Start.



Press left earbud: Next song;
Press right earbud:
Previous song.



Press the left earbud twice
quick: Volume +;
Press the right earbud twice
quick: Volume - .



When playing music or standby



Long press for 3 seconds left
or right earbud,
Turn on the phone voice
assistant.



Long press for 5 seconds left
or right earbud,
turn off the earbuds.

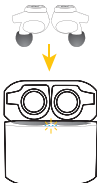

Charging

Put the earbuds into the charging case.

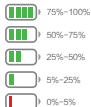

Note:

- Put the earphone into the charging case and close the cover, the earbuds will shut down automatically.
- The tap function needs to be at least three seconds apart.

Positioning and searching of earbuds and charging bins (need to be used with APP)



The APP will automatically record the Bluetooth disconnected position. If you lost earbuds you can use the search function of the APP to find the earbuds.

1.Open APP. The pattern of the earbuds and the pattern of the charging case will be displayed on the map.Click on the pattern to switch to the item you are looking for.

2.Click on the device name below to enter the map.



3.Click the "Vehicle" icon to enter navigation mode.Follow the navigation guide to find the earbuds or the charging case.
(The positioning accuracy depends on the positioning accuracy of the phone).

4.When the phone is within 10 meters of the earbuds,pair the earbuds with the phone,Click "Play Sound" the earbuds will beep,then you can find the earbuds.

FCC Caution.

This device complies with part 15 of the FCC Rules. Operation is subject to the following two conditions:

- (1) This device may not cause harmful interference, and
- (2) this device must accept any interference received, including interference that may cause undesired operation.

Any Changes or modifications not expressly approved by the party responsible for compliance could void the user's authority to operate the equipment.

Note: This equipment has been tested and found to comply with the limits for a Class B digital device, pursuant to part 15 of the FCC Rules. These limits are designed to provide reasonable protection against harmful interference in a residential installation. This equipment generates uses and can radiate radio frequency energy and, if not installed and used in accordance with the instructions, may cause harmful interference to radio communications. However, there is no guarantee that interference will not occur in a particular installation. If this equipment does cause harmful interference to radio or television reception, which can be determined by turning the equipment off and on, the user is encouraged to try to correct the interference by one or more of the following measures:

- Reorient or relocate the receiving antenna.
- Increase the separation between the equipment and receiver.
- Connect the equipment into an outlet on a circuit different from that to which the receiver is connected.
- Consult the dealer or an experienced radio/TV technician for help.

The device has been evaluated to meet general RF exposure requirement. The device can be used in portable exposure condition without restriction.