

# User Manual

## Bluetooth Dual Channel Stereo Speaker

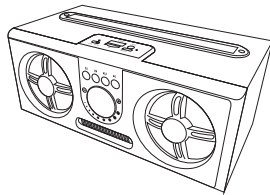

Please read this instruction carefully before use

## Description of Appearance and Function

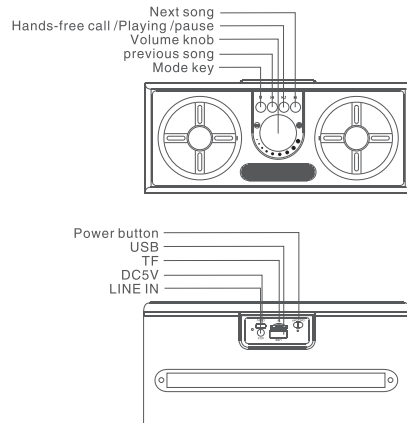

## Product feature

1. Bluetooth 5.0 chip is adopted with wide compatibility and clear sound quality. It is based on factory configuration.
2. High fidelity two-channel stereo, flexible and simple operation.
3. Built-in digital power amplifier, high efficiency and energy saving
4. Accessible to a variety of sound sources: Bluetooth support, induction and external signal direct playback
5. Barrier-free Bluetooth transmission distance 10 meters
6. Power-saving mode: Bluetooth waits for five minutes to shut down automatically while connecting

## Technical indicators

Output power: 10W\*2  
Loudspeaker specification: 2.5"  
System frequency: 60Hz-16KHz  
Signal-to-noise ratio:  $\geq 60\text{dB}$   
Input sensitivity: 600 $\pm$ 100mV

Distortion degree:  $\leq 0.3\%$ (1W 1KHz)  
Product size: L208\*W108\*H90mm  
Charging voltage: DC5V  $\approx$  500mA  
Play time: 3 hours  
Full charge time: 2 hours

## Bluetooth Connection Required Reading

1. Turn on the power switch, the working light is on, the blue light is flashing, and Bluetooth is in the state of being connected.
2. Turn on the Bluetooth settings of the mobile phone, in the search state, and click on the matching. At this time, Bluetooth indicates the blue light in a slow flash state, indicating that the connection was successful.
3. Short press **⏮** is the last song.
4. Short press **⏭** is the next song.
5. Short press **⏸** for pause/playing, double-press for automatic dial-up function of mobile phone, voice when calling. Short press this button to answer calls, and once more to hang up.
6. Volume can be adjusted knob according to their own needs
7. In the mode of successful paired connection, the next boot will automatically connect, eliminating re-search connection trouble.
8. If you need to connect with another phone, the original phone should be de-paired, and the speaker should be restarted and re-operated according to the above steps.
9. Short press **M** to exit Bluetooth mode.

## TF/U Disk playing

1. Please insert the TF card or U disk with MP3 music in the correct direction according to the chute of TF/U disk.
2. If there is a card in it, it will start and play directly on TF/U disk, and the blue light will flicker.
3. Short press **⏮** is the last song.
4. Short press **⏭** is the next song.
5. Short press **⏸** for pause/play
6. Volume can be adjusted knob according to their own needs
7. Short Press **M** to exit TF/U Disk mode

## FM radio

1. Use the attached 3.5 audio line to connect to Line in as an antenna.
2. The indicator light is blue flash when power on. Press the M key and enter the radio state. If it with TF card, you should press it short to enter the radio state with long blue light.
3. Short press **⏮** for the last channel.
4. Short press **⏭** for the next channel.
5. Short press **⏸** is an automatic search. It takes about one minute.
6. Volume can be adjusted knob according to their own needs
7. Short press **M** to exit FM mode.

## AUX Mode

1. Use the attached 3.5 connector to connect to the sound, and the other end to connect to the external sound source.
2. When the audio line has been inserted, boot directly into AUX mode, and the blue light is long.
3. Short press **⏸** for pause or playing.
4. Volume can be adjusted knob according to their own needs
5. Short press **M** exit AUX mode

## Charging instructions

1. This product is charged with high current. Do not change the charging power cable at will.
2. Charging indicator: The charging process is red light, long green light when charging is full.
3. New batteries or batteries that have not been charged for a long time may not reach the rated capacity and need to be charged and replayed.

## Security warning

- \* If the machine suddenly occurs smoke or other unusual phenomena when charging, please unplug the power cord quickly. Avoid accidents and contact local distributors or call after service calls Repair.
- \* If the machine is caught in the rain or damp, please put the equipment in the ventilating place to cool down and avoid drying at high temperature. This equipment will burn easily or make the components of the equipment invalid.
- \* Do not place this equipment in hot and high temperature sources, such as fire, heater, etc.
- \* If the machine is not used for a long time, it should be placed in a cool and dry environment. Please unplug the charging power supply. Charge once every month.

## Useful hints

- \* In order to extend the life of the equipment and your physical and mental health, please do not keep it in a loud environment for a long time. Listen to your voice so as not to damage your hearing.

## Packing accessories

speaker, Instructions, 3.5 AUX cable, DC5V Micro USB cable

This device complies with part 15 of the FCC Rules. Operation is subject to the following two conditions: (1) this device may not cause harmful interference, and (2) this device must accept any interference received, including interference that may cause undesired operation.

Any changes or modifications not expressly approved by the party responsible for compliance could void the user's authority to operate the equipment.

NOTE: This equipment has been tested and found to comply with the limits for a Class B digital device, pursuant to Part 15 of the FCC Rules. These limits are designed to provide reasonable protection against harmful interference in a residential installation. This equipment generates, uses and can radiate radio frequency energy and, if not installed and used in accordance with the instructions, may cause harmful interference to radio communications. However, there is no guarantee that interference will not occur in a particular installation.

If this equipment does cause harmful interference to radio or television reception, which can be determined by turning the equipment off and on, the user is encouraged to try to correct the interference by one or more of the following measures:

- Reorient or relocate the receiving antenna.
- Increase the separation between the equipment and receiver.
- Connect the equipment into an outlet on a circuit different from that to which the receiver is connected.
- Consult the dealer or an experienced radio/TV technician for help.

The device has been evaluated to meet general RF exposure requirement. The device can be used in portable exposure condition without restriction