

MUSICGO®
MOVIES MUSIC POWER GO

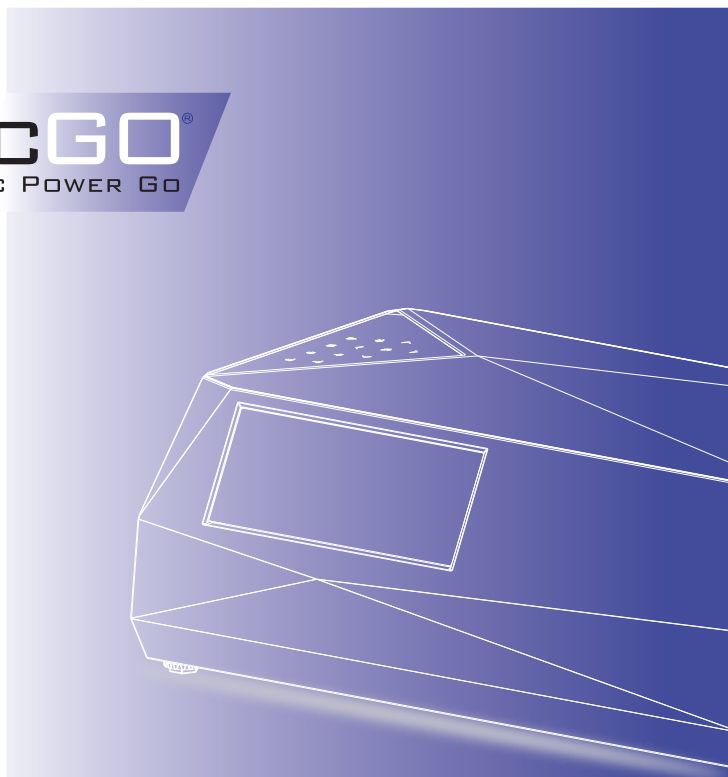

MUSICGO® Projector User's Guide

Model: Sport MG2U-S
Lite MG2U-L



for more update user manual:
Electronic file link
www.eliteprojector.com/downloads.html

www.eliteprojector.com
Printed in Taiwan
FBZZ-MG2U001-01



EYE SAFETY WARNINGS

- ⚠ To avoid retinal damage, do not stare directly or indirectly into the projector's light beam.
- ⚠ Rather than stand in the projector's light beam to point on the screen, use a laser pointer or pointer stick instead.
- ⚠ Make sure that students and other viewers observe the eye safety warnings and stay out of the direct light beam.
- ⚠ Use window blinds and turn down interior light sources to reduce the washout glare of ambient light.

IMPORTANT SAFETY INSTRUCTIONS

- 1.The ventilation ports prevent overheating. Never block these ports located on the sides and bottom of the projector.
Direct obstruction, confined spaces or placing on a cluttered surface restricts airflow, and ruins the projector.
- 2.To reduce risk of fire or electric shock, do not expose the projector to any liquids, rain, snow or airborne moisture.
- 3.Do not install near heat sources such as radiators, heaters, stoves or any other apparatus such as amplifiers that emit heat.
- 4.Do not use the projector in direct sunlight.
5. Do not use near any appliance generating a strong magnetic field.
- 6.Do not use the projector in areas susceptible to excessive dust and dirt.
- 7.Turn off the product before cleaning.
- 8.Disconnect the power cord if the product is not being used for a long period of time.
- 9.Ensure that the ambient room temperature is within -10- 40°C (14-104°F).
10. Ensure that relative humidity is 5 - 35°C (41- 95°F), 80% (Max.), non-condensing.
11. Do not drop, throw or try to bend your product.
12. Dispose of your projector in an environmentally appropriate manner and according to local disposal laws. Disposing the projector in a fire may cause an explosion.
13. Clean only with dry cloth.
14. Only use attachments/accessories specified by the manufacturer.
15. Do not use the unit if it has been physically damaged or abused. Physical damage/abuse would be (but not limited to):
 - ⇒ Unit has been dropped.
 - ⇒ Charger or plug has been damaged.
 - ⇒ Liquid has been spilled on the projector.
 - ⇒ Projector has been exposed to rain or moisture.
 - ⇒ Something has fallen into the projector or something is loose inside.Do not attempt to service the unit yourself. Opening or removing covers may expose you to dangerous voltages or other hazards. Please contact your local reseller or service center before you send the unit for repair.
16. Do not let objects or liquids enter the projector. They may touch dangerous voltage points and short out parts that could result in fire or electric shock.
17. Follow all warnings and cautions in this manual and on the projector.
18. The unit should only be repaired by appropriate service personnel.
19. Projector lamps generate a lot of heat. This causes much of the projector's surface area to heat up. If the projector seems to be excessively hot, turn it off so that it can cool down and then call customer service.

**CAUTION – RISK OF BATTERY EXPLOSION IF INCORRECT TYPE IS USED.
MAKE SURE TO PROPERLY DISCARD USED BATTERIES ACCORDING TO
LOCAL REGULATIONS.**

COPYRIGHT / TRADEMARK

© Copyright 2019. All rights reserved.

The manufacturer reserves the right to make technical changes. The manufacturer assumes no liability for damages incurred directly or indirectly from errors, omissions, or discrepancies between the device and this documentation.

Other brands or logos are trademarks or registered trademarks of their respective companies.

This device is not intended for use in the direct field of view at visual display workplaces.

DECLARATION OF CONFORMITY

We declare under our sole responsibility that this projector conforms to the following directives and norms:

EMC Directive 2014/30/EU

ErP Directive 2009/125/EC

EMC: EN 301489-1

EN 301489-17

EN 55032

EN 55024

Low Voltage Directive : 2014/35/EU

Safety: EN 62368 , EN62133+Annex.M

TRADEMARKS

Apple, Macintosh, iPod, iPod nano, and iPhone are trademarks or registered trademarks of Apple Computer, Inc. IBM is a trademark or registered trademark

Microsoft, PowerPoint, and Windows are trademarks or registered trademarks of Microsoft Corporation. Adobe and Acrobat are trademarks or registered trademarks of Adobe Systems Incorporated.



NOTE: This product is covered electrical and electronic equipment under the European Union's Waste from Electrical and Electronic Equipment (" WEEE") Directive (2002/96/EC). The WEEE Directive requires that covered equipment be collected and managed separately from typical household waste in all EU member states. Please follow the guidance of your local environmental authority or ask the shop where you purchased the product for collection or recycling options.

FCC WARNING

This device complies with part 15 of the FCC Rules. Operation is subject to the following two conditions: (1) This device may not cause harmful interference, and (2) this device must accept any interference received, including interference that may cause undesired operation.

Note: This equipment has been tested and found to comply with the limits for Class B digital device, pursuant to part 15 of the FCC Rules. These limits are designed to provide reasonable protection against harmful interference in a residential installation. This equipment generates, uses and can radiate radio frequency energy and, if not installed and used in accordance with the instructions, may cause harmful interference to radio communications. However, there is no guarantee that interference will not occur in a particular installation. If this equipment does cause harmful interference to radio or television reception, which can be determined by turning the equipment off and on, the user is encouraged to try to correct the interference by one or more of the following measures:

- Reorient or relocate the receiving antenna.
- Increase the separation between the equipment and receiver.
- Connect the equipment into an outlet on a circuit different from that to which the receiver is connected.
- Consult the dealer or an experienced radio/TV technician for help.

Changes or modifications not expressly approved may void authority to operate the equipment.

FCC CAUTION

Any changes or modifications not expressly approved by the grantee of this device could void the user's authority to operate the equipment

The changes or modifications not expressly approved by the party responsible for compliance could void the user's authority to operate the equipment.

FCC RF exposure warning

This equipment must be installed and operated in accordance with provided instructions and the antenna(s) used for this transmitter must be installed to provide a separation distance of at least 20 cm from all persons and must not be co-located or operating in conjunction with any other antenna or transmitter. End-users and installers must be provided with antenna installation instructions and transmitter operating conditions for satisfying RF exposure compliance.

AGENCY APPROVALS

FCC, CE, and LVD

Other specific Country Approvals may apply. Please see product certification label.

Input ratings: AC 100 - 240V, 2.5A, 50 - 60Hz

Product offerings and specifications may be altered at any time without notice.

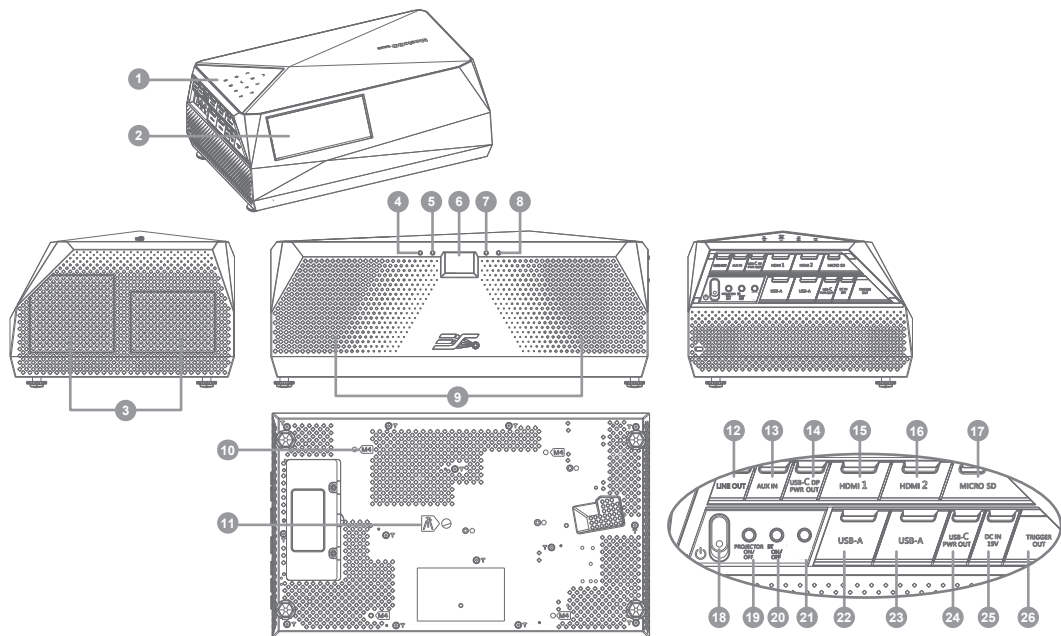

- | | | | |
|--|---|----------------------------------|----------------------------------|
| 1. Touch Keypad | 8. Battery / Power Status Indicator
(Battery indicator only for
MG2U-S model) | 13. Aux In | 20. Wireless Audio On/Off button |
| 2. Projection Window | 9. Speaker Mesh | 14. USB Type C (DP In/Power Out) | 21. Hot Key |
| 3. Ventilation Port | 10. Ceiling Mount Screw Holes (x4) | 15. HDMI 1 | 22. USB-A |
| 4. Indicator for Wireless Audio Out (Tx) | 11. Tripod Mount Hole | 16. HDMI 2 | 23. USB-A |
| 5. Indicator for Wireless Audio In (Rx) | | 17. Micro SD Slot | 24. USB Type C (Power Out) |
| 6. IR Window | | 18. Power On/Off Switch | 25. DC IN 19V |
| 7. Projector On/Off Indicator | | 19. Projector On / Off Button | 26. 12V Trigger out (To Screen) |

Note:
Follow the steps to open I/O cover.

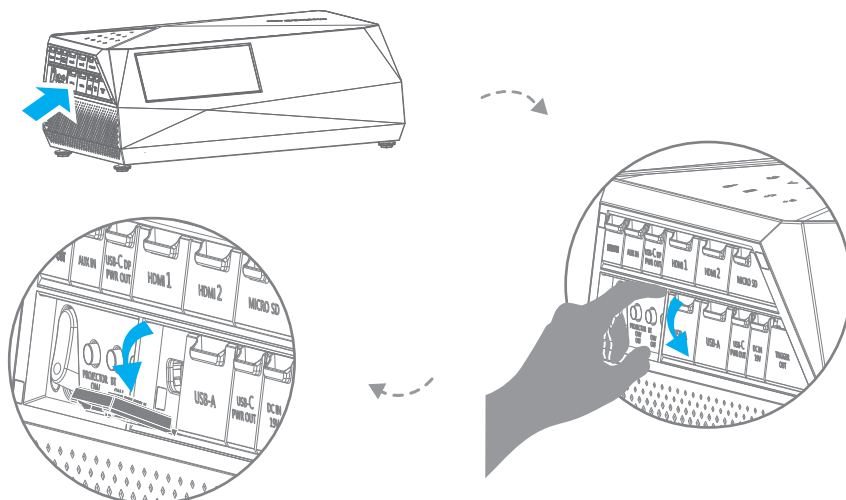

Touch Keypad

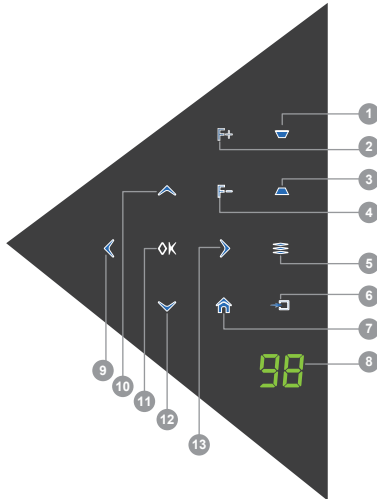

1. Keystone Up
2. Focus In
3. Keystone Down
4. Focus Out
5. Menu
6. Video Source Search
7. Home
8. Battery Capacity
9. Left
10. Up
11. OK/Enter
12. Down
13. Right

Remote Control

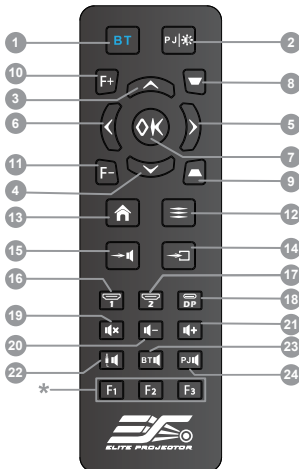

1. Wireless Speaker On/Off, reconnect(repair) external wireless speaker.(Note)
 2. Projector On/Off, Brightness Adjustment (Note)
 3. Up
 4. Down
 5. Right
 6. Left
 7. OK / Enter
 8. Keystone Up
 9. Keystone Down
 10. Focus In
 11. Focus Out
 12. Menu
 13. Home
 14. Video Source Search
 15. Audio Source Switch
 16. HDMI1
 17. HDMI2
 18. DP(Type C, Display Port)
 19. Mute
 20. Volume Down
 21. Volume Up
 22. Audio Aux Input
 23. Wireless Audio Input
 24. Projector Audio Input
- * No Function

*Note:

1. When projector is off, long press PJ button on remote control to turn on projector.
2. When projector is ON, short pressing the PJ button on the remote control will cycle through the following brightness modes: MAX, ECO, and MIN.
3. When projector is on, long press PJ button on remote control over 1 second, after prompt message and then short press PJ button again to turn off projector.
4. When projector is turned off, long pressing BT button on remote control over 1 second can turn on MoticGO as a wireless speaker. Long press again to turn off.
5. When projector is turned on, long press BT button on remote control over 1 second to turn on connection with external wireless speaker. User may need to short press BT button to (reconnect/repair external wireless speaker if it's the first time to connect. Long press again to turn off the connection of external wireless speaker.
6. When projector is turned on, short pressing hotkey button or F1 key on remote control can switch MoticGO as a wireless speaker or connect MoticGO to external speaker.

PRODUCT ACCESSORIES LIST

1

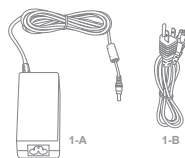

3



6



8



2



4



7



5

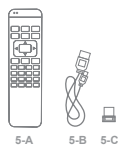

1. 1-A AC Adaptor
1-B Power Cord

3. USB Type C Cable
4. 4-A Remote Control
(P/N: 15AC-RCR3501-AA)
4-B Battery (AAA · x2)

5. 5-A Air Mouse
(P/N: 15AC-MG10001-AA)
5-B Charger Cable
5-C Air Mouse Receiver

6. User's Guide (with Warranty Card)

7. Carrying bag

8. Tripod

POWER ON/OFF

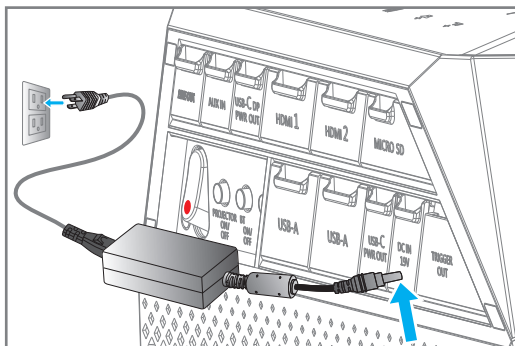

1. Connect the power cord to the DC input jack.

or

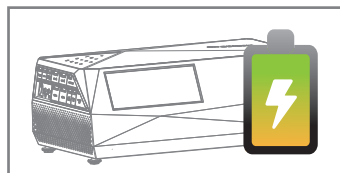

2. MoticGO® has an internal battery pack.
Please fully charge the battery before
using the projector.
(*Note: Only Sport MG2U-S model
has a battery pack)

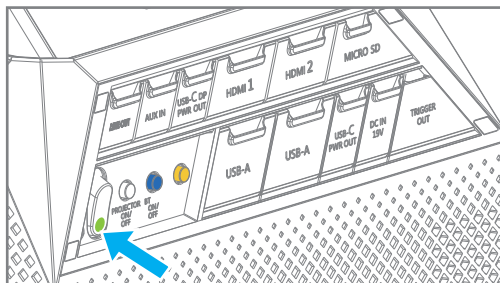

3. Press the Power On/Off Switch, the indicator light will turn green.

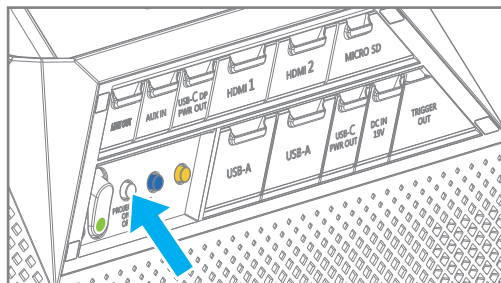

4. Press and hold the white PJ button to turn on the projector.