

CAR WIRELESS CHARGER

Smart Induction Expansion

The user manual



Made in China

Thanks for purchasing our products, this is a smart infrared induction vehicle-mounted wireless charger for smart phone. It could be used as vehicle-mounted mobile bracket, and more importantly, could be used as wireless charger with smart infrared induction expansion. Let you enjoy the great fun of digital smart products.

Please read this manual before using and keep it for future reference.

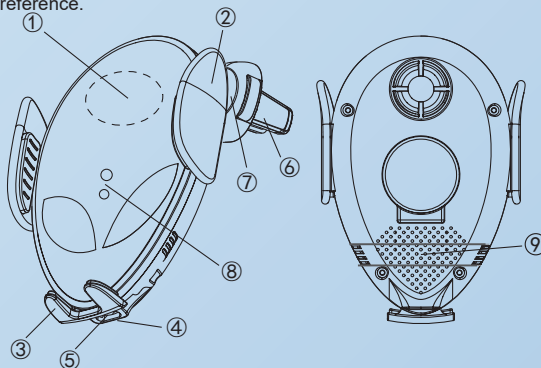

1. Wireless Charging Induction Area
2. Fixation Clamp
3. Adjust Tray
4. Type-C Power Port
5. Indicator Light
6. Vent Clip
7. 360° Rotation Ball
8. Sensor
9. Touching Induction Area

Installation of Charger

1. Mount the car wireless charger onto the vent clip by connecting the two brackets. Pushing the securing buckle forward, tightening the nut with suitable angle.

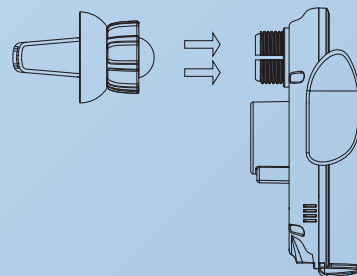

2. Fixing the vent clip onto the fender of the car's air condition vent.

Cable Connecting

Connect Type-C USB charging cable to the power port of the car wireless charger. Insert the other end of USB cable into the USB port of car charger.

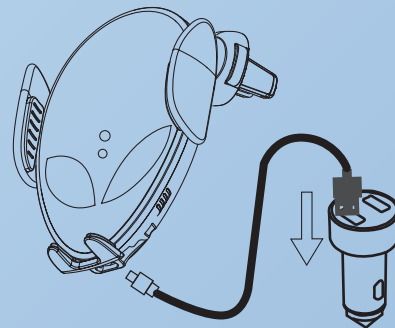

Charging for mobile phones

1. When the car wireless charger power on, the indicator light flash two times. When power standby, the indicator light power off.
2. Put the mobile phone near to the car wireless charger, and the fixation clamp could open automatically.
3. When inserting the mobile phone with wireless charging function into the car wireless charger, the fixation clamp could close automatically and hold your phone tightly, and start to charge. When charging the indicator light could breath.
4. When inserting the mobile phone without wireless charging function or other metal object, the fixation clamp could close automatically and hold tightly, meanwhile the indicator light flashing.
5. Touch the touching induction area, the fixation clamp could change the open-close state automatically to remove or put the mobile phone. (when the fixation closed, it could open by touching the touching induction area, otherwise it could close).

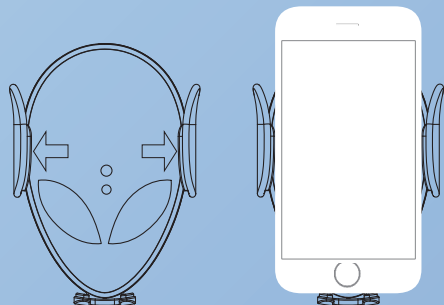

Specifications

Model: K2	Charger Efficiency: $\geq 73\%$
Input: 9V 1.7A/5V 2A	Output Power: 10W/7.5W/5W
Charger Distance: 2-8mm	Induction Distance: 5-8cm
Material: PC+ABS	Size: 79*109*43mm

Frequency Band: 111.22kHz-145.67kHz
H-field: -19.61dB μ A/m @ 10m

Packing details

Car Wireless Charger*1
Type-C Cable*1
User Manual*1
Car Charger*1(optional)
Sucker bracket*1(optional)

Cautions

1. Non-professionals, please do not open, repair or maintain this product;
2. Can not be used in humid environment;
3. Please do not knock it strongly;
4. Cleaning with chemical solvents is strictly prohibited;
5. Please do not pull the clamp arm too hard by hand;
6. Recommend to use certified QC 2.0 or QC 3.0 car charger, which can make wireless charging more efficient.

Mobile phones list with wireless charging function (not all listed):

Apple:	Samsung:
iPhone 8	Note 5 Note6 Note7
iPhone 8 Plus	Note8 Note9
iPhone X	S6 S6+ S7 S7+ S8 S8+
iPhone XS	S9 S9+ S10 S10e S10 5G S10+
iPhone XS Max	LG :
iPhone XR	G3 G6 G6+ G7 G7+ G7 ThinQ
Xiaomi :	G7+ ThinQ G8 G8 ThinQ V30 V30+
MIX 2S	V35 V40 ThinQ V50 V50 ThinQ
MIX3	Google :
Xiaomi 9	NEXUS 4 NEXUS 5 NEXUS 6
Huawei:	Pixel 3 Pixel 3XL
Mate RS Porsche	Nokia :
Mate20 Pro Mate20 RS Porsche	Lumia 720 Lumia 735 Lumia 810
P30 Pro	Lumia 820 Lumia 830 Lumia 920
Sharp:	Lumia 920T Lumia 928 Lumia 929
SH-02D SH-04D SH-07D	Lumia 930 Lumia 1520 Lumia Icon
SH-13C SH90B	SONY :
NTT Docomo :	Xperia Z3v Xperia XZ2 Xperia XZ3
SH-13C F-03D	KYOCERA :
SH-04D SH-05D	Brigadier DuraForce TORQUE
SH-02D N-01D F-09D SH-07D	DuraForce PRO DuraForce PRO 2
SH-09D P-06D	
SH-04E SH-06E	

FCC Statement

This device complies with Part 15 of the FCC Rules. Operation is subject to the following two conditions: (1) this device may not cause harmful interference, and (2) this device must accept any interference received, including interference that may cause undesired operation.

changes or modifications not expressly approved by the party responsible for compliance could void the user's authority to operate the equipment.

This equipment has been tested and found to comply with the limits for a Class B digital device, pursuant to Part 15 of the FCC Rules. These limits are designed to provide reasonable protection against harmful interference in a residential installation. This equipment generates, uses and can radiate radio frequency energy and, if not installed and used in accordance with the instructions, may cause harmful interference to radio communications. However, there is no guarantee that interference will not occur in a particular installation.

If this equipment does cause harmful interference to radio or television reception, which can be determined by turning the equipment off and on, the user is encouraged to try to correct the interference by one or more of the following measures:

- Reorient or relocate the receiving antenna.
- Increase the separation between the equipment and receiver.
- Connect the equipment into an outlet on a circuit different from that to which the receiver is connected.
- Consult the dealer or an experienced radio/TV technician for help.