

Quick Start Guide

Ultima

Version:

Date:

Each module of the device is optional, and the user can select the optional module according to the needs.
Modules with ★ are optional.

Device appearance

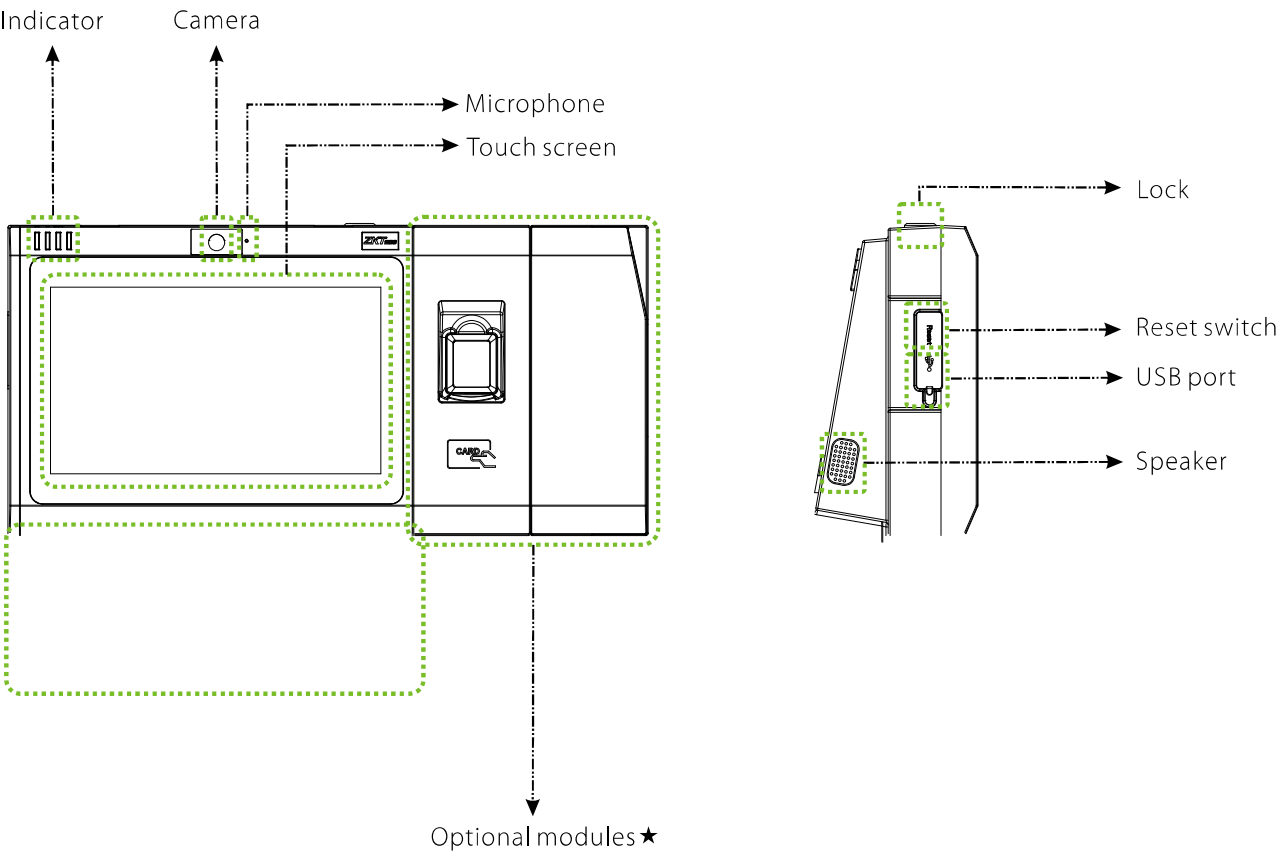

Optional modules★

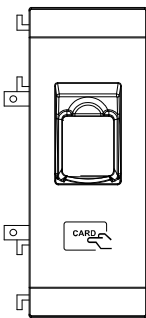

Fingerprint & RFID module

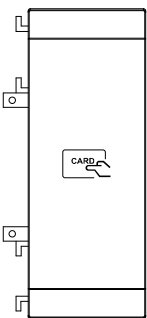

RFID module

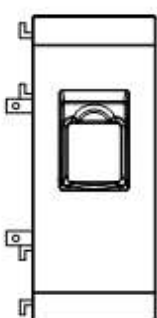

Fingerprint

Inside the device

Use the key to open the front cover of the device.

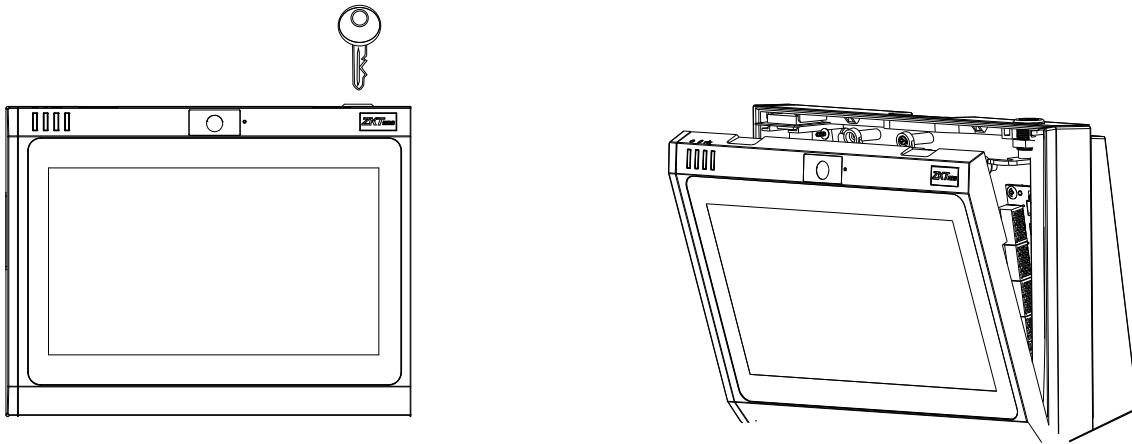

Optional modules★

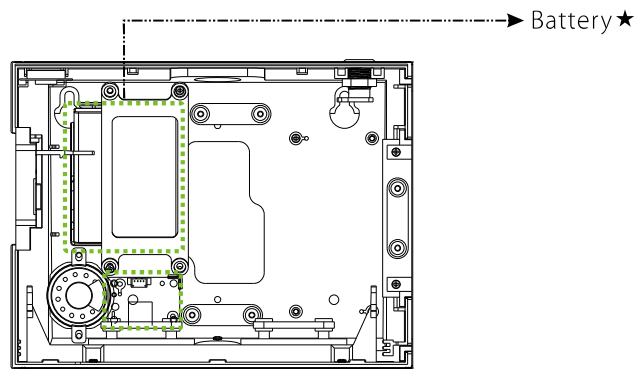

Wiring ports

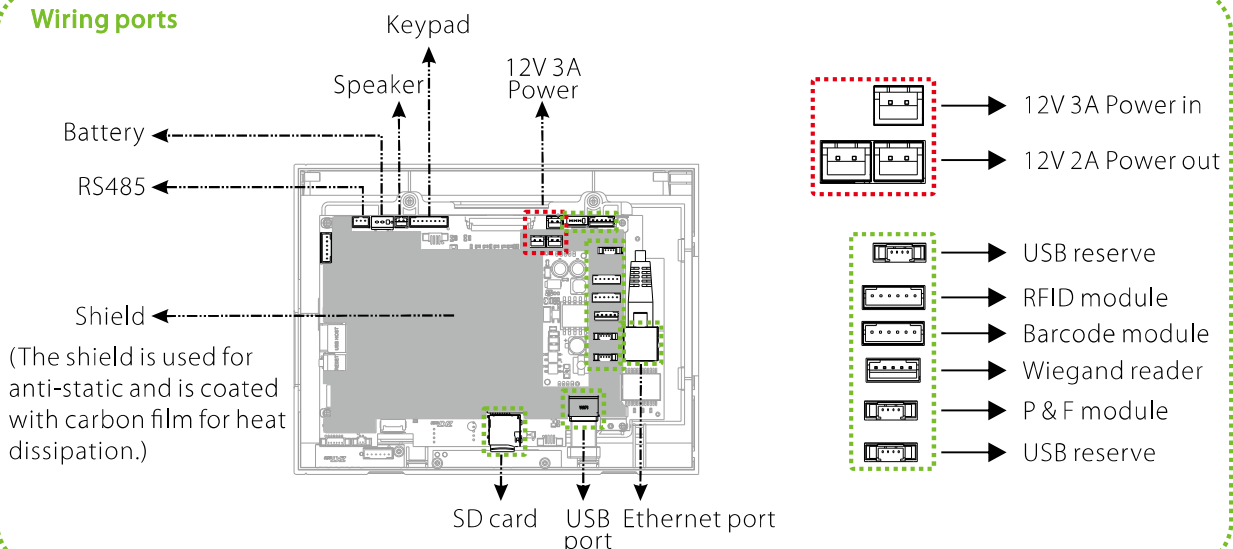

Device Installation

1

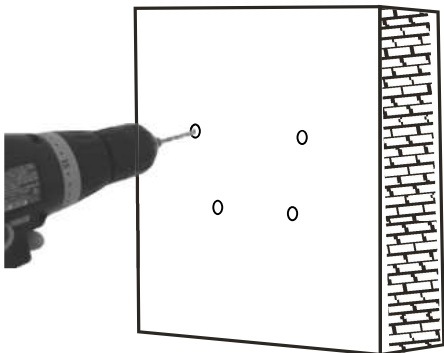

2

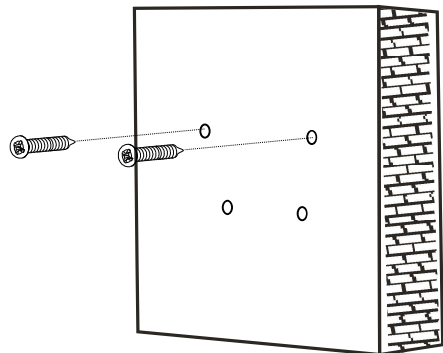

3

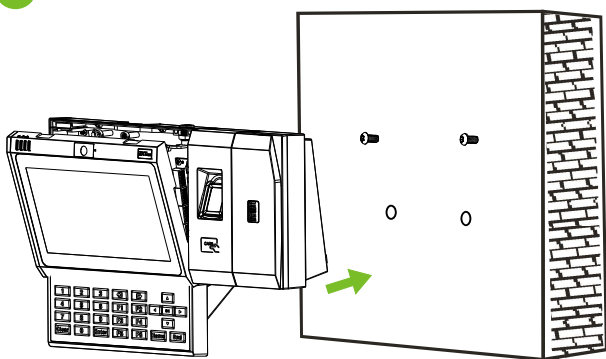

4

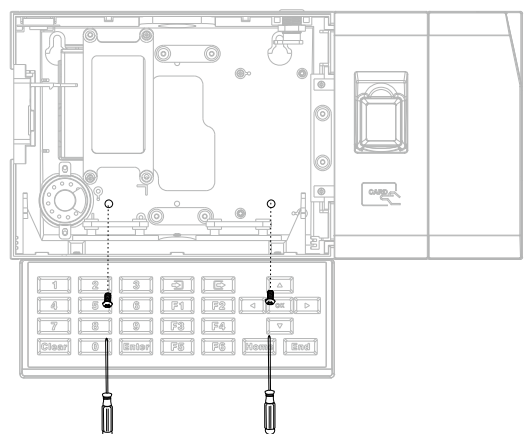

- ① Drill holes on the wall.
- ② Fix two screws on the wall.
- ③ Attach the device to the screws.
- ④ Fasten the device with two screws.

Note: The installation steps above are for device without any optional modules. Please drill enough holes and fix screws according to the actual device, and then connect the wiring.

Device Connection

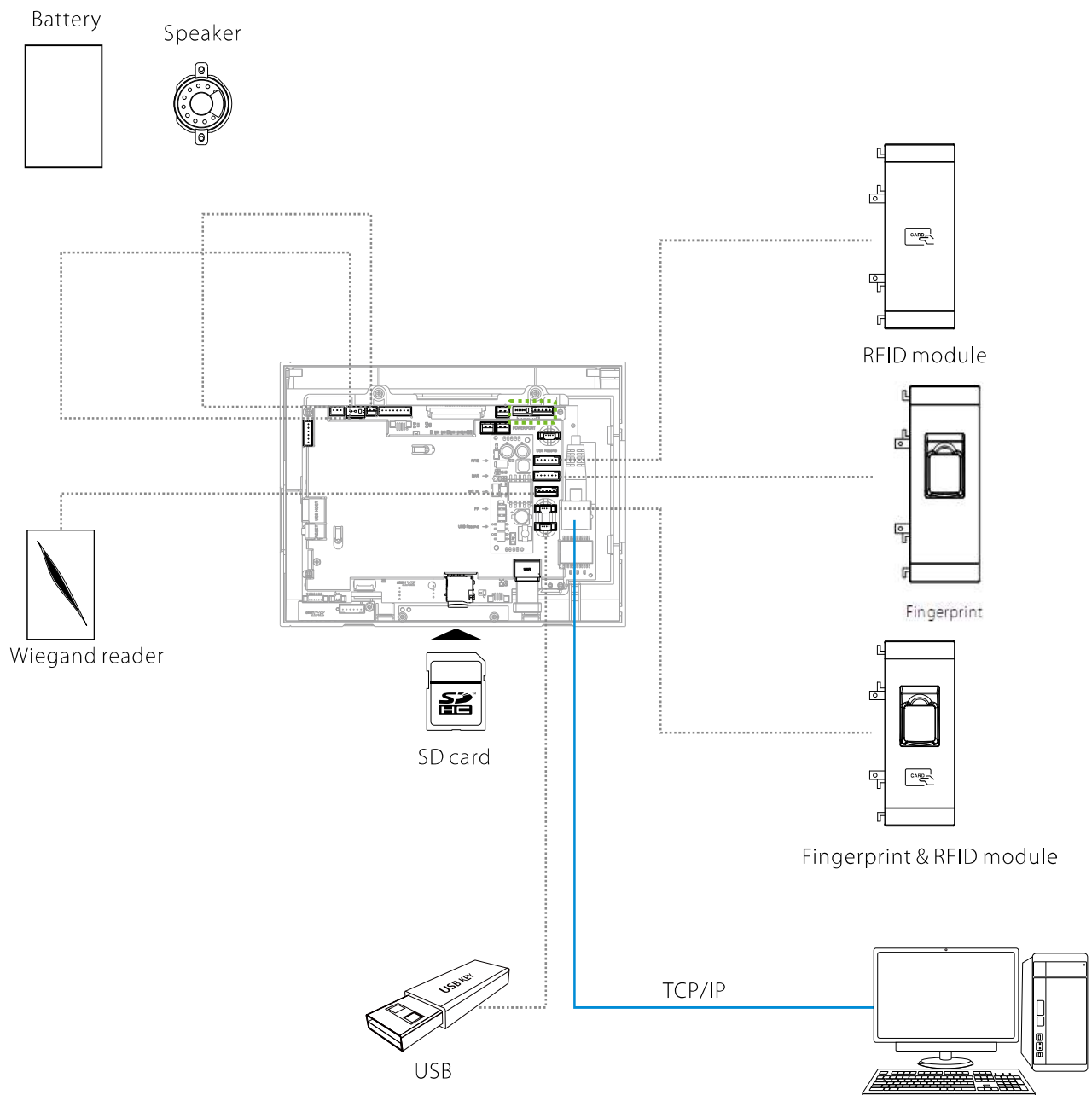

Basic Operation

Connect 12V 3A power supply to Power in port, the device automatically turns on.

❖ Initial Interface

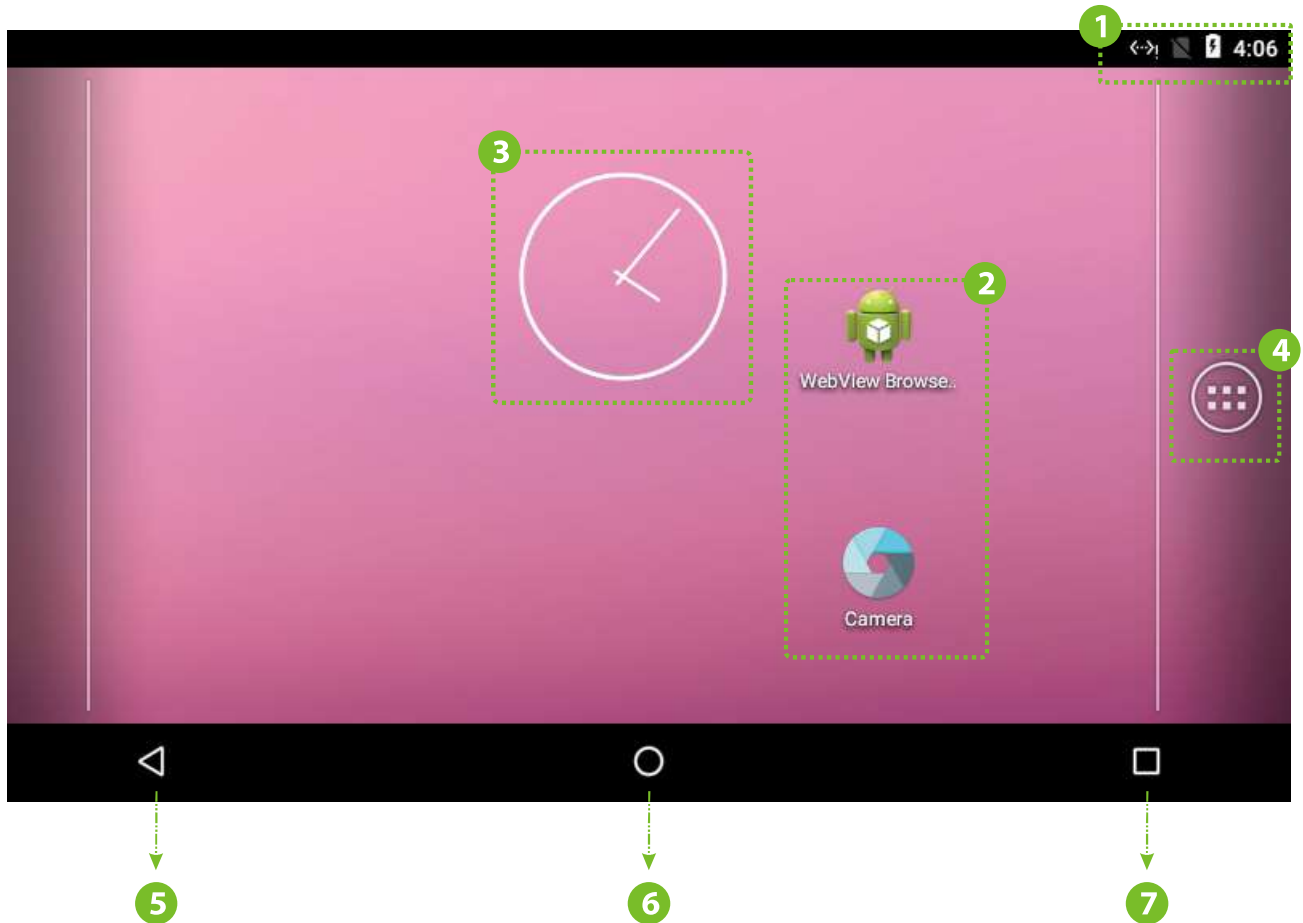

- 1 Status bar
- 2 Applications
- 3 Clock
- 4 Main interface key
- 5 Backspace key
- 6 Home key
- 7 Background key

Note: If you want to delete a widget or an application on the desktop, long press on the icon and drag it to the X area.

❖ Main Interface

Click  icon to enter to the main interface. You will see all the applications and widgets on it.

Click  icon to enter the Settings interface. You can set the Wireless & networks, Device, Personal and System.

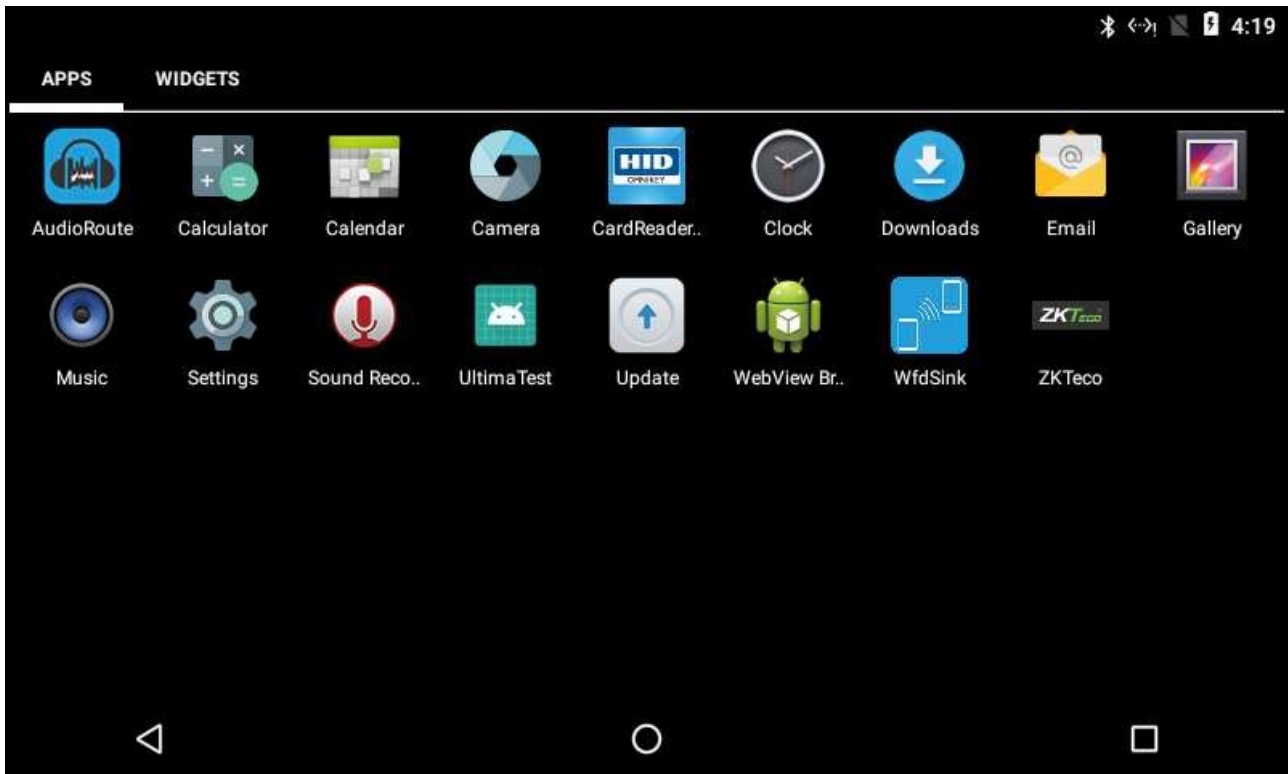

Note: If you want to add an application or a widget on the desktop, long press on the icon and drag it to the desktop.

Long press the status bar and slide down it. It will show the recent notifications that have not been read. Also you can quickly set functions such as Volume, Wi-Fi, and so on.

❖ Ultima test demo

Click  icon on the main interface main to enter the ultima test demo. You can test all the functions of the device.



Base unit and keypad

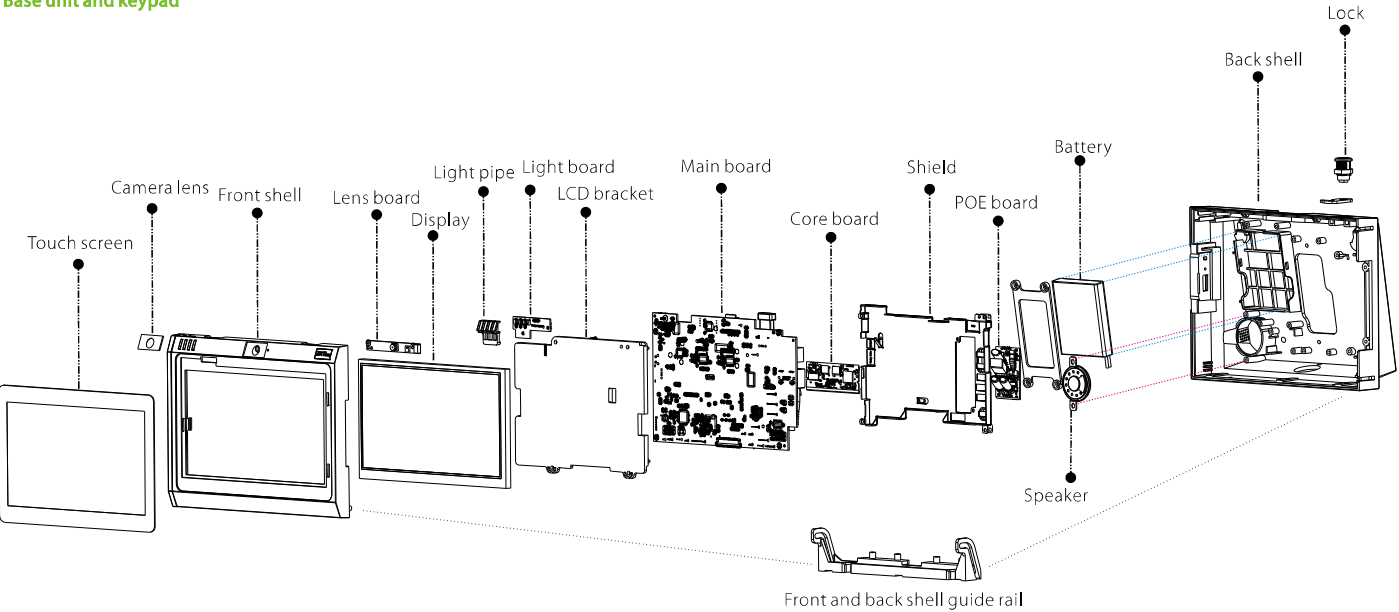

Optional modules★

Fingerprint & RFID module

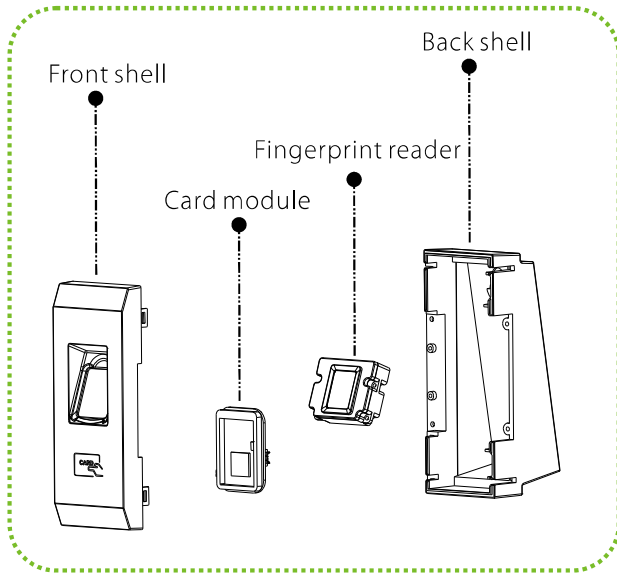

RFID module

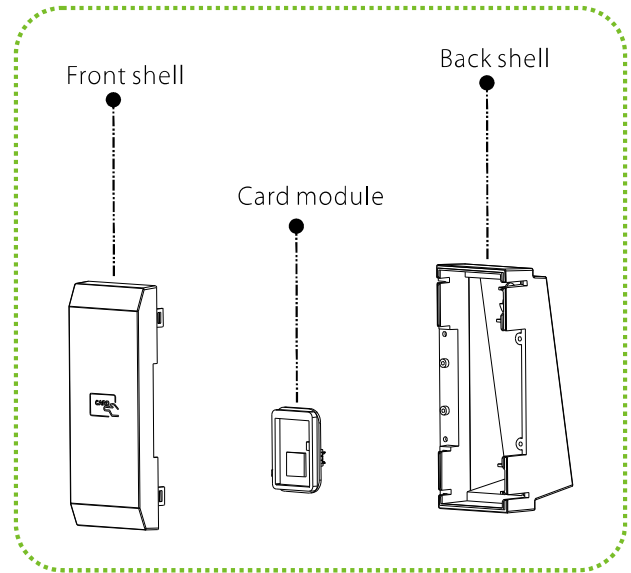

Fingerprint

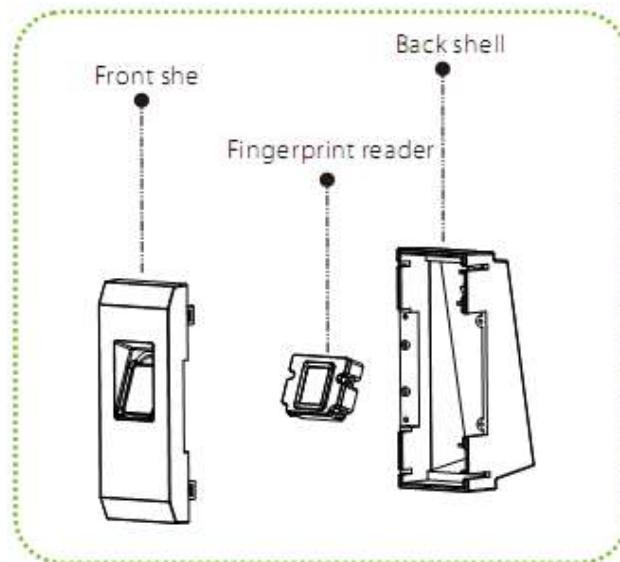

FCC Part 15 Compliance

CAUTION: Changes or modifications not expressly approved by the party responsible for compliance could void the user's authority to operate the product.

Note: This equipment has been tested and found to comply with the limits for a Class B digital device, pursuant to Part 15 of the FCC Rules. These limits are designed to provide reasonable protection against harmful interference in a residential installation. This equipment generates, uses and can radiate radio frequency energy and, if not installed and used in accordance with the instructions, may cause harmful interference to radio communications. However, there is no guarantee that interference will not occur in a particular installation. This equipment generates, uses and can radiate radio frequency energy and, if not installed and used in accordance with the instructions, may cause harmful interference to radio communications. However, there is no guarantee that interference will not occur in a particular installation. If this equipment does cause harmful interference to radio or television reception, which can be determined by turning the equipment off and on, the user is encouraged to try to correct the interference by one or more of the following measures:

receiver is connected.

- Reorient or relocate the receiving antenna.
- Increase the separation between the equipment and receiver.
- Connect the equipment into an outlet on a circuit different from that to which the
- Consult the dealer or an experienced radio/TV technician for help.

This equipment complies with FCC radiation exposure limits set forth for an uncontrolled environment.

This transmitter must not be co-located or operating in conjunction with any other antenna or transmitter.

This equipment should be installed and operated with minimum distance 20cm between the radiator and your body.

Supplier's Declaration of Conformity

47 CFR § 2.1077 Compliance Information

Trade Name: Data Collection Terminal

Madel: ULTIMA-200-G2,ULTIMA-G2,ULTIMA-BAR,ULTIMA-MAG,ULTIMA-SILKID,ULTIMA-LUM,ULTIMA-PRO
ULTIMA-PLUS,ORION -G2,ORION-BAR,ORION-MAG,ORION-TC1,ORION-SILKID,ORION-LUM
ORION-PRO,Orion-PLUS,CRONUS-200-G2,CRONUS-G2,CRONUS-BAR,CRONUS-MAG,CRONUS-SILKID,
CRONUS-LUM,CRONUS-PRO,CRONUS-PLUS,
PLATO-G2,PLATO-BAR,PLATO-MAG,PLATO-SILKID, PLATO-LUM,PLATO-PRO,PLATO-PLUS,
ULTIMA-FACE,ULTIMA-TOUCHLESS,ULTIMA--FT(face with thermal),ULTIMA-T(thermal),ULTIMA-P(for printer),
ULT-MAG,ULT-BAR,ULT-SILKID,ULT-FACE,ULT-FT,ULT-SLKID-MTPRO,ULT-face-MTPRO,
ULT-FT-MTPRO,ULT-PRO,WTPURULT200-G2,ULTIMA-FACE-G2,ULT-FACE-G2,ULTIMA-FT-G2,ULT-FT-G2

The functions of Wireless Access Systems including Radio Local Area Networks (WAS/RLANs) within the band 5150-5350 MHz for this device are restricted to indoor use only within all European Union countries.

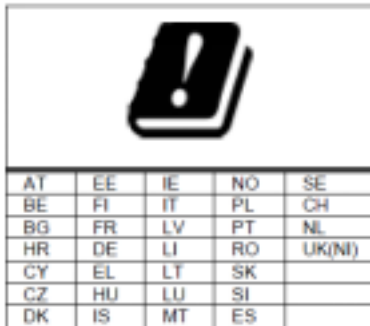

Technology	Modulation	Frequency band	Frequency range (transmitter/receiver)	Channel Bandwidth	Power
2.4G Wi-Fi	DSSS, OFDM	2412MHz-2472MHz	2412MHz-2472MHz	20MHz/40MHz	17.71dBm
5G Wi-Fi	OFDM	5150MHz-5700MHz	5150MHz-5700MHz	20MHz/40MHz /80MHz	9.93dBm
5.8G Wi-Fi	OFDM	5745MHz-5825MHz	5745MHz-5825MHz	20MHz/40MHz /80MHz	13.06dBm
NFC	ASK	13.56MHz	13.56MHz	660Hz	-12.36dBuA/m @10m
RFID	ASK	125kHz	125kHz	22 Hz	16.68 dBuA/m @10m
RFID	ASK	134.2kHz	134.2kHz	22 Hz	16.39 dBuA/m @10m

* Disposal of a battery into fire or a hot oven, or mechanically crushing or cutting of a battery, that can result in an explosion.

* Leaving a battery in an extremely high temperature surrounding environment that can result in an explosion or the leakage of flammable liquid or gas

Customer: ZKTECO EUROPE SL

Customer Address: Crta.de Fuencarral 44. Edificio 1. Planta 2.28108, Alcobendas. Madrid. SPAIN

Responsible Party – U.S. Contact Information

ZK Technology LLC DBA ZK Teco

200 Centennial Ave, Suite 211, Piscataway, NJ, 08854. U.S.