

Can't connect? Need help?



**DO NOT RETURN THIS
PRODUCT TO THE STORE**

Geeni support:
support.mygeeni.com
or tap 'Support' for help in the Geeni app.

Aroma Diffuser **START GUIDE**

MERKURY
INNOVATIONS

Thank you for purchasing your GEENI smart home product. Get started using your new devices by downloading Geeni, one convenient app that manages everything straight from your phone or tablet. Easily connect to your home Wi-Fi and control multiple devices from the touch of your fingertips.

Contents

Download & Register & Important Safeguards	2-5
Starting Diffuser & Cleaning	6-9
Connect (Easy Mode)	10-11
Connect (AP Mode)	12-13
Questions, Troubleshooting, Notices	14-16

FCC Notice

Any changes or modifications not expressly approved by the party responsible for compliance could void the user's authority to operate this equipment.

This device complies with Part 15 of the FCC Rules. Operation is subject to the two following conditions:

1. This device may not cause harmful interference.
2. This device must accept any interference received, including interference that may cause undesired operation.

This equipment has been tested and found to comply with the limits for a Class B digital device, pursuant to Part 15 of the FCC Rules. These limits are designed to provide reasonable protection against harmful interference in a residential installation. This equipment generates, uses and can radiate radio frequency energy and, if not installed and used in accordance with the instructions, may cause harmful interference to radio communications. However, there is no guarantee that interference will not occur in a particular installation.

If this equipment does cause harmful interference to radio or television reception, which can be determined by turning the equipment off and on, the user is encouraged to try to correct the interference by one or more of the following measures:

- Reorient or relocate the receiving antenna.
- Increase the separation between the equipment and receiver.
- Connect the equipment into an outlet on a circuit different from that to which the receiver is connected.
- Consult the dealer or an experienced radio/TV technician for help.

To maintain compliance with FCC's RF Exposure guidelines, This equipment should be installed and operated with minimum distance between 20cm the radiator your body: Use only the supplied antenna.

Note: This equipment has been tested and found to comply with the limits for a Class B digital device, pursuant to Part 15 of the FCC Rules. These limits are designed to provide reasonable protection against harmful interference in a residential installation.

Important Information:

Before installing, read and follow all precautions, including the following:

CAUTION: Suitable for indoor use only.

DO NOT IMMERSE IN WATER. DO NOT EXCEED RATED CAPACITY.

1. This appliance can be used by children aged from 8 years and above and persons with reduced physical, sensory or mental capabilities or lack of experience and knowledge if they have been given supervision or instruction concerning use of the appliance in a safe way and understand the hazards involved
2. Children shall not play with the appliance
3. Cleaning and user maintenance shall not be made by children without supervision
4. The appliance is only to be used with the power supply unit provided.

Support:

If you encounter any issues, please visit us at support.mygeeni.com for help.

To explore our full selection of products, visit us at: www.mygeeni.com

(888) 232-3143 Toll-free (English Only)

© 2019 Mercury Innovations • 45 Broadway 3rd FL, New York NY 10006.

The illustrated product and specifications may differ slightly from those supplied. Geeni is a trademark of Mercury Innovations LLC. iPhone, Apple and the Apple logo are trademarks of Apple Inc., registered in the U.S. and other countries. App Store is a service mark of Apple Inc. Galaxy S is a registered trademark of Samsung Electronics Co., Ltd. Google, Google Play, and related marks and logos are trademarks of Google LLC. iOS is a registered trademark of Cisco in the U.S. and other countries and is used under license. Amazon, Alexa and all related logos are trademarks of Amazon.com, Inc. or its affiliates. All other trademarks and trade names are those of their respective owners.

Made in China

Troubleshooting

Cannot connect to your Wi-Fi network.

Make sure you entered the correct Wi-Fi password during the Wi-Fi setup. Check whether there are any Internet connection problems. If the Wi-Fi signal is too weak, reset your Wi-Fi router and try again.

Reset the device

Reset once (press & hold Wi-Fi button) to reach Easy Mode, which is the primary way the app will try to connect. (When in Easy Mode, you'll see the LED flashing quickly, 2x per second)

Reset again (press & hold reset button) to reach AP, which is the Backup Mode to help connect. (When in AP Mode, you'll see the LED blinking slowly, every 3 seconds)

System Requirements

- Mobile device running iOS® 9 or higher or Android™ 5.0x or higher
- Existing Wi-Fi Network

Technical Specifications

- Power: 12W
- Capacity: 300ml
- Timer: 1/3/6 hour

What's in the Box

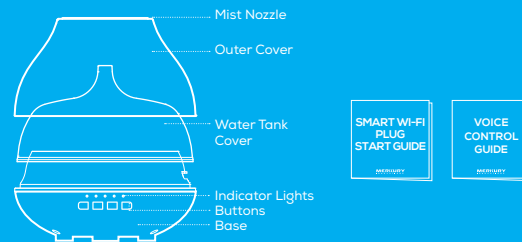

- Smart Wi-Fi Essential Oil Diffuser
- Measuring Cup
- Power Adapter
- User Manual
- Voice Control Guide

Get Ready

- Know your Wi-Fi network and password
- Make sure your mobile device is running iOS® 9 or higher or Android™ 5.0x or higher
- Make sure you're connecting to a 2.4GHz Wi-Fi network (Geeni can't connect to 5GHz networks)

1

Download the Geeni app from App Store or Google Play.

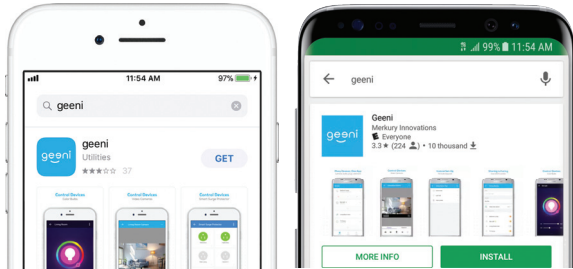

2

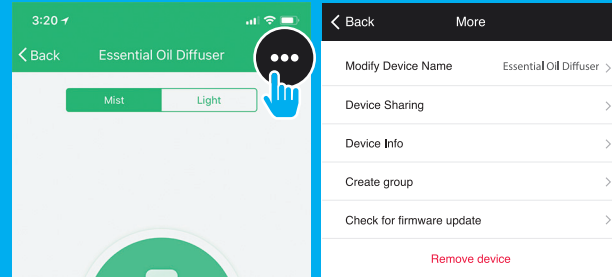

5. The device appears offline or unreachable, what should I do?

Make sure your Wi-Fi router is online and in range.

Make sure you have the latest Geeni functionality by clicking "Check for firmware update" in your device settings.

6. What's the Wireless Range?

The range of your home Wi-Fi is heavily dependent on your home router and the conditions of the room. Check with your router specifications for exact range data.

7. If my Wi-Fi/Internet goes down, will Geeni still work?

Geeni products need to be connected to Wi-Fi in order to use them remotely.

Frequently Asked Questions

1. Can I share with family and friends?

Yes, you can share your device with family and friends who will have access to control your bulbs, plugs, cameras, and other Geeni devices. In the Geeni app, press the Profile button and click on the "Device Sharing" button, and you will be able to give or revoke sharing permissions. In order to share, the other user should already have downloaded the Geeni app and registered a new account.

2. Can I group multiple Geeni devices together?

Yes, you can group multiple devices of the same type together, by room, location, or however else you want. From your main device list, click on one of the devices you want to group, press the "... " button on the top right for advanced settings, and click Create Group. You'll then be able to choose which devices you'd like to group together and will be able to rename them.

3. How Many Devices Can I Control?

Geeni's app can control an unlimited amount of devices in an unlimited amount of locations. Your router may have a limit of how many devices can be connected to one router.

4. My Geeni device has a funny name. How do I rename it?

From your main device list, click on one of the devices you want to rename, press the "... " button on the top right for advanced settings, and click Modify Device Name (or Modify Group Name, if applicable). You'll then be able to choose a more familiar name.

2

Register an account on your Geeni app.

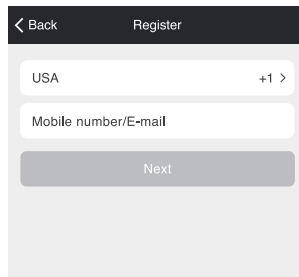

STEP 1.
Enter your mobile phone number
or email address.

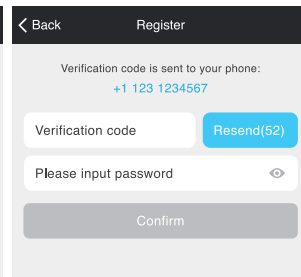

STEP 2.
Enter the verification code
and create a password.

2

Register an account on your Geeni app.

STEP 3.
Login to the App.

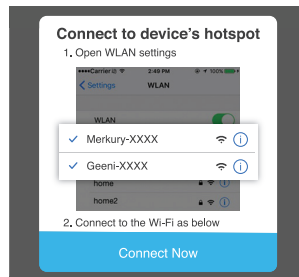

STEP 4.
Follow the instructions to choose the device from your Wi-Fi list.

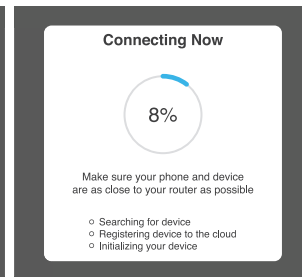

STEP 5.
The device will connect.

7

Add device. Method 2: Backup AP Mode

STEP 1.

Make sure the device is in AP Mode, blinking slowly (see reset instructions on p. 5)

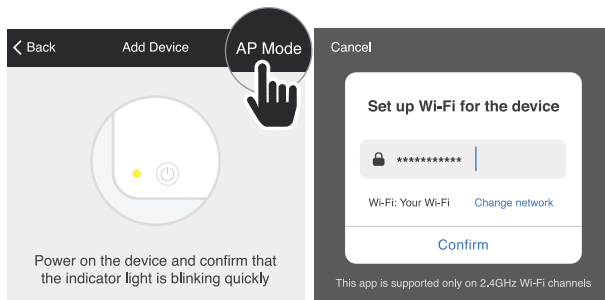

STEP 2.

In the Geeni app, on the top corner of the Devices screen, click (+).

Choose "Smart Appliances"
Choose "AP Mode" in the top corner.

STEP 3.

Click Next and enter your Wi-Fi details.

3

Important safeguards

This product is designed for household use only - When using electrical appliances, basic safety precautions should always be followed, including the following:

1. READ ALL INSTRUCTIONS.
2. To protect against fire, electrical shock and personal injury, do not immerse this appliance, including cord and plug, in water or other liquid.
3. Close supervision is necessary when any appliance is used by or near children.
4. Unplug from outlet when not in use, before putting on or taking off parts, and before cleaning.
5. Do not operate any appliance with a damaged cord or plug or after the appliance malfunctions or has been damaged in any manner. To avoid hazards, return the appliance to Merkury Innovations for examination, repair or adjustment.
6. The use of accessory attachments not recommended by the manufacturer may result in fire, electric shock or injury to persons.
7. Do not use outdoors.
8. Do not let cord hang over edge of table or counter, or touch hot surfaces.
9. Do not place on or near a hot gas or electric burner or in a heated oven.
10. Do not use appliance other than for its intended use, as described in this manual.

4 Getting ready.

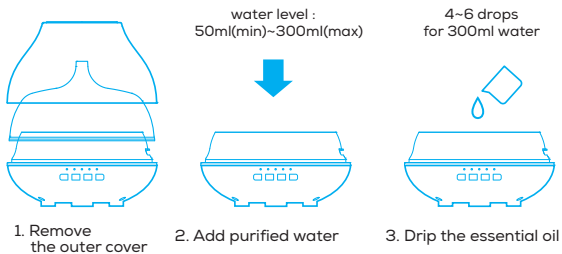
- 
1. Remove the outer cover
 2. Add purified water
water level : 50ml(min)~300ml(max)
 3. Drip the essential oil
4~6 drops for 300ml water

Use included measuring cup to fill water tank

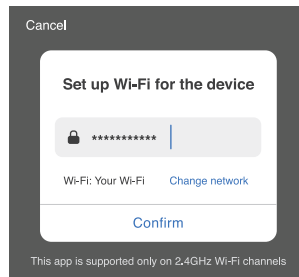

STEP 4.
Enter your Wi-Fi network and password.

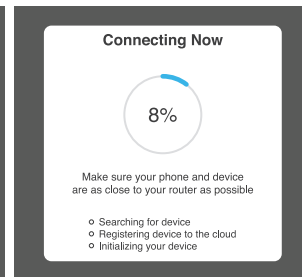

STEP 5.
The Geeni app will try to connect your device.

*If the connection fails, try to connect using AP Mode.
NOTE: Geeni can't connect to 5GHz networks.

6

Add device. Method 1: Easy Mode

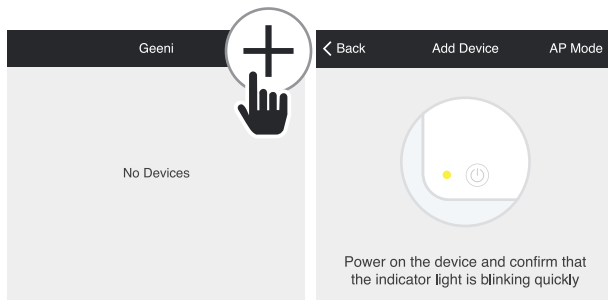

STEP 2.

In the Geeni app, on the top corner of the Devices screen, click (+).

Choose "Smart Appliances"

STEP 3.

Make sure the indicator light on the device is flashing rapidly indicating the device is ready to connect using Easy Mode. If not, press and hold the Button for 3 seconds until the indicator light is flashing rapidly, then press "Next Step".

4

Starting the diffuser

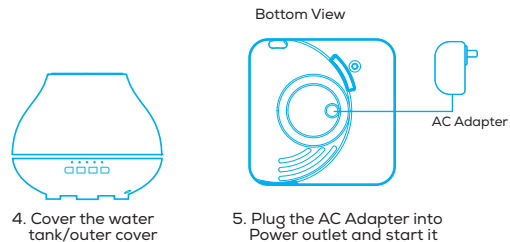



4 Using controls



Connect the diffuser

- Long press “” for 5 seconds to set until the indicator light flashes quickly to put the diffuser in pairing mode. You can now pair the diffuser with the Geeni App.

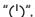
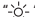
Operate the diffuser

- Press “”, to turn the diffuser on and off.
- Press “”, each time this button is pressed, the mood LED will change color.
- Press “” button, to set the diffuser to change timer settings. The default timer is 1 hour. Press the button again to change the timer to 3 hours. Press a 3rd time to set to 6 hours. Press once again and the timer will be turned off.

NOTE : DO NOT open the outer cover or fill with water/oil while misting

5 Cleaning

For safety, it is suggested to clean the diffuser every 5-6 days or after 9~10 times of usage. The cleaning procedures are as follows:

- Disconnect the adaptor from the AC power source or turn off the power source.
- Place the diffuser on a flat and stable place such as table. Remove the outer cover and the water tank cover. Ensure that the place is flat and stable to avoid the water leakage.
- When pouring out the water, keep the mist nozzle up. Don't let any water flow inside the circuitry.
- Clean the ultrasonic vibration plate at the bottom of the water tank with a cotton swab; clean the outer cover with cloth or cotton swab.
- Clean every 2-3 days.
- When there is dirt like aroma or oil in the cover of the diffuser or the water tank, please clean it with a dried cloth with kitchen soap and warm water.
- After cleaning, please add purified water into the water tank, then power on the diffuser for 30 minutes, drain the water out and dry the water tank. You can store the diffuser after it is dried out.
- When there is dirt on the mist nozzle, please remove the outer cover, clean it with a neutral detergent. After it is dried, you can use the diffuser again.

NOTE : Neutral detergent is strongly recommended for cleaning. Any detergent containing chlorine, acid, enzyme left inside the tank may produce hazardous effects and maybe harmful.