

THINKCAR  
V-BIKE

Quick Start Guide

1 Quick Start Manual



Sensor Body



Anti-theft Nut



Special Wrench

2 Technical Specifications

Operating Temperature	-40°C to +105°C
Dimensions (Diameter × Height)	21 mm × 16.96 mm
Operating Frequency	2.4GHZ
Waterproof Rating	IP67

3 Installation Guide

**Note:** After installing one sensor, perform the pairing operation with the i-VENU APP and the sensor. Once the pairing is completed, proceed with the installation of the next sensor.

**(1) Clean the valve stem:** Remove the original valve stem cap. Use a clean cloth to carefully wipe the exterior of the valve stem, ensuring it is free of dust, sand, oil, or any remnants of old seals.

**(2) Install the anti-theft nut:** Screw the anti-theft nut clockwise to the bottom of the valve stem.

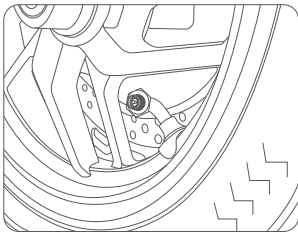

**(3) Install the Sensor:** Rotate the sensor clockwise by hand to install it onto the valve stem until it can no longer be easily twisted.

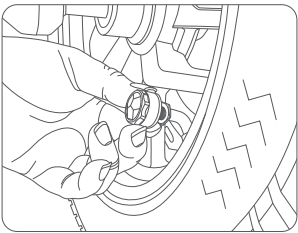

**(4) Final Tightening:** Use the special wrench included with the sensor to tighten the anti-theft nut towards the sensor. Stop tightening once you feel noticeable resistance, and check for any air pressure leakage.

**Note:** Never use excessive force! Over-tightening is the most common cause of valve core damage, air leakage, or even breakage.

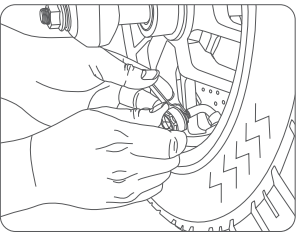

**(5) Pairing:** Download the i-VENU APP and complete the registration. Follow the instructions in the beginner's guide to proceed. Once paired successfully, the current tire pressure, temperature, and other data will be displayed.

**(6)** The installation steps for the remaining tires are the same as above.

**(7) i-VENU APP download QR code:**



4 Warranty

THINKCAR guarantees this sensor for a period of 12 months. If there are any material or manufacturing defects, the product will be repaired or replaced free of charge. During the warranty period, THINKCAR reserves the right to decide whether to replace any product. The warranty will be void under the following conditions:

1. Improper installation or misuse of the product;
2. Defects caused by non-THINKCAR low-frequency induction products;
3. Damage resulting from collision or tire failure; and
4. Losses caused by exceeding specified pressure/speed limits.

SIMPLIFIED EU DECLARATION OF CONFORMITY

Hereby, THINKCAR TECH CO., LTD. declares that this equipment is in compliance with Directive 2014/53/EU.

The full text of the EU declaration of conformity is available at the following internet address:  
[https://h5.mythinkcar.com/update\\_app/productlist](https://h5.mythinkcar.com/update_app/productlist)



THINKCAR

## FCC Warning

This device complies with part 15 of the FCC Rules. Operation is subject to the following two conditions:  
(1) This device may not cause harmful interference, and (2) this device must accept any interference received, including interference that may cause undesired operation.

Any Changes or modifications not expressly approved by the party responsible for compliance could void the user's authority to operate the equipment.

**Note:** This equipment has been tested and found to comply with the limits for a Class B digital device, pursuant to part 15 of the FCC Rules. These limits are designed to provide reasonable protection against harmful interference in a residential installation. This equipment generates uses and can radiate radio frequency energy and, if not installed and used in accordance with the instructions, may cause harmful interference to radio communications. However, there is no guarantee that interference will not occur in a particular installation. If this equipment does cause harmful interference to radio or television reception, which can be determined by turning the equipment off and on, the user is encouraged to try to correct the interference by one or more of the following measures:

- Reorient or relocate the receiving antenna.
- Increase the separation between the equipment and receiver.
- Connect the equipment into an outlet on a circuit different from that to which the receiver is connected.
- Consult the dealer or an experienced radio/TV technician for help.

The device has been evaluated to meet general RF exposure requirement. The device can be used in portable exposure condition without restriction.

## IC Warning

This device complies with Industry Canada's licence-exempt RSSs. Operation is subject to the following two conditions:

- (1) This device may not cause interference; and
- (2) This device must accept any interference, including interference that may cause undesired operation of the device.

The device has been evaluated to meet general RF exposure requirement. The device can be used in portable exposure condition without restriction.

Cet appareil est conforme aux CNR exemptes de licence d'Industrie Canada . Son fonctionnement est soumis aux deux conditions suivantes :

( 1 ) Ce dispositif ne peut causer d'interférences ; et

( 2 ) Ce dispositif doit accepter toute interférence , y compris les interférences qui peuvent causer un mauvais fonctionnement de l'appareil.

Le dispositif a été conçu pour répondre à la demande générale de radioexposition.