

WYZELOCK

QUICK START GUIDE

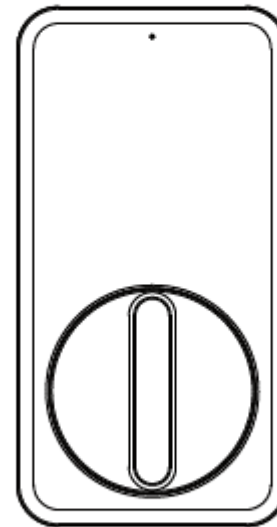

NEED MORE HELP?

Resources & Support
support.wyze.com

Community
forums.wyze.com

Wyze Labs, Inc
www.wyze.com
Built in partnership with Lockin

WELCOME

Congrats on your new Wyze Lock!

Installation will take roughly 15 minutes and will require a Phillips screw driver (not included).

Now let's get started!

IN THE BOX

Wyze Lock	x1
Wyze Lock Gateway	x1
Quick Start Guide	x1
AA Batteries	x4
Adhesive Strip	x1
Mounting Plate	x1
Adapter	x3

Lock - front
Front plate on

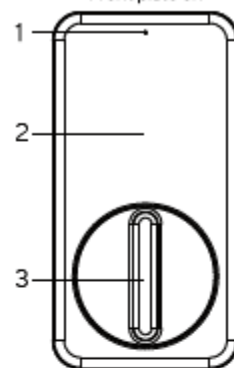

Lock - front
Front plate off

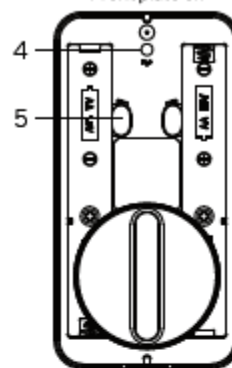

Lock - back

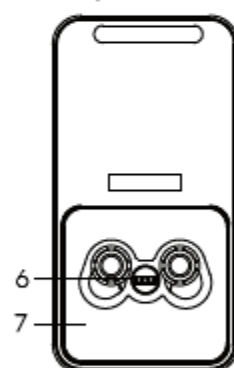

Gateway - front

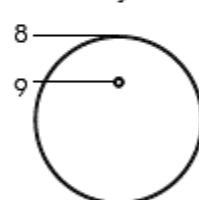

- | | |
|--------------------|--------------------|
| 1. Indicator Light | 6. Adapter |
| 2. Front Plate | 7. Mounting Plate |
| 3. Knob | 8. Setup Button |
| 4. Pair Button | 9. Indicator Light |
| 5. Battery Latch | |

OVERVIEW

Wyze lock makes your existing deadbolt smart by replacing the interior thumb latch, it does not alter the exterior lock.

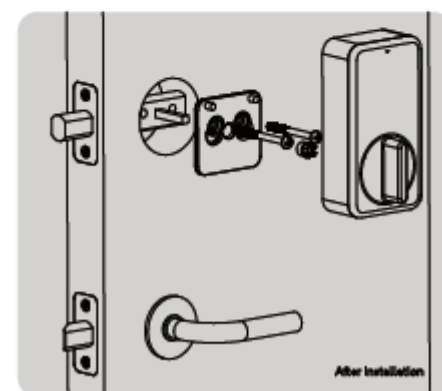
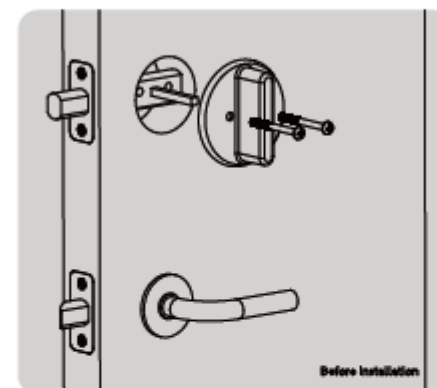

SETUP

1. Download the Wyze app

Log in or create a Wyze account



2. Set up the Lock Gateway

Plug the Lock Gateway into an outlet near your door (within 50 feet). In the Wyze app, tap the 3 dots on the top right corner of the Home Page. Select "Add a Product" and then "Wyze Lock Gateway". Follow the instructions in the app to complete setup.

3. Install and set up the Lock

After setting up the Gateway, continue following the in-app installation and setup instructions to complete Lock set up.

4

LIGHT INDICATIONS

Lock

 **Flashing Green Light**
The Lock is ready to connect

 **Flashing Green/Red Light**
The Lock is updating its firmware

 **Solid Red Light**
The Lock failed to lock or unlock

 **Solid Green Light**
The Lock successfully locked or unlocked

Lock Gateway

 **Solid Green Light**
The Gateway is working properly

 **Flashing Red Light**
The Gateway failed to connect to WiFi

 **Flashing Green Light**
The Gateway is ready to connect

 **Flashing Blue Light**
The Gateway is ready to pair to a lock

5

TROUBLESHOOTING

1. My Gateway will not connect to the network

Ensure your router has the 2.4GHz band enabled as the Wyze Lock Gateway cannot connect to 5GHz networks. If problems persist, try moving the Gateway closer to your router.

2. I can't get the Gateway and Lock to pair

Make sure the Lock Gateway's indicator light is flashing blue/red showing it is in pairing mode. If problems persist, move the Wyze Lock Gateway closer to the Lock or remove obstacles that may inhibit the signal.

3. My Lock is getting jammed

Remove the Wyze Lock from the mounting plate and the loosen the screws attaching the mounting plate to the door. Ensure the mounting plate is properly aligned and that you're using the correct adapter. Retighten the mounting plate's screws (do not over tighten) and try manually locking the door. If problems persist, your deadbolt may be misaligned to the doorjamb requiring additional adjustments.

6

FCC Part 15 Compliance

CAUTION: Changes or modifications not expressly approved by the party responsible for compliance could void the user's authority to operate the product.

Note: This equipment has been tested and found to comply with the limits for a Class B digital device, pursuant to Part 15 of the FCC Rules. These limits are designed to provide reasonable protection against harmful interference in a residential installation. This equipment generates, uses and can radiate radio frequency energy and, if not installed and used in accordance with the instructions, may cause harmful interference to radio communications. However, there is no guarantee that interference will not occur in a particular installation. If this equipment does cause harmful interference to radio or television reception, which can be determined by turning the equipment off and on, the user is encouraged to try to correct the interference by one or more of the following measures:

- Reorient or relocate the receiving antenna.
- Increase the separation between the equipment and receiver.
- Connect the equipment into an outlet on a circuit different from that to which the receiver is connected.
- Consult the dealer or an experienced radio/TV technician for help.

This equipment complies with FCC radiation exposure limits set forth for an uncontrolled environment.

This transmitter must not be co - located or operating in conjunction with any other antenna or transmitter.

This equipment should be installed and operated with minimum distance 20cm between the radiator and your body.

This device complies with Part 15 of the FCC Rules. Operation is subject to the following two conditions:

- (1) this device may not cause harmful interference,
- (2) and (2) this device must accept any interference received, including interference that may cause undesired operation.

ISED Regulatory Compliance

This device contains licence-exempt transmitter(s)/receiver(s) that comply with Innovation, Science and Economic Development Canada's licence-exempt RSS(s).

Operation is subject to the following two conditions:

1. This device may not cause interference.
2. This device must accept any interference, including interference that may cause undesired operation of the device.

L'émetteur exempt de licence contenu dans le présent appareil est conforme aux CNR d'Innovation, Sciences et Développement économique Canada applicables aux appareils radio exempts de licence. L'exploitation est autorisée aux deux conditions suivantes :

1. L'appareil ne doit pas produire de brouillage;
2. L'appareil doit accepter tout brouillage radioélectrique subi, même si le brouillage est susceptible d'en compromettre le fonctionnement.

This equipment complies with IC RSS-102 radiation exposure limits set forth for an uncontrolled environment. This transmitter must not be co-located or operating in conjunction

with any other antenna or transmitter.

This equipment should be installed and operated with minimum distance 20cm between the radiator and your body.

Cet équipement est conforme aux limites d'exposition aux radiations IC CNR-102 établies pour un environnement non contrôlé. Cet émetteur ne doit pas être situé ou fonctionner conjointement avec une autre antenne ou un autre émetteur.

Cet équipement doit être installé et utilisé avec une distance minimale de 20 cm entre le radiateur et votre corps.

CAN ICES-3 (B)/NMB-3(B)