

TX1 & TX2

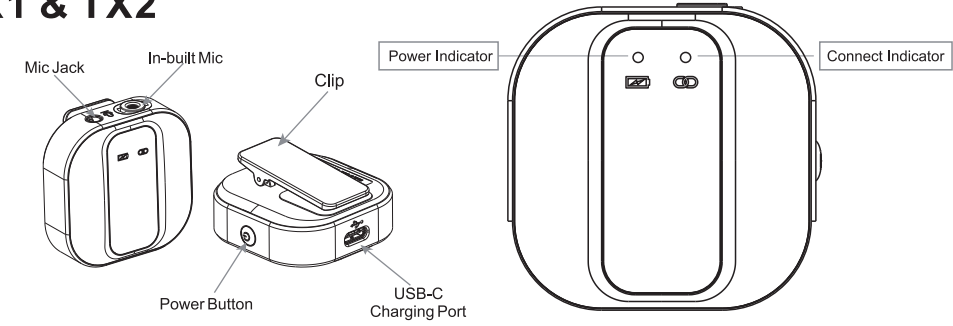

Indicator Function

Status	Power Indicator(red)	Power Indicator(blue)	Connect Indicator(red)	Connect Indicator(blue)
Flash slowly	Low power	/	/	Not connected
Quick flash 3 times, then off	Lacking power and automatically turned off	/	/	/
Keep on and light	Charging(on)	Full Charge(off)	Mic Mute	Complete connection

Button Function

1. ON / OFF
Press for 3 seconds ON/OFF the Transmitter.

2. MICROPHONE MUTE FUNCTION
In the power on state, short press the power button to realize the microphone MUTE / RECEPTION function.

RX

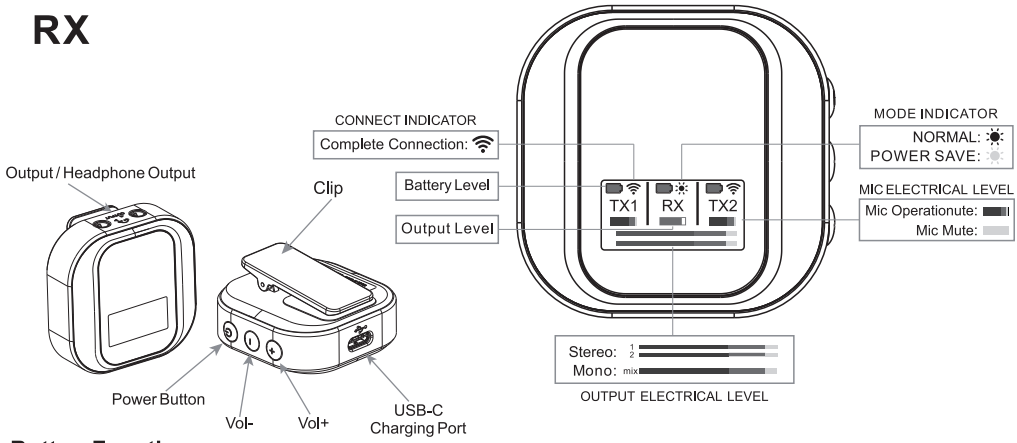

Button Function

1. ON / OFF
Press for 3 seconds ON/OFF the Receiver

2. NORMAL /POWER SAVE MODE SWITCHING
In the power on state, short press the power button once to enter the mode switching function, and the mode indication signal flashes. At the same time, short press the Vol + button to realize the NORMAL / POWER SAVE MODE SWITCHING , After completing the adjustment, stand for 5 seconds to exit the channel switching function.

2. MONO / STEREO CHANNEL SWITCHING
In the power on state, short press the power button twice to enter the channel switching function, and the output level flashes. At the same time, short press the Vol + button to realize MONO / STEREO CHANNEL SWITCHING, After completing the adjustment, stand for 5 seconds to exit the channel switching function.

TX1 & TX2

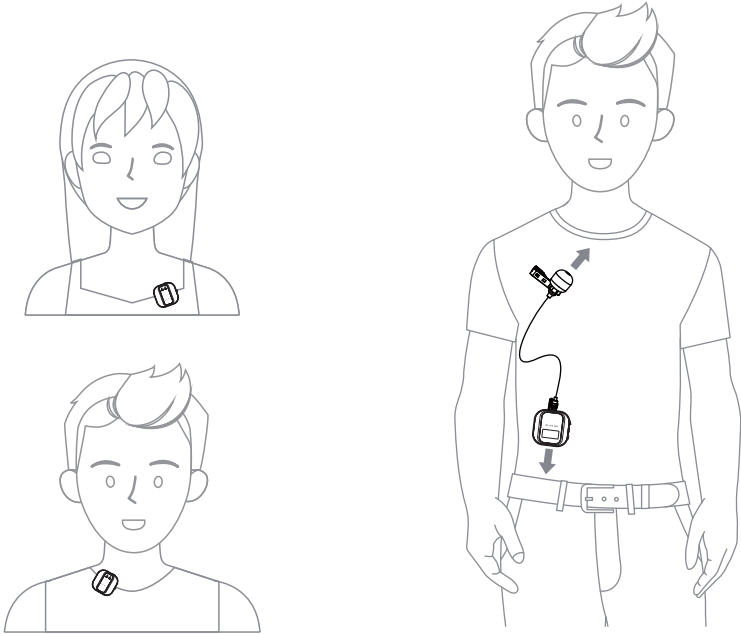

RX

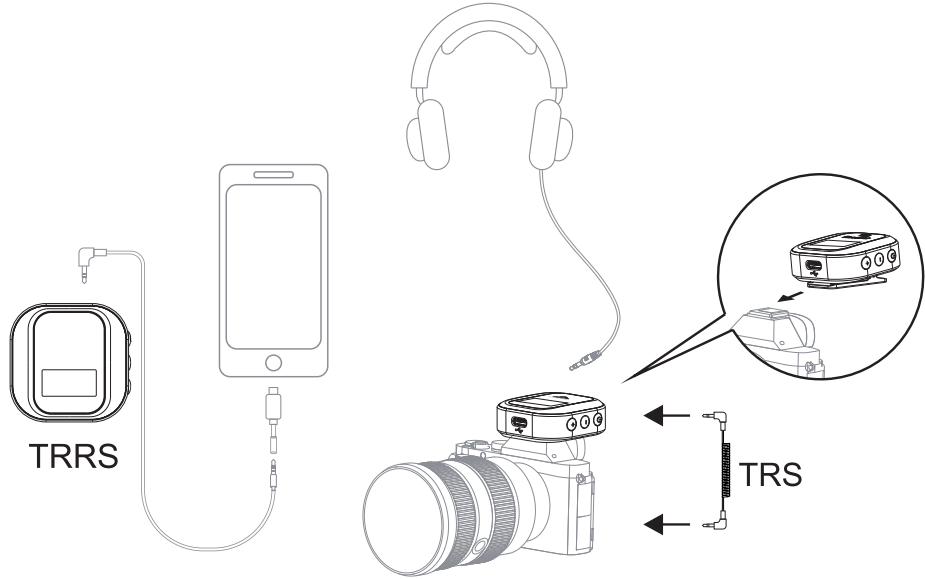

INSTRUCTION MANUAL

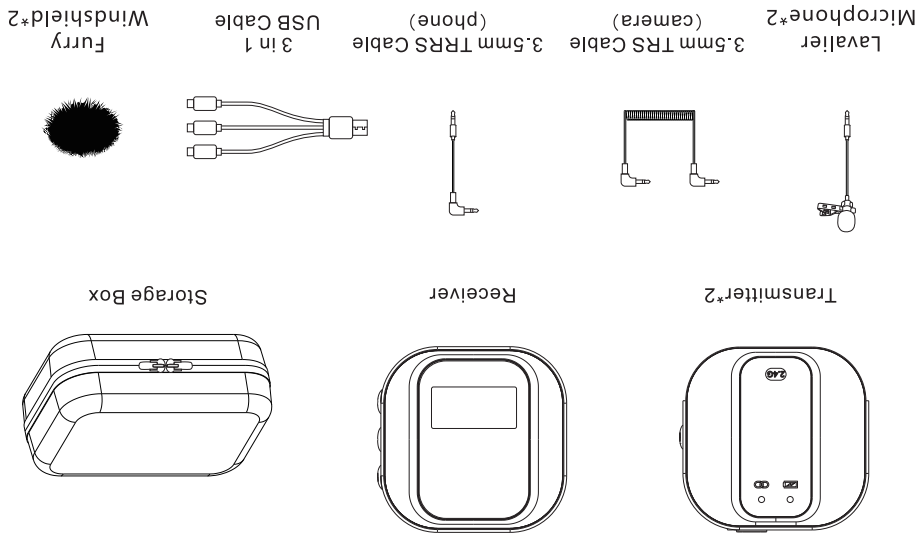
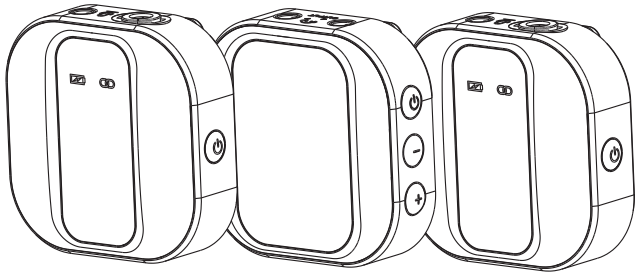

This device complies with Part 15 of the FCC Rules. Operation is subject to the following two conditions: (1) this device may not cause harmful interference, and (2) this device must accept any interference received, including interference that may cause undesired operation

NOTE: This equipment has been tested and found to comply with the limits for a Class B digital device, pursuant to Part 15 of the FCC Rules. These limits are designed to provide reasonable protection against harmful interference in a residential installation. This equipment generates, uses and can radiate radio frequency energy and, if not installed and used in accordance with the instructions, may cause harmful interference to radio communications. However, there is no guarantee that interference will not occur in a particular installation.

If this equipment does cause harmful interference to radio or television reception, which can be determined by turning the equipment off and on, the user is encouraged to try to correct the interference by one or more of the following measures:

- Reorient or relocate the receiving antenna.
- Increase the separation between the equipment and receiver.
- Connect the equipment into an outlet on a circuit different from that to which the receiver is connected.
- Consult the dealer or an experienced radio/TV technician for help.

Warning: changes or modifications not expressly approved by the party responsible for compliance could void the user's authority to operate the equipment

The devices has been evaluated to meet general RF exposure requirement , the device can be used in portable exposure condition without restriction