

AXIOMA

ULTRASONIC WATER METER

QALCOSONIC W1 INSTALLATION INSTRUCTIONS

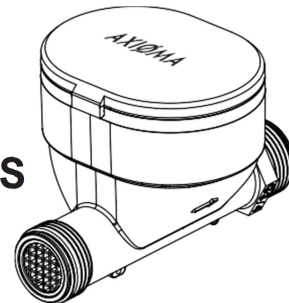

SAFETY INFORMATION

Before beginning installation works you must to read this document and follow its instructions.

The meter is powered from the battery (3.6 V), risk factors during the meter installation and service fluid flowing within flow sensor with inner pressure up to 1,6 MPa and temperature up to 194 °F.

Only qualified technical personnel may install and maintain water meters. Personnel must be familiar with appropriate technical documentation and general safety instructions. It is necessary to follow general safety requirements during installation and maintenance process.

Safety guarantees at installation and service of meter is:

- Hermetic fitting of primary flow sensor into the pipeline,
- Reliable fastening of water meter at installation.

WARNING! Mounting of the sub-assemblies of water meter is permissible only after ensuring of absence of fluid and pressure in the pipeline.
CAUTION: If this equipment is used in a manner not specified by the manufacturer, the protection provided by the equipment may be impaired.

PACKAGE CONTENT

Each package contains: water meter and optional connection kit (if ordered).



TRANSPORTATION AND STORAGE CONDITIONS

Packed meters may be transported in any type of covered vehicle. Equipment should be anchored reliably to avoid shock and possibility to shift inside vehicle.

Meters should be protected against mechanical damage and shock.
No aggressive chemical substances should be stored together because of corrosion hazard.

Storage and transportation temperature:
-13°F...158 °F (drained flow part)
Humidity: not more than 93%.



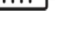

ESSENTIAL INFORMATION

	Water temperature max. 194 °F
	Ambient temperature range 5 °F...+158 °F
	Operating pressure max 16 bar
	Battery lifetime 16 years *

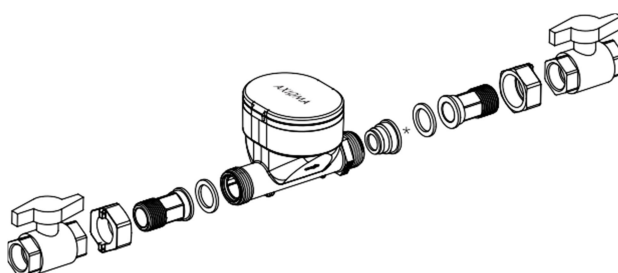
*at an ambient temperature of 68 °F.

Flow direction is indicated by an arrow on the meter body. Maximum admissible working pressure (Pressure class) 16 bar (MAP16). Installation location must be protected from direct sunlight. Exposure to direct sunlight is not permitted.



G3/4"	G1"
	
1.06"	1.22"
	
30 Nm	35 Nm

COMPONENTS REQUIRED TO INSTALL THE METER

A set of couplings with gaskets.
Please ALWAYS use new gaskets.

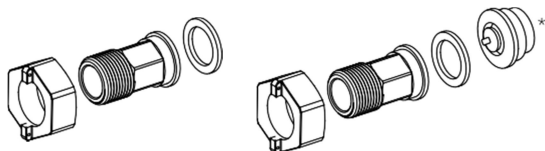

*Backflow valve is an optional component.
If this valve is used, it is mandatory to use a gasket attached to the valve.
The valve is mounted on the meter output.

CLASSIFICATION OF ENVIRONMENTAL CONDITIONS





Classification of the environment, climatic and mechanic conditions - B class according to EN ISO 4064-1:2017

Classification of the environment and mechanical conditions M1 class - according to Directive 2014/32/EU of 26 February 2014

Electromagnetic environments - E1, E2 class according to EN-ISO 4064:2014 and to Directive 2014/32/EU of 26 February 2014

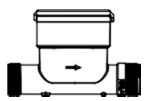
INSTALLATION REQUIREMENTS

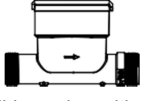
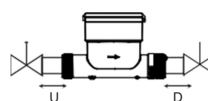
Installation possibilities and requirements

			 Possible work position	
QALCOSONIC W1	✓	✓		U0 D0

INSTALLATION GUIDELINES

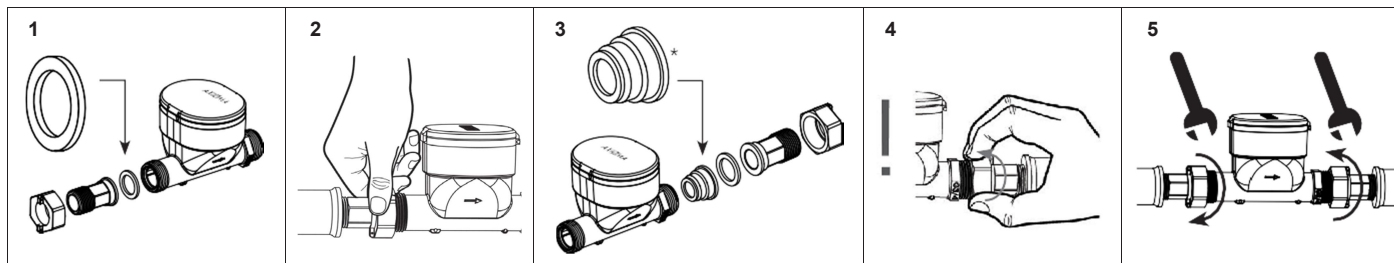

NOTE. The transport mode will turn off automatically (the ability to transmit data via radio will be activated) when the meter starts operation and the volume integrator has accumulated more than 10 liters.

*Backflow valve is an optional component. If this valve is used, it is mandatory to use a gasket attached to the valve. The valve is mounted on the meter output.

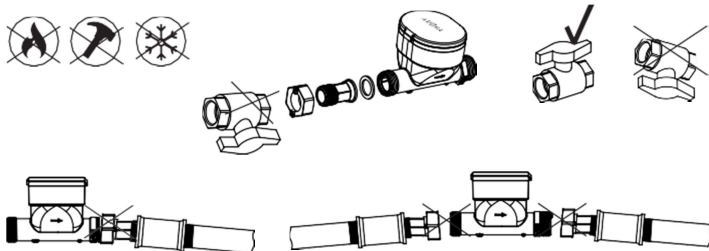

FOR SEALING OF METER AFTER INSTALLATION, THERE ARE PROVIDED HOLES IN THE METER BODY:



AUTOMATED METER READING



FOR EU CUSTOMERS ONLY - WEEE MARKING



Marking of electrical and electronic equipment in accordance with Article 14 (2) of Directive 2012/19/EU

This symbol on the product indicates that it will not be treated as household waste. It must be handed over to the applicable take-back scheme for the recycling of electrical and electronic equipment. For more detailed information about the recycling of this product, please contact your local municipal office.

IT IS PROHIBITED TO DISPOSE A METER MARKED WITH THIS SIGN INTO AN UNSORTED MUNICIPAL WASTE CONTAINER TOGETHER WITH OTHER WASTE!

EU DECLARATION OF CONFORMITY

EU DECLARATION OF CONFORMITY

Axioma Metering UAB hereby declares that the water meter QALCOSONIC W1 conforms to the essential requirements of the following Directives:

2014/32/EU

Directive 2014/32/EU of the European Parliament and of the Council of 26 February 2014 on the harmonisation of the laws of the Member States relating to the making available on the market of measuring instruments (recast).

2014/30/EU

Directive 2014/30/EU of the European Parliament and of the Council of 26 February 2014 on the harmonisation of the laws of the Member States relating to electromagnetic compatibility (recast).

2014/35/EU

Directive 2014/35/EU of the European Parliament and of the Council of 26 February 2014 on the harmonisation of the laws of the Member States relating to the making available on the market of electrical equipment designed for use within certain voltage limits.

2014/53/EU

Directive 2014/53/EU of the European Parliament and of the Council of 16 April 2014 on the harmonisation of the laws of the Member States relating to the making available on the market of radio equipment.

EU-Type Examination Certificate No LT-1621-MI001-034

The Notified Body: Laboratory of Heat Equipment Research and Testing of the Lithuanian Energy Institute, Lithuania, Notified Body Number 1621.

MANUFACTURER'S ADDRESS:

AXIOMA METERING UAB / Veterinarų str. 52, Biruliškės / Kaunas region, LT-54469 / Lithuania / metering@axioma.eu / axiomametering.com tel. +370 37 360 234 / fax. +370 37 360 358.