

Universal Functions Smart Locker

MANUALS

PART-1 Administrator's operations (Locker registration & Testing)

- 1.1 Main Menu of Universal Locker
- 1.2 Administrator Login
 - 1.2.1 EQUIPMENT REGISTRATIN
 - 1.2.2 EQUIPMENT TESTING

PART-2 Couriers' Operations (Courier registration & Drop-off)

- 2.1 Courier Registration on locker's screen
- 2.2 Courier Drop-off Procedures
 - 2.2.1 Courier drop off
 - 2.2.2 Locker box type selection
 - 2.2.3 Input Recipient Information

PART-3 Recipient's Operations (Pick Up)

- 3.1 Pick-up procedures
- 3.2 Key Returning

PART-1 Administrator's operations (Locker registration & testing)

1.1 Main Menu of Universal Locker:

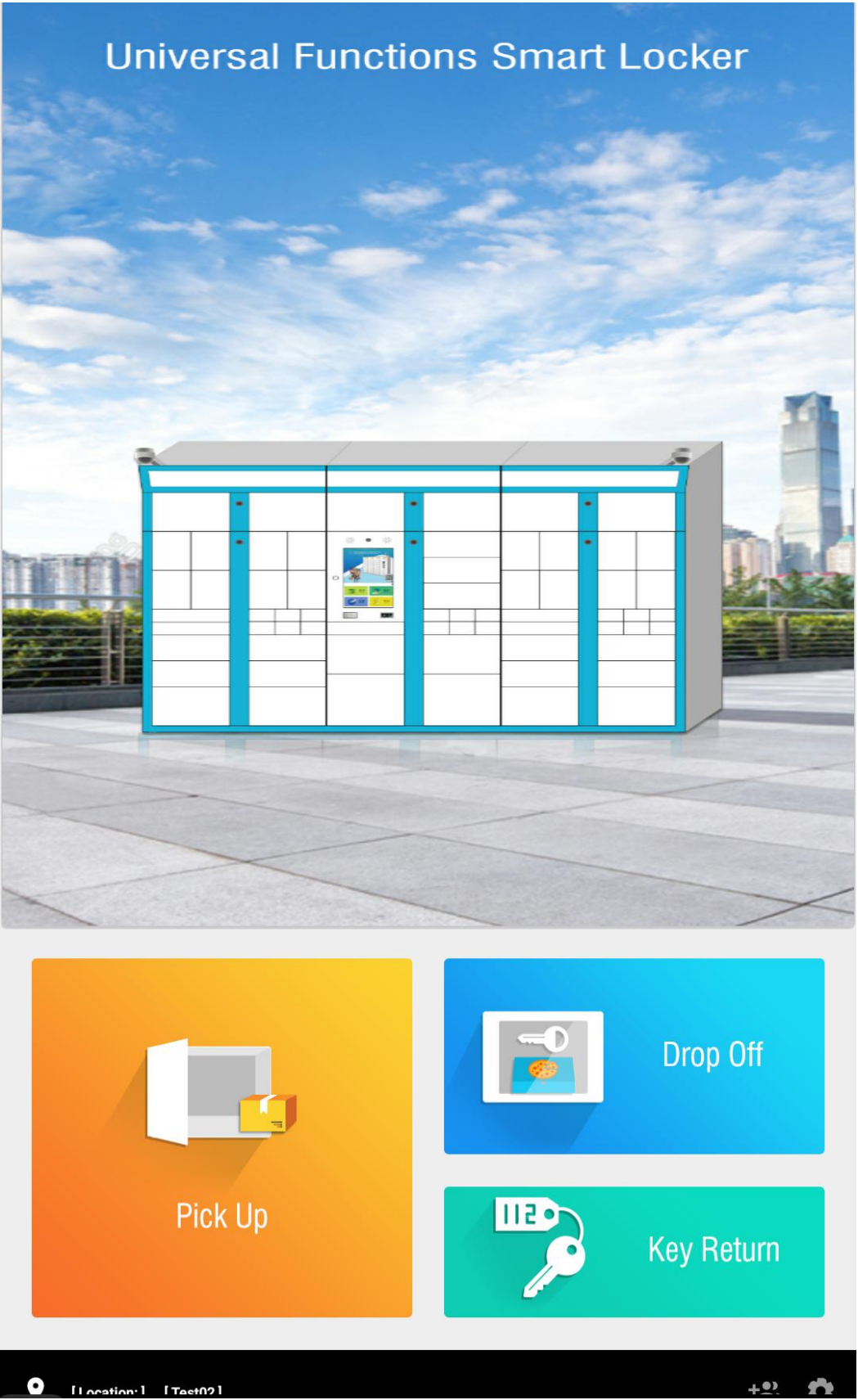

1.2 Administrator Login



Press button at bottom right corner, input Service code (BM), User account, Password, press NEXT login.

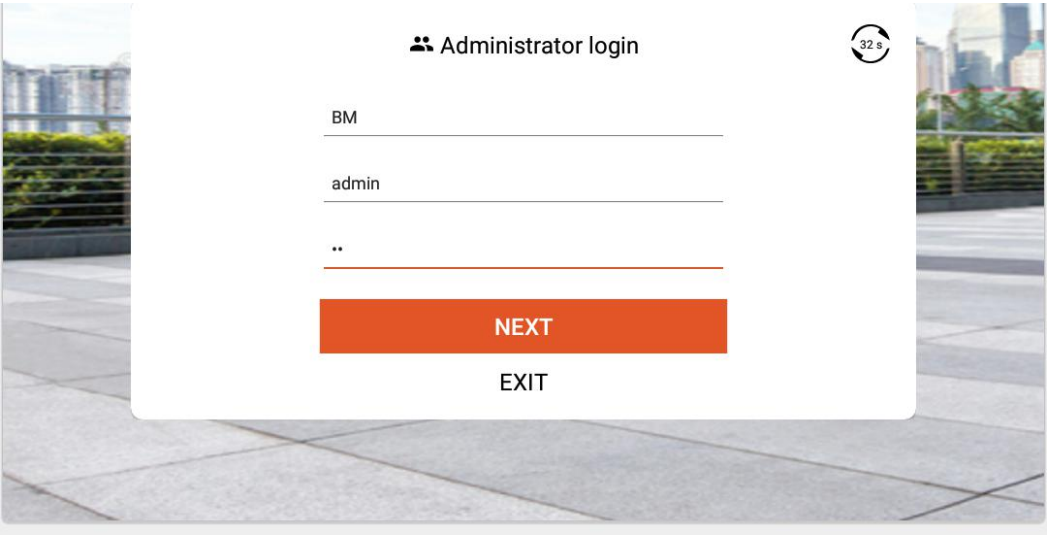

Main menus displaying after login successfully:

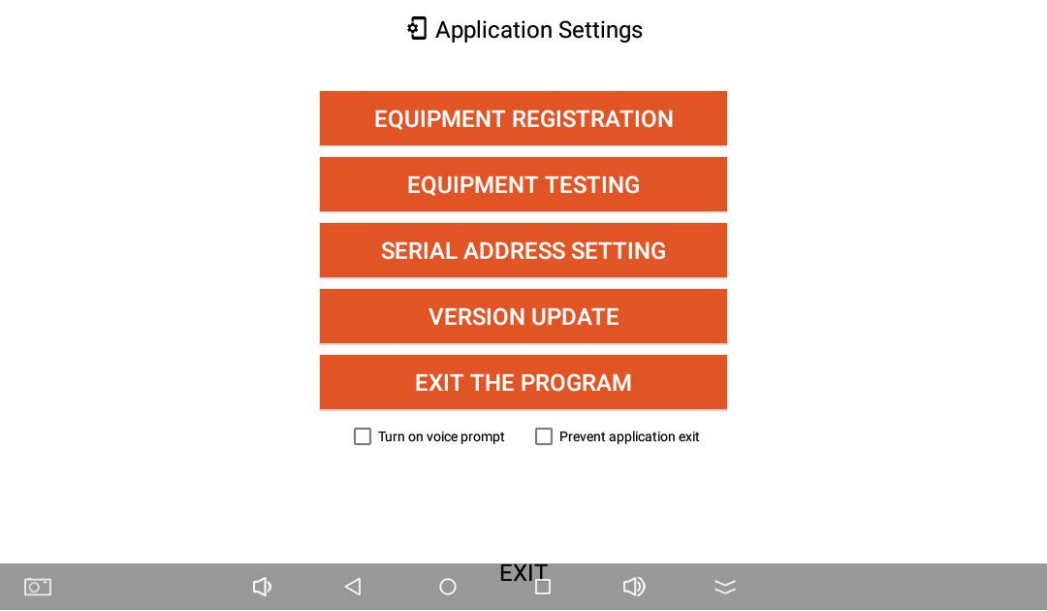

1.2.1 EQUIPMENT REGISTRATIN: input the Locker ID

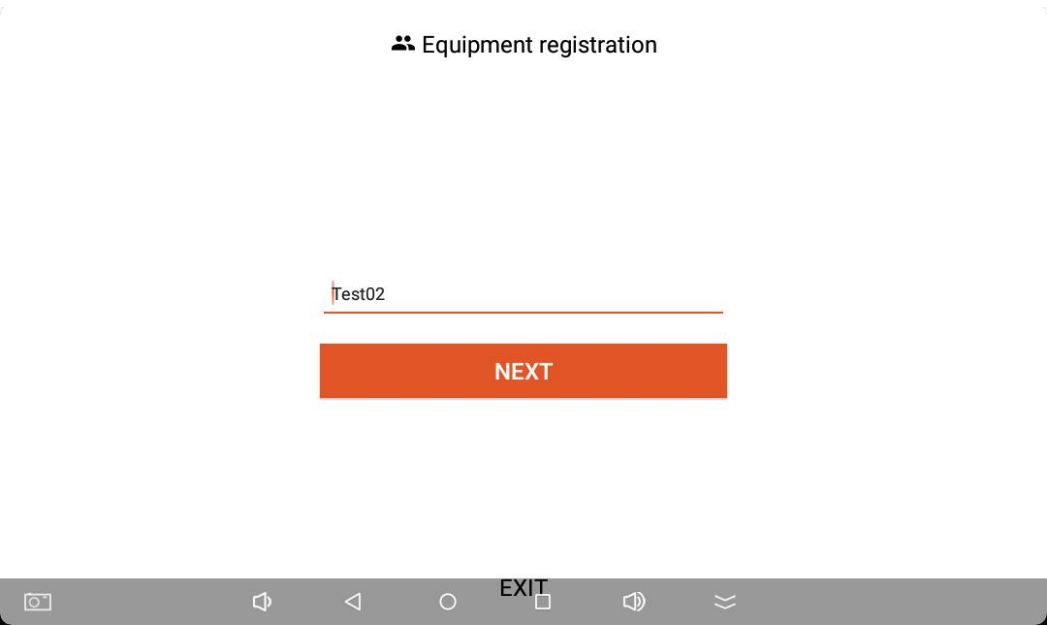

1.2.2 EQUIPMENT TESTING: check all electronic locks (locker doors) status

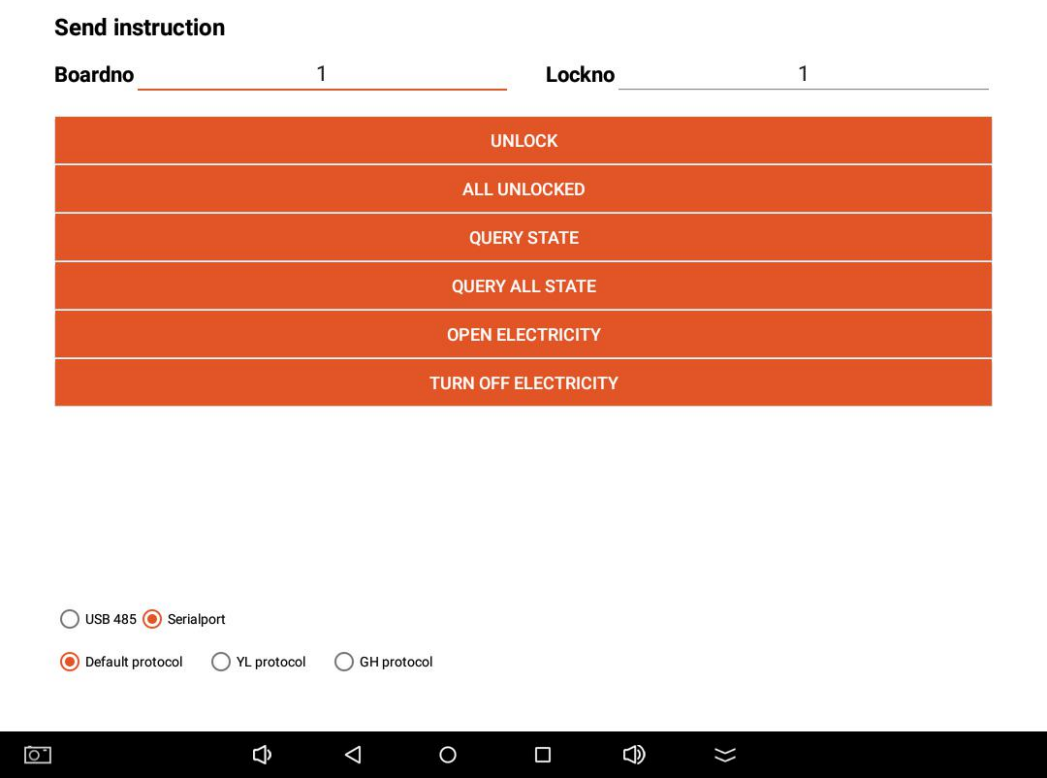

2.2 Courier Drop-off Procedures:

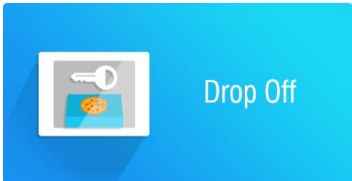

2.2.1 Courier press button, Login interface displaying as below:

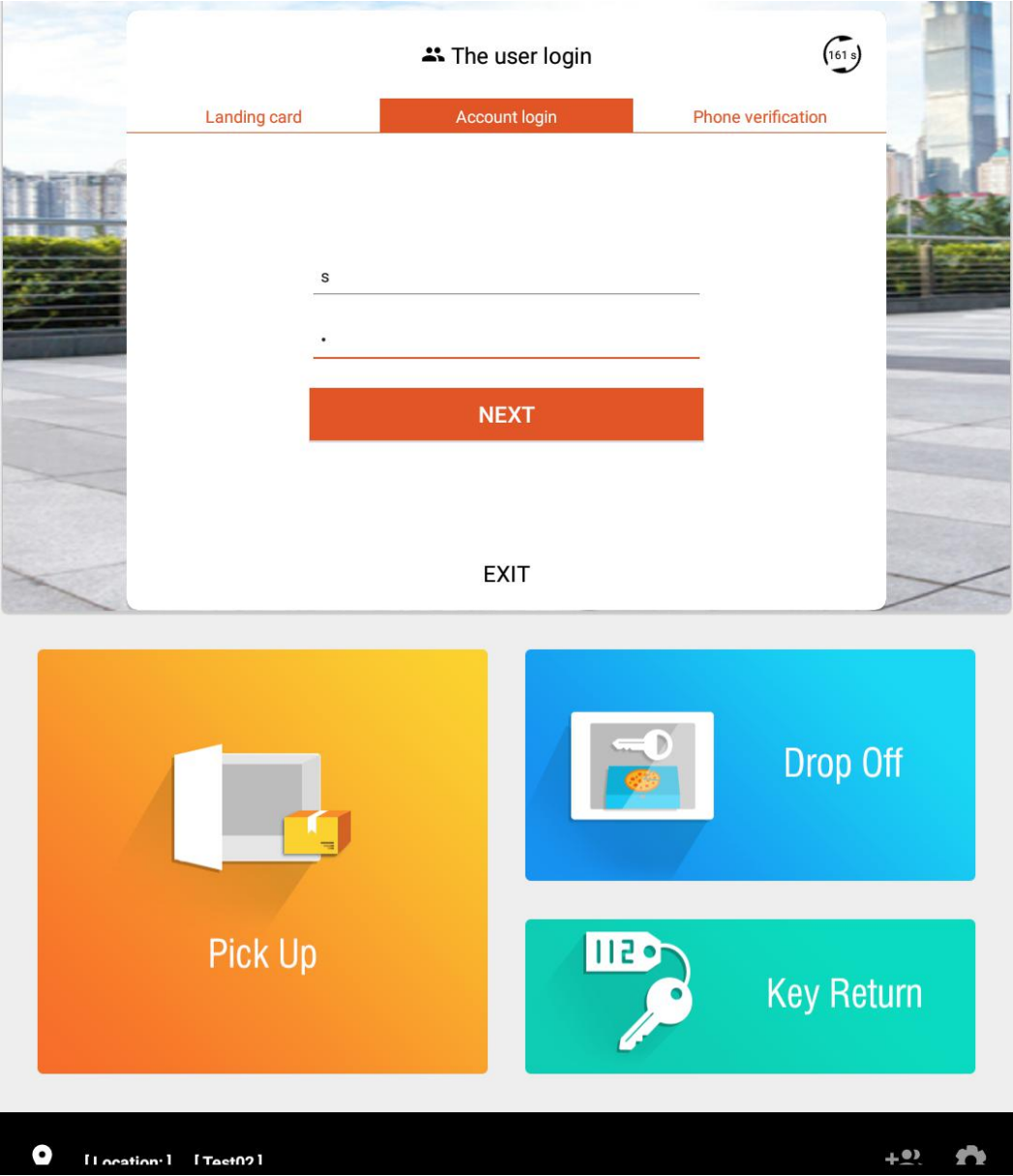

2.2.2 Users (courier / delivery staff / property manager) select locker box type / quantity and drop off:

☐ Please select the type

Key box	Available	2	Quantity	-	0	+
---------	-----------	---	----------	---	---	---

NEXT

☐ Please select the type

Wide box	Available	1	Quantity	-	0	+
Square box	Available	2	Quantity	-	0	+

NEXT

☐ Please select the type

Small box	Available	16	Quantity	-	0	+
Middle box	Available	4	Quantity	-	0	+
Big box	Available	4	Quantity	-	0	+

NEXT

2.2.3 Courier press INPUT button:

🔍 Orders submitted

ID	Number	Phone
TEST02A107		

INPUTOPENREMOVE

SUBMIT ALL

Input the Recipient information (Parcel Number, Recipient’s mobile phone number)

Information input

1234567890

13988888888

🔍 QUERY

SUBMITNEXT

EXIT

🔍 Orders submitted

ID	Number	Phone
TEST02A107		

INPUTOPENREMOVE

SUBMIT ALL

After SUBMIT ALL information, the PIN code has been sent to Recipient’s mobile phone through SMS.

PART-3 Recipient's Operations (Pick Up)

3.1 Pick-up Procedures:

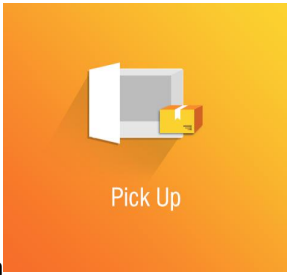

Press button ,

Check PIN code out through SMS,

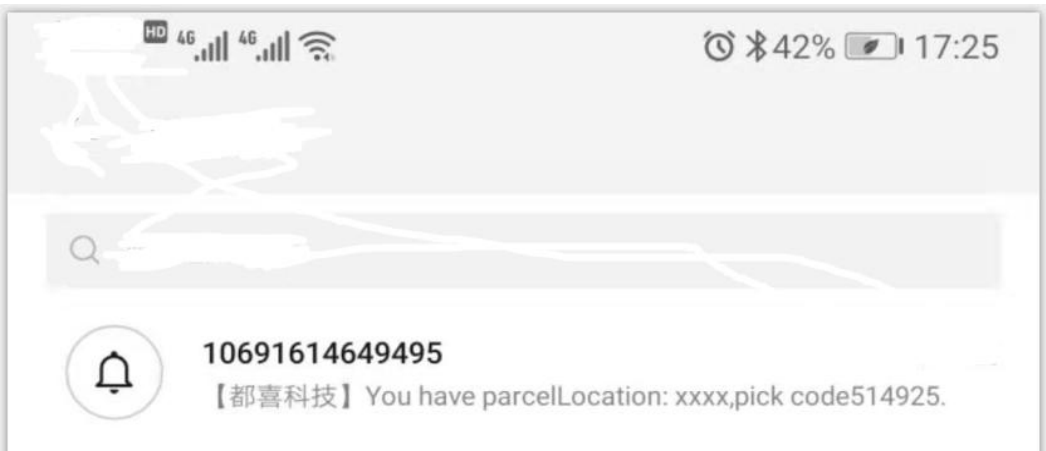

Enter PIN code:

Please enter the verification code

49 s

123456

789

456

123

0DELETE

EXIT

Locker door open automatically and take parcel out and close locker door, Pick-up finished.

3.2 Key Returning:

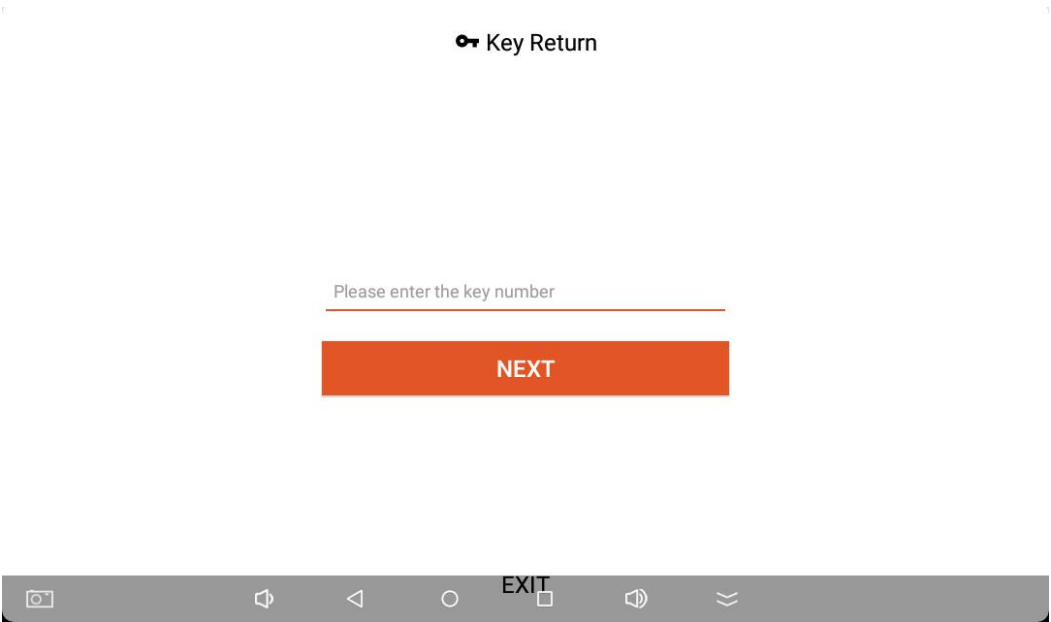

Scan or enter the bar-code or number of the key, locker box open and drop off key and close the door, meanwhile, the PIN code would be sent to Property manager’s mobile phone.

- Technical description:
- Frequency Range: LTE Band 2, Band 4, Band 7, Band 12
 - Transmit Power: 24 dBm
 - Antenna Type:External antenna
 - Antenna Gain:0 dBi

FCC Statement:

This device complies with Part 15 of the FCC rules. Operation is subject to the following two conditions: 1) this device may not cause harmful interference, and 2) this device must accept any interference received, including interference that may cause undesired operation.

Note: This equipment has been tested and found to comply with the limits for a Class B digital device, pursuant to part 15 of the FCC Rules. These limits are designed to provide reasonable protection against harmful interference in a residential installation. This equipment generates uses and can radiate radio frequency energy and, if not installed and used in accordance with the instructions, may cause harmful interference to radio communications. However, there is no guarantee that interference will not occur in particular installation. If this equipment does cause harmful interference to radio or television reception, which can be determined by turning the equipment off and on, the user is encouraged to try to correct the interference by one or more of the following measures:

- Reorient or relocate the receiving antenna.
- Increase the separation between the equipment and receiver.
- Connect the equipment into an outlet on a circuit different from that to which the receiver is connected.
- Consult the dealer or an experienced radio/TV technician for help.

Changes or modifications not expressly approved by the party responsible for compliance could void the user's authority to operate the equipment.

FCC Radiation Exposure Statement

This device complies with FCC RF radiation exposure limits set forth for an uncontrolled environment.

This transmitter must not be co-located or operating in conjunction with any other antenna or transmitter.

This device must operate with a minimum distance of 50mm between the radiator and user body.

IC Statement

This device complies with Industry Canada's licence-exempt RSSs. Operation is subject to the following two conditions:

- (1) This device may not cause interference; and
- (2) This device must accept any interference, including interference that may cause undesired operation of the device.

Cet appareil est conforme aux CNR exemptes de licence d'Industrie Canada .

Son fonctionnement est soumis aux deux conditions suivantes :

- (1) Ce dispositif ne peut causer d'interférences ; et
- (2) Ce dispositif doit accepter toute interférence , y compris les interférences qui peuvent causer un mauvais fonctionnement de l'appareil.

This device must operate with a minimum distance of 50mm between the radiator and user body.