



Azzaro Earbuds

Wireless Bluetooth Earbuds

USER MANUAL

What's in the Box



1200mAh Charging Case x 1
True Wireless Earbuds x 2



Eartips x 2



USB Cable x 1



User Manual x 1

Product Preview

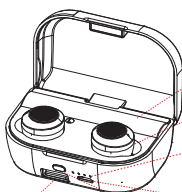

1200mAh Charging Case

True Wireless Earbuds

Battery Status
Indicator Lights

Charging Port

Battery Status Button

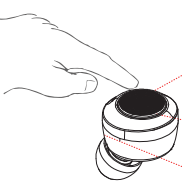

Multi-functional
Touch Button (MFB)

LED Indicator

Microphone



Charging Pin

Power On/Off

Power On

Earbuds auto power on once removed from charging case. LED indicator lights turn white & blue and flash intensely.

Manual Power On: Press the MFB for 3-4 seconds.

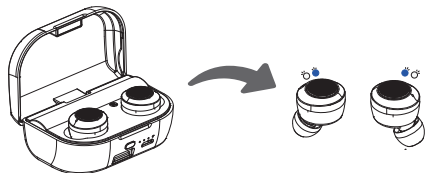

Power Off

Place earbuds into the charging case. Earbuds will disconnect automatically for charging. White LED indicator lights on earbuds and on charging case will indicate charging has begun.

Manual Power Off: Press the MFB for 3-4 seconds.

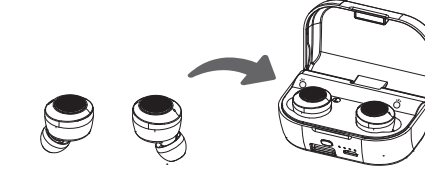

Auto Pairing

1. Remove both earbuds from charging case. White & blue indicator lights will flash and you will hear a voice prompt.

2. Open bluetooth settings on your device and select "Azzaro Earbuds" from bluetooth list to connect.

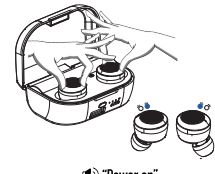

"Power on"

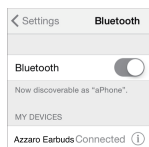

"Connected"

Earbuds will auto connect to previously paired bluetooth device within pairing range and voice prompt will indicate "your device is connected".

Mono Earbud Mode

1. Remove one earbud from charging case. White & blue indicator lights will flash and you will hear a voice prompt.

2. Open bluetooth settings on your device and select "Azzaro Earbuds" from bluetooth list to connect.

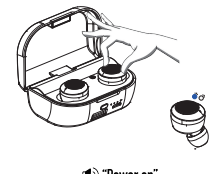

"Power on"

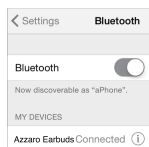

"Connected"

Music Control

Play/Pause



One click



Siri/Google



Press & hold for 1-2 seconds (do not continue to hold)



Next/Last Song



Double click for next song.
Triple click for previous song.



Phone Call Control

Accept/End Call



One click



Send Call to Voicemail



Press for 2 seconds (do not continue to hold)



Charging Earbuds



White LED indicator lights on earbuds will flash 3 times every 30 seconds followed by a voice prompt, "please charge". The earbuds will turn off automatically within 1 minute of voice prompt.

To charge earbuds, place earbuds into charging case.

White LED indicator lights on earbuds and on charging case will indicate charging has begun.

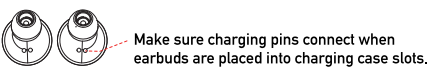
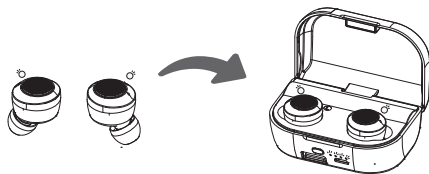

Make sure charging pins connect when earbuds are placed into charging case slots.

Allow up to 1 hour to fully charge the earbuds

Battery status indicator lights turn on when earbuds are charging.

When fully charged, battery indicator lights will shut off.

Charging Case

Battery Status Indicator

To check the battery status, press the Battery Status button. The battery status indicator lights will show the remaining power of the case. See power level diagram below.

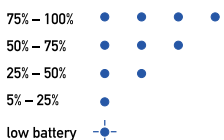
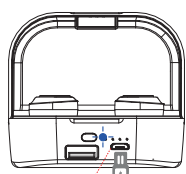

To charge case, use the USB Cable to connect the charging port to a power input supply. Refer to the specifications for power input recommendation.

Allow up to 4 hours to fully charge the case.

Charging status - one light flashing slowly.

When fully charged, battery indicator lights are on and steady.

Power Bank

Using the Charging Case as a Power Bank

The USB Power Output port can be used to charge your device.

USB Power Output

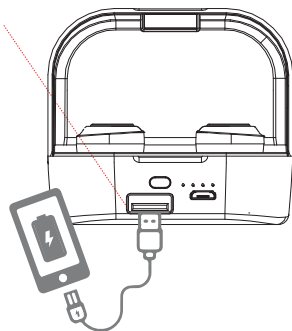

Fully charged, the case can:

- Re-charge earbuds up to 12 times.
- Supply 1200mAh of power to any device.

Safety Precautions

Do not use earbuds at a high volume. Long-term exposure to sound at high volumes may cause permanent hearing damage. You are advised to adjust to proper volume to protect your hearing.

Do not use these earbuds when engaged in activities requiring you to be aware of your surrounding environment.

Do not use earbuds during stormy weather. Use may increase the risk of being struck by lightning.

Keep the earbuds and charging case away from extreme heat, humidity or corrosive environments.

Battery Warning

Use DC-5V 1A chargers/adapters certified by a regulated manufacturer to charge.

Use of an unqualified battery or charger may present a risk of accident.

Do not overcharge the battery. This will decrease the battery life. Battery usage by children should be supervised.

Dispose of batteries according to the local regulations and recycle when possible.

In the event of a battery leak, do not allow the liquid to come in contact with the skin or eyes. In the event of leak or a hazard seek medical attention immediately.

FCC Statement

This device complies with Part 15 of the FCC rules. Operation is subject to the following two conditions: 1) this device may not cause harmful interference, and 2) this device must accept any interference received, including interference that may cause undesired operation.

Note: This equipment has been tested and found to comply with the limits for a Class B digital device, pursuant to part 15 of the FCC Rules. These limits are designed to provide reasonable protection against harmful interference in a residential installation.

This equipment generates uses and can radiate radio frequency energy and, if not installed and used in accordance with the instructions, may cause harmful interference to radio communications. However, there is no guarantee that interference will not occur in particular installation. If this equipment does cause harmful interference to radio or television reception, which can be determined by turning the equipment off and on, the user is encouraged to try to correct the interference by one or more of the following measures:

- Reorient or relocate the receiving antenna.
- Increase the separation between the equipment and receiver.
- Connect the equipment into an outlet on a circuit different from that to which the receiver is connected.
- Consult the dealer or an experienced radio/TV technician for help.

Changes or modifications not expressly approved by the party responsible for compliance could void the user's authority to operate the equipment.

Radiation Exposure Statement

This device complies with RF radiation exposure limits set forth for an uncontrolled environment. This transmitter must not be co-located or operating in conjunction with any other antenna or transmitter.

SPECIFICATIONS

Version: 5.0

Supported Profiles: HSP/HFP/A2DP/AVRCP

Play Time: Up to 5 hours

Talk Time: Up to 6 hours

Power input: Micro USB, DC 5V-1A

Earbuds Charging Time: 1 hour

Charging Case Charging Time: 4 hours

Frequency Range: 20Hz–20kHz

Operation Range: 30 feet

Sweat Resistant: Yes

Ambient Temperature: 68–140°F

Earbuds Battery: 50mAh/3.7V

Charging Case Battery: 1200mAh Li Polymer rechargeable battery

MADE IN CHINA