

User Manual

Smart Pet Feeder

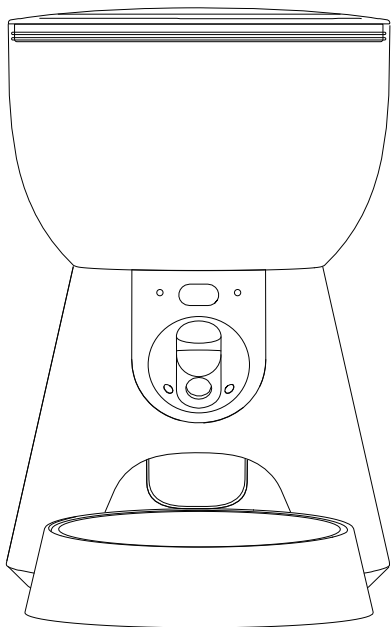

Please read the user manual carefully before using the product

Components



1.Food Hopper



2.Main Body



3.Top Lid



4.Food Bowl



5.Type-C Adapter

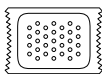

6.Desiccant

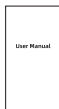

7.Manual



8.Stainless Steel Bowl

Features

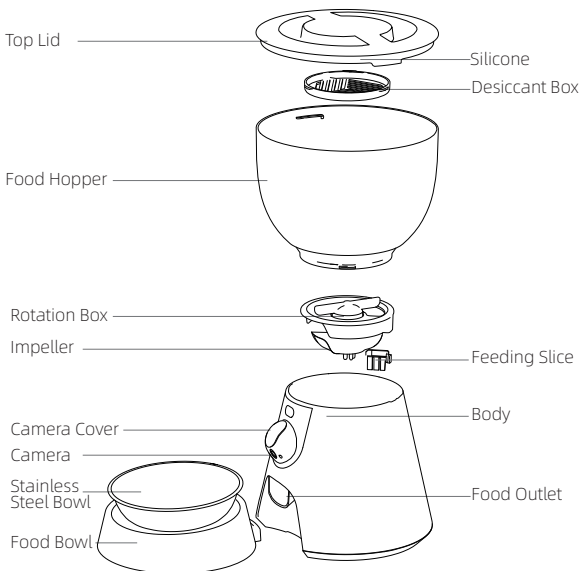

Product Introduction

Product Name	Smart Pet Feeder
Product Model	F17-C
Dimension	216mm*353mm*327mm(with food bowl)
Color Box Size	225mm*225mm*270mm
Material	Food grade ABS、Stainless steel
Net Weight	About 1.45KG
Food Appliance	5~15mm dry pet food
Pets Appliance	Cats & Small size dog
Capacity	4L(around 2kg)
Power Supply	USB 5V2A/ 4*D sized batteries
Rated Voltage	USB 5V
Rated Power	5W
WiFi Connection	2.4G&5G&BLE
Working Temperature	0°~50°

Setup and Assemble Feeder

Install food hooper

Take out the food hooper and install it by aligning the slot on the base.

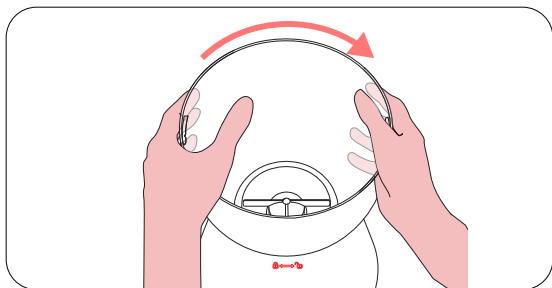

Place Desiccant

Open the desiccant box on top lid, tear off the transparent wrapping paper of the desiccant bag, place it into the box and close it.

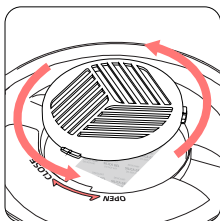

Plug in Power Adapter

①Battery power supply(APP Not Work): insert 4 alkaline" D" batteries and reinstall the battery cover.

②Power adapter supply: plug in the power adapter and connect the power cable into the card slot

***Note: Please use safe and standard alkaline batteries. Do not mix batteries of different specifications and models.**

Install the Food Bowl

Tilt the base unit back slightly, align the buckle of the food bowl with the base unit to install; the same steps to disassemble.

Fill Pet Food

Open the top lid, fill fresh dry food into the food hopper, and close the top lid.

***Note: The device only support 5-15mm dry pet food**

Grain Size Self-check:

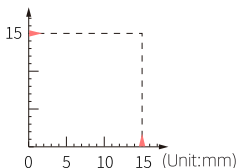

Product Introduction

Get Access to App

- ①Scan the QR code to download the APP
- ②Please login or register an account
- ③Turn on the bluetooth, click "+" on top right in Home page and Add device follow the instruction.



Download the APP

Note: WIFI 2.4&5GHz and BLE are allowed to use.

Set Up Your Programmed Feeding

The pet feeder will dispense the food based on the programmed feeding and users can receive the feeding notifications accordingly.

Reset Your Pet Feeder

Long press button for 10 seconds to reset your feeder until you hear "Di" sound. The Orange Link indicator will flash rapidly and now you can try to connect your pet feeder again.

Note: You can use tools like card pins to complete this step

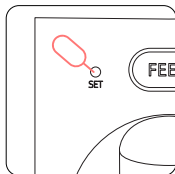

APP Remote Feeding

Enter device setting page and click "Feeding", select servings and click Feed to complete the remote feeding.

Note: Users can not feed your pets via APP when powered by batteries



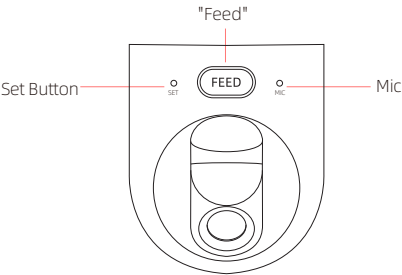

Instant Feeding

Short press "  " twice, then the device will dispense one serving, repeat the above step for more servings.

Operation Features



Indicator State

	White indicator flash	Powered by adapter
	Orange indicator flash	Connecting
	Blue indicator solid	Connected
		Working
	Red indicator flash	Food shortage & Abnormal
		Low battery

Device Disassemble & Clean

Power off

Unplug and take out the alkaline batteries.

Clean the Food Hopper

①To disassemble, hold both sides of the food hopper and rotate to the left and lift upwards.

②Disassemble the impeller/ feeding slice and feeding mechanism.

③The main body of the feeder is not dishwasher-safe.

④The food bowl is dishwasher-safe once removed from the main body.

Assemble the impeller

①Align the impeller with the certain position and install it at an inclined angle

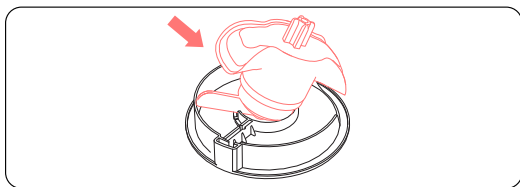

②Align the impeller as shown in the figure

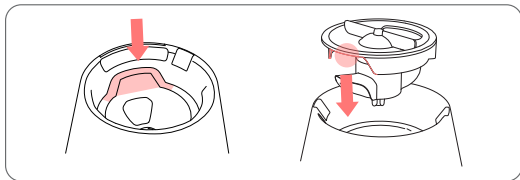
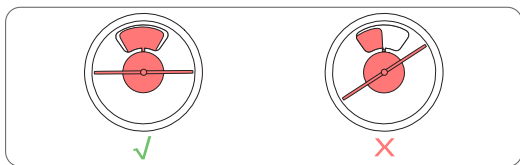

Clean the Food Bowl

Make sure all parts of the feeder are completely clean and dry before filling with food.

Clean the Body

Use the dry soft cloth to wipe it, the body is not waterproof, please do not use wet cloth.

Replace the desiccant pack

Open the desiccant box cover and replace the desiccant pack. It is suggested to replace it every one or two months.

Replace Alkaline Batteries

Unplug and open battery lid at the bottom, then you can replace the batteries.

Replace or Change the Food

Empty the food hopper, then fill the fresh food and proceed instant feeding once.

※Attention:

- ①Please keep the food hopper dry after cleaning it.
- ②Please replace the food on a regular basis if your pets did not eat up.(For time period, please refer to the food packing instruction).
- ③Please clean and maintenance your device on a regular basis to prolong the using period of your pet feeder.

Safety Precaution

Keep Plug In

1. Please check the power supply of the device before going out to ensure that the power supply is stable.
2. Please keep charging the device to make sure the wifi connection is stable.
3. The camera will turn off automatically that get into the lower power consumption mode when using dry batteries, but your feeding plan is working as the same.
4. There will no record of the feeding status and records if the device is offline.

Working Conditions

1. Place the device horizontally and securely, tilt, sway or turning upside down are forbidden.
2. Exposure to sunlight could damage the internal electronics or cause discoloration. Do not place or store an appliance where it can fall or be pulled.
3. Do not remove product components other than food bowl and hooper.
4. Do not place any foreign object in the pet feeder
5. Please make sure there is no objects on and around the food bowl to prevent pets from eating normally.

Important Safety Information

1. This product is only applicable to cats and small dogs.
2. Do not allow children to play with, in or around pet feeder.
3. The desiccant is not edible. If it is damaged, do not use it
4. The feeder is only applicable 5-15mm dry pet food.
5. Do not disassemble the pet feeder other than components as instructed in this operating guide
6. Do not immerse feeder in water, as this may damage electronic components.
7. The feeder only supports charging with 5V/2A adapter.
8. Do not allow pets to chew on or swallow any parts.
9. Do not use the pet feeder for any purpose other than feeding pets.
10. Do not touch the camera to avoid the scratches and oil stain

FAQ

What happened to your device	What happened to your device	How to solve it
Food hopper cannot be installed	Food blocked on the installation position	Clear the cat food inside the installation position and reinstall
Device Abnormal	Impurities inside food hopper	Clean the impurities inside of food hopper
	Food stuck near the food outlet	Clean the food left in the food bowl
	Food size inapplicable	Ensure to use 5-15mm dry pet food
	Infrared sensor faulty	Contact After-sale Service
	Motor Faulty	Contact After-sale Service
Lack of Food	Lack of food	Fill pet food and instant feed once
	Food hopper not fix well	Disassemble the food hopper and re-fix it.
Device Offline	Powered by Battery	Check if power cut or power adapter is fixed properly
	Network abnormal or something wrong with WiFi	Check if the WiFi is normal and re-connect the pet feeder
	Mainboard Defective	Contact After-sale Service

FCC STATEMENT :

This device complies with Part 15 of the FCC Rules. Operation is subject to the following two conditions:

- (1) This device may not cause harmful interference, and
- (2) This device must accept any interference received, including interference that may cause undesired operation.

Warning: Changes or modifications not expressly approved by the party responsible for compliance could void the user's authority to operate the equipment.

NOTE: This equipment has been tested and found to comply with the limits for a Class B digital device, pursuant to Part 15 of the FCC Rules. These limits are designed to provide reasonable protection against harmful interference in a residential installation. This equipment generates uses and can radiate radio frequency energy and, if not installed and used in accordance with the instructions, may cause harmful interference to radio communications. However, there is no guarantee that interference will not occur in a particular installation. If this equipment does cause harmful interference to radio or television reception, which can be determined by turning the equipment off and on, the user is encouraged to try to correct the interference by one or more of the following measures:

- Reorient or relocate the receiving antenna.

- Increase the separation between the equipment and receiver.

- Connect the equipment into an outlet on a circuit different from that to which the receiver is connected.

- Consult the dealer or an experienced radio/TV technician for help.

FCC Radiation Exposure Statement:

This equipment complies with FCC radiation exposure limits set forth for an uncontrolled environment. This equipment should be installed and operated with minimum distance 20cm between the radiator & your body.