

User Manual

Smart Pet Feeder

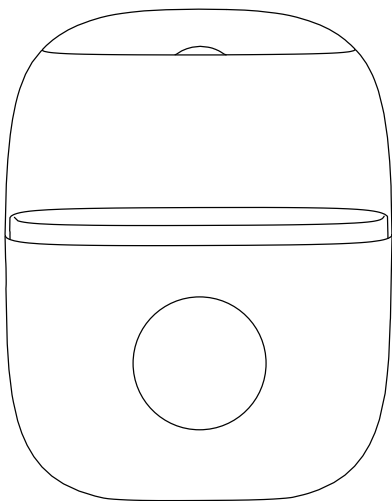

THANKS FOR CHOOSING OUR AUTOMATIC PET FEEDER

Product Accessories



Main Body



Fix Board



Food Bowl



Food Outlet Component



Rotary knob



Feed Outlet Cover

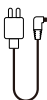

Power Adapter

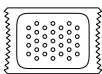

Desiccant Box



Manual

Product Introduction

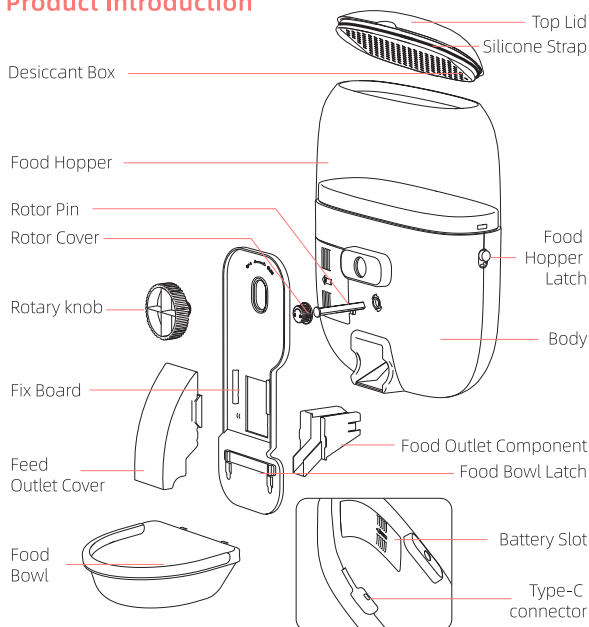

Basic Information

Product Name	F15-W Smart Pet Feeder
Item No	F15-W
Dimension	L240mm*W88mm*H306mm(Main Body)
Box Size	L275mm*W125mm*H340mm
Material	Food grade ABS+SS bowl
N.W	1.1kg
Pets Appliance	Non mixed hay grains
Suitable Cage Size	Verrical cable spacing 21-44mm, less than $\phi 5\text{mm}$ Horizontal cable spacing: over 22mm in height intervals
Food Appliance	Cage Pet
Capacity(food hooper)	About 1.8L
Capacity(food bowl)	100ml(About 100g)
Power Supply	Type-C 5V2A/Backup 2*D size Batteries
Rated Power	10W
Working Temperature	0°~50°

Set Up and Assemble Pet Feeder

Toggle the food hooper latch downward and remove food hooper and take out accessories.

Install Food Hopper and desiccant

Align the notch at the bottom of the bucket with the body clip, and then move the lock of the food hooper upward, and hear a "snap" sound that the food hooper installation is complete.

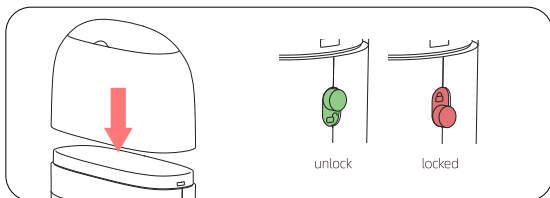

Place Desiccant Bag

Open the desiccant bag inside the top lid, tear off the transparent packaging and place it into the desiccant box and close desiccant bag and install top lid.

***Attention:**

1. Do not tear open the inner packaging of the drying bag;
2. Drying bags are not edible.

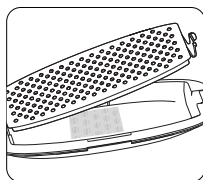

Install Pet Feeder

①Select the appropriate food outlet components according to the cage size, install the food outlet components to the food outlet until you hear a "snap" sound, then the installation of the food outlet components is complete.

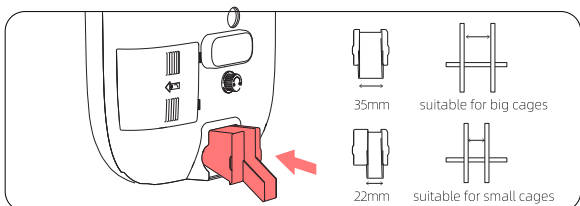

***Attention: Two food outlet components come standard, large components with large spaced cage and small components with small spaced cage.**

②As shown in the figure, fix the feeder on the outside of cage, install the hanging plate on the inside.



③Tighten the knob clockwise to install the food tray after securing the feeder and fasten the food tray latch to the left.

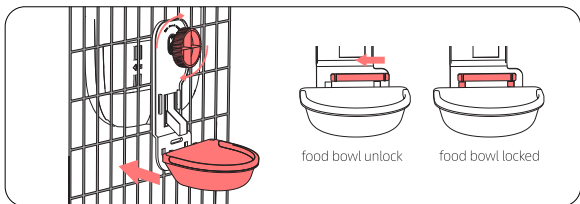

④Install food outlet cover, then the feeder completed.



Power On

①Plug in Adapter: Plug the Type-C cable into the power connector on the bottom of the feeder.

②Battery Back-up: Open the battery cover on the back, insert 2*D zied alkaline dry batteries, and close the battery cover.

***Attention: Please use safe and legitimate alkaline dry batteries. Do not mix dry batteries of different specifications and models to avoid affecting the normal use of the device.**

Fill Pet Food

Open the top lid, fill the hopper with dry pet food.

***Note: Small outlet component is suitable for about 5~20mm pet food, large outlet component is suitable for about 5~30mm pet food, please don't use special-shaped food or out of size food to avoid clogging.**

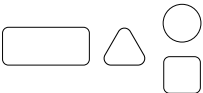
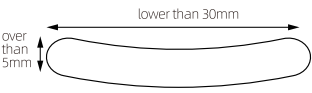
small component	large component
 5-20mm food size	 5-30mm food size

Product Usage

Get Access to App

①Scan the QR code to download the APP

②Please login or register an account

③Click "+" on top right in Home page and Add device follow the instruction.



Download the APP

Note: Only Support 2.4Ghz.

Set Up Your Programmed Feeding

The pet feeder will dispense the food based on the programmed feeding and users can receive the feeding notifications accordingly

Reset Your Pet Feeder

Long press button for 10 seconds to reset your feeder until you hear "Di" sound. The white light turn to orange link flash slowly and now you can try to connect your pet feeder again.

APP Remote Feeding

Enter device setting page and click "  ", select servings and click Feed to complete the remote feeding.

Note: Users can not feed your pets via APP when powered by batteries



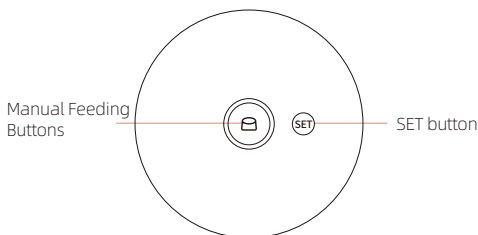

Manual feeding

Under the energized state, click the "  " button, then the device will dispense one serving

Operation Introduction



Indicator Status

	White light then Orange light blinks slowly	Reset the network
	Orange indicator flash	Connecting/Offline
	Blue indicator solid	Connected
	Red indicator flash	Abnormal
		Low battery
		Food shortage/Abnormal
	White indicator solid	Powered by batteries

Disassemble&Clean

Power Off

Unplug and take out the alkaline batteries and Type-C cable.

Clean the food hooper and food outlet components

- ① Move the food tray latch to the right, and take out food tray.
- ② Turn the knob counterclockwise to remove the fix board.
- ③ Move the lock of the food hooper upward to take out food hooper.
- ④ Open top lid and desiccant box.
- ⑤ After remove feeder, take out food outlet component.
- ⑥ Unscrew the spindle cover counterclockwise and remove the spindle pin.
- ⑦ Disassemble impeller from inside body.
- ⑧ The main body of the feeder is not dishwasher

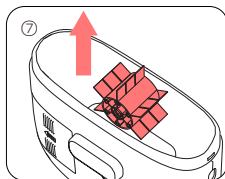
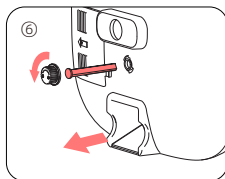

⑨Make sure all parts of the feeder are completely clean and dry before filling with food.

***Notice:**When installing the impeller after cleaning, the rotor pin needs to be aligned with and embedded in the middle gear of the impeller before installing the rotor cover.

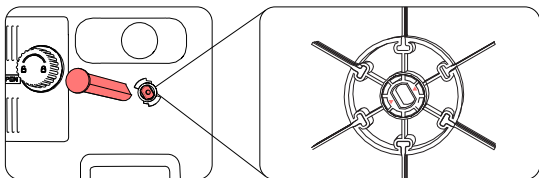

Clean Main Body

Wipe the inside of the body with a soft dry cloth. The body is not waterproof, do not use a wet cloth to clean.

Replace the desiccant pack

Open the desiccant box cover and replace the desiccant. It is suggested to replace it every one months.

Replace Battery

Unplug and open battery lid at the bottom, then you can replace the batteries.

Replace pet food

Empty the remainder of the hooper, fill with fresh pet food and execute a manual feeding.

*Warnings

- ①Please keep the food hooper dry after cleaning it.
- ②Please replace the food on a regular basis if your pets did not eat up.
(For time period, please refer to the food packing instructions.)
- ③Please clean and maintenance your device on a regular basis to prolong the using period of your pet feeder.

Installation Guide

Please read all instructions and precautions in this manual before using this product.

Keep Plug In

1. Please check the power supply of the device before going out to ensure that the power supply is stable.
2. To ensure the normal functioning of the internet connection, please use Type-C power cable for power supply.
3. When batteries power on, the device will turn off the camera, disconnect from the network, and enter low-power mode, but will continue to automatically feed according to the feeding schedule before the network disconnection.
4. There will no record of the feeding status and records if the device is offline.

Device Placement

1. For pets in cages only
2. For indoor use only
3. Do not install or expose this product to low temperatures below -20°C.
4. Do not place objects on this pet feeder
5. Please make sure there are no objects covering the food tray, to avoid prevent your pet's normal eating or cause damage to the device.

Caution

1. Intended for use with rabbit, cat, dog, totoro, squirrel, minks, birds and other caged pets.
2. This product is suitable for people over 12 years old, children use, please ask the guardian to closely supervise.
3. Do not eat the desiccant. Do not use it if it is damaged.
4. Do not place any objects other than pet food in the feeder.
5. Please use suitable food according to actual gap between cages.
6. Make sure plug in adapter before a long outing.
7. Do not immerse main body in water any time, otherwise it will damage electronic components.
8. To prevent electric shock, do not insert the power cord or plug into water or other liquids.
9. Avoid getting the Type-C connector wet. If the Type-C connector is wet, allow it to dry sufficiently before plugging it in.
10. For 5V/2A adapter only
11. Dispose of all packaging materials properly. Some parts may be wrapped in plastic bags that can cause suffocation. Keep them away from children and pets.
12. Do not use the pet feeder for anything other than its intended purpose.
13. Do not touch the camera to avoid the scratches and oil stain

FAQ

What happened to your device	How to check by yourself	Solutions
The rotor pin won't fit	Impeller direction installed incorrectly	Reverse the impeller direction and reinstall
Device Abnormal	Food size inapplicable	Replace suitable outlet accessories or pet food
	There's a foreign object in the food bucket	Removal foreign object
	Device Faulty	Contact After-sale Services
Device blockage	Grain blockage in the food aisle	Clean out the remaining food in the aisles for reuse
	Overfeed lead blockage	Reduction servings
	Food outlet blocked by foreign objects	Remove foreign objects from access ports
	Food outlets unclean	Clean the inside of the outlet channel with a soft dry cloth
Device offline	Powered by Battery	Check if power cut or power adapter is fixed properly
	Network abnormal or something wrong with WiFi	Check if the WiFi is normal and reconnect the pet feeder
	Mainboard defective	Contact After-sale Service

FCC STATEMENT :

This device complies with Part 15 of the FCC Rules. Operation is subject to the following two conditions:

- (1) This device may not cause harmful interference, and
- (2) This device must accept any interference received, including interference that may cause undesired operation.

Warning: Changes or modifications not expressly approved by the party responsible for compliance could void the user's authority to operate the equipment.

NOTE: This equipment has been tested and found to comply with the limits for a Class B digital device, pursuant to Part 15 of the FCC Rules. These limits are designed to provide reasonable protection against harmful interference in a residential installation. This equipment generates uses and can radiate radio frequency energy and, if not installed and used in accordance with the instructions, may cause harmful interference to radio communications. However, there is no guarantee that interference will not occur in a particular installation. If this equipment does cause harmful interference to radio or television reception, which can be determined by turning the equipment off and on, the user is encouraged to try to correct the interference by one or more of the following measures:

- Reorient or relocate the receiving antenna.

- Increase the separation between the equipment and receiver.

- Connect the equipment into an outlet on a circuit different from that to which the receiver is connected.

- Consult the dealer or an experienced radio/TV technician for help.

FCC Radiation Exposure Statement:

This equipment complies with FCC radiation exposure limits set forth for an uncontrolled environment. This equipment should be installed and operated with minimum distance 20cm between the radiator & your body.