

Anchor Vista DirectFive

Reference node for Real Time Location System

User Manual rev0.2

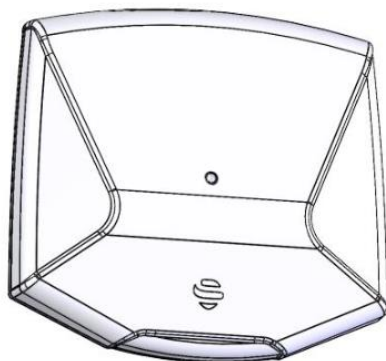

EN Anchor Vista, reference node for real time location system

Technical Parameters

Size	212 x 190 x 36
Weight	390 g
Power Supply	PoE 802.3af
Power Requirements	2.5W
Operating Conditions	-20 - 60 °C 20 – 85% humidity
Warm-up Time	Immediate
Environment	Household environment Retail Building / Offices Automotive, Industrial Machinery
Use	Indoor only
UWB Radiated Power (CH5) 6240 – 6739.2 MHz	-41.3 dBm/MHz

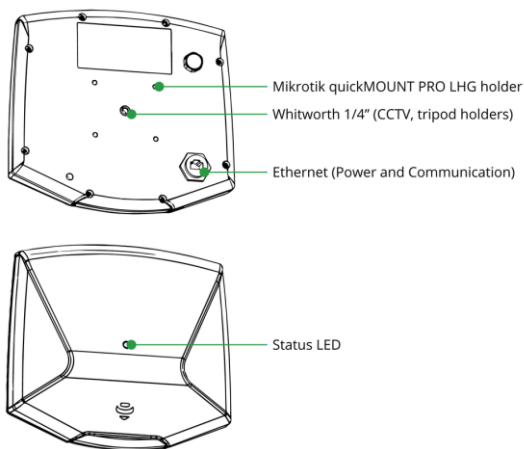

Power-Up

Power Over Ethernet

Please connect Anchor to network switch supporting PoE IEEE 802.3af standard and connect anchor with shielded Ethernet cable (CAT6 or higher). Maximum cable length is 100 m for PoE from anchor to PoE switch.

Once the Anchor is connected to a stable power supply, a blue LED blink several times that indicates the anchor was turned ON. Then LED is turned OFF.

Device Mounting

Adjustable holder with degree scale Mikrotik quickMOUNT PRO LHG is recommended for permanent anchor installation for both horizontal and vertical placements. It allows to mount anchor directly to the wall and have accessories to mount it on console or pillar. Mobile deployments can utilize the whitworth 1/4" as it is compatible with the most off-the-shelf tripods and CCTV holders.

Fixed Anchor placement on a wall

Holder: Mikrotik quickMOUNT PRO LHG



Holder: Mikrotik quickMOUNT PRO LHG + metal console



Mobile Anchor placement on a tripod



For correct Anchor deployment please follow the official documentation page available at <https://docs.sewio.net>.

Safety Instructions



Anchor Vista DirectFive does not contain any user-serviceable parts and is not allowed to be opened by unauthorized personnel! Opening the screws of the device housing will invalidate any warranty claims.

Anchor can only be installed, operated, used and maintained by appropriately trained, authorized specialist personnel. Specialist personnel are individuals who possess the technical training, knowledge and experience necessary in order to understand the tasks entrusted to them, evaluate these and identify possible hazards.

Precautions:

- Do not use deformed or damaged product or battery.
- Do not expose the devices to extreme heat, pressure or humidity.
- Do not charge or use the product if liquid has entered.
- Do not use or store the devices in dusty or dirty areas.
- Protect the product from excessive moisture.
- Do not expose the devices to water, rain, splashing water or spilled drinks.
- Do not spray anything on and inside the device.
- Dropping, knocking, violently shaking and any rough handling may damage the device.
- Do not transport or store flammable gas, liquid or explosives in the vehicle compartment where the device is installed.
- In case of malfunction, contact Sewio support.
- Do not modify the product.

NOTE: Performance of anchors might be affected by materials like metal or water in the vicinity of the anchor, shielding or absorbing signals.

Maintenance: Anchor does not contain any user-serviceable parts.

Cleaning: Clean the housing with a soft, dry or slightly moistened cloth. Do not use any solvents or high-pressure cleaners

Host to Anchor Connection

Setting up and operating the Anchor is done exclusively via RTLS Studio software. RTLS Studio software is available through Sewio [partner portal](https://docs.sewio.net). For more information please follow the official documentation page available at <https://docs.sewio.net>.

Regulatory Information

For FCC compliance, the following conditions must be met:

- All units must be exclusively used indoors.
- No devices may be installed at any outdoor locations.

This device is designed to be operated with the supplied antenna. The use of any other antenna with this device is strictly prohibited and may result in the voiding of the FCC authorization for this equipment's operation. It is strictly forbidden to use of any other antenna than the one Sewio Networks s.r.o has supplied.

This device is compliant with FCC Rules, part 15. Its usage is subject to the two following conditions:

(1) this device may not be the cause of any harmful interference, and (2) this device shall accept any interference received, including interference that may interfere with its desired operation.

This device is also in compliance with part 15.517 of the FCC Rules. This equipment may only be used indoors. Usage outdoors violates 47 U.S.C. 301 and the operator could be subject to serious legal penalties.

This equipment is only to be installed and used at a 20 cm minimum distance between the radiator and a person.

Any changes or modifications that have not been expressly agreed to by the Sewio Networks s.r.o could invalidate the user's authority to use the equipment

DISCLAIMER

The information contained within this document is subject to change without prior notice. Sewio Networks s.r.o accepts no responsibility for any inaccuracies or omissions and specifically rejects any losses, liabilities, or risks, personal or otherwise, sustained as a consequence, directly or otherwise, of the use or application of anything contained within this document. In order to obtain the latest documentation, contact Sewio Networks s.r.o.