

## Gateway Model 1.0

### User Manual

#### CE Declaration

Name and Address of the Importer in EU:

**Christie Lites Coventry**

40 Sayer Drive,

Unit B, Lyons Park

Coventry, CV5 9PF, UK

This device is in compliance with the essential requirements and other relevant provisions of Directive 2014/53/EU. All essential radio test suites have been carried out.

This product is a fixed location. To comply with RF exposure requirements, a minimum separation distance of 20cm must be maintained between the user's body and the device, including the antenna. Use only the supplied or an approved antenna.

#### Introduction

The 2.4 Ghz Wireless PoE Gateway is utilized in installations using 2.4 Ghz Wireless Active RFID Tag Devices and Network Manager System Software. Each Gateway is provided power over Ethernet and installed in fixed locations within a facility where inventory tracking is desired.

The Gateway uses proprietary communication protocols and can operate in the presence of WiFi without interference to the WiFi or Gateway device.

## Photos of Wireless Gateway

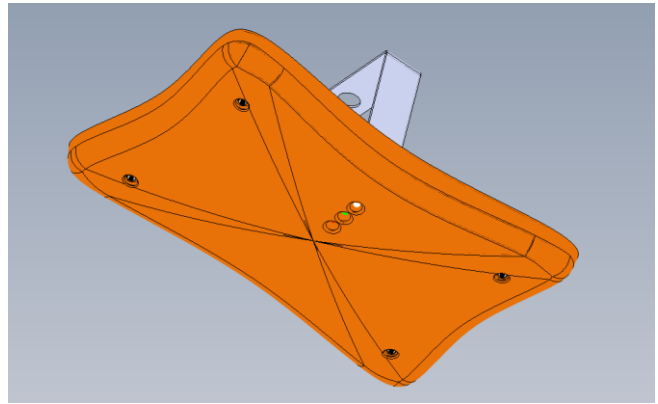
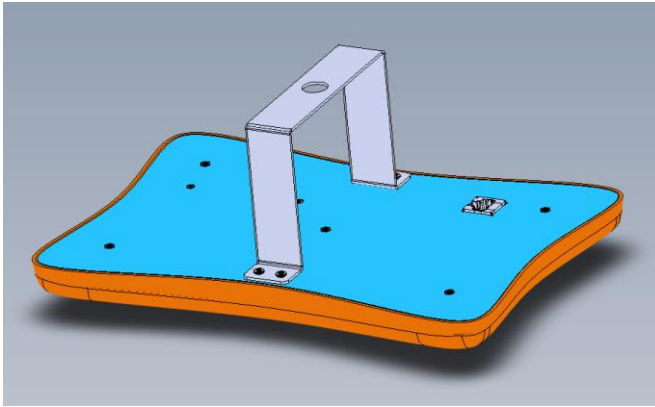

### Warnings

- a) **Failure to follow all Gateway User Instructions may result in improper operation of device, failure of device or other hazard.**
- b) **The RFID Asset Tag is powered over Ethernet. Shock Hazard may exist if internal components are exposed by disassembly.**
- c) **The Gateway has no user serviceable parts or components.**
- d) **Opening the Gateway plastic enclosure voids all warranties. DO NOT DISASSEMBLE**

### Unpacking

- a) The Gateway is supplied in bulk packaging, open container and remove an individual Gateway.
- b) Remove Gateway from its plastic bag and discard the bag properly for recycling.
- c) Unused Gateways may be stored indefinitely without degradation.

### Gateway Installation

Gateways are intended for installation on exposed spider beams within a commercial warehouse, consult factory for other installation applications. Gateways are distributed on a grid type distribution in Warehouse ceiling at spacing's of 30 to 50 feet in each direction. Beam Clamp 3048T61 and ½-13 Bolt are user supplied.

- a) Locate the Gateway Mounting Bracket with Mounting Hole.
- b) Affix a Beam Clamp (McMaster: 3048T61 or eq.) to Gateway using a ½-13 Bolt or threaded rod, thread locker is recommended on threads entering the Beam Clamp. (Beam Clamp, ½-13 Bolt and Thread locker sold separately)
- c) Affix Beam Clamp to exposed spider beam and tighten clamp on beam.
- d) Connect facility PoE Cat 5e Ethernet Cable to rear of Gateway port shown below.

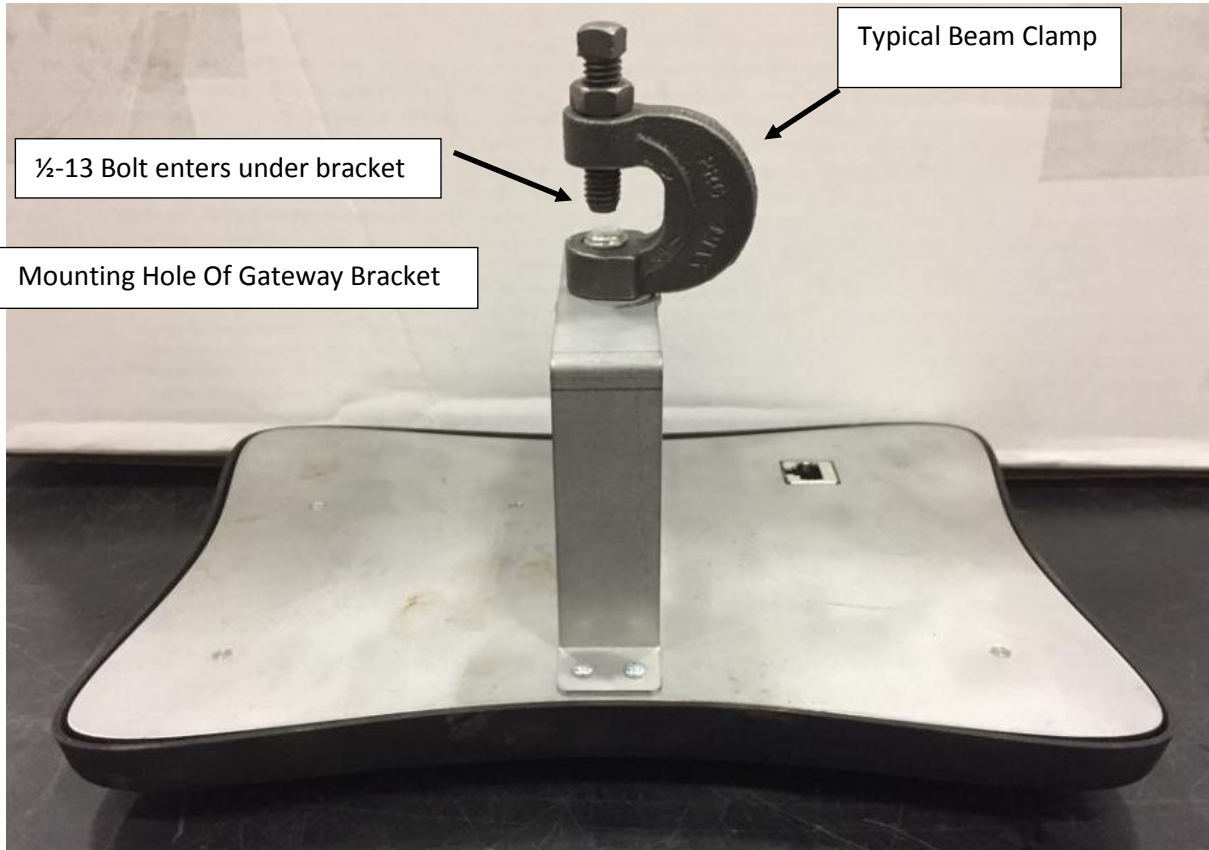

## Gateway Activation

Gateways are delivered fully programmed and ready for use. Gateways will have to be configured through the Network Manager Software. Full details for Gateway Activation are found in the Network Manager Software User Manual.

### FCC WARNING

This device complies with part 15 of the FCC Rules. Operation is subject to the following two conditions: (1) this device may not cause harmful interference, and (2) this device must accept any interference received, including interference that may cause undesired operation.

Any changes or modifications not expressly approved by the party responsible for compliance could void the user's authority to operate the equipment.

NOTE: This equipment has been tested and found to comply with the limits for a Class B digital device, pursuant to Part 15 of the FCC Rules. These limits are designed to provide reasonable protection against harmful interference in a residential installation. This equipment generates, uses and can radiate radio frequency energy and, if not installed and used in accordance with the instructions, may cause harmful interference to radio communications. However, there is no guarantee that interference will not occur in a particular installation.

If this equipment does cause harmful interference to radio or television reception,

which can be determined by turning the equipment off and on, the user is encouraged to try to correct the interference by one or more of the following measures:

- Reorient or relocate the receiving antenna.
- Increase the separation between the equipment and receiver.
- Connect the equipment into an outlet on a circuit different from that to which the receiver is connected.
- Consult the dealer or an experienced radio/TV technician for help.

To maintain compliance with FCC's RF Exposure guidelines, This equipment should be installed and operated with minimum distance between 20cm the radiator your body: Use only the supplied antenna.

Equipment:	Gateway
Trade Name:	Christie Lites Enterprises
Model Name:	1.0
Operation Frequency:	2405-2480MHz
Modulation Type:	GFSK
Antenna Type:	Ceramic Patch antenna
Antenna Gain:	1dBi
Max. Field Strength:	95.02dBuV/m@3m
Power Source:	DC 48V from POE
Hardware Version:	1.03
Software Version:	1.01t

## **IC Caution:**

Radio Standards Specification RSS-Gen, issue 5

- English:

This device contains licence-exempt transmitter(s)/receiver(s) that comply with Innovation, Science and Economic Development Canada's licence-exempt RSS(s). Operation is subject to the following two conditions:

This device may not cause interference.

This device must accept any interference, including interference that may cause undesired operation of the device.

- French:

Cet appareil contient des émetteurs / récepteurs exemptés de licence conformes aux RSS (RSS) d'Innovation, Sciences et Développement économique Canada. Le fonctionnement est soumis aux deux conditions suivantes:

Cet appareil ne doit pas causer d'interférences.

Cet appareil doit accepter toutes les interférences, y compris celles susceptibles de provoquer un fonctionnement indésirable de l'appareil.

Manufacturer's Name: Christie Lites Enterprises USA

Sample Description: Gateway

Trade Mark: Christie Lites Enterprises

Model number: 1.0

Operating Temperature: -10° C to 40° C

This product is a fixed location. To comply with RF exposure requirements, a minimum separation distance of 20cm must be maintained between the user's

body and the device, including the antenna. Use only the supplied or an approved antenna.

This device in compliance with the essential requirements and other relevant provisions of Directive 2014/53/EU. All essential radio test suites have been carried out.

1. CAUTION : RISK OF EXPLOSION IF BATTERY IS REPLACED BY AN INCORRECT TYPE. DISPOSE OF USED BATTERIES ACCORDING TO THE INSTRUCTIONS

2. The device complies with RF specifications when the device used at 20cm from your body