

1. PLECO DISPLAY UNIT (DU) - LABEL

The Display Unit (DU) will use e-label to display regulatory information. As shown in Figure 1, only two (2) steps are necessary for the user to access regulatory information: From the Home screen the user selects Settings and from the Settings screen the user selects “Regulatory”, which displays the e-label containing the FCC ID and other regulatory information.

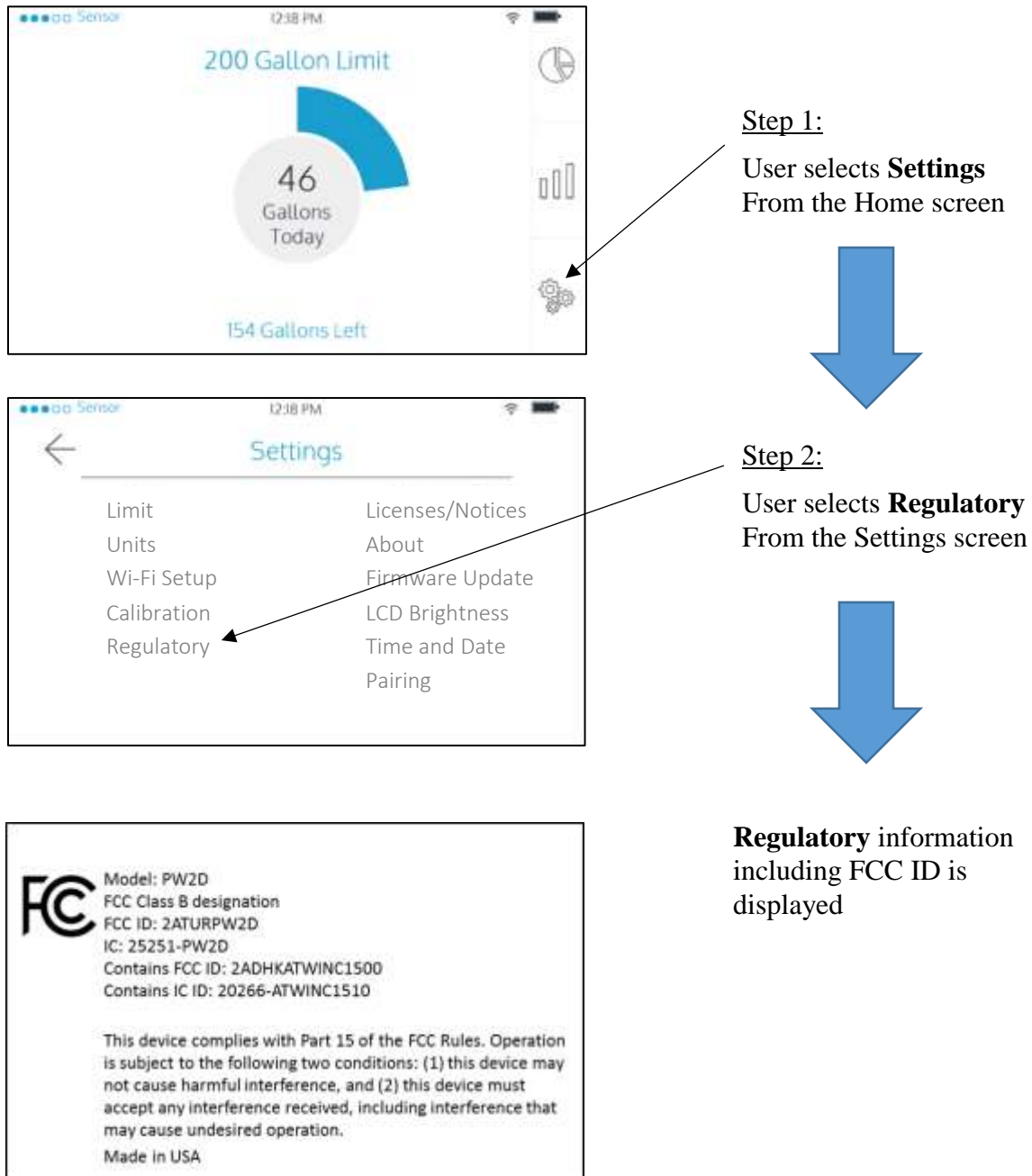

Fig. 1: User access to regulatory information

Figure 2 shows the Display Unit (DU) electronic label in the size as seen by the user in the screen.

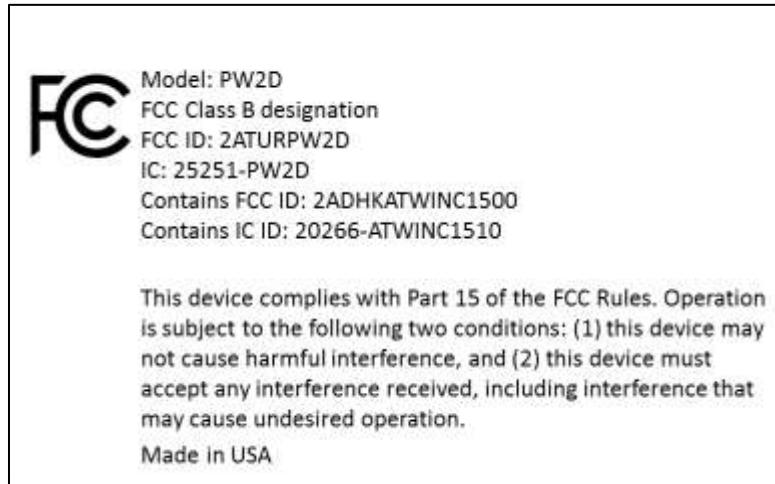

Fig. 2: DU screen showing regulatory information label in the size as seen by the user.

2. COMPLIANCE WITH KDB 784748 D02

Following are description of compliance to KDB 7847748 D02, sections 4.1 through 4.6:

Section 4.1: User Steps to Access Information – As described in the previous paragraphs (Section 1) no access codes are required for the user to access regulatory information and only two (2) steps are required to access the information. Therefore, the Pleco Display Unit (DU) complies with Section 4.1 KDB 7847748 D02.

Section 4.2: Products must not require special accessories or supplemental plug-ins to access the information – No special accessories or access code is required to access regulatory information (Section 1). Therefore, the Pleco Display Unit (DU) complies with Section 4.2 KDB 7847748 D02.

Section 4.3: Readability of Regulatory Information – Figure 2 shows the regulatory label in the size as seen by the user in the LCD screen. The font size is 10 points and the information clearly legible without need for magnification. Therefore, the Pleco Display Unit (DU) complies with Section 4.3 KDB 7847748 D02.

Section 4.4: Regulatory Information must be secure – The regulatory information is implemented at the factory and stored in non-volatile memory in the Display Unit (SU). It is stored locally in the device and easily accessible to the user. It is also secure and

cannot be changed by the user ensuring the correct information is displayed. Therefore, the Pleco Display Unit (DU) complies with Section 4.4 KDB 7847748 D02.

Section 4.5: Physical and Temporary label for Purchasing and Importation – An adhesive label containing regulatory information including FCC ID (Fig. 3) is attached to the product packaging. Therefore, the Pleco product complies with Section 4.5 KDB 7847748 D02.

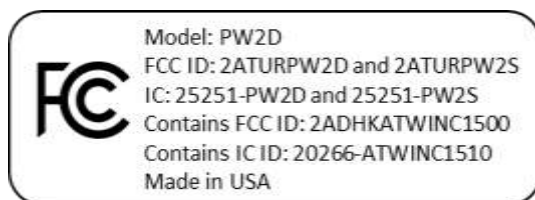

Fig. 3: Adhesive label on the packaging

Section 4.6: Additional Considerations – The Display Unit (DU) uses a modular Wi-Fi transmitter and the regulatory information is included in the electronic label screen as shown in Figure 2: “Contains FCC ID: 2ADHKATWINC1500”. Therefore, the Pleco Display Unit (DU) complies with Section 4.6 KDB 7847748 D02.