

Guizhou Gaotong Technology Co.,Ltd
For
Network Camera
Model No.: W10
FCC ID: 2ATS8-W10

Product interface

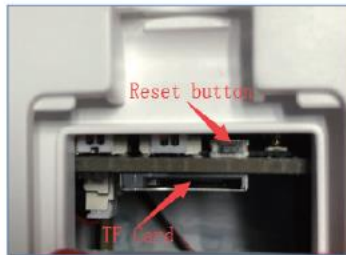

Connect Camera

1. Network cable connection configuration wifi

1.1 Connect network cable to router and plug in power adapter.



Note: The router must be able to connect to the Internet! Please use the standard power supply.

1.2 Connect LAN cable and power to camera, it needs about one minute to self checking and then start working.

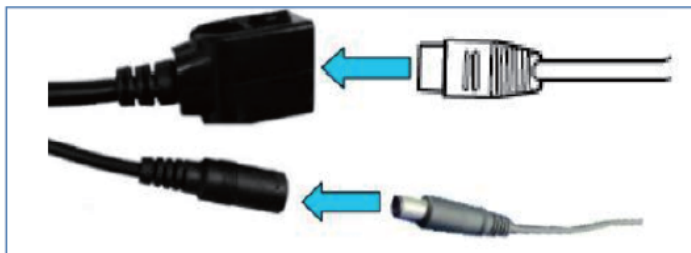

Network indicator light (green): always flashing means network data.

2. Download APP

Scan the following QR code to download the APP for IOS and Android mobile device, or download freely in APP store and Google Play by searching for "Ai View".



Android



Ai View



IOS

2.1 Sign up and login

Follow the app steps to register and login.

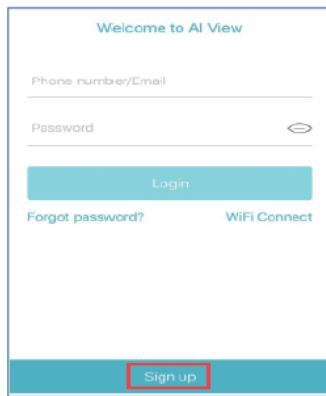
A screenshot of the Ai View app's login and sign-up screen. The screen has a white background with a blue header bar at the top containing the text "Welcome to Ai View". Below the header, there are two input fields: "Phone number/Email" and "Password". The "Password" field has a small eye icon to its right. Below these fields is a blue "Login" button. Under the "Login" button, there are two links: "Forgot password?" and "WiFi Connect". At the bottom of the screen, there is a blue bar with a white "Sign up" button highlighted by a red rectangle.

3. Add camera

3.1 Click Add, scan the device QR code

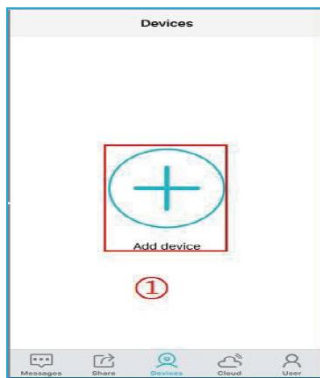

Note: If you are unable to scan the QR code on your device, please select the second “AP hotspot connection” behind the instructions.

3.2 Add Camera successful

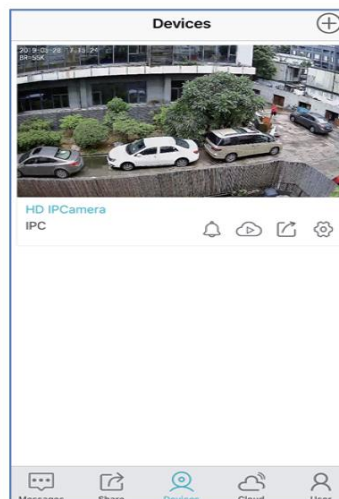
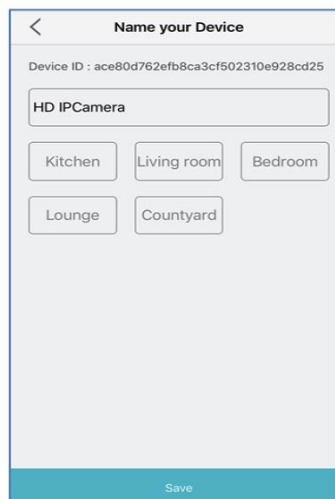

3.3 Set WIFI

Click  , select the wireless network settings, select the SSID of the connected external router in the search list, enter the router wifi connection password and confirm.

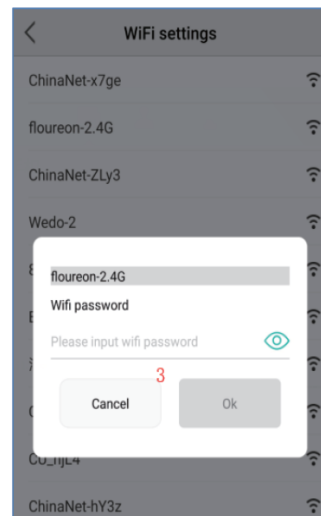
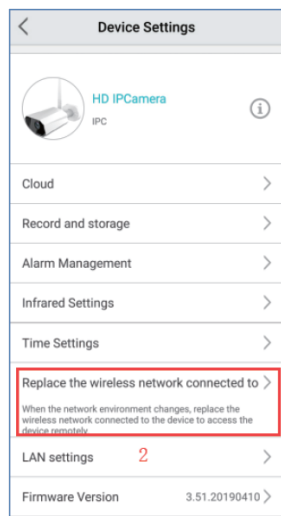
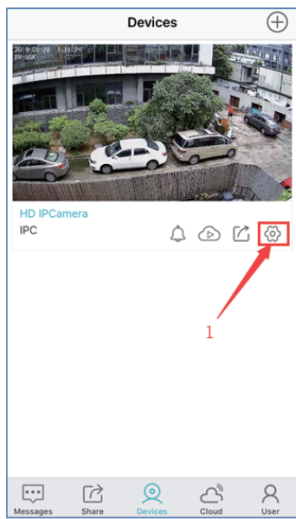

3.4 Operation interface introduction



3.5 Double light Alarm setting

Click  , select the Infrared Settings.

Note: Enabling partial mode requires motion detection to be enabled for it to take effect.

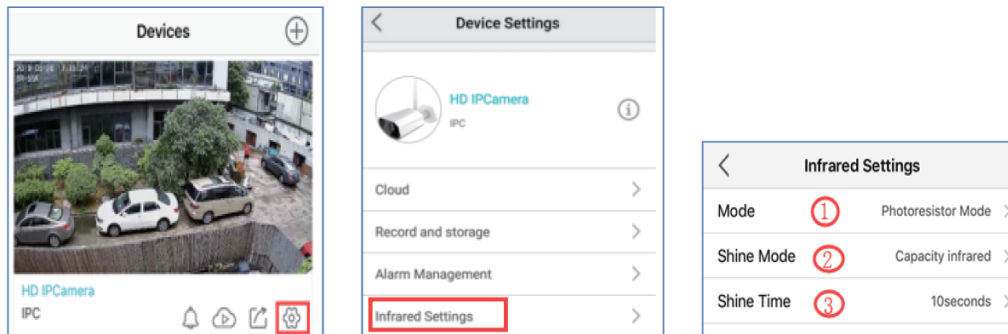

Mode: Timing Mode(Timed night vision start) Photoresistor mode(Automatically switch according to the environment) Auto Mode

Shine Mode: Full Color Capacity infrared Ordinary infrared

Shine Time: 10-60 seconds customize

AP Hotspot Configuration WIFI

1. Mobile phone connection device hotspot

1.1 Open the Ai View App and log in.

1.2 After the device is powered on, open the phone WIFI and connect to the device Hotspot HSIPC-XXXXXX in the search list.

The connection password: 12345678

Note: Make sure the camera is in factory mode before setting up. Press and hold the camera reset button for more than 5 seconds until you hear the sound.

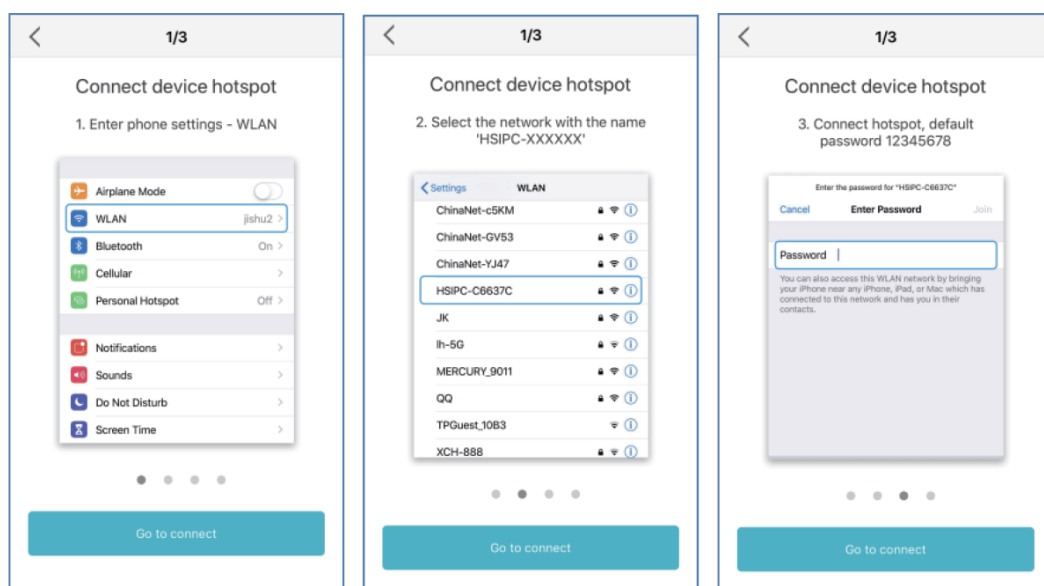

After the hotspot wifi connection is successful, the client will automatically search for and add devices.

① Open the Ai View mobile app and click the picture screen to pop up the setup password box.

② Enter a custom password of 6 or more digits and click to confirm to the next step.

Note: Please remember this password for use in subsequent WEB logins!

③ Set wifi

④ Enter wifi password

⑤ Add settings successfully

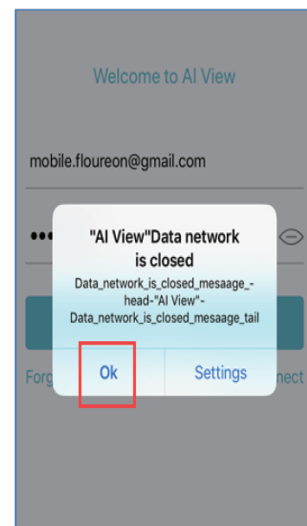
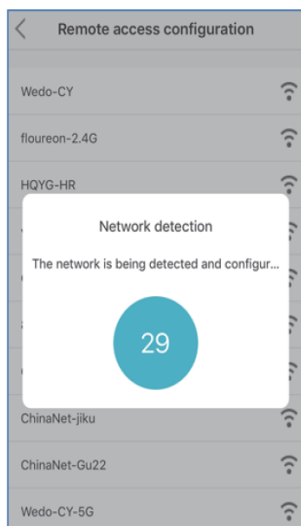
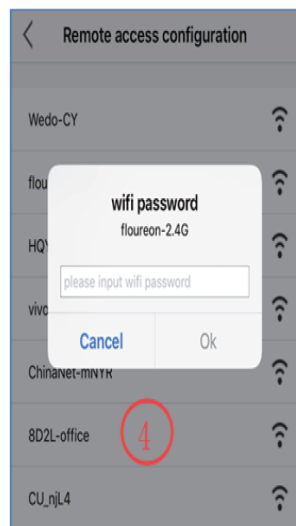
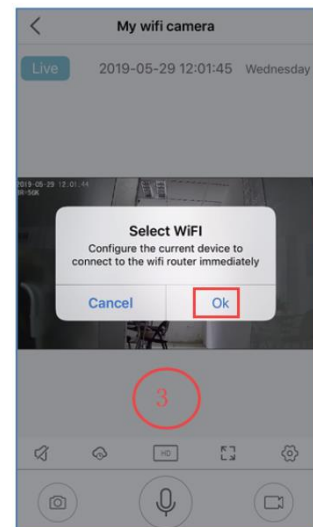
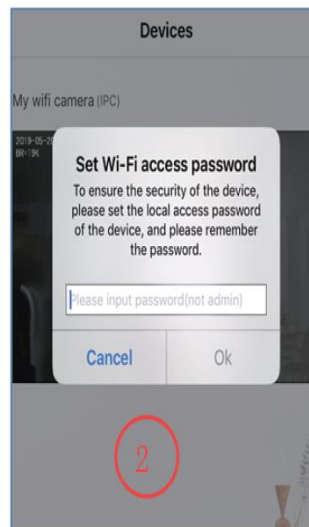
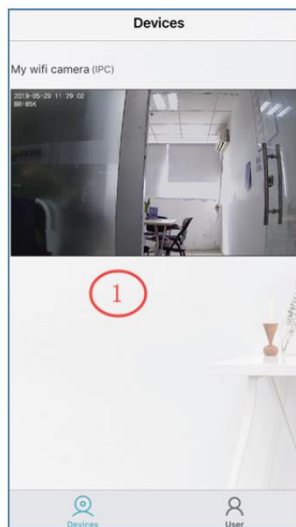

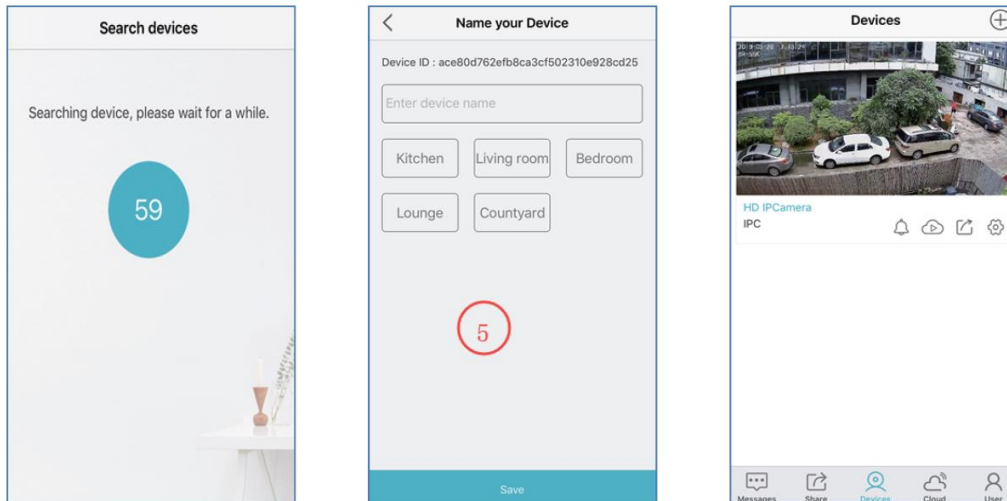

FCC Statement

This device complies with part 15 of the FCC Rules. Operation is subject to the following two conditions:

(1) This device may not cause harmful interference, and (2) this device must accept any interference received, including interference that may cause undesired operation. Any Changes or modifications not expressly approved by the party responsible for compliance could void the user's authority to operate the equipment.

Note: This equipment has been tested and found to comply with the limits for a Class B digital device, pursuant to part 15 of the FCC Rules. These limits are designed to provide reasonable protection against harmful interference in a residential installation. This equipment generates uses and can radiate radio frequency energy and, if not installed and used in accordance with the instructions, may cause harmful interference to radio communications. However, there is no guarantee that interference will not occur in a particular installation. If this equipment does cause harmful interference to radio or television reception, equipment generates, uses and can radiate radio frequency energy and, if not installed and used in accordance with the instructions, may cause harmful interference to radio communications. However, there is no guarantee that interference will not occur in a particular installation. If this equipment does cause harmful interference to radio or television reception,

- Reorient or relocate the receiving antenna.
- Increase the separation between the equipment and receiver.
- Connect the equipment into an outlet on a circuit different from that to which the receiver is connected.
- Consult the dealer or an experienced radio/TV technician for help.

FCC RF Radiation Exposure Statement

The equipment should be installed and operated with minimum distance 20cm between the radiator and your body.