

Network Camera Quick Start Guide

- Please read this instruction carefully before using the product and keep it for further reference.
- All the examples and pictures used here are for reference only.
- The contents of this manual are subject to change without notice.

1 Warning and Caution

- If the product does not work properly, please contact your dealer or the nearest service center. Never attempt to disassemble the camera yourself. (We shall not be responsible for any problems caused by unauthorized repair or maintenance.)
- Do not allow water or liquid intrusion into the camera.
- In the use of the product, you must be strict compliance with the electrical safety regulations of the nation and region. When the product is mounted on wall or ceiling, the device shall be firmly fixed.
- Do not use camera beyond specified voltage range.
- Do not drop the camera or subject it to physical shock.
- The product must be grounded to reduce the risk of electric shock.
- You must wear anti-static gloves or discharge static electricity before installing the camera.
- Avoid touching the camera lens.
- If cleaning is necessary, please use clean cloth to wipe it gently.
- Avoid aiming the camera directly towards the sun or other bright objects.
- Do not place the camera in extremely hot, cold (the operating temperature shall be -30°C~60°C), dusty or damp locations, and do not expose it to high electromagnetic radiation.
- To avoid heat accumulation, good ventilation is required for operating environment.

2 Package

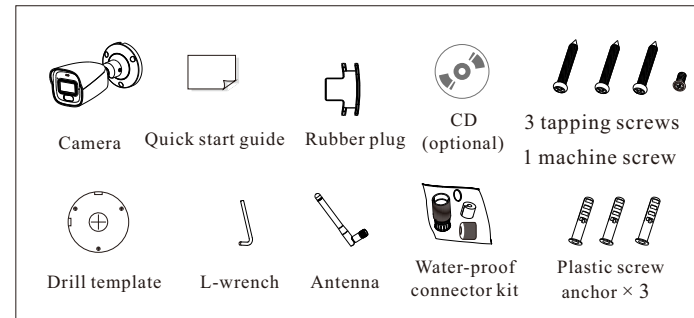

3 Overview

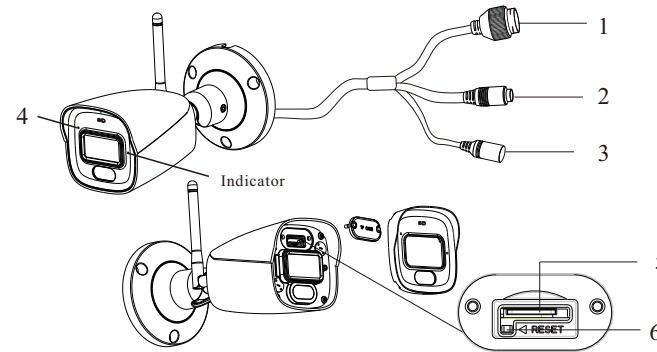

- Indicator
 - Solid red light: starting
 - Flashing red light: network disconnected
 - Flashing green light: upgrading
 - Flashing blue light: alarm triggered
 - Solid blue light: Wi-Fi setting mode
 - Solid green light: work normally

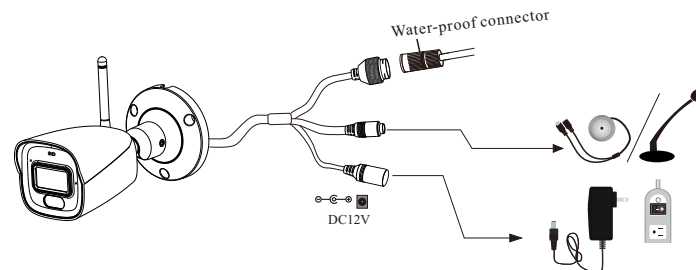

* 1 It is recommended to install the water-proof connector for outdoor installation.

* 2 Press and hold the reset button for more than 10 seconds to restore to the factory default setting.

4 Installation

Please make sure that the wall or ceiling is strong enough to withstand 3 times the weight of the camera. Please install and use the camera in a dry environment.

1 Loosen the set screw and then adjust the bracket as shown below. Install the antenna to the camera. After that, adjust the antenna and the bracket of the camera as needed.

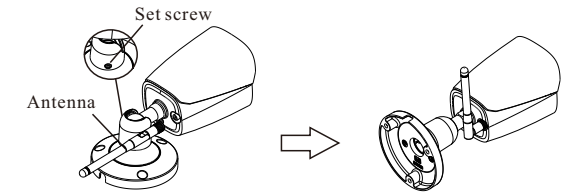

2. Install a micro SD card. Remove the plastic cover (a) from the camera and then loosen the two screws of (b). Remove (b) and then insert a micro SD card. After that, install back (b) and (a).

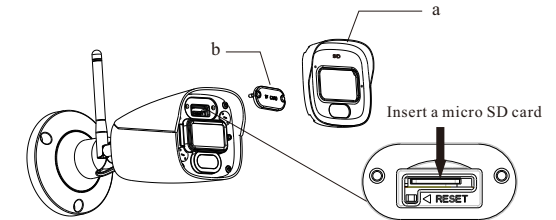

3. Attach the drill template to the place where you want to fix the camera and then drill the screw holes and the cable hole on the wall according to the drill template.

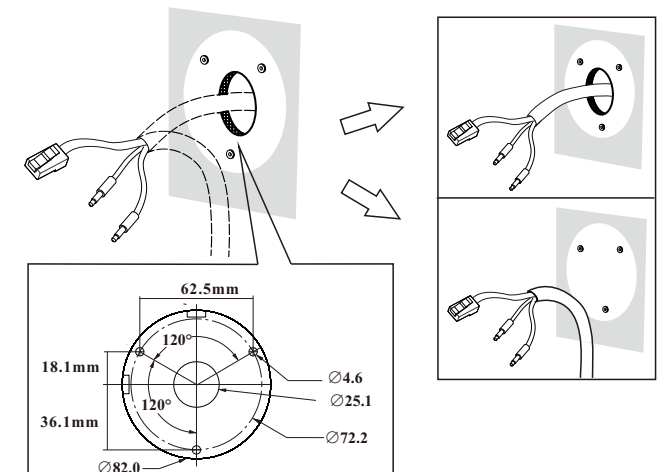

4. Route the cables and connect the relevant cables.

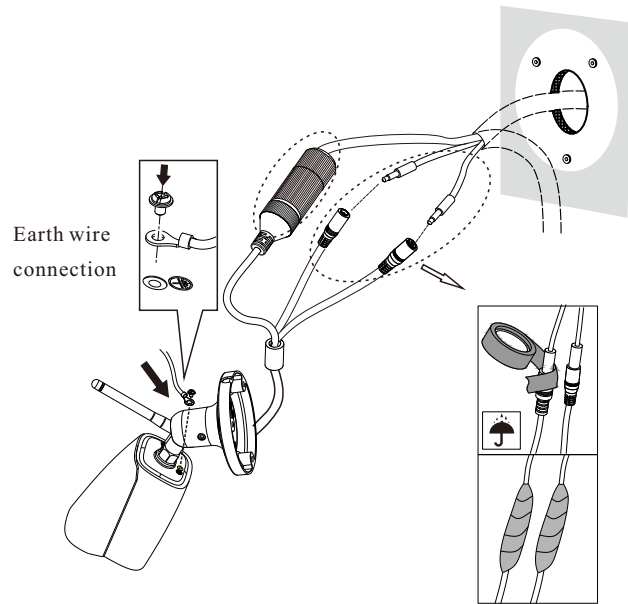

Connecting Network Cable

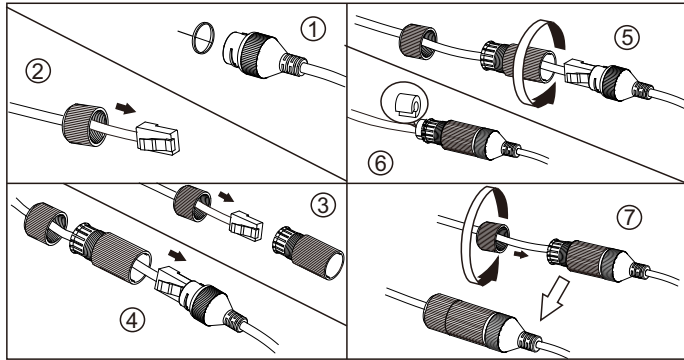

* If the RJ 45 connector of the network cable has a jacket and cannot be threaded through the kit, remove the jacket. If the jacket cannot be removed, cut off the connector and install an RJ 45 connector without the jacket.

5. Fasten the mounting base to the wall with the screws provided.

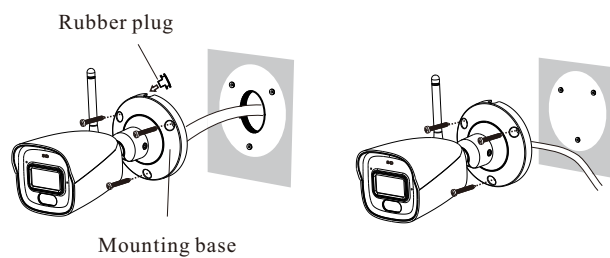

6. Loosen the set screw to adjust the viewing angle of the camera.
Before adjustment, view the image of the camera on a monitor.

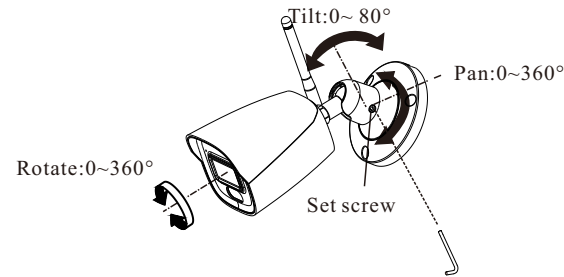

7. Tighten the set screw to finish the installation.

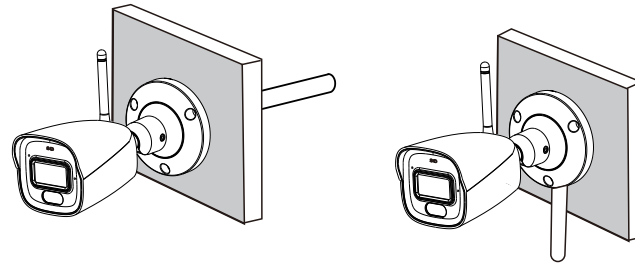

5 Network Connection

● Wired Network Connection

- ① Make sure that the device and the PC are connected via LAN.
- ② Get the IP-Tool from the supplier and then install it in the computer. After that, run the IP-Tool.
- ③ Double-click the device information listed in the IP-Tool to connect the device. If there are many devices, please find your device via its MAC address.

Note: Please make sure the device and the computer are in the same local network.

- ④ Read the privacy statement and then activate the device. The default username is **admin**. You need to self-define the password. Then set the security questions and answers. It is important for you to remember these answers, or you will not be able to reset your password.
- ⑤ Follow directions to download and install the plugin if prompted. After that, you can log in and configure the relevant parameters via web as needed.

● Wireless Network Connection

- ① Enable Wi-Fi network of your phone. Then scan the QR Code of the APP on the gift box to download and install the APP in your phone.
- ② Run the APP and then login in your account of the APP (if you don't register, please register and log in first).
- ③ Power on your camera. Then tap “” in the live interface of the APP. Scan the QR code on the camera and tap “Add”. Then follow directions to configure the Wi-Fi network. After you activate the camera, the device will be automatically added to the server list of the APP. You can view the video and receive the relevant information of the camera.

FCC Warning:

This equipment has been tested and found to comply with the limits for a Class B digital device, pursuant to part 15 of the FCC Rules. These limits are designed to provide reasonable protection against harmful interference in a residential installation. This equipment generates, uses and can radiate radio frequency energy and, if not installed and used in accordance with the instructions, may cause harmful interference to radio communications. However, there is no guarantee that interference will not occur in a particular installation. If this equipment does cause harmful interference to radio or television reception, which can be determined by turning the equipment off and on, the user is encouraged to try to correct the interference by one or more of the following measures:

- Reorient or relocate the receiving antenna.
- Increase the separation between the equipment and receiver.
- Connect the equipment into an outlet on a circuit different from that to which the receiver is connected.
- Consult the dealer or an experienced radio/TV technician for help.

Caution: Any changes or modifications to this device not explicitly approved by manufacturer could void your authority to operate this equipment.

This device complies with part 15 of the FCC Rules. Operation is subject to the following two conditions:

(1) This device may not cause harmful interference, and (2) this device must accept any interference received, including interference that may cause undesired operation.

This equipment complies with FCC radiation exposure limits set forth for an uncontrolled environment. This equipment should be installed and operated with minimum distance 20cm between the radiator and your body.