

MARCUS&MARCUS[®]

HAPPITEETH

Kids Premium Oral Care Set

Kids Sonic Toothbrush
MNMRC04

EN

INSTRUCTION FOR USE

SONIC ELECTRIC TOOTHBRUSH

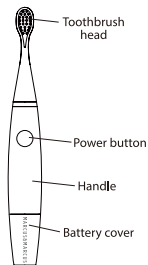

MARCUS&MARCUS X TOOTHBAT

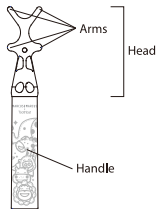

INTERACTIVE LCD BRUSHING TIMER

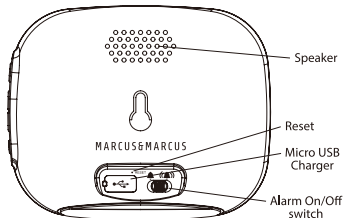
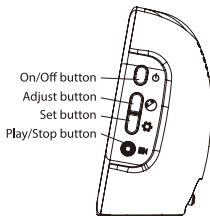
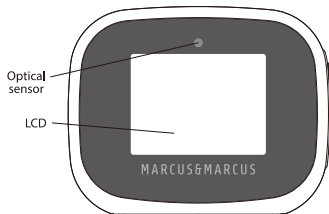

SONIC ELECTRIC TOOTHBRUSH & INTERACTIVE LCD BRUSHING TIMER

Place Battery To Sonic Electric Toothbrush

1. Turn battery cover as direction (1) and pull down as (2).
2. Insert a new AAA alkaline battery with (-) and (+) in correct orientation.
3. Install battery cover as (3) and turn it firmly as (4).

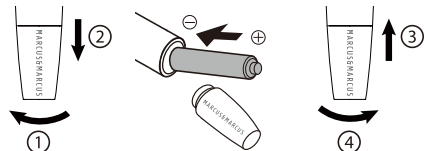

Insert Toothbrush Head Into The Sonic Electric Toothbrush

1. Plug the new toothbrush head into the notch and twist clockwise until the toothbrush head is secured. Wash toothbrush head thoroughly with warm-soapy water before initial use.
2. To replace the old toothbrush, twist the old toothbrush head anti-clockwise and pull it off.

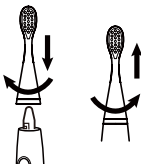

Charge Up The Interactive LCD Brushing Timer

1. Insert the micro USB plug from a 5V USB power adaptor (not included) to charge the LCD Brushing Timer for 4 hours or until battery is full. Disconnect charger when battery icon stops flashing and in full.
2. Press button to turn on the LCD Brushing Timer and the screen will show clock display. Flashing of battery icon shows that it is charging.

How To Set Clock On Interactive LCD Brushing Timer

1. Press to turn on the LCD Brushing Timer or during screen is ON.
2. Slide the CLOCK switch at the back to to activate the clock function.
3. Press , then press to adjust hour.
4. Press , then press to adjust minute.
5. Press once finished.

How To Set Alarm Clock On Interactive LCD Brushing Timer

1. Press to turn on the LCD Brushing Timer or during screen is ON.
2. Slide to at the back to activate the alarm function.
3. To set the alarm time, press when flashing, press to adjust hour.
4. Press , then press to adjust minute.
5. Press once finished, the alarm time will flash for 10 seconds and back to the clock mode.

How To Reboot The Interactive LCD Brushing Timer

The LCD Brushing Timer is needed to reboot if there are no responses to any switches even the battery has not been drained out.

1. Insert a straightened paperclip or tool into the reset hole when the LCD Brushing Timer is charging.
2. The screen will reboot or press to turn on the LCD Brushing Timer.

How To Use Sonic Electric Toothbrush & Interactive LCD Brushing Timer

- Press **⏻** to turn on the LCD Brushing Timer. The screen will be ON for 2 minutes and it will be remained in its standby mode.
- LCD Brushing Timer will be activated when someone moves in front of the optical sensor or change of light.
- Apply toothpaste to the toothbrush head before pressing **⏻**.
- Once press the toothbrush power button, it will transmit a RF signal to the LCD Brushing Timer.
- LCD Brushing Timer can receive RF signal within 5 meters range.
- LCD Brushing Timer will start one of the 3 animations randomly at the same time to encourage kids to brush for 2 minutes.
- If the toothbrush power button is pressed before the 2-minute completion, the screen will show a message of "Try Harder Next Time".
- Charge up LCD Brushing Timer when the battery icon is flashing by inserting the micro USB plug from a 5V USB power adaptor (not included). Disconnect charger when battery icon stops flashing and in full.
- If you wish to power off the LCD Brushing Timer, press and hold **⏻** for 3 seconds.
- You can play or stop animation by pressing **⏻** during screen is ON.
- When the vibration of the toothbrush is gradually weakened indicating that the battery is almost drained, replace it by a new AAA alkaline battery. Before replacing the battery, ensure the handle is thoroughly dry to prevent water drops entering it.

SPECIFICATION

Sonic Electric Toothbrush

Operation voltage: 1.5V DC

Battery: AAA Alkaline battery

IPX7

Sonic Vibration: Frequency 7000 oscillations/ min

Interactive LCD Brushing Timer

Operation voltage: 3.7V DC

Battery: Rechargeable Lithium battery (built-in)

Charging voltage: 5V DC

MARCUS&MARCUS X TOOTHBAT

How To Use The Marcus&Marcus x Toothbat

- Turn handle to align the head.
- Wrap the floss as direction shown, then lay on 4 arms and wrap again.
- Twist handle to control the floss tension.
- Use the top floss to clean all molars.
- Use side floss for other teeth.

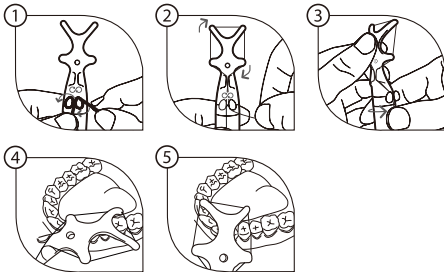

FCC Statement

Changes or modifications not expressly approved by the party responsible for compliance could void the user's authority to operate the equipment. This equipment has been tested and found to comply with the limits for a Class B digital device, pursuant to Part 15 of the FCC Rules. These limits are designed to provide reasonable protection against harmful interference in a residential installation. This equipment generates uses and can radiate radio frequency energy and, if not installed and used in accordance with the instructions, may cause harmful interference to radio communications. However, there is no guarantee that interference will not occur in a particular installation. If this equipment does cause harmful interference to radio or television reception, which can be determined by turning the equipment off and on, the user is encouraged to try to correct the interference by one or more of the following measures:

- Reorient or relocate the receiving antenna.
- Increase the separation between the equipment and receiver.
- Connect the equipment into an outlet on a circuit different from that to which the receiver is connected.
- Consult the dealer or an experienced radio/TV technician for help.

This device complies with part 15 of the FCC rules. Operation is subject to the following two conditions (1) this device may not cause harmful interference, and (2) this device must accept any interference received, including interference that may cause undesired operation.

1 year warranty applies to this product from the date of purchase. According to the condition of the product, defective caused by the device itself or during production will be replaced free of charge for 1 year.

Please register online at
www.marcusnmarcus.com

CLEANING & CARE:

- Wash toothbrush head thoroughly with warm-soapy water before initial use. After use, rinse toothbrush head thoroughly, shake off excess water and store upright.
- Do not wash the toothbrush head with water hotter than 80°C (176°F).
- Do not immerse the toothbrush under water.
- Do not strike or knock the toothbrush with too much strength.
- Do not use any other toothbrush heads other than that recommended by the manufacturer.
- Make sure the battery cover is fixed firmly when washing the toothbrush.
- Take out battery of toothbrush if no intention to use for an extended period of time.
- The LCD Brushing Timer is not water proof. Check and make sure no water on the Brushing Timer. Whips it dry if necessary. Otherwise, it may cause malfunction.
- Store products in a dry place. Do not leave products in direct sunlight or near a source of heat.

FOR YOUR CHILD'S SAFETY AND HEALTH WARNING:

- This is not a toy. This product is for tooth brushing only.
- Do not chew or bite on toothbrush. Battery choke hazard.
- Do not install batteries backwards, charge or put in fire. May explode or leak causing injury.
- Always use AAA alkaline batteries. Use of non-alkaline batteries may result in a drastically reduced operating time.
- If battery cover is not secured, water leakage may cause malfunction of the toothbrush.
- Not suitable for children under 3. Always use with adult supervision.
- Do not leave child unattended while using the product.
- Keep away from children when not in use.
- Inspect the product before each use.
- Dentists recommend to replace toothbrush every 3 months or sooner if toothbrush head looks worn.
- Discard and replace at first signs of damage or weakness.

CLEANING & CARE:

- Wash Toothbat head thoroughly with warm-soapy water before initial use.
- After use, rinse head thoroughly, shake off excess water and store upright.
- Avoid water seepage into handle when washing.
- Do not immerse the Toothbat under water.
- Store products in a dry place.
- Do not leave products in direct sunlight or near a source of heat.

FOR YOUR CHILD'S SAFETY AND HEALTH WARNING:

- This is not a toy. Not suitable for children under 3. Always use with adult supervision.
- Do not leave child unattended while using the product.
- Keep away from children when not in use.
- Inspect the product before each use.
- Discard and replace at first signs of damage or weakness.
- If continuous bleeding or gum discomfort, stop using the product and consult your dentist.