

USER MANUAL

F17 wireless headset

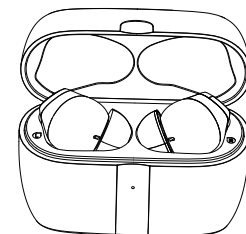

DIAGRAM

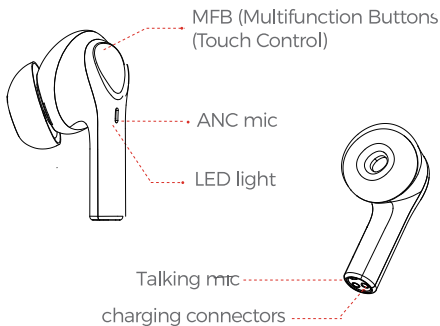
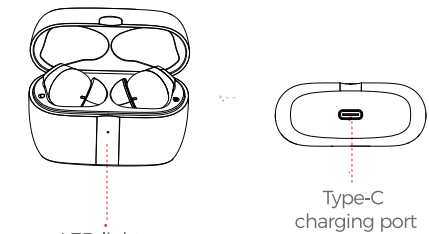

PAIRING

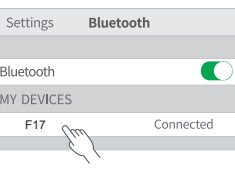
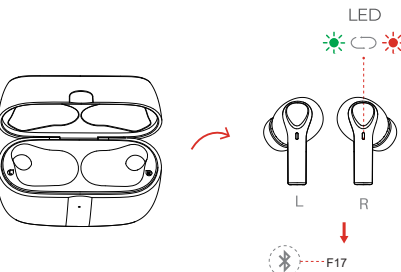

take out the earphones, they automatically enter the pairing mode when the green and red lights start flashing alternately, and then select "F17".

-2-

Startup & Shutdown

Note:
the earbud will reconnect to the paired device by priority, if you want to pair to other smartphone, please disconnect bluetooth on the paired smartphone.

power on

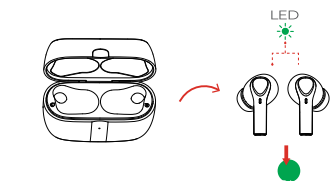

power off

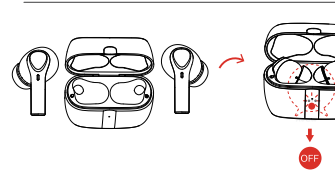

-3-

MUSIC

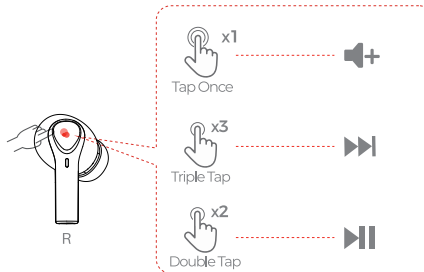
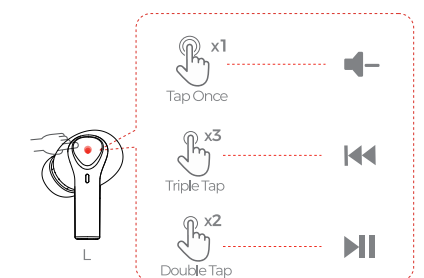

-4-

INCOMING CALL

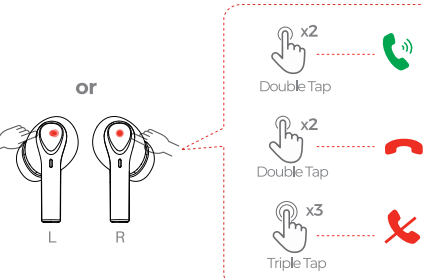

ACTIVATE Siri

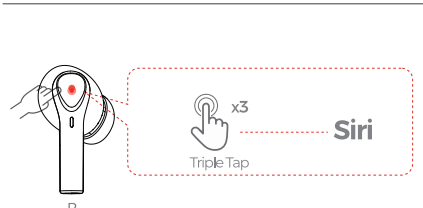

-5-

ANC MODE

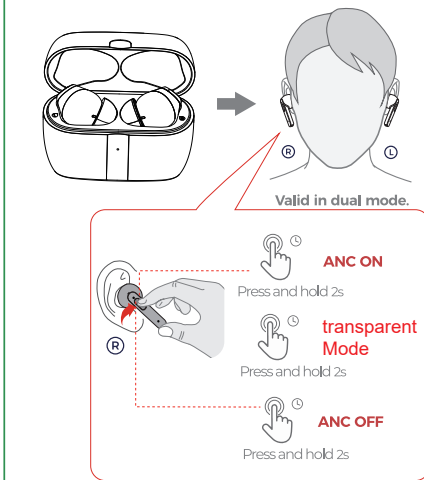

twin mode press and hold the left or right earbud for 2 seconds to turn on or off the ANC.

-6-

CHARGING

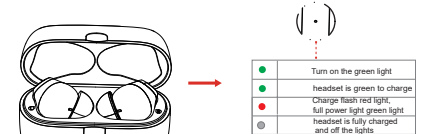
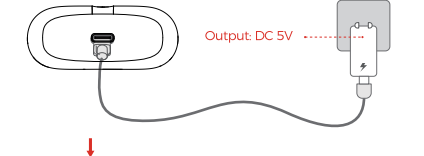

do not put the earbuds in the charging case when the earbuds are wet.

-7-

PACKING LIST

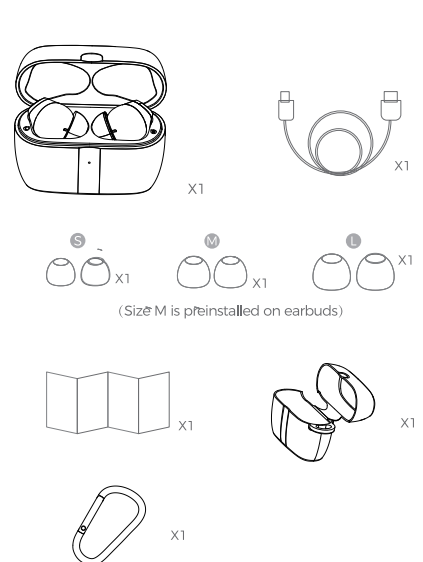

-8-

CORRECT DISPOSAL OF THIS PRODUCT

this marking shown on the product or is literature indicate that it should not be disposed with other household wastes at the end of its working life. to prevent possible harm to the environment or human health from uncontrolled waste disposal please separate this from other types of wastes and recycle it responsibly to promote the sustainable reuse of material resources household user should contact either the retailer where they purchased this product or their local government office, for details of where and how they can take this item for environmentally safe recycling business users should contact their supplier and check the terms and conditions of the purchase contact this product should not be mixed with other commercial wastes for disposal.

FCC STATEMENT

any changes or modifications not expressly approved by the party responsible for compliance could void the user's authority to operate the equipment this device complies with part 15 of the FCC rules operation is subject to the following two conditions. (1) this device may not cause harmful interference and (2) this device must accept any interference

-9-

FCC STATEMENT

released including interference that may cause undesired operation. FCC Radiation Exposure statement this equipment complies with FCC radiation exposure limits set forth for an uncontrolled environment.

-10-

FCC Caution:

This device complies with part 15 of the FCC Rules. Operation is subject to the following two conditions: (1) This device may not cause harmful interference, and (2) this device must accept any interference received, including interference that may cause undesired operation.

Any Changes or modifications not expressly approved by the party responsible for compliance could void the user's authority to operate the equipment.

Note: This equipment has been tested and found to comply with the limits for a Class B digital device, pursuant to part 15 of the FCC Rules. These limits are designed to provide reasonable protection against harmful interference in a residential installation. This equipment generates uses and can radiate radio frequency energy and, if not installed and used in accordance with the instructions, may cause harmful interference to radio communications. However, there is no guarantee that interference will not occur in a particular installation. If this equipment does cause harmful interference to radio or television reception, which can be determined by turning the equipment off and on, the user is encouraged to try to correct the interference by one or more of the following measures:

- Reorient or relocate the receiving antenna.
- Increase the separation between the equipment and receiver.
- Connect the equipment into an outlet on a circuit different from that to which the receiver is connected.
- Consult the dealer or an experienced radio/TV technician for help.

The device has been evaluated to meet general RF exposure requirement. The device can be used in portable exposure condition without restriction.