

UltraPro™

Wireless Headset Mono

Detachable 2nd earpiece



See reverse for exclusive deals

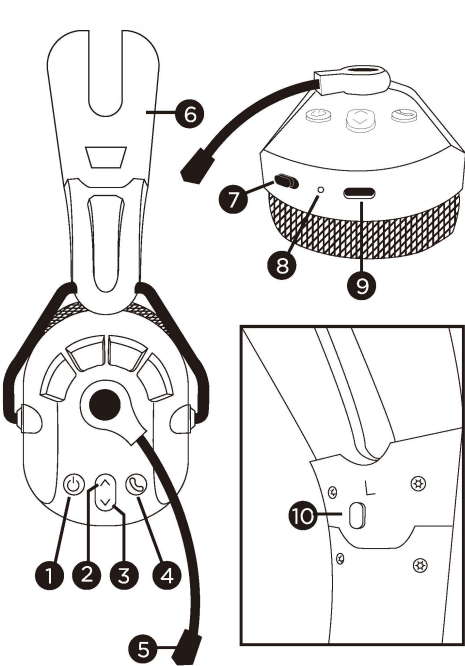

Headset Overview

- 1. Power ON/OFF and play/pause
- 2. Volume up and next track
- 3. Volume down and previous track
- 4. Call button
- 5. Microphone
- 6. Adjustable headband
- 7. Microphone ON/OFF
- 8. LED indicator light
- 9. USB-C charging port
- 10. Ear cup release button

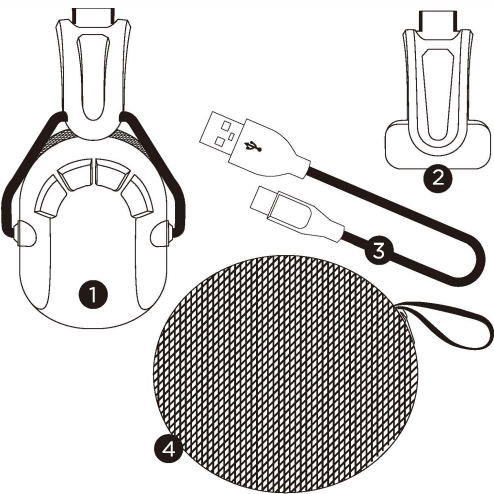

Included Accessories

- 1. Detachable ear cup
- 2. Detachable anti-slip pad
- 3. USB-A to USB-C charging cable
- 4. Carry case

Charging the Headset

To charge the headset, use the included USB-A to USB-C charging cable to connect the headset's USB-C port to a powered USB-A outlet. A full charge will take approximately 2.5 hours. The headset's red indicator light will illuminate while charging and will turn off once charging is complete.

NOTE: This headset is safe to use while charging.

Low Battery Indicator

When the battery level is low, the headset's red indicator light will blink twice every 30 seconds. Once the battery's voltage is below 3.2V, the headset will automatically turn off.

Setup

Mono Mode – Single Ear Cup

Convert the headset to mono mode by replacing the left ear cup with the anti-slip pad.

- 1. Press and hold the ear cup release button.
- 2. Pull the left ear cup downward to remove.
- 3. Insert the anti-slip pad into the headband until it snaps into place.

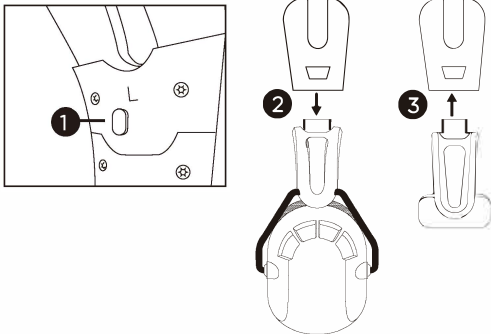

Stereo Mode – Dual Ear Cups

Convert the headset to stereo mode by replacing the anti-slip pad with the left ear cup.

- 1. Press and hold the ear cup release button.
- 2. Pull the anti-slip pad downward to remove.
- 3. Insert the left earcup into the headband until it snaps into place.

Operation

Microphone

The microphone's flexible boom easily bends for perfect positioning and rotates up to 280° for use with either left or right orientation.

Power ON

Press and hold the POWER button for approximately two seconds. The indicator light will flash red and blue, and several beeps in ascending tones will sound. The indicator light will remain blue while the headset is turned on.

Power OFF

Press and hold the POWER button for approximately three seconds. The indicator light will illuminate light purple for one second, and several beeps in descending tones will sound. The indicator light and headset will then turn off.

Pairing to Bluetooth

- 1. Make sure your mobile phone, computer or audio device is turned on and within 3ft. (1m) of the headset.
- 2. Activate your phone or device's Bluetooth and search for **UPmono** in the list of Bluetooth devices. You will hear two beeps, and the indicator light will alternately flash red and blue.
- 3. Once UPmono appears in the list, click on it to complete the pairing process. You will hear one beep. The indicator light will stop flashing and then remain blue.

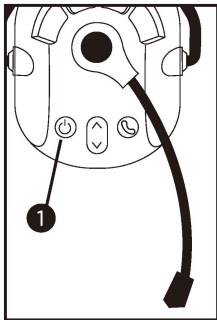

Thank you for your purchase!



Instructions made easy

Read instructions or watch an easy-to-follow video.

Scan code or visit byjasco.com/82454i.



Register your product

Receive exclusive deals and register your product.

Scan code or visit byjasco.com/deals.



Enhance your home entertainment experience at byjasco.com/ce



Like our product?

Leave a review on your favorite retailer website or amazon.com.



Having problems?

Let us know how we can help. Call **1-800-654-8483**, M-F.

Pairing to Two Mobile Phones

- 1. Follow the instructions in the Pairing to Bluetooth section to pair the headset to the first mobile phone.
- 2. Turn on the headset, then turn off the first phone's Bluetooth. The headset will enter pairing mode again.
- 3. Activate your second phone's Bluetooth and search for **UPmono** in the list of Bluetooth devices. You will hear a beep, and the indicator light will alternately flash red and blue.
- 4. Once **UPmono** appears in the list, click on it to complete the pairing process.
- 5. Turn on the first mobile phone and manually connect it to the headset.

Note: If a Bluetooth connection is not made within 10 minutes, the headset will automatically turn off.

Audio Controls

Volume

The headset's default volume level is 70% when connected to a new device. Once a device has been connected to the headset, the headset will remember that device's audio setting and will revert to it whenever that device is connected.

Media Functions

- Play/Pause - Tap the POWER button
- Volume up - Tap the ^ button
- Volume down - Tap the v button
- Next track - Press and hold the ^ button
- Previous track - Press and hold the v button

Call Functions

- Answer/Hang up - Tap the phone icon button
- Reject calls - Double click the phone icon button
- Cancel dialing - Tap the phone icon button
- Microphone ON/OFF – To mute the microphone, slide the microphone ON/OFF button to the OFF position. If you've started a call and then turn the microphone on or off, you'll hear: "Microphone on" or "Microphone off."

Voice Assistant for iPhone and Android

- Turn on – Press and hold the phone icon button for two seconds. A beep will sound once your phone's voice assistant has been activated.
- Turn off – Press and hold the phone icon button for one second.

NOTE: Bluetooth must be connected.

Specifications

Audio:
•Environmental Noise Cancellation (ENC)
•Speaker size: 40mm
•Speaker frequency range: 20Hz to 20KHz
•Speaker power: 10mW

Connectivity:
•Bluetooth version: 5.4
•Operating range: 32ft./10m
•Bluetooth profiles: HSP/HFP/A2DP/AVRCP

Battery:
•Battery type: Lithium polymer battery, 490mAh, 1.813Wh
•Charge time: ~2.5 hours
•Play time: ~15 hours*
•Stand-by time: ~30 days
•Charging input: USB-C, 5V, 500mA

General:
•IP Rating: IP54
•Operating temperature: -20°C to 40°C/-4°F to 104°F
•Storage temperature: -10°C to 30°C/14°F to 86°F
•Included USB cable: 90cm/2.9ft, USB-A to USB-C

*Play time will vary depending on environment and music

FCC Radiation Exposure Statement

The device has been evaluated to meet general RF exposure requirement. The device can be used in portable exposure condition without restriction.

FCC STATEMENT:

Suppliers Declaration of Conformity | Model #: 82454 | Jasco Products Co., 10 E. Memorial Rd., Oklahoma City, OK 73114, www.byjasco.com

This device complies with Part 15 of the FCC Rules. Operation is subject to the following two conditions: (1) this device may not cause harmful interference, and (2) this device must accept any interference received, including interference that may cause undesired operation.

FCC NOTE: The manufacturer is not responsible for any radio or TV interference caused by unauthorized modifications to this equipment. Such modifications could void the user's authority to operate the equipment.

NOTE: This equipment has been tested and found to comply with the limits for a Class B digital device, pursuant to Part 15 of the FCC Rules. These limits are designed to provide reasonable protection against harmful interference in a residential installation. This equipment generates, uses and can radiate radio frequency energy and, if not installed and used in accordance with the instructions, may cause harmful interference to radio communications. However, there is no guarantee that interference will not occur in a particular installation. If this equipment does not cause harmful interference to radio or television reception, which can be determined by turning the equipment off and on, the user is encouraged to try to correct the interference by one or more of the following measures:

- Reorient or relocate the receiving antenna.
- Increase the separation between the equipment and receiver.
- Connect the equipment into an outlet on acircuit different from that to which the receiver is connected.
- Consult the dealer or an experienced radio/TV technician for help.

⚠ WARNING

- FOR BEST BATTERY HEALTH AND LONG-TERM CAPACITY, AVOID STORING THE HEADSET IN HOT OR COLD ENVIRONMENTS.
- DO NOT STORE THE HEADSET FOR MORE THAN 90 DAYS WITHOUT RECHARGING IT.
- DO NOT USE IN CONDITIONS OF EXTREME HEAT OR IN CONFINED SPACES WITH LIMITED AIRFLOW.
- USE ONLY IN DRY CONDITIONS. DO NOT IMMERSE IN LIQUIDS.
- DO NOT CONTINUE TO USE OR ATTEMPT TO CHARGE THE PRODUCT IF IT HAS BEEN PUNCTURED OR DAMAGED, EXHIBITS ANY ABNORMAL CHARACTERISTICS SUCH AS EXCESSIVE HEATING OR SWELLING OR EMITS AN ODOR.
- IF BATTERY CONTENTS TOUCH SKIN OR CLOTHING, WASH IMMEDIATELY WITH MILD SOAP AND WATER.
- IF BATTERY CONTENTS ENTER EYES, IMMEDIATELY FLOOD EYES WITH CLEAN, COLD RUNNING WATER FOR AT LEAST 10 MINUTES AND GET IMMEDIATE MEDICAL ATTENTION.



MADE IN CHINA/HECHO EN CHINA

Distributed by Jasco Products Company LLC, 10 E. Memorial Rd., Oklahoma City, OK 73114.

This Jasco product has a 1-year limited warranty. Visit www.byjasco.com for warranty details.

Questions? Contact our U.S.-based Consumer Care at 1-800-654-8483, M-F.

PATENTS/PATENTS PENDING

[WWW.BYJASCO.COM/PATENTS](https://www.byjasco.com/patents)