

Language learning machine
User guide

Function Description

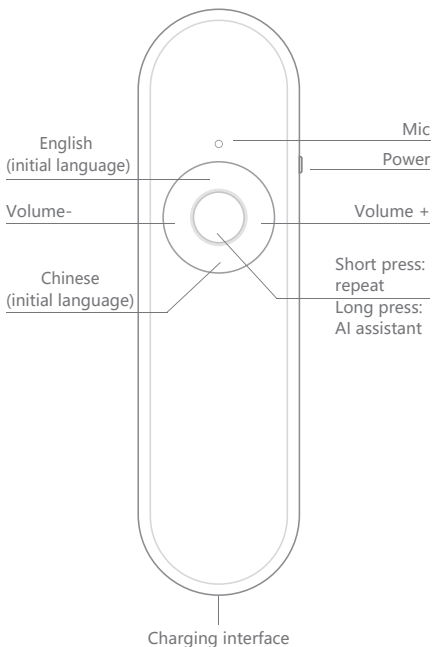

Function Description

Connect Network

1.Scanning the QR code to download and install "T9 Translator" APP .



"T9 Translator" APP

2.Open APP, register an account with your Email.

3. According to the prompt step in APP, the device can be connected to the Internet, which can connect 2.4G WiFi or the hotspot of this mobile phone.

Power ON/OFF

Slide power switch to power ON/OFF.

Voice translation

1.In the initial state,press the voice key above to speak English and translate it into Chinese.

2.In the initial state,press the voice key below to speak Chinese and translate it into English.

3. Other translation languages can be selected in APP.





YuanRen Technology

Charging, battery safety and precautions

Charging, battery safety and precautions

- This product contains sensitive electronic components,Do not disassemble,repair or modify it yourself,Avoid using it in environments with excessive or excessive temperature,Avoid prolonged exposure to strong sunlight or high humidity,Dangerous chemicals and strong magnetic fields.
- Do not use this product in a gas station, fuel depot,chemical plant,fuel or chemical transportation or storage facility,as this may cause an explosion or fire.
- Please do not use high volume for a long time to prevent possible hearing damage.

Environmental instructions

Part Name	Toxic or harmful substances or elements					
	(Pb)	(Hg)	(Cd)	(Cr(VI))	(Pbb)	(PBDE)
Shell	O	O	O	O	O	O
Battery	O	O	O	O	O	O
Charging Cable	O	O	O	O	O	O
Circuit board and components	O	O	O	O	O	O

This form has been prepared in accordance with the provisions of SJ/T 11364

O:Indicates that the content of hazardous substances in all homogeneous materials of this part is below the limit requirement specified in GB/T 26572.

X:Indicates that the content of hazardous substances in at least one of the homogeneous materials of the part exceeds the limit requirement specified in GB/T 26572.

Product parameters

Model	Amigo T9
Voice translation	Support 40+ languages to translate, covering188+ countries and regions around the world.
Dimensions	133*33*2.3mm
Body weight	116g
Mattery capacity	1300mAh
Network support	2.4G WIFI
Mic	Silicon Mic
Speaker	High fidelity speaker
Charging interface	Micro USB, 5V 1A

Troubleshooting

Unable to boot

1. Check the battery is exhausted or not, and check the remaining power in APP.
2. Insert charging wire to charge the device, and the charging status will be displayed in APP when charging.

Weak signal

1. Check the mobile phone hotspot and the network environment of the router.
2. Restart the device and try again.

Unable to connect

Using WIFI/Hot Network

1. Check if other devices can connect to the current WIFI/hotspot network and access the Internet.
2. Check if the password is entered incorrectly.
3. Check if there is a connection limit on the WIFI router.
4. When the iphone user turns on the hotspot, if there is a "Open Wi-Fi" popup window, please select Open.

Inaccurate translation

1. Try to use standard speech rate and Mandarin when speaking.
2. Try to be as close as possible to the device.
3. Use device in quiet environment as far as possible.

Short standby time

1. Don't use equipment to play music and stories for a long time.
2. Reduce the volume of the translator when playing.

Did not hear clearly

Increase the volume and play it again.

Function Description

AI assistant

Long press this key and ask AI assistant questions. It knows astronomy, geography, ancient poems, lunyu, stories and songs.

Try hold on this key and ask:

"Will it rain tomorrow in Newyork?"

"Recite a Tang poem"

Why is the sky blue?

"Sing a Pop Song"

"Tell me a story"



Repetition

Press this button to repeat the last translated language.

You can listen and repeat while you follow.



Oral test

In APP, follow-up training and oral learning can be carried out, and the pronunciation of words can be evaluated, scored, and the wrong pronunciation can be corrected.

At present, it supports Chinese test, and more languages continue to upgrade.

Volume adjust

Press the left and right volume keys to adjust the volume.

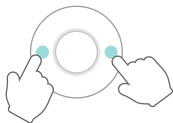

FCC WARNING

This device complies with part 15 of the FCC Rules. Operation is subject to the following two conditions: (1) this device may not cause harmful interference, and (2) this device must accept any interference received, including interference that may cause undesired operation.

Any changes or modifications not expressly approved by the party responsible for compliance

could void the user's authority to operate the equipment.

NOTE: This equipment has been tested and found to comply with the limits for a Class B digital device, pursuant to Part 15 of the FCC Rules. These limits are designed to provide reasonable protection against harmful interference in a residential installation.

This equipment generates, uses and can radiate radio frequency energy and, if not installed and used in accordance with the instructions, may cause harmful interference to radio communications. However, there is no guarantee that interference will not occur in a particular installation.

If this equipment does cause harmful interference to radio or television reception, which can be determined by turning the equipment off and on, the user is encouraged to try to correct the interference by one or more of the following measures:

- Reorient or relocate the receiving antenna.
- Increase the separation between the equipment and receiver.
- Connect the equipment into an outlet on a circuit different from that to which the receiver is connected.

-- Consult the dealer or an experienced radio/TV technician for help. The device has been evaluated to meet general RF exposure requirement. The device can be used in portable exposure condition without restriction

FCC ID: 2ATMO-T9