

GETTING STARTED

QUICK GUIDE: THE SOMATIX SMARTBAND FOR SAFEBEING™

Welcome to the Somatix smartband – a device that complements our wearable-assisted gesture detection platform.

What you'll find in the box.

1. Somatix smartband
2. Charging cable
3. Quick guide user manual



Prior to setting up your Somatix smartband, be sure to download the SafeBeing™ app from Google Play and follow the instructions to set up the app on your smartphone.



Version 2 August 2019

INITIAL SETUP

I. CHARGE

1. Remove the smartband from the box, pull the small plastic module out of the silicone wristband, and connect it to a computer USB port or wall adapter via the supplied charging cable. The three green LEDs on the smartband will blink during charging, and a full charge should take around three hours to complete.
2. Once fully charged, insert the module back into the silicone wristband. Note the orientation of the module in relation to the small notch on the back of the smartband to ensure proper reinsertion.

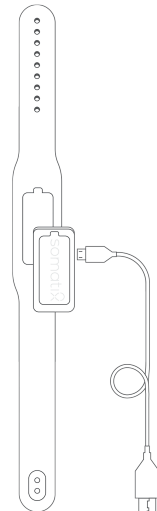

II. PAIR

1. To pair the smartband, ensure that Bluetooth is enabled on your smartphone, then launch the SafeBeing app.
2. Enter your phone number, wait for the registration confirmation notification sent to your smartphone and enter the code in the app. Note that in order to use the app you must first be registered by your clinic in the SafeBeing dashboard.
3. Select and tap 'Smartband' from the wearable's list. Then, press the button twice on your smartband, if done correctly, the app will display a pairing confirmation notification (see illustration below).

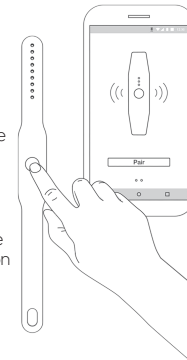

Led indication during the pairing procedure:

 Pairing
(blinking red & blue)

 Pairing successful
(solid blue)

 Pairing failed
(solid red)

III. GO

The Somatix smartband is now ready to use. Be sure to wear it on the correct wrist and in the proper orientation with the LED indicators facing up.

Press the button on the smartband briefly at any time to display its battery charge level (see illustration below).

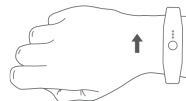
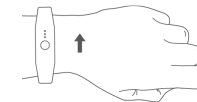

Low charge



Medium charge



Battery full

somatix®
Data with a purpose

FREQUENTLY ASKED QUESTIONS/ TROUBLESHOOTING

Do I have to carry my smartphone with me all the time for the smartband to work properly?

The smartband is capable of working autonomously to transmit relevant data to your smartphone, but the smartphone needs to be in close proximity to ensure a consistent flow of data. The smartband will transmit data once it is back in range. The ideal range is up to 22 feet, assuming there are no walls or devices obstructing transmission.

What does the emergency alert button do?

You can trigger an emergency alert by holding the button on your smartband. This sends an alert to your designated emergency family contacts and your caretaker's mobile device and/or dashboard. Note, it does not dispatch emergency services such as an ambulance. For such matters, please dial 911.

My smartband is unresponsive, and the LEDs do not light up when I press the button?

This is most likely due to the smartband needing to be recharged. Recharge the smartband. If the smartband still doesn't respond, simply reset the smartband by pressing the pairing button for approximately 20 seconds, then press for 3 additional seconds to activate the smartband. Then press 'Forget' in the app and run the pairing process again or contact Somatix technical support.

Is the smartband waterproof?

Yes, the Somatix Smartband is designed to be waterproof and can withstand showers, washing dishes and rain. However, please avoid swimming in your Smartband.

When do I need to update the smartband software version?

Whenever a software version update notification appears on your smartphone. You may need to perform an update after the initial pairing, or when a new version is released.

My smartband won't pair with my smartphone. What should I do?

Ensure that Bluetooth is enabled on your smartphone, that the smartband is charged and that the two devices are in close proximity, then repeat the pairing procedure in the app. Keep both smartband and smartphone away from metal surfaces (such as a metal countertop, for example) during pairing, as this may severely impair the wireless signal quality.

My smartband will not charge. What should I do?

Charge it for three hours. If the smartband still doesn't respond, try using another USB cable to charge it. Each charge will last 3-5 days.

I'm trying to update to a new software version, but the process won't work. What should I do?

Make sure your smartband is connected to a charger, and in close proximity to the smartphone during the entire update process. If after 5 minutes the update process has not yet started, briefly press the button on the smartband twice.

If, for any reason, the smartband continuously fails to pair or update, contact Somatix technical support.

For more information, please visit
www.somatix.com or e-mail support@somatix.com

© Copyright 2019. All rights reserved. Somatix, the Somatix logo, the Somatix real-time gesture detection platform and SafeBeing are trademarks of Somatix. All other names and brands are trademarks or registered trademarks of their respective owner(s).



SOMATIX SMARTBAND User Guide

For use with SafeBeing™

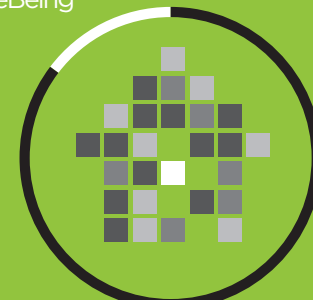

MANUFACTURER DETAILS

Produced by: Somatix©
Website: www.somatix.com
Commercial Name: Somatix Smartband
Model: SB01
FCC ID: 2ATLI-SB01

PRODUCT LABELING INFORMATION

Each device is identified by:

- Manufacturer logo imprinted on the top of the band
- FCC ID is printed on the top face of the capsule
- Model number is printed on the top face of the capsule
- Serial number is printed on the bottom face of the capsule
- Regulatory compliance: CE, FCC, RoHS
- IP code: 67 indicating that the Somatix Smartband is dust tight and resistant to immersion in water up to 1 m depth for up to 30 minutes

 Represents compliance of the Somatix Smartband with the European Community Directive on medical devices 93/42/EEC.

 Represents compliance of the Somatix Smartband with the Federal Communications Commission Declaration of Conformity.

 Represents compliance of the Somatix Smartband with the Restriction of Hazardous Substances Directive.

 Represents compliance of the Somatix Smartband with the Waste Electrical and Electronic Equipment Directive.

IP67 Represents the Ingress Protection Marking class

REGULATORY AND SAFETY INFORMATION

FCC Part 15.105 Statement

This equipment has been tested and found to comply with the limits for a Class B digital device, pursuant to part 15 of the FCC Rules. These limits are designed to provide reasonable protection against harmful interference in a residential installation. This equipment generates, uses and can radiate radio frequency energy and, if not installed and used in accordance with the instructions, may cause harmful interference to radio communications. However, there is no guarantee that interference will not occur in a particular installation. If this equipment does cause harmful interference to radio or television reception,

which can be determined by turning the equipment off and on, the user is encouraged to try to correct the interference by one or more of the following measures:

- Reorient or relocate the receiving antenna
- Increase the separation between the equipment and receiver
- Connect the equipment into an outlet on a circuit different from that to which the receiver is connected.
- Consult the dealer or an experienced radio/TV technician for help.

FCC Part 15.21 Statement

Changes or modifications not approved by Somatix Inc. could void the user's authority to operate the equipment.

FCC Part 15.19 Statement

This device complies with Part 15 of the FCC Rules.

Operation is subject to the following two conditions: (1) This device may not cause harmful interference, and (2) this device must accept any interference received, including interference that may cause undesired operation.

This device meets the FCC requirements for RF exposure in public or uncontrolled environments.

SPECIFICATIONS

Operating temperature: -20°C to 55°C (-4F to 131F)

Battery: Rechargeable, 3.7V, 70mAh lithium-polymer battery

Power adapter output: 5Vdc, up to 2A output, micro USB
SAFETY NOTE: This equipment complies with the following requirement(s) of the Low Voltage Directive: IEC/EN/UL 60950-1 with rated voltage of 5Vdc and rated current of 2A max

SAFETY NOTE- : This equipment complies with the following requirement(s) of the Low Voltage Directive: IEC/EN/UL 60950-1 with rated voltage of 5Vdc and rated current of 2A max

Wireless technology: Bluetooth 4.2 radio transceiver

Dimensions and Weights: Electronic module: 37 x 18 x 11 mm, weight 8 gram
Band: fits a wrist between 180 to 220 mm, weight 16 gram

AVIS DE SÉCURITÉ :

Cet équipement est conforme aux exigences suivantes de la Directive Basse Tension : IEC/EN/UL 60950-1 avec une tension nominale de 5 V c.c. et un courant nominal de 2 A max.



SOMATIX SMARTBAND User Guide

For use with SafeBeing™

