

miroir

HDMI™
HIGH DEFINITION MULTIMEDIA INTERFACE

 **Bluetooth**®

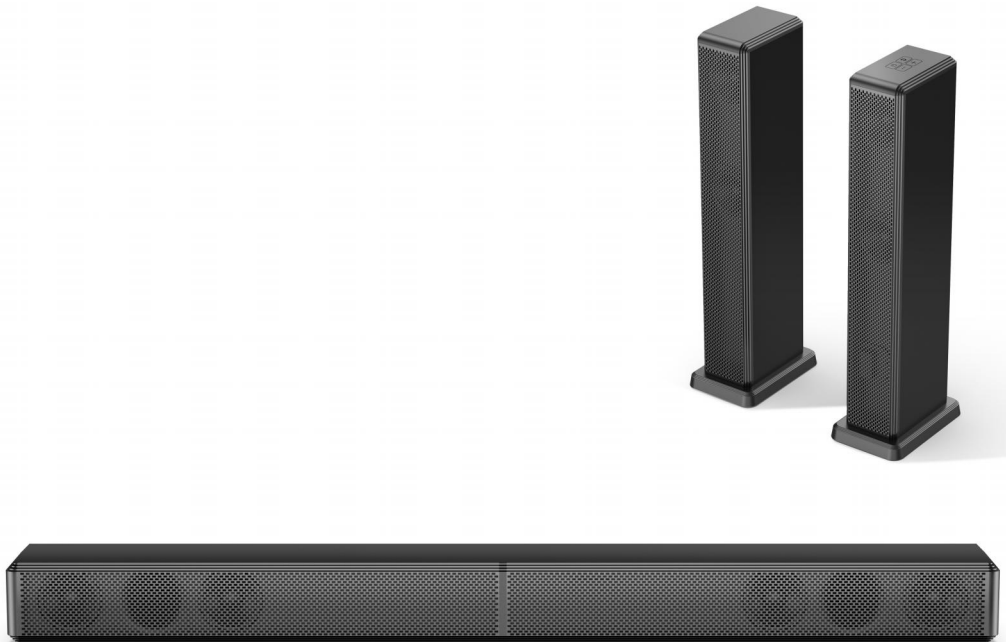

User Manual

SL3301

2.0 Channel Bluetooth Soundbar

Contents

1 ACCESSORIES LIST	01
2 SOUNDBAR CONTROLS	01
3 SOUNDBAR INSTALLATION	02
4 REAR PANEL	03
5 CONNECT TO TV VIA HDMI OUT ARC	03
6 CONNECT TO TV VIA OPTICAL / AUX	03
7 CONNECT TO BLUETOOTH®	04
8 PLACEMENT OPTIONS	04
9 WALL MOUNT INSTALLATION	05
10 SPECIFICATIONS	05

miroir SL3301

User Manual

WE ARE
READY
TO HELP



1 ACCESSORIES LIST

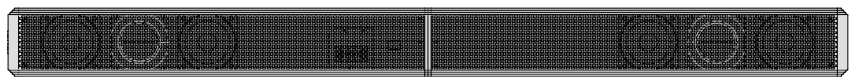

Soundbar



Power Adaptor

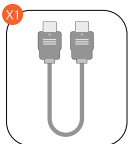

HDMI ARC

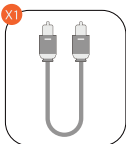

Digital Optical Cable

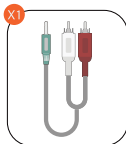

Stereo 3.5mm to RCA
Audio Cable

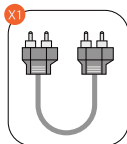

Stereo RCA to RCA
Audio Cable(100mm)

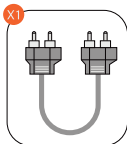

Stereo RCA to RCA
Audio Cable(2.5m)

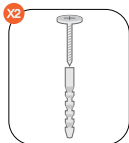

Wall Mounting Kit

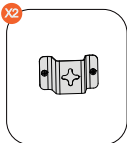

Wall Bracket

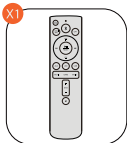

Remote Control

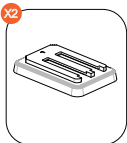

Base



User Manual

2 SOUNDBAR CONTROLS

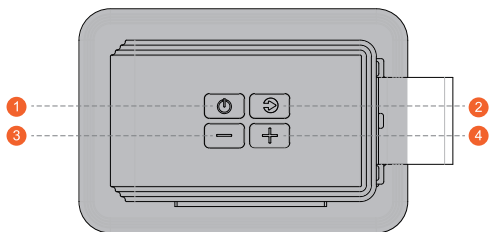

Control Panel

- 1 “⏻”: **Power Button**
Press to power on / Hold for 3 seconds to power off.
- 2 “🔊”: **Input Mode**
Press to switch channels: ARC-OPT(OPTICAL)-BT-AUX-USB.
Hold for 3 seconds to disconnect the current device and
connect to a new device manually on your mobile phone /
PC / TV (BT ID: SL3301)
- 3 “⏮”: **Volume Down**
- 4 “⏭”: **Volume Up**

Remote Control

- 1 “⏻”: **Power Button**
Click to turn on or off.
- 2 “HDMI ARC”: **ARC**
Press to switch to HDMI ARC channel.
- 3 “📶”: **BT**
Press to switch to Bluetooth channel and enter pairing mode.
Hold for 3 seconds to disconnect the current device and connect to a new device manually on your mobile phone / PC/TV (BT ID: SL3301).
- 4 “OPT”: **OPT**
Press to switch to OPTICAL channel.
- 5 “AUX”: **AUX**
Press to switch to AUX channel.
- 6 “USB”: **USB**
Press to switch to USB channel.
- 7 “LED”: **LED**
Press to turn on the LED. Press again to turn off.
- 8 “VOL +”: **Volume Up**
- 9 “VOL -”: **Volume Down**
- 10 “⏮”: **Previous**
For BT and USB mode only: Skip to previous track.
- 11 “⏭”: **Next**
For BT and USB mode only: Skip to next track.
- 12 “▶⏸”: **Play / Pause**
For BT and USB mode only.
USB mode: Hold for 3 seconds to switch between single loop playback and list loop playback.
- 13 “MOVIE”: **MOVIE**
Press to switch to MOVIE mode.
- 14 “GAME ”: **GAME**
Press to switch to GAME mode.
- 15 “MUSIC ”: **MUSIC**
Press to switch to MUSIC mode.
- 16 “BASS ”: **BASS™**
Press to adjust bass level.
- 17 “🔊”: **Mute / Recover the volume.**

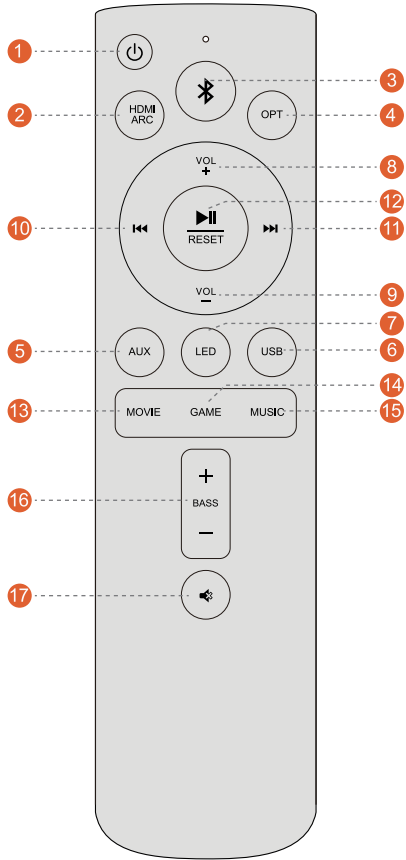

3 SOUNDBAR INSTALLATION

Assembly steps:

- 1 Align the joints of the two parts.

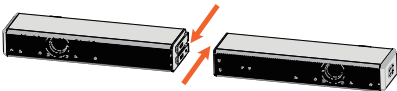

- 2 Plug in the Stereo RCA to RCA Audio Cable.



Detached and stand on base:

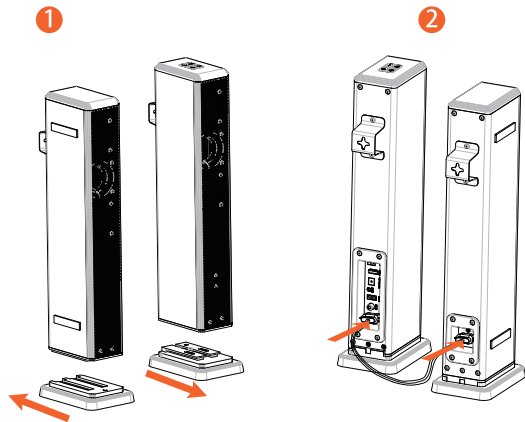

- 1 Set the soundbar on the base and align the joints.
- 2 Plug in the Stereo RCA to RCA Audio Cable.

4 REAR PANEL

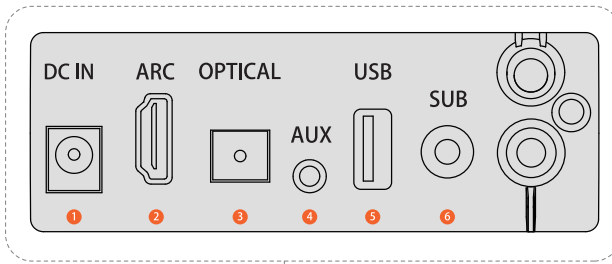

- ① DC IN
- ② HDMI ARC OUT
- ③ OPTICAL IN
- ④ AUX IN
- ⑤ USB Port:
Support MP3 files with 64GB max memory.
- ⑥ SUB OUT:
Connect to active subwoofer (Not Included)

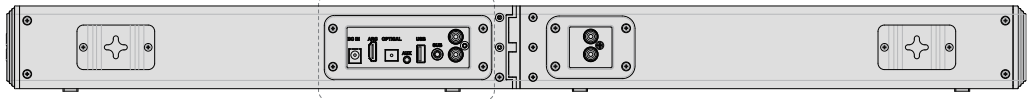

5 CONNECT TO TV VIA HDMI OUT ARC

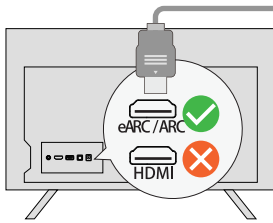

Step 1:
Connect one end of the HDMI cable to the eARC / ARC port on the back of your TV.

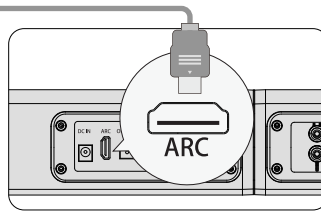

Step 2:
Then connect the other end into the ARC port of the soundbar.

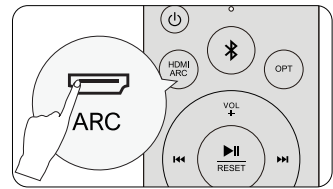

Step 3:
Press "ARC" button on the remote control to select "ARC" input.

If there is no sound, try setting the TV audio output to PCM:
TV Settings > Home > Settings > Sound > Digital Audio Output > PCM

Note: Please turn on the "CEC" function on your TV.

When eARC / ARC is connected, your TV remote control can control the soundbar and TV simultaneously:

- ① Turn on / off
- ② Adjust the volume

6 CONNECT TO TV VIA OPTICAL / AUX

OPTICAL

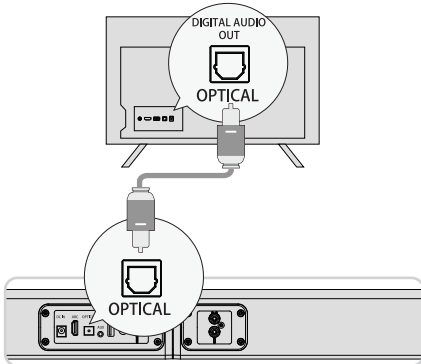

OPTION 1: OPTICAL

- ① Make sure the TV's port is OPTICAL OUT, connect both sides of the cable to OPTICAL, for both the TV and the soundbar.
- ② Make sure the optical plug is inserted correctly as it shows in the picture. Do not insert the plug upside down and break the optical.

Note: If audio is coming from the internal TV speakers, mute or minimize the TV volume.

AUX

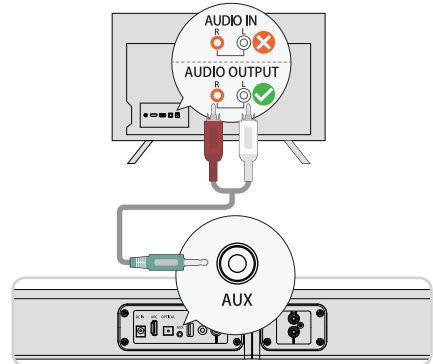

OPTION 2: AUX

- ① Connect the 3.5mm to RCA audio cable to connect to your TV's RCA AUDIO OUT port.
- ② Make sure the color of the cables ends matches the color of the TV ports.

Note: Please remember to unplug the AUX cable from TV and Soundbar when you want to switch other mode.

In Optical Mode: If there is no sound, try setting the TV audio output to PCM: TV Settings > Home > Settings > Sound > Digital Audio Output > PCM

7 CONNECT TO BLUETOOTH®

- 1 Press the “⌂” button on the soundbar or press the “BT” button on the remote control to enter Bluetooth pairing mode.
- 2 Go to the Bluetooth setting on your phone, find and select “SL3301” to connect the soundbar.

Note: If it's already in the Bluetooth mode and connected, press and hold “BT” button for 3 seconds to disconnect current device and choose to connect to a new device manually on your mobile phone / PC / TV.

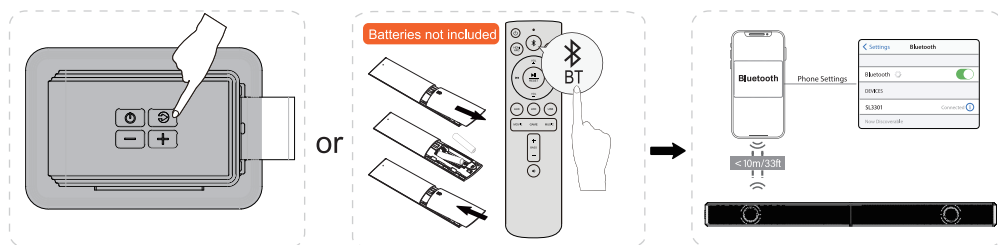

8 PLACEMENT OPTIONS

Detached and stand on base

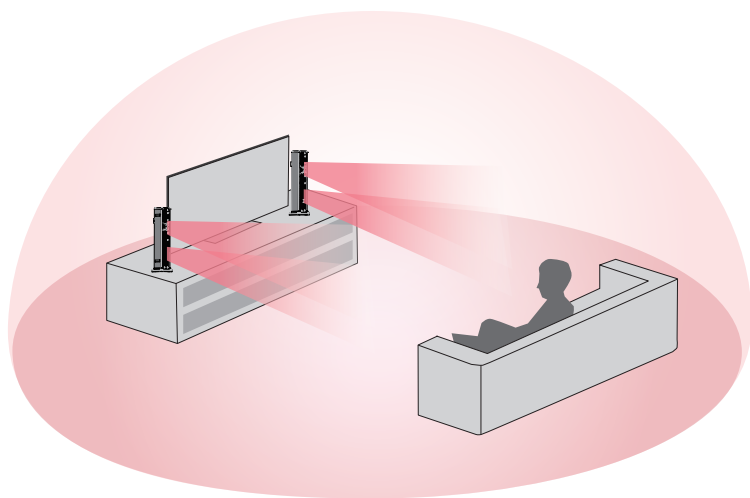

Horizontal placement

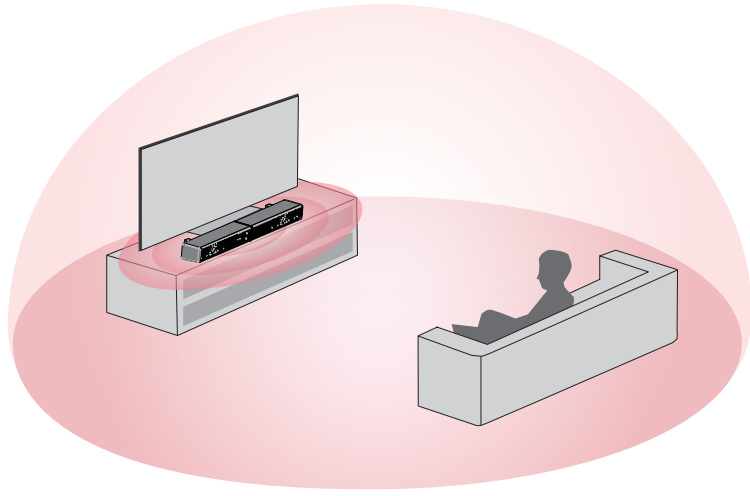

Note: The soundbar should be placed at or near ear level.

9 WALL MOUNT INSTALLATION

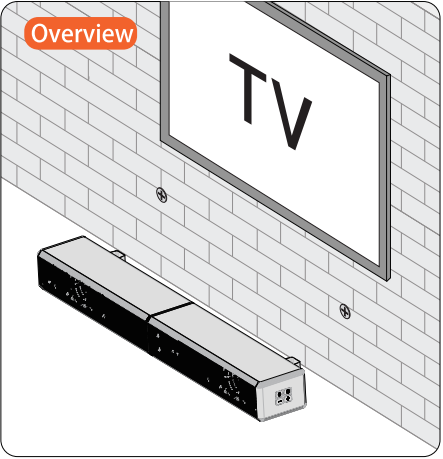
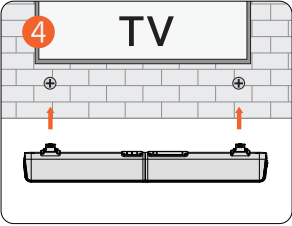
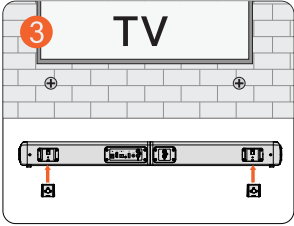
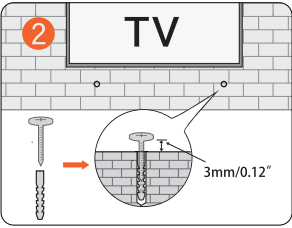
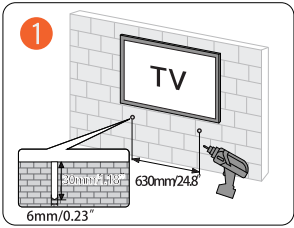

10 SPECIFICATIONS

Model Number	SL3301
Power Supply	AC 100 - 240V, ~50 / 60Hz
Soundbar Drivers	2.25" x 4(Soundbar)
Frequency Response	45Hz - 20kHz
Standby Power	<0.5W
Operating Temperature	0° C - 45° C / 32° F - 113° F
Bluetooth Vision	5.3

Dimensions and Weight	
Soundbar	800(W) × 137(D) × 67(H)
Packaging	367(W) × 278(D) × 476(H)
Net Weight	/
Gross Weight	/

Trade Marks:



The Bluetooth® word mark and logos are registered trademarks owned by Bluetooth SIG, Inc. and any use of such marks by Soundlab Technology Co.,Ltd, is under license, Other trademarks and trade names are those of their respective owners.



The Adopted Trademarks HDMI, HDMI High-Definition Multimedia Interface, HDMI trade dress and the HDMI Logos are trademarks or registered trademarks of HDMI Licensing Administrator, Inc, in the United States and other.

FCC

This equipment has been tested and found to comply with the limits for a Class B digital device, pursuant to Part 15 of the FCC Rules. These limits are designed to provide reasonable protection against harmful interference in a residential installation. This equipment generates uses and can radiate radio frequency energy and, if not installed and used in accordance with the instructions, may cause harmful interference to radio communications. However, there is no guarantee that interference will not occur in a particular installation. If this equipment does cause harmful interference to radio or television reception, which can be determined by turning the equipment off and on, the user is encouraged to try to correct the interference by one or more of the following measures:-- Reorient or relocate the receiving antenna.

- Increase the separation between the equipment and receiver.
- Connect the equipment into an outlet on a circuit different from that to which the receiver is connected.
- Consult the dealer or an experienced radio/TV technician for help.

This device complies with part 15 of the FCC Rules. Operation is subject to the following two conditions:

(1) This device may not cause harmful interference, and (2) this device must accept any interference received, including interference that may cause undesired operation.

Changes or modifications not expressly approved by the party responsible for compliance could void the user's authority to operate the equipment

***RF warning for Mobile device:**

This equipment complies with FCC radiation exposure limits set forth for an uncontrolled environment. This equipment should be installed and operated with minimum distance 20cm between the radiator & your body.

FCC ID : 2ATKO-SL3301