



Single Side BT Controller Introduction PG-9120

EN/ PT/ RU/ AR/ ZH_CN

EN

Application:

- 1.Thanks very much for purchasing ipega brand PG-9120 BT controller.
- 2.Application device: Android and iOS Smartphone/ tablet.
- 3.Extendable size fit for 140-220mm smart phone and tablet,height of slot space is 10mm.

- ★ Due to mobile system issues, some mobile may not support this device(e.g.:mobile under MTK platform do not support)
- ★ Due to the official game platform software upgrades or source code changes and other not resist factors caused some of the game can not be played or connected with our Gamepad, iPega company has no responsibility.iPega reserve the right of final interpretation for this.

Introduction for Key Function

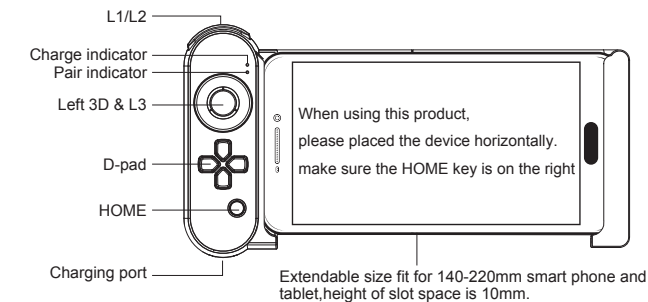

For Android Devices

1. Scan QR code on the right through mobile, download and install Octopus platform

2. Turn on the device by pressing both D-pad Right key and HOME key for 3-5 seconds until blue light flashing, open the BT setting on mobile and search name of "PG-9120" and pair, blue light will be on after connected.

- 3.Open the game platform, add installed mobile games to the platform, open the games from the platform, then you can start your game experience.

Scan the QR code to download Octopus



<http://www.phoenixos.com/octopus/intro>

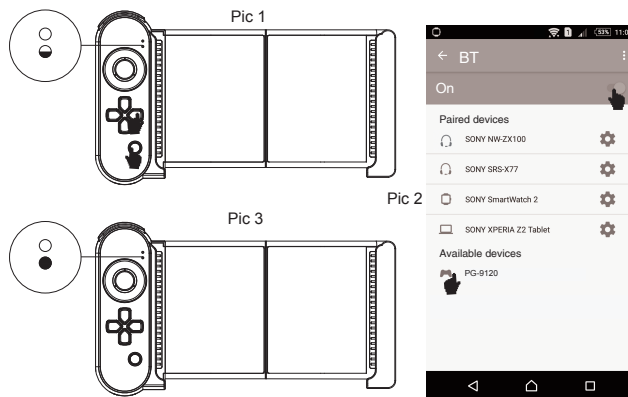

For IOS Devices (Direct Play Mode)

- 1.Enter the pairing mode by pressing both D-pad Left key and HOME key for 3 seconds until blue light flashing, open the mobile BT setting and search nane of "PG-9120" and pair, blue light will be on after connected.
2. Re-connection: Long press Home key for 3-5 second will auto re-connected, if failed to connection, the device will turn off and enter sleep mode in 10 minutes;
- 3.If need to reset the mapped buttons, please download APP; Search "Shooting Plus" on APP store, download and install the APP.
- 4.E-Introduction: Search "www.ipega.hk" and find detailed operation introduction.
- 5.Support IOS system 11.0 or above



ShootingPlus V3

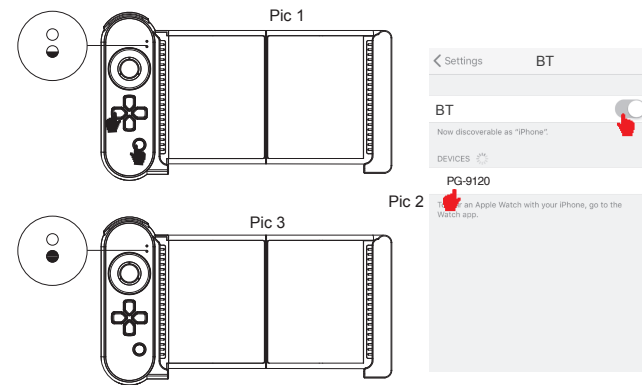

Charging/Sleep/Awaken Function:

1. When the controller is off and plug in adapter, the orange light flashes slowly means the gamepad is charging, the light will be off after fully charged,
2. While the controller is under connection status, it will automatic turn off if without any operation in 10 minutes.
3. Turn off the device and press HOME keys for 5 seconds to enter re-connection.
4. The blue light will flash if low battery.

Electrical Specification :

- | | |
|---------------------------------------|---|
| 1.Working Voltage: DC3.7V | 5.Charging Voltage/Current: DC5V/500mA (USB Type-C charging port) |
| 2.Working Current: <10 mA | 6.BT 4.0, transmission distance: ≤8M |
| 3.Support continues playing up to 20H | 7.Battery capacity: 380mAh |
| 4.Sleep Current: <10uA | 8.Standby Time: 30 days after fully charged |

Accessories List:

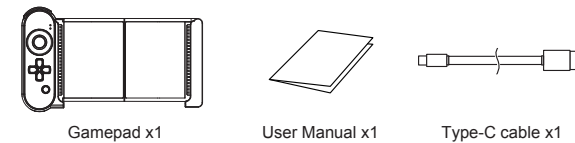

Warning: Changes or modifications to this unit not expressly approved by the party responsible for compliance could void the user's authority to operate the equipment.

NOTE:

This equipment has been tested and found to comply with the limits for a Class B digital device, pursuant to Part 15 of the FCC Rules. These limits are designed to provide reasonable protection against harmful interference in a residential installation. This equipment generates, uses and can radiate radio frequency energy and, if not installed and used in accordance with the instructions, may cause harmful interference to radio communications.

However, there is no guarantee that interference will not occur in a particular installation. If this equipment does cause harmful interference to radio or television reception, which can be determined by turning the equipment off and on, the user is encouraged to try to correct the interference by one or more of the following measures:

- o Reorient or relocate the receiving antenna.
- o Increase the separation between the equipment and receiver.
- o Connect the equipment into an outlet on a circuit different from that to which the receiver is connected.
- o Consult the dealer or an experienced radio/TV technician for help.

This device complies with Part 15 of the FCC Rules. Operation is subject to the following two conditions:
(1) this device may not cause harmful interference, and
(2) this device must accept any interference received, including interference that may cause undesired operation.

iPega trademarks belongs to PEGA LIMITED.