

# INSTALLATION INSTRUCTIONS

Model: 8030 WIFI Contril Series



**WARNING: TO AVOID RISK OF ELECTRICAL SHOCK, BE SURE TO TURN POWER OFF AT CIRCUIT BREAKER OR FUSE.**

## NOTES:

- Some codes request to install by a qualified electrician.
- To avoid hazard, read this instruction carefully before installation and save this instruction.

## 1 . Important Safety Instructions:

- 1). Do not touch or install the light fixture while in contact with standing water.
- 2). Do not remove the LED cover.
- 3). Do not look at the LED directly.
- 4). Do not expose bare wires outside the exterior awning shell.
- 5). Electrical requirements: 120V, 60Hz
- 6). Maximum Wattage: 20W
- 7). Working Temperature Range: -22°F ~ 113°F
- 8). Suitable for wall or eaves mounting on recessed or round surface mounted junction box, rated for wet location. This product is not suitable for floor-standing electrical boxes.
- 9). Do not let the sensor head touch the LED head housing. Keep at least 1" spacing between LED heads and sensor head.
- 10). For proper operation and to prevent water damage, the mounting base connect to the wall need to be sealed.

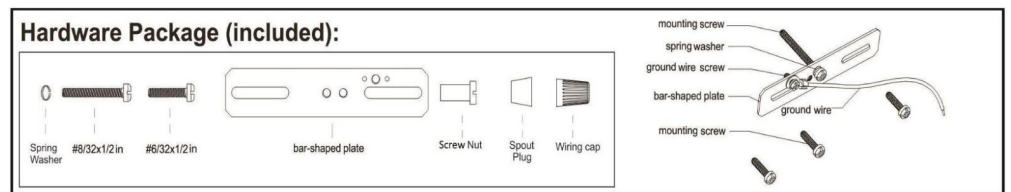

Please confirm all components are included in the box after you received it.

## 2 . Should Be Known before Installation:

- 1) . For the best performance, install fixture at least 8ft above the ground. At such a height the fixture will provide a detection distance of up to 26 feet at 77 degrees Fahrenheit.

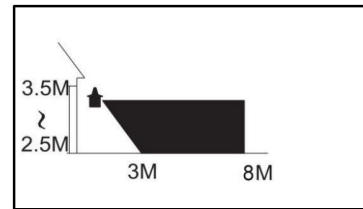

- 2) . The sensor detects movement across a detection range of 180 degrees.

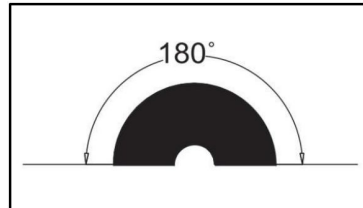

- 3) . The sensor will be more sensitive to motion across its detection path than motion directly towards it.

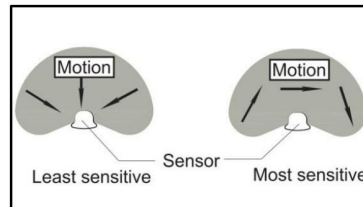

## 3 . Installation Step:

- 1) . Turn off power to the work area at the circuit breaker main or fuse box. Note: do not rely on the wall switch turns off the power.

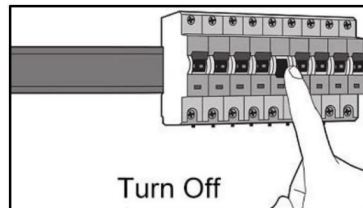

- 2) . The Yellow&Green- Earth Wire (Ground Wire) is fixed to the aluminum bar-shaped plate. Fix the aluminum bar-shaped plate to the outlet box.

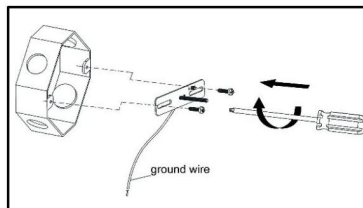

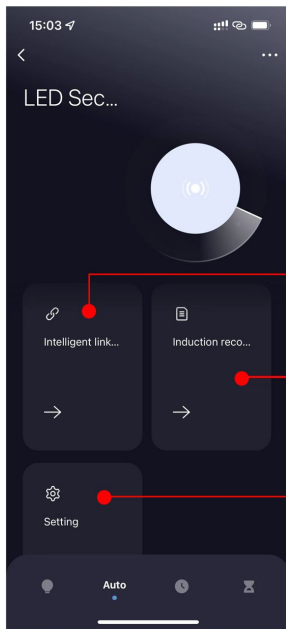

Intelligent Devices Link

Induction Record

Lumination Detected Adjustable

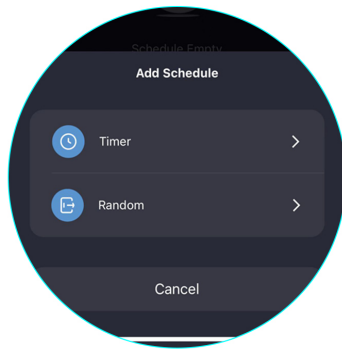
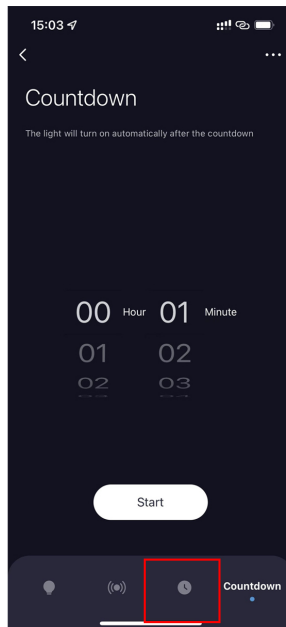

Schedule Your Time



- 3) . Fix the gasket to the outlet box. Pull out the source wires from the outlet box. Make wire connections using wire nuts as follows:
  - Black - Live Wire (Hot Wire)
  - White - Neutral Wire (Naughty Wire)
  - Green&Yellow - Ground Wire

Carefully tuck the wires back into the outlet box.

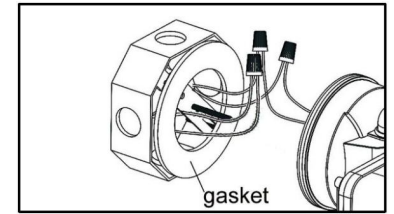

- 4) . Attach the light fixture to the aluminum bar-shaped mounting plate, and use the screw nut to fix the light fixture to aluminum bar-shaped plate.

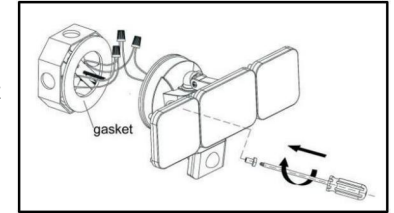

- 5) . Push the rubber decorative cover firmly into the fixture screw nut hole on the middle of light.

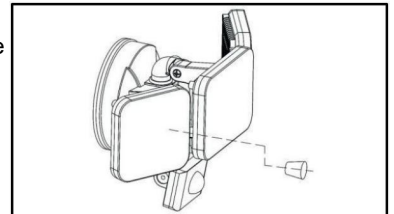

- 6) . Turn on the power at fuse or circuit box.

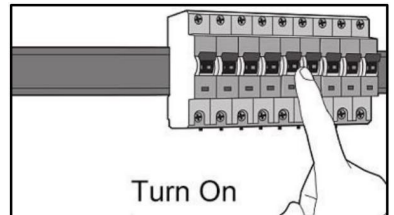

- 7) . After the security light passed the installation test, use silicone caulking compound caulk completely around where the back plate meets the wall surface.

**CAUTION:** Be sure to caulk completely where the back plate meets the wall surface to prevent water from seeping into the outlet box.

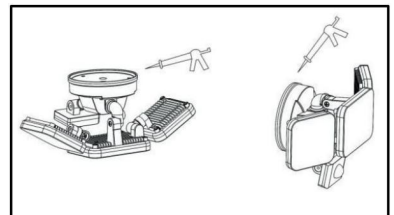

#### 4 . Adjusting the Sensor Head:

- 1) . Aim sensor head toward desired detection area  
Maintaining a 5°- 40°downward angle to allow moisture to drain.
- 2) . You can move the sensor head up and down to change the coverage area.

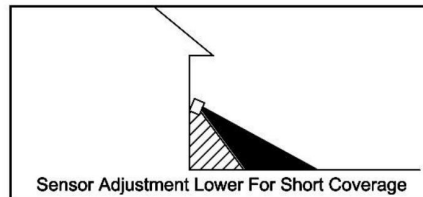
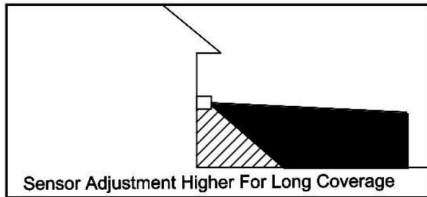
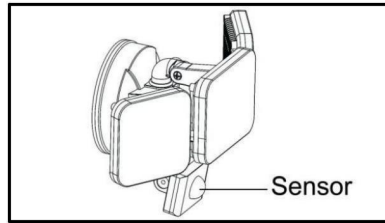

#### 5 . Trouble Shooting

---The light does not come on at all :

- Make sure the wall switch and circuit breaker are on.
- Make sure the wiring is correct.
- Cover the sensor with dark color cloth to verify that the ambient light level is not too high

---The light comes on for no apparent reason :

- Re-aim the motion sensor
- Decrease the sensitivity setting.
- Do not use a dimmer or timer to control the light fixture. Replace the dimmer or timer with a standard

on/off wall switch.

---The light flashes on and off :

- Reposition the motion sensor

#### Set-up

Custom settings according to your need.

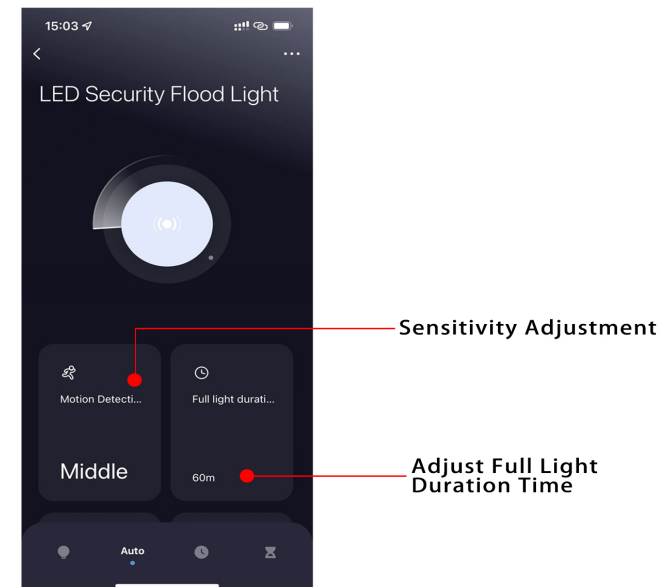
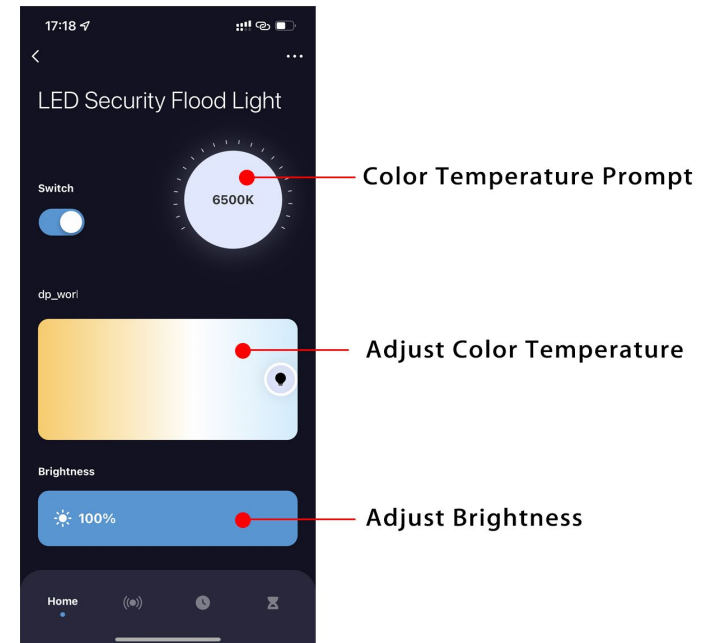

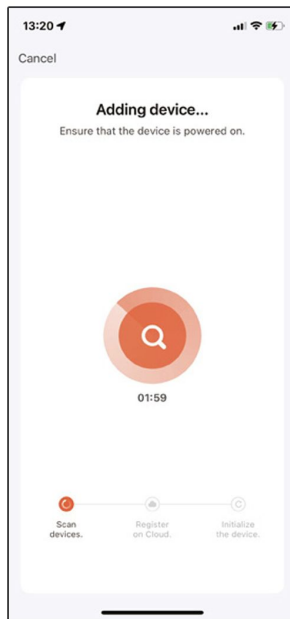

⑨ Adding device

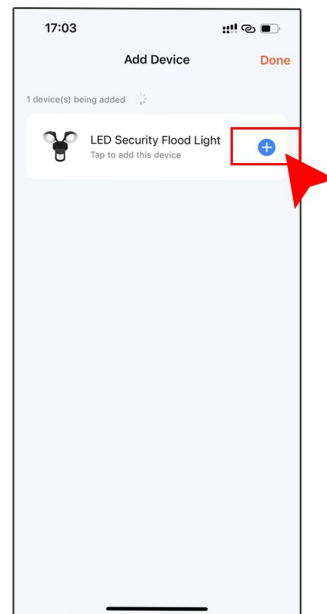

⑩ Download the light

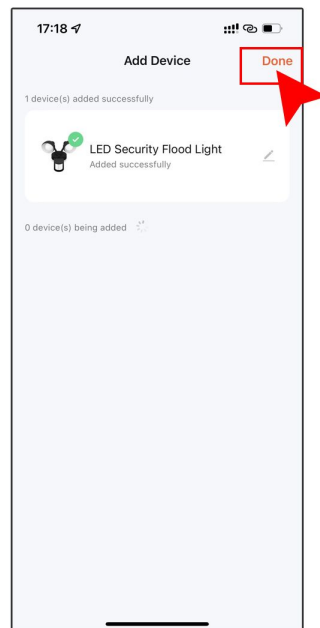

⑪ Connect the light

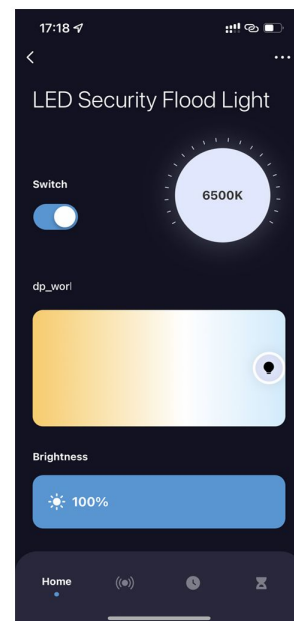

⑫ Ready for use

# LED Security Flood Light User Manual



Option 1: Download The Smart Life APP



Option 2: Download The Tu Ya Smart APP

## Sign up & log in

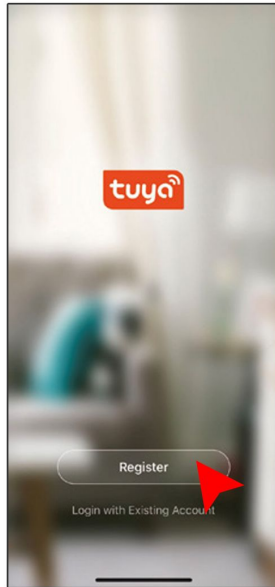

① Register

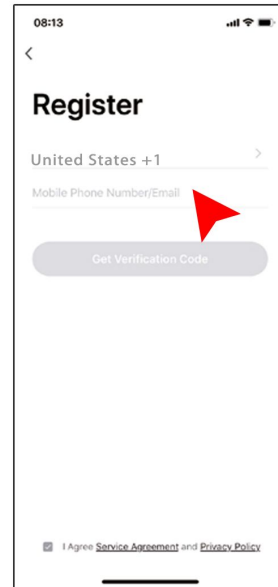

② Get Verification Code

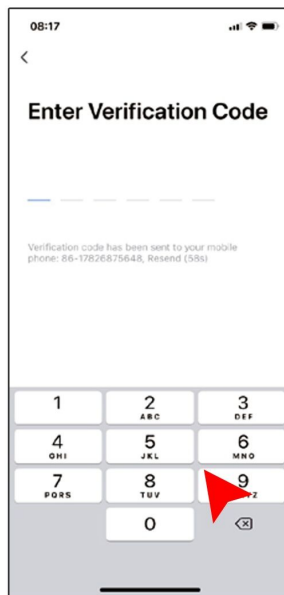

③ Enter Verification Code

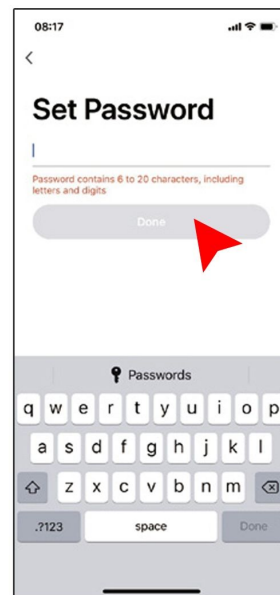

④ Set Password

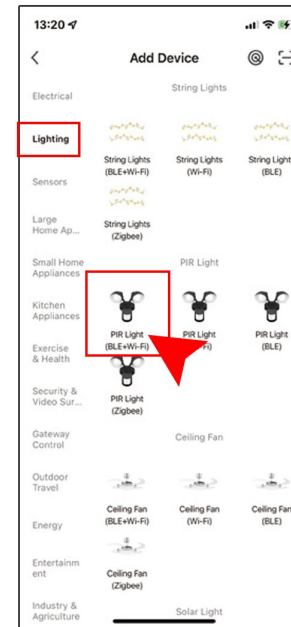

⑤ Confirm selection

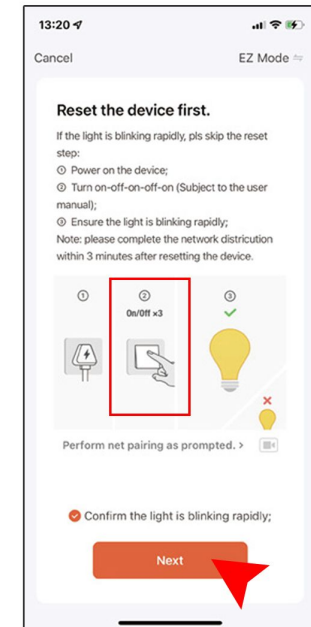

⑥ Ready for use

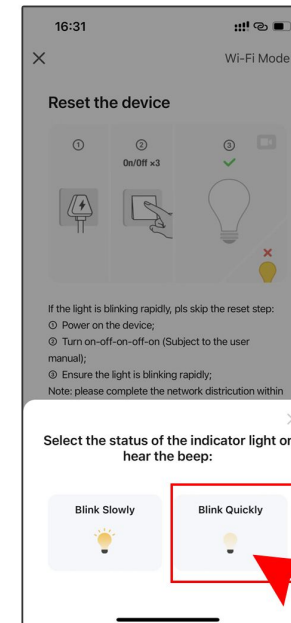

⑦ Select blink quickly

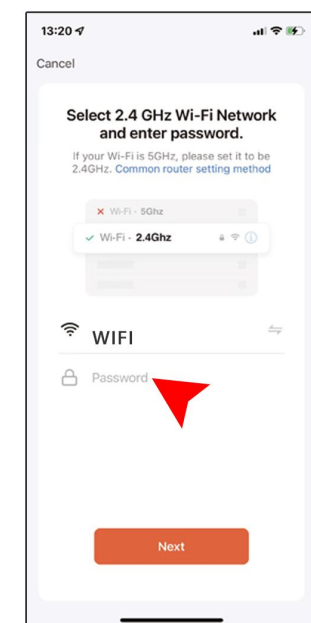

⑧ Connect the WIFI

This device complies with part 15 of the FCC Rules. Operation is subject to the following two conditions: (1) This device may not cause harmful interference, and (2) this device must accept any interference received, including interference that may cause undesired operation.

Any Changes or modifications not expressly approved by the party responsible for compliance could void the user's authority to operate the equipment.

**Note:** This equipment has been tested and found to comply with the limits for a Class B digital device, pursuant to part 15 of the FCC Rules. These limits are designed to provide reasonable protection against harmful interference in a residential installation. This equipment generates uses and can radiate radio frequency energy and, if not installed and used in accordance with the instructions, may cause harmful interference to radio communications. However, there is no guarantee that interference will not occur in a particular installation. If this equipment does cause harmful interference to radio or television reception, which can be determined by turning the equipment off and on, the user is encouraged to try to correct the interference by one or more of the following measures:

- Reorient or relocate the receiving antenna.
- Increase the separation between the equipment and receiver.
- Connect the equipment into an outlet on a circuit different from that to which the receiver is connected.
- Consult the dealer or an experienced radio/TV technician for help.
- This equipment complies with FCC radiation exposure limits set forth for an uncontrolled environment. This equipment should be installed and operated with minimum distance 20cm between the radiator & your body.