

W-02

## TWS Wireless Bluetooth Earphone FUNCTIONAL INSTRUCTIONS

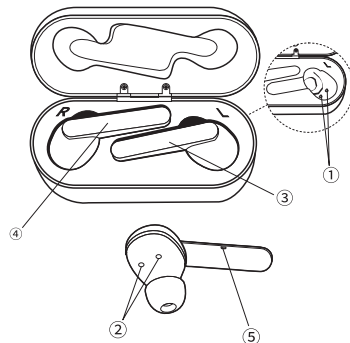

### Description of Function Port

- ①② Thimble charging with charging compartment
- ③④ Pause, play, pick up/hang up, reject calls
- ③ Call out Siri (Left side)
- ④ Next song (Right side)
- ⑤ Microphone hole, indicator light

**Thank you for purchasing and using the Wireless earphones. For correct and safe use of earphones, please read the instructions carefully before use and save it.**

### I. Product Features

1. Wireless version 5.0 + EDR
2. Support Wireless protocol HFPV1.7, HSP V1.2 A2DPV1.3, AVRCPV1.6 SSP V1.2
3. Support audio format: SBC ACC
4. Support Wireless calls, Wireless music
5. Built-in lithium-ion battery, charging by charging compartment.
6. Intelligent power saving (Automatic shutdown when 3-minute pairing timeout.)

### II. Product Parameters

1. Barrier-free transmission distance: 10M
2. Earphones battery capacity: 40MAH  
Charging compartment battery capacity: 400MAH
3. Frequency range: 20-20KHZ
4. Sensitivity: 100±3DB
5. Impedance: 16 Ω
6. Loudspeaker size: 6MM
7. Earphones charging time: 1H
8. Charging compartment charging time: 1-2H
9. Output power: 4MW
10. Voice continuous talk time: 4-5H (appropriate volume)
11. Wireless music playback time: 4-5H (appropriate volume)

### III. Product Operation Instructions

#### 1.1 Wireless Function:

##### 1.1.1 Wireless Pairing Use:

##### 1. Startup & Shutdown

Automatically startup: when take out from the charging compartment, it will be automatically startup. Manual startup: Touch 2 seconds to startup, until the blue light on to release your hand.

Automatically shutdown: The earphones automatically shutdown after it is placed in the charging compartment. Manual shutdown: Touch 5 seconds, until the red light on to release your hand. After the earphone has been successfully connected, when manual shutdown any one of them then the other one is also shutdown. When use two sides of earphones to listen to the songs, if the main earphone is placed in the charging compartment, and the secondary earphone is disconnected. If the secondary earphone is placed in the charging compartment and the main earphone is used normally.

2. Main earphone (L) Wireless identification name: M8 L  
Secondary earphone (R) Wireless identification name: M8 R

3. Stereophonic Earphones Use: When the first time that pair of earphones is taken out from the charging compartment, it will automatically startup, the main earphone and the secondary earphone are automatically connected, and the main earphone appears alternately and slowly flash in red and blue lights. When the secondary earphone light is off, the mobile phone will appear the Wireless identification name: YqMg L. The indicator does not light after the pairing is successful, and the Wireless icon on the device has a

connection symbol and battery level. The displaying varies slightly depending on the device.

Single earphone use: long press for 5 seconds to startup until the indicator light red and blue alternately flashes slowly, the phone turns on the Wireless to pair by search device name.

##### 1.1.2 Wireless Plays Music and Calls:

1. **Play pause:** touch any earphone one time and you will hear a "beep"; **Next song:** Touch the secondary earphone (right ear) for 1 second and you will hear a "dang" and release your hand; **Call out siri:** Touch the main earphone (left ear) for 1 second and you will hear a "dang" and release your hand; **Calls:** Under the calling state, it will be hung up by touch any one of earphones one time, and when there is a call, it will be picked up the call by touch any one of earphones one time. Any call is touched any one of earphones for 1 second to reject it.

##### 1.1.3 Charging Function

1. The earphones are placed in the charging compartment and begin to charge. When the charging compartment capacity is less than 25%, the first green light flashes, and the remaining lights are not bright. When more than 25% is less than 50%, the second green light flashes, and the first green light is on. When more than 50% less than 75%, the third green light flashes, and the first and second green lights are on. The fourth light flashes when it is greater than or equal to 75%, and other lights are on. When power is full then the lights are all on. Press the charging compartment button to check the power, and double-press continuously to turn off the charging indicator.

2. Voice reminder will appear when in low voltage.

3. Restore the factory settings: long press for 5 seconds to startup until the red and blue lights alternately flash and report the Pairing, then continuous touch 4 times until the red light on, then automatically shutdown.

##### 1.1.4 Troubleshooting

1. Two earphones cannot be automatically paired.

If the pairing record has been cleared due to man-made caused, under this case, the left and right earphones should be shutdown and pressed for 5 seconds to startup until the red and blue lights alternately flash and the pairing is reported, then touch 4 times continuous until the red light is on and automatically shutdown. When startup again, the left and right earphones will be automatically paired.

2. The function cannot be operated

If the earphones do not operate normally or without any functions, please put the earphones into the charging compartment and reset them automatically.

3. Noise

Please check if there is any interference from WIFI or other electric appliance signals around the area and change to another environmental to do a test.

4. Distance is not good

Please check if there is any interference from WIFI or other electric appliance signals around the area and change to another environmental to do a test.

## **FCC Statement**

This device complies with Part 15 of the FCC Rules. Operation is subject to the following two conditions:

(1) This device may not cause harmful interference.

(2) This device must accept any interference received, including interference that may cause undesired operation.

2. Changes or modifications not expressly approved by the party responsible for compliance could void the user's authority to operate the equipment.

Note: This equipment has been tested and found to comply with the limits for a class B digital device, pursuant to Part 15 of the FCC Rules. These limits are designed to provide reasonable protection against harmful interference in a residential installation.

This equipment generates uses and can radiate radio frequency energy and, if not installed and used in accordance with the instructions, may cause harmful interference to radio communications. However, there is no guarantee that interference will not occur in a particular installation. If this equipment does cause harmful interference to radio or television reception, which can be determined by turning the equipment off and on, the user is encouraged to try to correct the interference by one or more of the following measures:

- Reorient or relocate the receiving antenna.
- Increase the separation between the equipment and receiver.
- Connect the equipment into an outlet on a circuit different from that to which the receiver is connected.
- Consult the dealer or an experienced radio/TV technician for help.

The device has been evaluated to meet general RF exposure requirement. The device can be used in portable exposure condition without restriction.