

Label printer manual

table of Contents

Foreword.....	1
Chapter 1 Precautions before use	1
First, the use of precautions	2
Second, the use of power adapter considerations	2
Chapter II Product Operation Process.....	2
First, the product display	2
Second, the operation method	4
Chapter III App Operation Method.....	7
I.app download	8
2. App link.....	8
Three. app instructions.....	8
Chapter IV Application of the Product	8
Chapter V Warranty Card / Certificate.....	8
First, the principle of warranty service	8
Second, the scope and duration of the warranty	9
Third, the following conditions are not covered by the warranty	9

Foreword

Thank you for buying Seabird Sticker Printer

Before using this product, please read the manual carefully and use it correctly.

After detailed reading, please keep the manual properly.

Before using this product, please read the product manual carefully and use it correctly.

After reading it in detail, please keep the manual in a safe place.

Chapter 1 Precautions before use

First, the use of precautions

1. Do not use volatile solvents such as thinner, volatile oil or alcohol when cleaning or maintaining this product.
2. Do not put items in the label outlet or block the outlet.
3. Please use the coupons for this product.
4. Do not pull out or insert the label tape
5. Due to factors such as the location of the label or the material of the article, environmental conditions, etc., sometimes the label may be discolored, peeled off, or there may be residual glue, label color residue, tearing, and pasting position damage. Please confirm the material of the place or object to be affixed, the purpose of use, and test it before use in an inconspicuous part.
6. Do not use the used label tape or print without the label tape installed to avoid print head failure.
7. Do not use a cutting knife when printing. Cutting the label will cause the label to get caught inside the machine.
8. Please check before printing, the paper cutter does not block the paper path, otherwise it will cause the label to get inside the machine.
9. When loading the label paper, make sure that the label paper is not tilted, otherwise the printed content will be tilted or missed.
7. If this product is malfunctioning. If the repair or power is insufficient, the last edited information may disappear. Please be careful.

Second , the use of power adapter considerations

This product's built-in lithium battery supports usb (type-c) interface dc-5v input

Do not use damaged or worn power, as this may result in electric shock or fire.

Do not touch the power adapter, power plug, and power output with wet hands to prevent the risk of electric shock.

Do not bend excessively, pull the power cord hard, and do not place heavy objects on the power cord. Otherwise, the power cord may be damaged and fire or electric shock may occur.

Keep the power adapter out of the reach of children to avoid danger

Before servicing and maintaining the printer, be sure to disconnect the power supply to avoid danger.

If consumers use power adapters for power supply, they should purchase power adapters that meet the corresponding safety standards or are CCC certified power adapters.

Battery Note:

1. It is forbidden to disassemble, impact, squeeze the battery or put into the fire;
2. If there is severe swelling, do not continue to use it;
3. Do not put it in a high temperature environment. Do not use the battery after it has entered the water;
4. There is a danger of explosion when replacing the battery with the wrong type. Always dispose of the used battery as instructed.

Chapter II : Product Operation Process (Product Technical Manual)

First, the product display

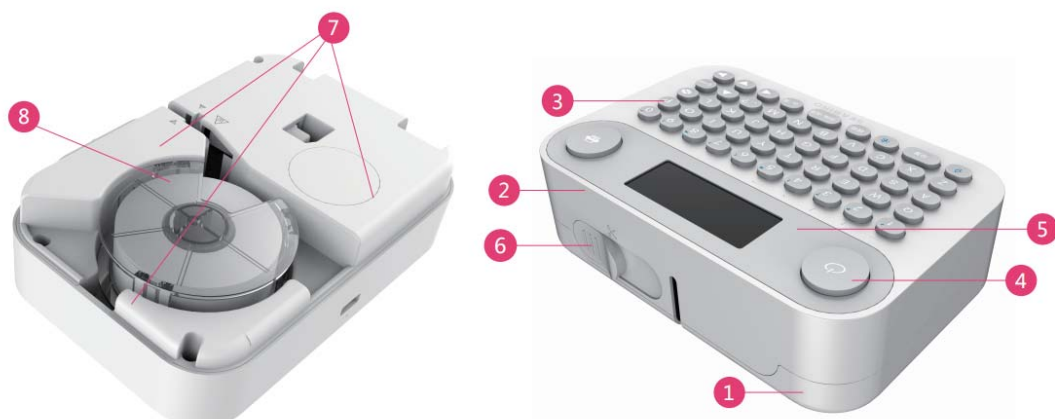

1. Lower case
2. Upper case
3. Keyboard button
4. Main button
5. Screen
6. Crop button
7. Inner case
8. Carton

1. packing list

- Printer
- Data line
- Label box
- Guide for use

1. Product parameters:

Printing method: no ink printing (thermal)

Resolution: 203dpi

Interface: Bluetooth /spp

Cutter: manual

Print width: 12mm

Printing speed: up to 15mm per second

Screen size: 1.8 inch monochrome backlight LCD

Number of buttons: 51 full keyboard

Machine size:

Weight: 230g

Battery: 2516MWh

Standby time: about 3 months

Life time: 5 rolls of paper continuously printed

Charging interface: type-c 5v

Label paper specifications:

Smart tray

Twenty optional patterns (late update, on-demand)

Label length: 6 meters

Label width: 15mm

Label specifications: three anti-labels (waterproof, oil-proof, scratch-resistant)

Second, the operation method

1, label tape installation

- a. Remove the back cover, pull the hook and remove the battery cover
- b. The front section of the label tape is exposed during installation
- c. Rotate the label tape with your fingers and pull the front section back to the knife edge
- d. Cover the back cover



2, function key introduction

Key Description:

Power button: Tap to turn on, long press to turn off

Print button: print

Arrow keys: move

Symbol key: switch symbol input

Chinese / English key: switch input mode (English, pinyin, strokes)

Number keys: 0-9, digital input, or pinyin / stroke selection

Letter keys: AZ, English input, pinyin input, stroke input (qwerty: one)

Delete key: delete / return

Enter key: confirm / carriage return

Space bar: enter a space, select the corresponding candidate word input Chinese characters (pinyin, stroke input)

Shift key: Click to switch letters to input capitalization

Set button: Reference file 1

Template key: select template border

Bluetooth button: enter Bluetooth mode

Combination key description (shift key + function key):

Shift key + up and down keys: switch folder

Shift key + delete key: delete all

3, the body operation method

Instructions:



1. power button (power)

Short press the power button to turn it on, long press the power button to turn it off.

No operation within 3 minutes, it will automatically shut down

In Bluetooth mode, there is no printing operation for 10 minutes, it will automatically shut down.

2. Press the "Chinese/English" button repeatedly to switch the input mode.

3 input modes:

English input

Pinyin input

Stroke input



Press "Shift" to switch between upper and lower case

3. Pinyin, stroke input

When you input the corresponding pinyin or stroke, the candidate words appear below.



Press "up, down, left and right"

* Pinyin, stroke input support Lenovo, pinyin input also supports phrase input, initial input



("symbol key" as pinyin separator input)



4. "Delete" button: Function 1: Delete text, 2: Return



"Enter" key: Function 1: Enter newline, 2: Confirm

*Text supports up to 4 lines of text

5. Press the "Settings" button to enter the print settings.

Individual settings for each line of text

Text size range: extra large, large, medium, small, extra small
Font type: black body, Song body, Microsoft ya black, scorpion body, doll body, girl body,
etc.

Font orientation: horizontal and vertical

Word spacing

Can set the frame, length, alignment, etc.

6. Template

//not yet

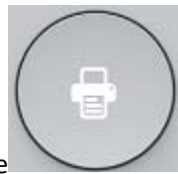

7. Print, press the "Print" button to print

8. Bluetooth mode



Press the "Bluetooth icon" button to enter the Bluetooth mode, the app controls printing and upgrades.

Button description supplement:

Letter key: az, English input, pinyin input (need to press the conversion button to convert)

Number keys: 0-9, digital input, stroke input (number is not available when stroke input)



+ Number keys: You can quickly enter the symbol corresponding to each number (ie the blue part).

Chapter III : app operation method (fixed frequency software and software description)

1、What configuration does the phone need to install the Seabird sticker printer app?

a. Android phone system requires Android 4.3 and above.

b. iPhone system requires iOS 9.0 and above.

2.app download

a. Browser open URL download: <http://pay-me.cn:55667/sb.apk>(not the final version)

b. Mobile phone scanning QR code download:



二.App link (only supports Bluetooth links)

Technical parameters of radio transmission

Sticker printer

Device type: 2.4GHz/Bluetooth device

Equipment model: seabird p1-12a seabird p1-12b

Main function: Bluetooth communication

Modulation method: gfsk, $\pi/4$ DQPSK, 8DPSK



Frequency range: 2400-2483.5mhz

Occupied bandwidth: ≤ 2 MHz

Transmitting power: ≤ 6 dBm

Operation method:

1、 How do I pair a sticker printer with an app?

- a. Short press the power button to open the sticker printer, press the  button → open "Bluetooth". The corresponding Bluetooth name will be displayed on the screen: for example: seabirdxxx
- b. Open the app page → → click on the virtual tag machine " " and find the corresponding Bluetooth link.

≡.App instructions (code display)

1. Blank template editing

1. Click on "Blank Label" to enter the edit page



2. Click on " " to "Add text, icon, QR code, time stamp, image" element

3. Click on the horizontal and vertical button to adjust the horizontal and vertical orientation of the paper.

4. Click on the length and width button to set the length and width of the printer.



5. Click on Save to save the settings to the history.



6Click . to print the label paper

2. Scene template use

App preset scenes are: name paste garbage classification household storage (electric plug) kitchen food documents books office management medical labels.

1. Name post scene

Click on the name of the app to enter the interface, click on the small classmate to enter, you can edit the label paper, click on the template at the bottom left, and select the name to paste the multiple templates for editing.

3. Cloud tag use

Click the cloud tab and select the video uploaded or uploaded by “Upload Video/Shooting/Select from Mobile”, it will automatically generate QR code, input text, save, and click to print.

Kitchen food

Click on the kitchen food to enter, select the kitchen classification required, enter the food seasoning logo, click on the template to edit, enter the selectable icon, text, etc. After editing, click Save and click Print.

Chapter IV: Product application scenario

Name posted:

Sort by style, from simple to complex, divided into several styles, name, class, phone.

Once the name is entered, it can be synced to other templates with names.

Other subdivision label template selections are retained in the editing interface.

Garbage classification:

Generate spam prompt tags by editing keywords

Enter as a style template, click on a template and edit the keyword to generate the relevant spam prompt text.

Such as editing "computer" system automatic production" can recycle garbage.

Household storage (electrical plug)

Electrical plug remote control switch logo, children's toy logo, clothing shoe logo, cleaning equipment logo, cosmetic toiletries logo, green plant perimeter fence security logo.

Kitchen food

Food seasoning label, operation prompt label, kitchen utensils classification label
, alcohol and beverage labels (labels should emphasize shelf life)

Document office management

Badge label prohibition reminder label

Confidential label electrical switch label file data file label office equipment label

Commercial label

Fabric label style label switch label price label

Material Labels Sequin Labels Food Labels Cake Labels Seasoning Labels Ornament Labels Design Labels

Medical label

Ordinary household label, laboratory label, instrument identification, chemical identification

Industrial label

Logistics warehouse, building construction, workshop identification, power communication,

Fun and good mood

Hand account, diy jewelry, clothes decoration, holiday gift decoration, personalized decoration, key distinguishing logo. mood story

Chapter V Warranty Card / Certificate (Quality Manual)

First, the principle of warranty service

1. Free repair for products that meet warranty and warranty coverage
2. A warranty card is required to request warranty service
3. Repair service outside the warranty period or not covered by the warranty, charged according to the standard
4. Non-company authorized maintenance personnel to disassemble the product, its warranty is invalid
5. The repair equipment must be packaged in the original packaging or with protective packaging measures. Damage due to improper packaging or shipping is not covered by the warranty. The company has the right to charge customers for the additional repair costs incurred.
6. The company will provide guarantee services for the products in accordance with the provisions of this article, and will not be liable for any direct or indirect losses caused by product failure.

Second, the scope and duration of the warranty

The warranty is limited to failures due to poor materials or manufacturing processes.

Warranty period is calculated from the date of purchase

Machine warranty

Printer (except printhead): one year warranty

Print head: four months or cumulative print length of 30km, first to meet the warranty period

note:

The print head compresses consumables and consumables during normal use, causing friction and natural wear and tear.

The quality of the consumables and the environment in which they are used directly affect the life of the printhead and can even damage the printhead.

The print head needs to be cleaned and maintained on a regular basis. Improper maintenance can also cause physical damage to the printhead, and any physical damage to the printhead (including but not limited to scratches, cracks, breaks, discoloration, etc.) is not covered by the warranty.

Third, the following conditions are not covered by the warranty

1. No warranty card

2. Damage due to negligence or improper operation, damage
3. Damage due to water in the printer or foreign matter
4. Print head damage due to inferior consumables
5. Damage due to the use of the environment (including but not limited to earthquakes, fires, floods, etc.)
6. Use the printer for other purposes beyond its scope of use
7. Machine damage caused by non-certified engineer repairs
8. Wear in the normal range

FCC Warning Statement

Changes or modifications not expressly approved by the party responsible for compliance could void the user's authority to operate the equipment. This equipment has been tested and found to comply with the limits for a Class B digital device, pursuant to Part 15 of the FCC Rules. These limits are designed to provide reasonable protection against harmful interference in a residential installation. This equipment generates uses and can radiate radio frequency energy and, if not installed and used in accordance with the instructions, may cause harmful interference to radio communications. However, there is no guarantee that interference will not occur in a particular installation. If this equipment does cause harmful interference to radio or television reception, which can be determined by turning the equipment off and on, the user is encouraged to try to correct the interference by one or more of the following measures:

- - Reorient or relocate the receiving antenna.
- - Increase the separation between the equipment and receiver.
- - Connect the equipment into an outlet on a circuit different from that to which the receiver is connected.
- - Consult the dealer or an experienced radio/TV technician for help.

This device complies with part 15 of the FCC Rules. Operation is subject to the following two conditions: (1) This device may not cause harmful interference, and (2) this device must accept any interference received, including interference that may cause undesired operation.