

WIFI KIT

WIFI IPC Operation Manual

1. WIFI IPC Installation

Please make sure the device is intact and all the parts are ready before installation.

Note: The mounting wall should withstand at least 4 times the total weight of the wifi camera and accessories.

1.1 WIFI IPC appearance and interface

Interface for the wifi camera, refer to following figure 1-1

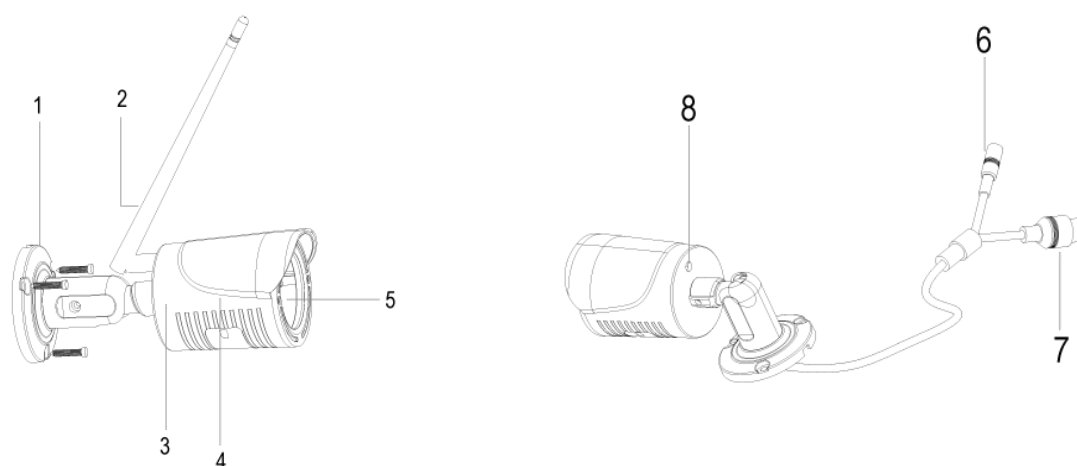

Figure 1-1 wifi camera appearance indication and interface diagram

No.	Name	Function
1	3-axis bracket	Adjust direction of the camera
2	Antenna	Transmitting & receiving wifi signal
3	Rear cover	Rear cover for housing
4	Front cover	Front cover for housing
5	Double ring glass	Prevent light leaking from lens
6	Power port	DC12V power supply
7	matching button	NVR matching
8	antenna port	Antenna port base

1.2 Installation procedure

1. Drilling mounting hole: Mark the hole position in the mounting wall, drilling 3 holes by a $\Phi 5\text{mm}$ drill, the depth of the hole is not less than 30mm, and then insert the wall plugs to the hole.
2. Fixing the wifi camera: using the PA4 screw to fix the camera base to the mounting wall. As show in figure 2-2 .

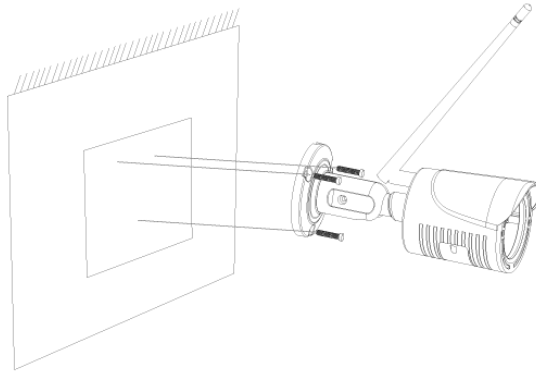

Figure 2-2 fixing the wifi camera

3. Adjust the 3-axis bracket: loosen the locking screw for the bracket and then adjust the bracket. By adjusting the shaft connection between bracket and the base to realize the direction adjustment. Horizontal (P) 0-360 degree, vertical (T) 0-90 degree, and rotating(R) 0-360 degree. Tightening the screw when it reach the appropriate scene. As show in figure 2-3.

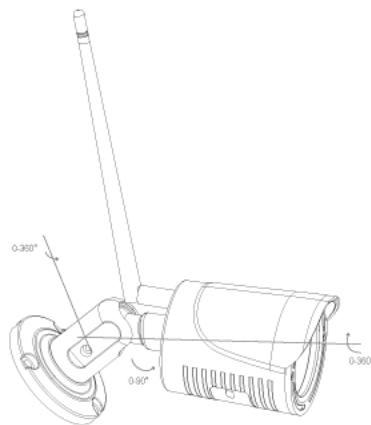

Figure 2-3 3-axis bracket adjustment

2. WIFI IPC Parameter

Item	Parameter
Image Sensor	1/2.9"
Min. Illumination	0.05Lux/F1.2(Color); 0.01Lux/F1.2(night)
Video Compression	H.264
H.264 Type	Baseline Profile/Main Profile
Lens Mount	M12
Lens	3.6mm
Day & Night	IR Cut Filter
IR LED	12 PCS SMT LED
Max. Resolution	1920 × 1280 @15fps
Shade setting	OK
Image setting	Brightness, Contrast, Saturation, Tone
Alarm	OK
Protocols	Proprietary protocol
Wireless Standards	IEEE 802.11b/g/n, 802.3,802.3n
Frequency Range	2.4 GHz to 2.4835 GHz
Channel Bandwidth	20 MHz
Transfer Rates	11b: 11 Mbps, 11g: 54 Mbps, 11n: 20 Mbps
Security	WEP, TKIP, AES, WPA, WPA2
Power supply	DC12V 1A,Max: 6W
Operating Conditions	-10℃~50℃, 30%~80%RH
Ingress Protection	IP66
Material	Metal
Dimensions	165 (L) × 66 (W) × 66 (H) (no RF wire)
Weight	<350g

FCC Statement

This equipment has been tested and found to comply with the limits for a Class B digital device, pursuant to part 15 of the FCC rules. These limits are designed to provide reasonable protection against harmful interference in a residential installation. This equipment generates, uses and can radiate radio frequency energy and, if not installed and used in accordance with the instructions, may cause harmful interference to radio communications. However, there is no guarantee that interference will not occur in a particular installation. If this equipment does cause harmful interference to radio or television reception, which can be determined by turning the equipment off and on, the user is encouraged to try to correct the interference by one or more of the following measures:

- Reorient or relocate the receiving antenna.
- Increase the separation between the equipment and receiver.
- Connect the equipment into an outlet on a circuit different from that to which the receiver is connected.
- Consult the dealer or an experienced radio/TV technician for help.

To assure continued compliance, any changes or modifications not expressly approved by the party.

Responsible for compliance could void the user's authority to operate this equipment. (Example- use only shielded interface cables when connecting to computer or peripheral devices).

This equipment complies with Part 15 of the FCC Rules. Operation is subject to the following two conditions:

- (1) This device may not cause harmful interference, and
- (2) This device must accept any interference received, including interference that may cause undesired operation.

FCC Radiation Exposure Statement:

The equipment complies with FCC Radiation exposure limits set forth for uncontrolled environment. This equipment should be installed and operated with minimum distance 20cm between the radiator and your body.

Any Changes or modifications not expressly approved by the party responsible for compliance could void the user's authority to operate the equipment.