

## 警告(Warning):

本产品含有小零件请勿让三岁以下儿童玩耍；本品含电子元件，不得入水或在潮湿环境下使用；电池充电器应定期检查其电线、插头、外壳和其他部件是否损坏，发现损坏时应停止使用。

Choking hazard! This product contains small parts. NOT suitable for children under 3 years. Contains electrical components and should be kept dry at all times. Regularly check the battery charger wires, plugs and shell and other components for damage. DO NOT use if any part is damaged.

## 注意事项 (Caution proceeding)

- 1.可拆卸的小零件要放好，千万不可让小孩吞食。
- 2.如操作场地有电波干扰，请另选场地操作。
- 3.遥控器电源低电时，请立即停止操作。
- 4.对拆除后的包装物，请不要随地丢弃，以免污染环境。
- 5.请将您的遥控模型存放在干燥、阴凉的地方。
- 6.不要置于近火和高温、潮湿的地方储存。
- 7.当电池被水浸湿，请将水分充分地擦拭干净，如有变形，请停止使用。

1. Detachable small parts should be stored safely and out of reach of children.
2. If interference is experienced, turn the model off and try it again in a different area.
3. Remote control will not function correctly if the batteries are low. Please replace the batteries.
4. Please discard old/used batteries in a safe manner. Consider your environment!
5. Please store the remote control in cool, dry place.
6. DO NOT expose to fire or high temperatures, moist storage.
7. Should the battery get wet, wipe immediately with a soft dry cloth.  
If transformed, please stop usage.

### 电池使用注意事项(Battery use caution proceeding)

- 1、车体使用一组 Li-Po 3.7V 可充电电池组；
- 2、遥控器使用2节1.5V “AA” 号电池；
- 3、安装或更换电池时请注意极性；
- 4、充电电池只能在成人监护下充电；
- 5、不可混用新旧或不同型号的电池；
- 6、电池电量用尽后，应从模型内取出；
- 7、接线端不应短路；
- 8、非充电电池不可充电；
- 9、充电电池充电前应从模型中取出；
- 10、请不要将坏的电池、电池组分解或扔到火中、水里，以免发生意外；
- 11、充电器的额定输入电压必须与当地的家用电压相符；
- 12、在充电过程中，充电器和电池出现微温，属于正常现象。

1. Bodywork uses a set of Li-Po 3.7V rechargeable batteries.
2. Remote control uses 2x 1.5V 'AA' batteries.
3. Please pay attention to correct polarity when replacing batteries.
4. Rechargeable batteries should be charged under adult supervision.
5. DO NOT use a mix of old and new or different types of battery.
6. After the battery is exhausted, the model should be removed.
7. DO NOT short circuit any terminals.
8. DO NOT attempt to recharge non rechargeable batteries.
9. Remove batteries from the model when recharging.
10. DO NOT put batteries into a fire or into water.
11. The rated input voltage battery charger MUST be suitable for your mains power voltage.
12. During charging it is quite normal for the charger and batteries to heat up.



FCC ID:2ATA9YEL99008

This device complies with Part 15 of the FCC Rules. Operation is subject to the following two conditions:

- (1) this device may not cause harmful interference, and
- (2) this device must accept any interference received, including interference that may cause undesired operation.

**Warning:** Changes or modifications to this unit not expressly approved by the party responsible for compliance could void the user's authority to operate the equipment.

**NOTE:** This equipment has been tested and found to comply with the limits for a Class B digital device, pursuant to Part 15 of the FCC Rules. These limits are designed to provide reasonable protection against harmful interference in a residential installation. This equipment generates, uses and can radiate radio frequency energy and, if not installed and used in accordance with the instructions, may cause harmful interference to radio communications.

However, there is no guarantee that interference will not occur in a particular installation. If this equipment does cause harmful interference to radio or television reception, which can be determined by turning the equipment off and on, the user is encouraged to try to correct the interference by one or more of the following measures:

- Reorient or relocate the receiving antenna.
- Increase the separation between the equipment and receiver.
- Connect the equipment into an outlet on a circuit different from that to which the receiver is connected.
- Consult the dealer or an experienced radio/TV technician for help.

## ⚠ WARNING

There are small parts inside possibly causing a choking hazard, so the product isn't suitable for children 3 years old and below. When the product is being used, an adult must be on the scene for guardianship and guidance. These instructions have important information and thus shouldn't be discarded randomly. They should be kept properly for future inquiry.

8+



# UNIVERSAL DRIFT WHEEL TWISTING SPRAY CAR

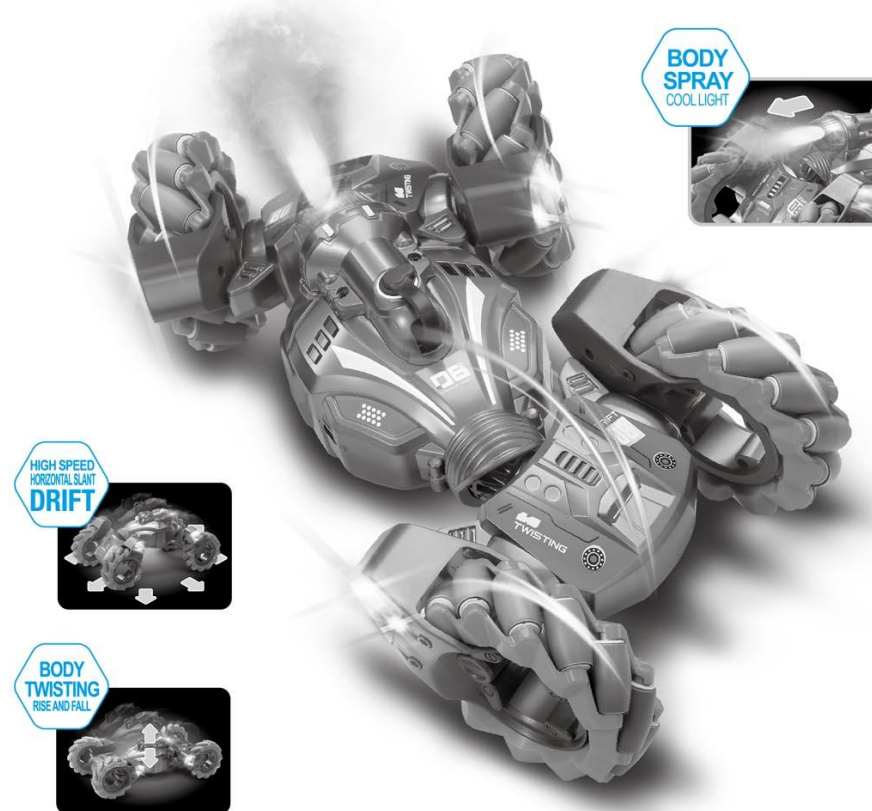

BODY  
SPRAY  
COOL LIGHT

HIGH SPEED  
HORIZONTAL SLANT  
DRIFT

BODY  
TWISTING  
RISE AND FALL

Move forward, move backward, turn left, turn right, body rise and fall, Body twisting, rotate at 360°, horizontal drifting, dance, sound, spray, cool light.

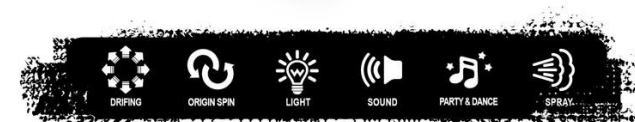

### <SAFETY PRECAUTIONS>

- It is a radio control model, not a toy!
- In order to enjoy running the car, you need to finish assembly before operation. Do routine maintenance work after operation. Replacement parts and option parts are available separately.
- Improper usage with Alkaline cells or rechargeable batteries may damage the electronics for the car or the radio.

### <IN ORDER TO OPERATE THE CAR SAFELY, BE SURE THAT YOU HAVE OBSERVED THE FOLLOWING POINTS:>

#### **WARNING!**

Please follow the points as below in order to prevent accident from happening to the car and people.



- Be sure to read thoroughly the manual before you begin. Fresh user should seek advice from people having rich experience in order to assemble the model correctly.



- Never reverse connection / disassemble the battery. This may lead to damage and leakage.



- As the product contains small and sharp parts, assemble and store this product only in places out of the reach of children.



- Do not operate the model on public roads, in crowded places and near infant as it may cause accidents.

#### **WARNING!**

Please follow the following steps to operate, in order to prevent hurt to your body or damage of material property.



- Cutters, nippers and screwdrivers need careful handling.

- When the model is not in use, always turn off the receiver and transmitter. Further more, disconnect the batteries and remove them from the model and the transmitter. This may be dangerous such as overheat and leakage.

- Do not expose this model to high temperature, humidity or direct sunlight.

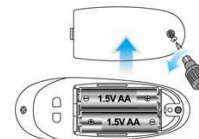
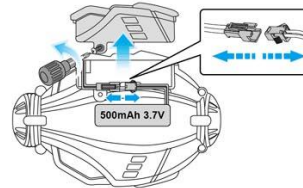

One handed remote controller

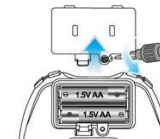

Two handed remote controller



## OPERATING YOUR MODEL SAFELY



### WARNING!

Do NOT operate the model in the following places and situations.  
(Non-observance may lead to accident!)

- Operate your model in spacious areas ONLY with few people around! Do not operate it:

1. On road!
2. In places where children and many people gather!
3. In residential districts and parks!
4. Indoors and in limited space! Non-observance may result in personal injury and property damage!

- The car must stop immediately and check for the reasons when it is operating abnormal.

As long as the problem is not cleared, do NOT operate it! This may lead to further trouble and unforeseen accidents!

- Always check the radio batteries!

With weak dry batteries, transmission and reception of the radio would fall off. You may lose control of your model in such condition. This may also cause serious accidents!!



- Keep in mind that people around you may also operate a radio control model!

NEVER share the same frequency with somebody else at the same time! Otherwise, Radio signals will be mixed up and you will lose control to your model. This may lead to accidents.



### WARNING!

In order to avoid accidents and personal injury, be sure that you have observe the following points:

- The safety of battery:

1. Exhaust battery should be safely dispose!
2. Non rechargeable batteries are not to be recharged, there is danger of explosion!
3. Do not throw the of battery into a fire! There is danger of explosion!
4. Do not swallow battery!
5. Store only in cool, dry and dark places and should be keep out of the children!
6. When the battery leaks the liquid and let it into you eyes, please right away rinse them and consult an ophthalmologist.

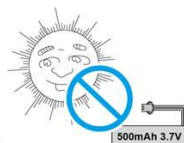

PROHIBITED

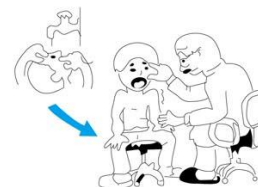

- Do NOT put fingers or any objects inside rotating and moving parts!
- Right after use, do NOT touch the motor! Danger of burning yourself!



### WARNING!

Changes or modifications to this unit not expressly approved by the party responsible for compliance could void the user's authority to operate the equipment.



### NOTE:

This equipment has been tested and found to comply with the limits for a Class B digital device, pursuant to Part 15 of the FCC Rules. These limits are designed to provide reasonable protection against harmful interference in a residential installation. This equipment generates, uses and can radiate radio frequency energy and, if not installed and used in accordance with the instructions, may cause harmful interference to radio communications.

However, there is no guarantee that interference will not occur in a particular installation. If this equipment does cause harmful interference to radio or television reception, which can be determined by turning the equipment off and on, the user is encouraged to try to correct the interference by one or more of the following measures:

- ☐ Reorient or relocate the receiving antenna.
- ☐ Increase the separation between the equipment and receiver.
- ☐ Connect the equipment into an outlet on a circuit different from that to which the receiver is connected.
- ☐ Consult the dealer or an experienced radio/TV technician for help.
- ☐ This device complies with Part 15 of the FCC Rules.

Operation is subject to the following two conditions:

- (1) this device may not cause harmful interference, and
- (2) this device must accept any interference received, including interference that may cause undesired operation.

## Contents

### Included the following parts

■ Body (To the actual product)

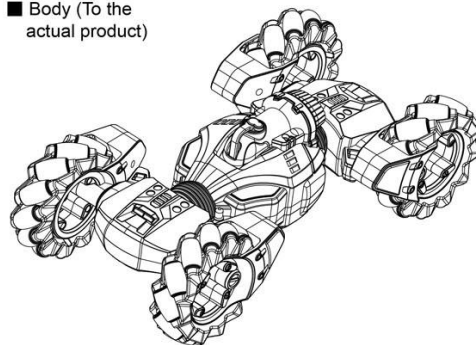

■ Transmitter

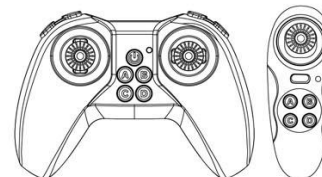

■ Instruction manual



■ 7.4V 1400 mAh Large power Li-Po battery

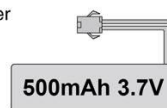

■ USB Charge line



■ Screwdriver



## About the Radio

1. Frequency description: Turn the power switch of the remote control car to the "ON" position, the power will be switched on, and the operation indicator light of the remote controller will be off, which means that the frequency pairing is completed.
2. Accept the machine plug schematic.

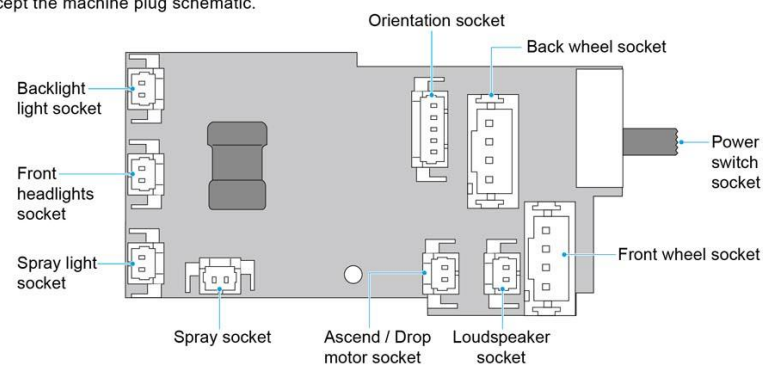

## Description of functions of remote controller

### One handed remote controller function description



### Two handed remote controller function description

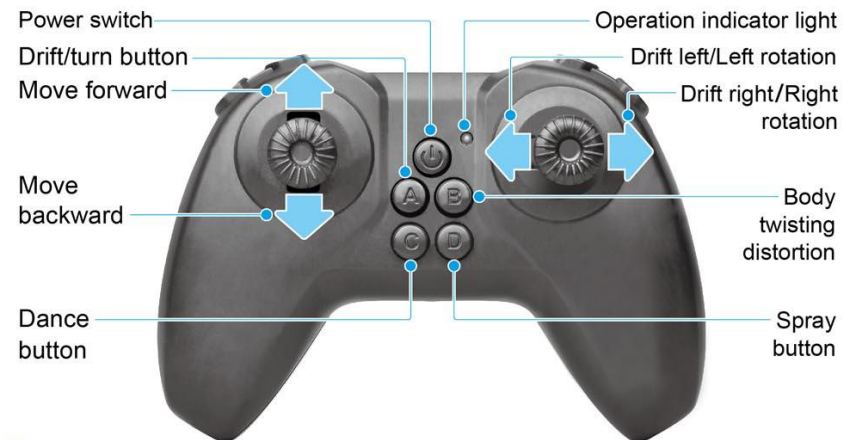

### Note:

The two remote controllers are optional, and the actual color box shall prevail.

## Assembly of the transmitter battery

The remote control unit is equipped with two 1.5V AA non-rechargeable batteries (Battery need additional purchase).

- Loosen the screws on the battery door with cross screwdrivers.  
(Phillips screwdriver need additional purchase)
- Load the new 1.5V AA batteries corresponding the "+" and "-" in the battery case to the "+" and "-" of the batteries.
- Cover up the battery cover, and tighten the screws.

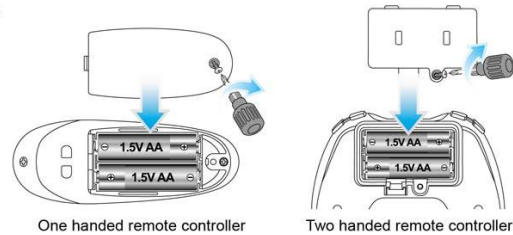

## Model battery's charging and assembly

- Take out the rechargeable battery from the product as shown in the diagram. (Phillips screwdriver need additional purchase)

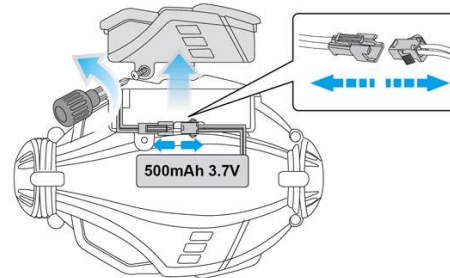

- Plug the USB into the computer's USB interface, and then plug the lithium battery into the charge port of the USB, when the red indicator light for charging in the USB will be long on. A full charge will take about 90 minutes. After a full charge, the red indicator light will be off, and the product will be used 5 minutes later. Overcharging may damage the batteries, cause burnings or catch a fire.

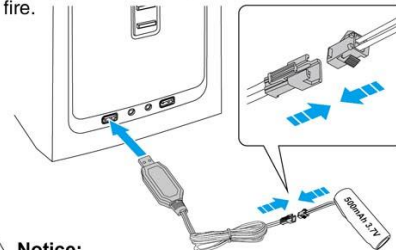

### Notice:

When the product is idle, please push its power switch to "OFF", and take out the batteries in case the service life of the rechargeable batteries is affected.

- Load the battery pack in the battery case by corresponding to the correct electrodes, and cover up the battery cover. (Phillips screwdriver need additional purchase)

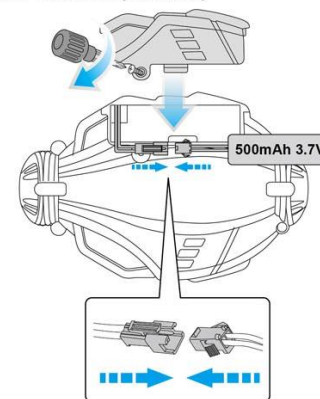

## R/C Car assembly diagram

LS0002 2.6x8mm Screw 8

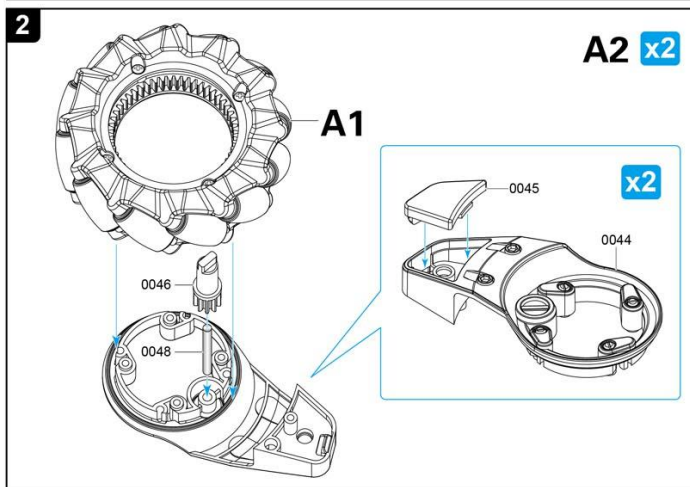
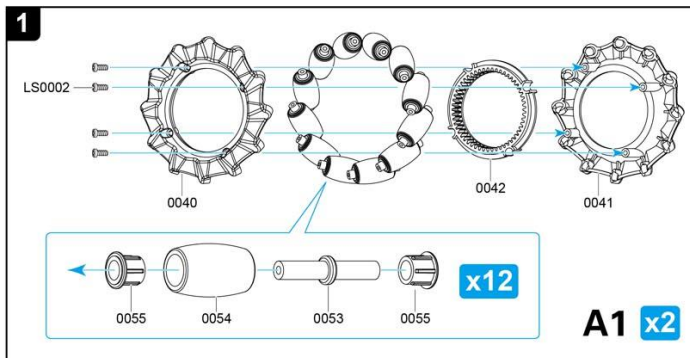

LS0002 2.6x8mm Screw 10

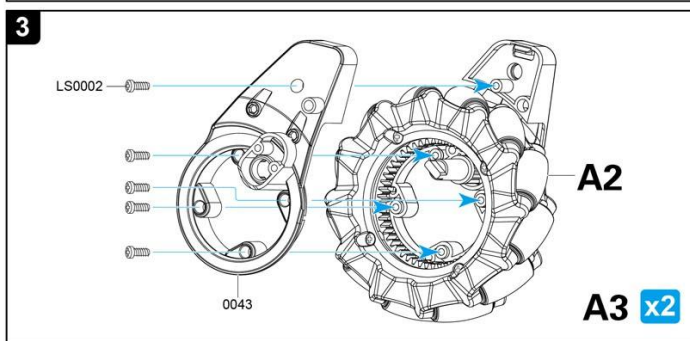



LS0002 2.6x8mm  
Screw

4

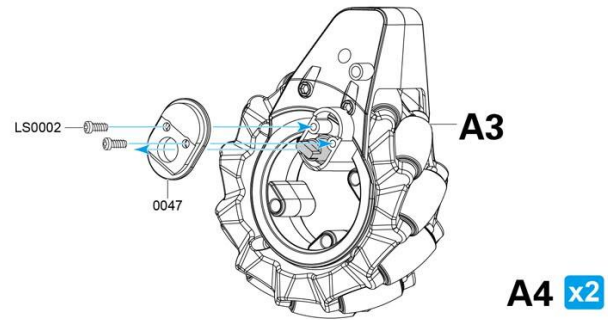

LS0002 2.6x8mm  
Screw

5

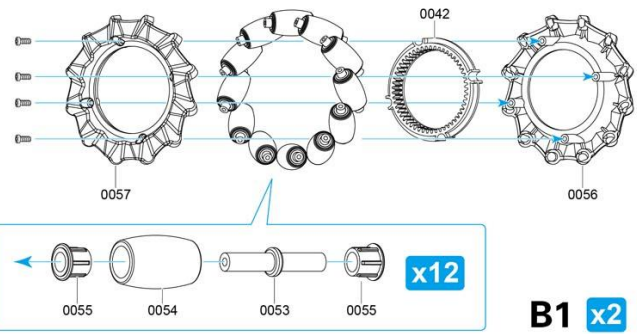

6

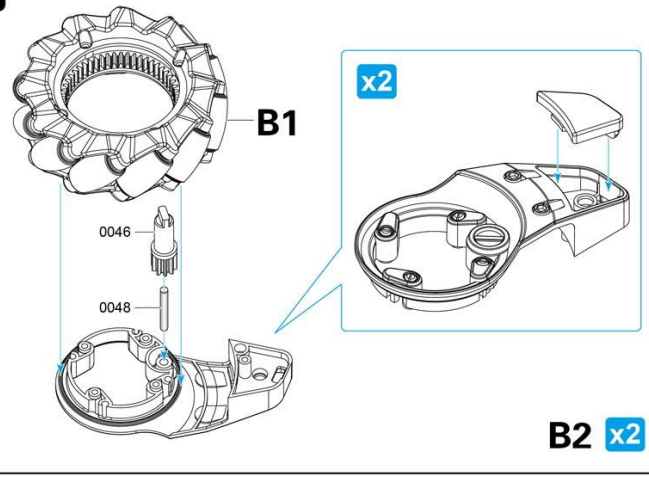

LS0002 2.6x8mm Screw 10

7

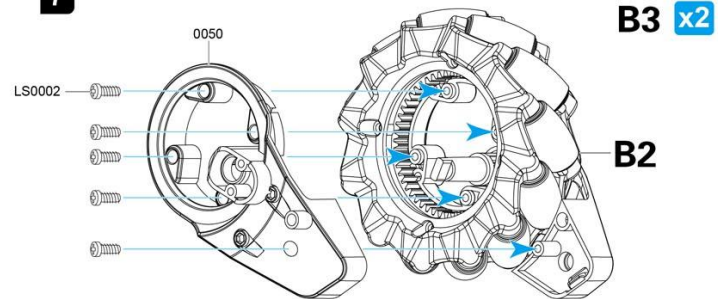

LS0002 2.6x8mm Screw 8

8

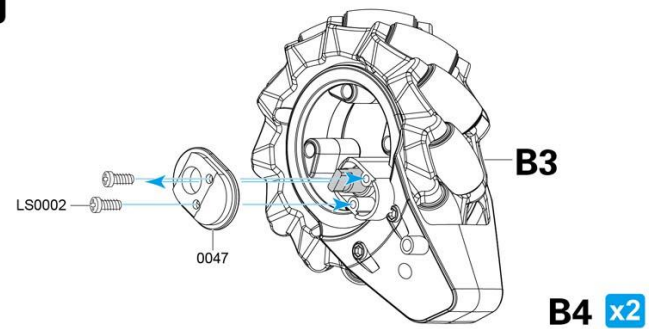

9

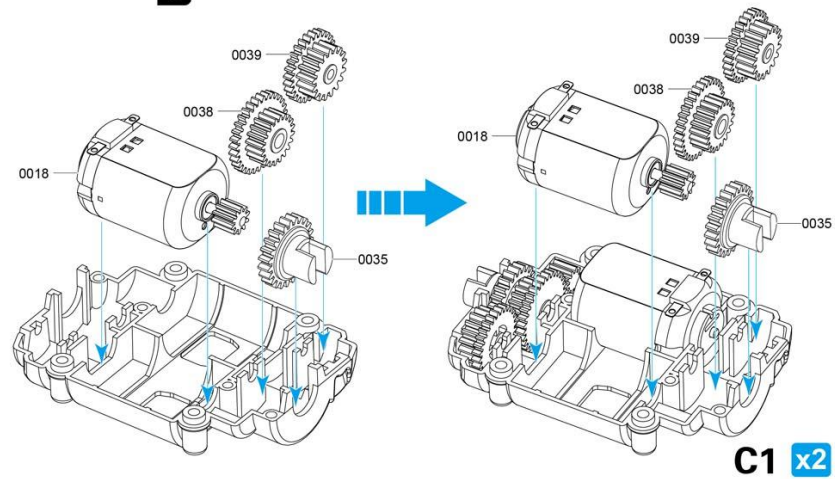

- LS0001 2.3x6mm  
Screw
- LS0002 2.6x8mm  
Screw

10

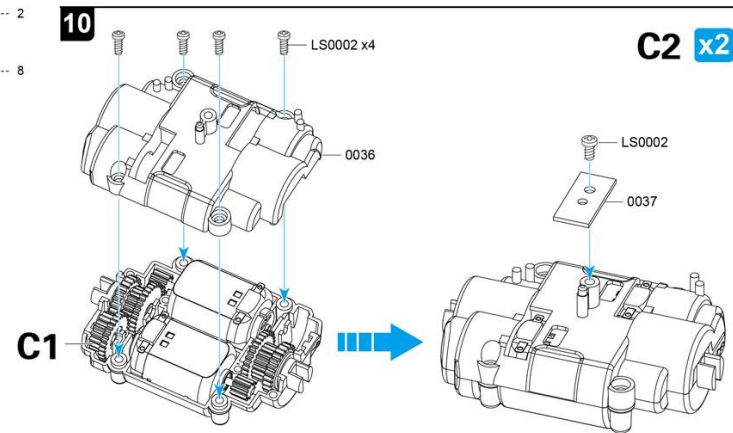

- LS0002 2.6x8mm  
Screw

11

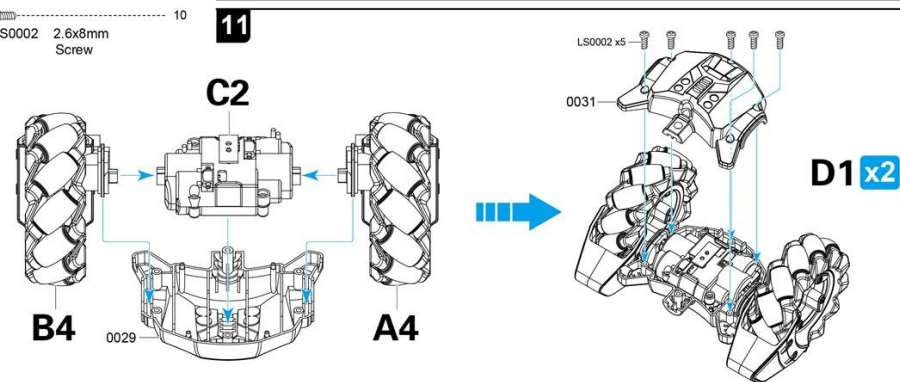

- LS0002 2.6x8mm  
Screw

12

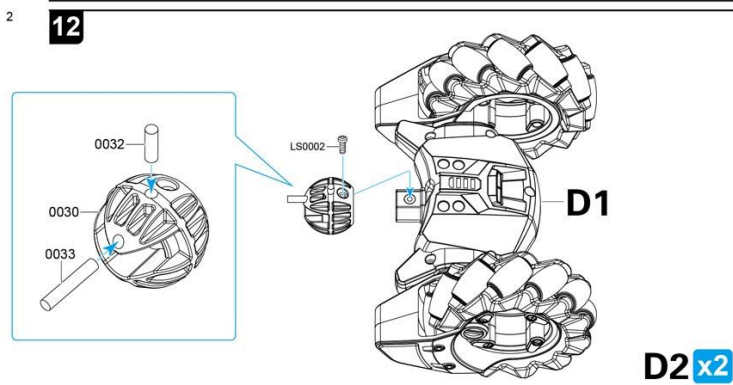

LS0002 2.6x8mm  
Screw

13

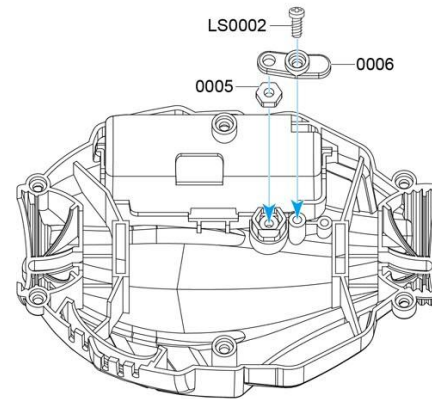

LS0002 2.6x8mm  
Screw

14

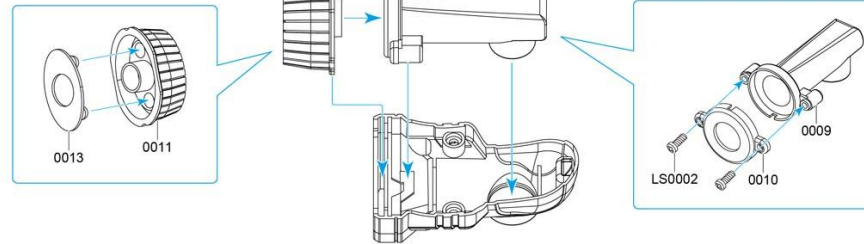

LS0002 2.6x8mm  
Screw

15

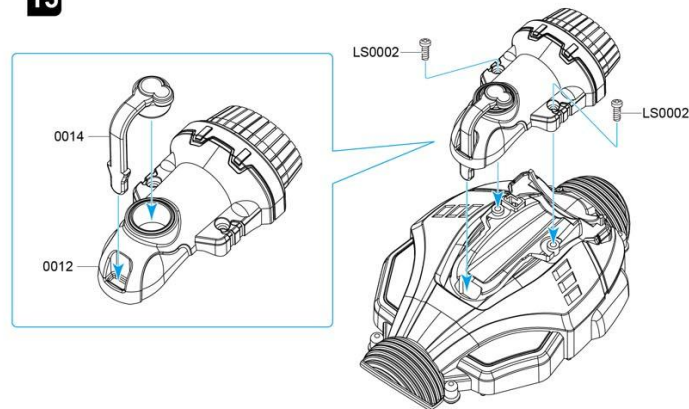



LS0002 2.6x8mm  
Screw

16

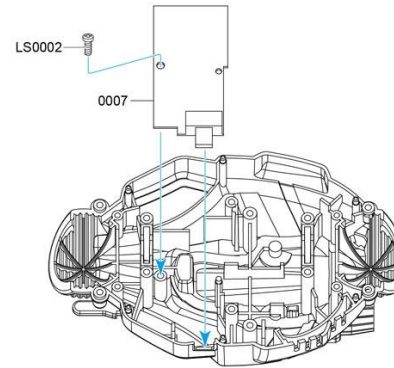

17

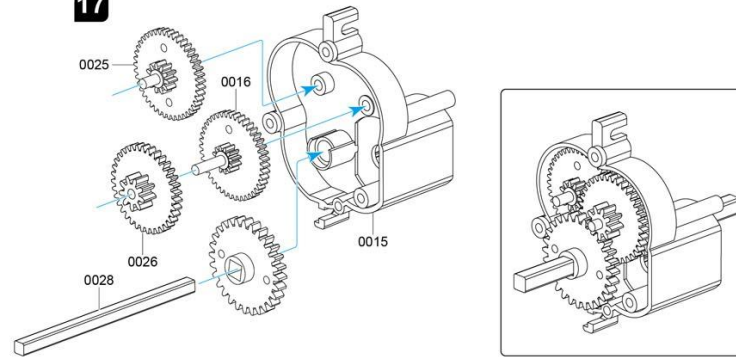

LS0002 2.6x8mm  
Screw

18

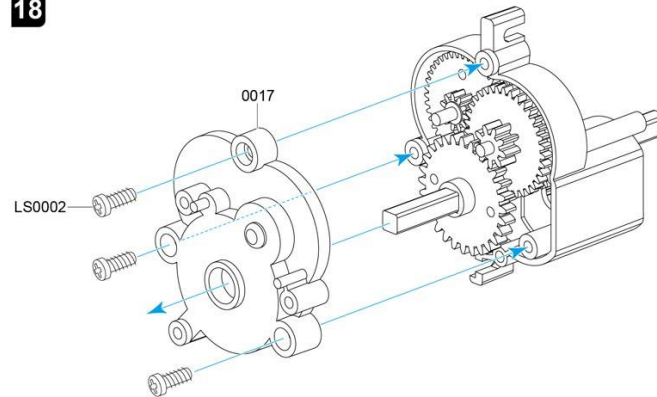

LS0002 2.6x8mm  
Screw

19

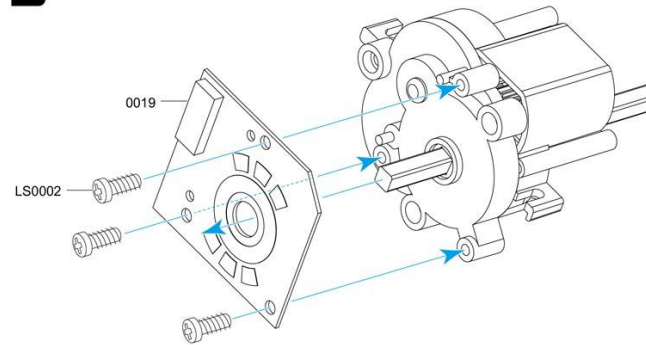

LS0002 2.6x8mm  
Screw

20

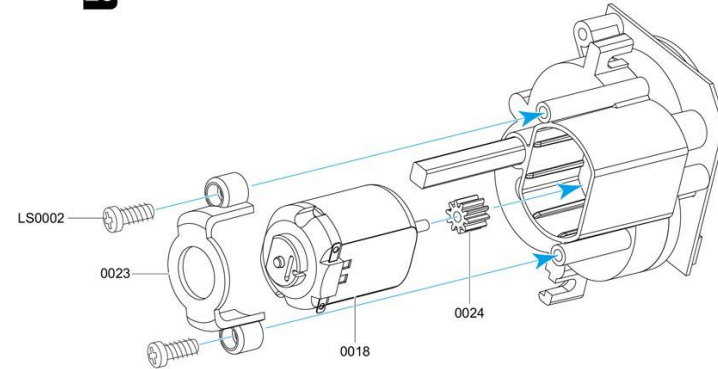

21

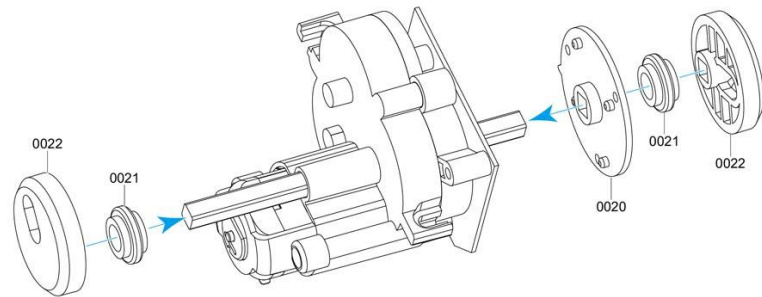

LS0002 2.6x8mm  
Screw

22

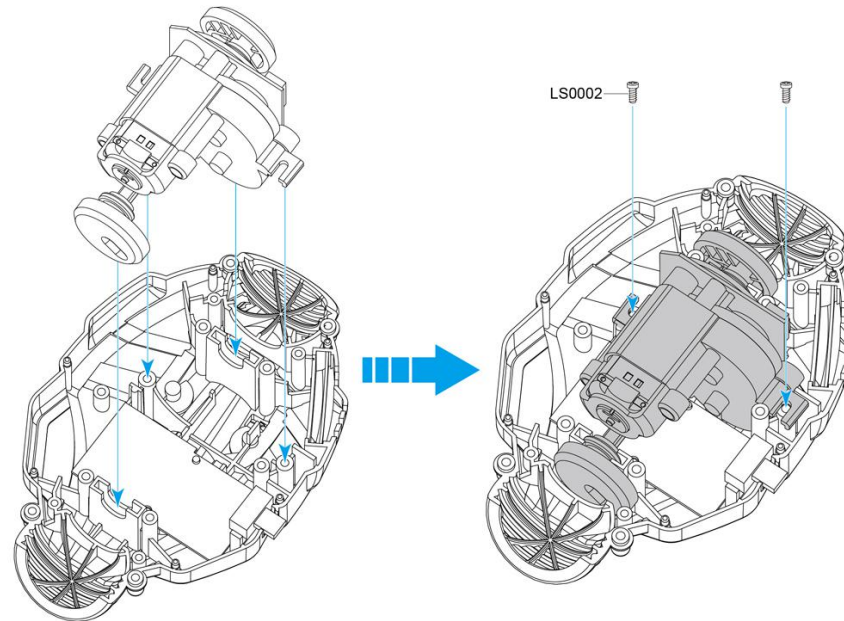

23

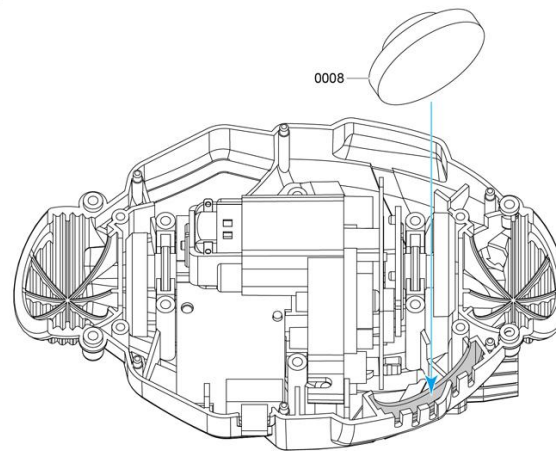

24

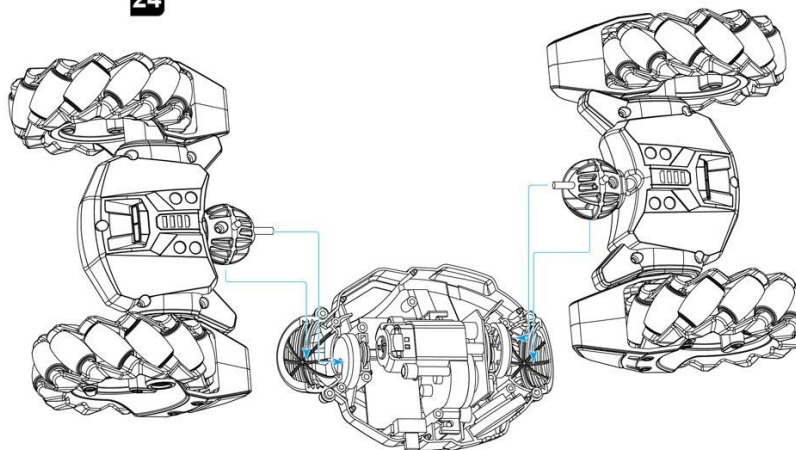

LS0002 2.6x8mm Screw

25

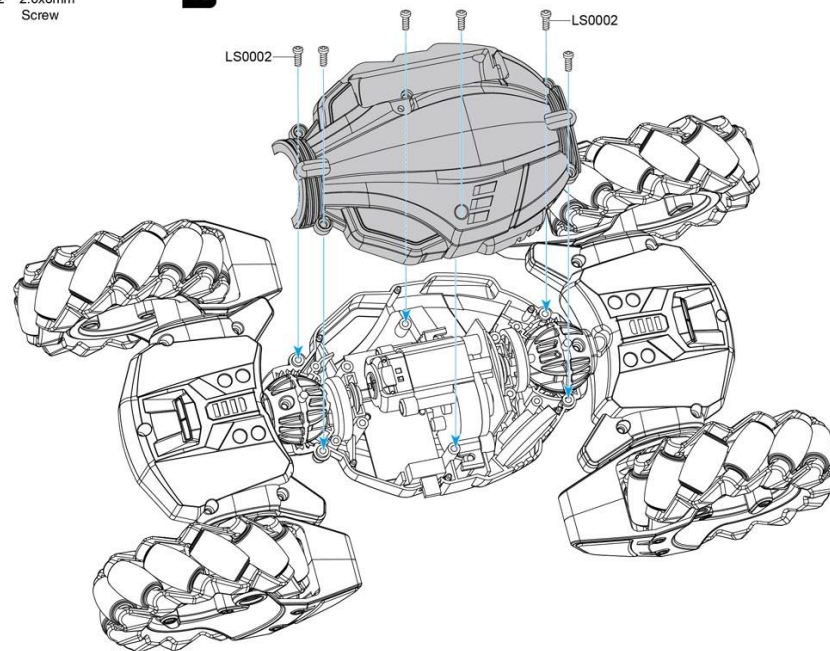



LS0003 2.3x6mm  
Screw

26

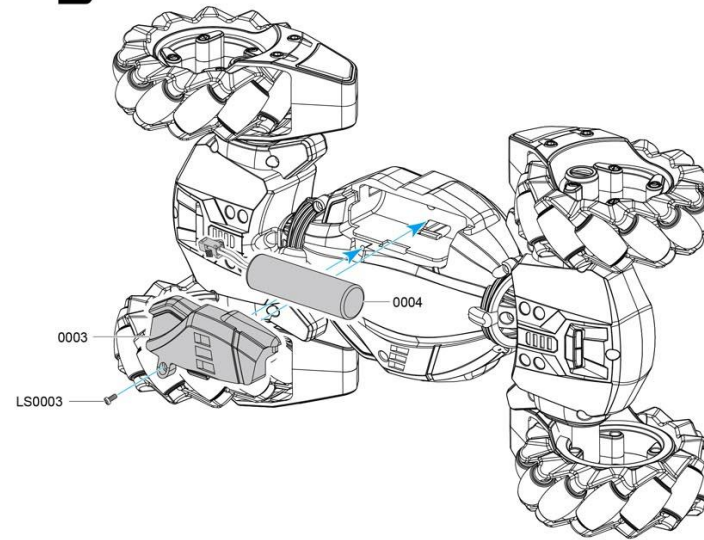

27

