

## USER GUIDE:

### 1. Open the phone holder

Set this product face up and open up the phone holder to 90 degrees from the side of the product. Stretch upwards, the holder supports 360-degree rotation.

### 2. Bluetooth pairing

Take the remote controller out of the product, press its button for 3 seconds till the blue light flashes to show that the bluetooth is working, then set your phone to pair up with the bluetooth "YMP", when pairing successful, the blue light will be on all the time press the remote controller button for another 3 seconds to shut the blue-tooth down.

### 3. Fix the phone

Rotate the phone holder till you can pull open the holder handle and fix the phone steadily with it

### 4. Photograph

Open your camera App and set it ready for photographing, and then you can use the remote controller to take photos freely.

### 5. Use the tripod

This product brings with a tripod, open the bottom cover and pull out the tripod, then fix it on a flat surface, then you can start to enjoy your photographing easily.

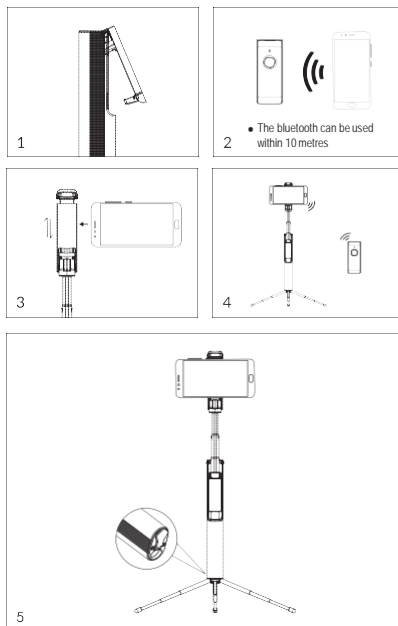

## FCC Warning

This device complies with part 15 of the FCC Rules. Operation is subject to the following two conditions: (1) This device may not cause harmful interference, and (2) this device must accept any interference received, including interference that may cause undesired operation.

Any Changes or modifications not expressly approved by the party responsible for compliance could void the user's authority to operate the equipment.

Note: This equipment has been tested and found to comply with the limits for a Class B digital device, pursuant to part 15 of the FCC Rules. These limits are designed to provide reasonable protection against harmful interference in a residential installation. This equipment generates uses and can radiate radio frequency energy and, if not installed and used in accordance with the instructions, may cause harmful interference to radio communications. However, there is no guarantee that interference will not occur in a particular installation. If this equipment does cause harmful interference to radio or television reception, which can be determined by turning the equipment off and on, the user is encouraged to try to correct the interference by one or more of the following measures:

- Reorient or relocate the receiving antenna.
- Increase the separation between the equipment and receiver.
- Connect the equipment into an outlet on a circuit different from that to which the receiver is connected.
- Consult the dealer or an experienced radio/TV technician for help.

The device has been evaluated to meet general RF exposure requirement. The device can be used in portable exposure condition without restriction.