

USER GUIDE:

1. Adjust and extend the stick length you want.

2. Fix the phone on the bracket.

360 degrees rotatable phone holder +210 degrees head with adjustable handle which let you select horizontal or vertical camera mode freely.

3. Bluetooth Pairing

Press the remote shutter button for 3 seconds until the blue light flashes to enter standby mode; turn on the phone Bluetooth to select the "YMP" and connect. The blue light will always be on and not flashing if the Bluetooth connection is successful.

4. Take Photos & Videos

Open the phone camera App, press the remote camera shutter to start taking photos & Videos.

5. Use the tripod

This product comes with a tripod. Open the bottom cover and pull out the tripod; start photographing when it is fixed on a flat place.

6. Electric parameter

Rated voltage: DC3.7V (lithium battery), DC5V (charge)

Operating voltage range: 3.3-4.2V

Bluetooth core specification version: 4.2

FCC ID: 2AT7S-YMP-M05

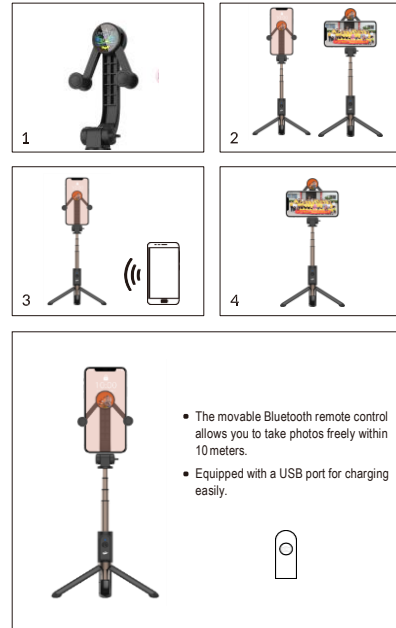

FCC Statement

This device complies with part 15 of the FCC rules. Operation is subject to the following two conditions: (1) this device may not cause harmful interference, and (2) this device must accept any interference received, including interference that may cause undesired operation.

Changes or modifications not expressly approved by the party responsible for compliance could void the user's authority to operate the equipment.

NOTE: This equipment has been tested and found to comply with the limits for a Class B digital device, pursuant to part 15 of the FCC Rules. These limits are designed to provide reasonable protection against harmful interference in a residential installation. This equipment generates uses and can radiate radio frequency energy and, if not installed and used in accordance with the instructions, may cause harmful interference to radio communications. However, there is no guarantee that interference will not occur in a particular installation. If this equipment does cause harmful interference to radio or television reception, which can be determined by turning the equipment off and on, the user is encouraged to try to correct the interference by one or more of the following measures:

- Reorient or relocate the receiving antenna.
- Increase the separation between the equipment and receiver.
- Connect the equipment into an outlet on a circuit different from that to which the receiver is connected.
- Consult the dealer or an experienced radio/TV technician for help.

The device has been evaluated to meet general RF exposure requirement. The device can be used in portable exposure condition without restriction.