



LUNATM 4 body (gen 2)

T-SONICTM MASSAGING BODY BRUSH



ONLINE MANUAL

FULL USER MANUAL

GETTING STARTED

Congratulations on acquiring your new LUNA™ 4 body (gen 2) & joining millions worldwide who believe in smarter selfcare. Before you start enjoying your new life with sophisticated skincare technology & professional results in the comfort of your home, please take a few moments to carefully read this manual. Welcome to the future of skincare.

Please READ ALL INSTRUCTIONS BEFORE USE and utilize this product only for its intended use as described in this manual.



WARNING: NO MODIFICATION OF THIS EQUIPMENT IS ALLOWED.

LUNA™ 4 body (gen 2) OVERVIEW

Meet LUNA™ 4 body (gen 2) - your travel-friendly massaging body brush. A gentle, T-Sonic™-powered skin care device visibly softens, smooths & firms as you indulge in a profoundly purifying full body spa. The highly adaptable, ultra- hygienic silicone brush head respects your individual curves - flexing inwards like a sponge - to accommodate all various bodily contours.

The ultra-hygienic plush silicone effortlessly glides across the skin with no pulling or stretching & combines with 8 manually adjustable T-Sonic™ pulsation intensities for a perfectly tailored cleanse in seconds. Remove 99.5% of impurities, lift away dirt, dead skin cells, sweat & grime in just 1 minute & gently exfoliate to prep for enhanced lotion absorption.

An ergonomic bacteria-resistant body is lightweight & compact, USB rechargeable, with a practical travel lock feature and an elegant & durable leather strap for easy storage. No compromises, just clean! Never miss a spot again and enjoy fresh, glowing & flawless skin, every day.

GETTING TO KNOW LUNA™ 4 body (gen 2)

T-SONIC™ PULSATIONS

8 adjustable T-Sonic™ intensities gently remove impurities & dead skin cells, enhancing absorption of lotions

ADAPTABLE BRUSH HEAD

Easily adapts to your body contours so you'll never miss a spot again

EXTRA SOFT & ULTRA-HYGIENIC SILICONE

35x more hygienic than nylon bristles and suitable for all skin types. BPA & phthalate free

SMART SWEDISH DESIGN

Fit for all skin types with no replacement brush heads required



POWER BUTTON

Short press to turn device on and off

INTENSITY BUTTONS

Easily change between 8 T-Sonic™ intensities

CHARGING PORT

Up to 300 minutes of use per charge. 100% waterproof closure

INDICATOR LIGHT

Flashes to indicate when device needs to be charged



USB CABLE

Charge anytime, anywhere

UNLOCK YOUR DEVICE

LUNA™ 4 body (gen 2) is locked when first unboxed – unlock it by holding down the + and - buttons together for 3 seconds. The light will flash to indicate your device is unlocked. Should you wish to lock your device for travel convenience, follow the same procedure.

HOW TO USE LUNA™ 4 body (gen 2)

1. Apply shower gel or soap to your body as usual.
2. Wet the device, and press the universal button to turn it on.
3. Press power button to turn on the device and press the +/- buttons to select your preferred cleansing intensity.
4. Press the universal button to turn off your device. It will automatically turn off after 3 minutes. Finish by rinsing your body.
5. Rinse your device and leave it to air dry.



CLEANING YOUR LUNA™ 4 body (gen 2)

Always clean LUNA™ 4 body (gen 2) thoroughly after use. Wash the brush surface with water and soap, then rinse with warm water. Avoid using clay-based, silicone-based or grainy cleansers, exfoliators or scrubs, as they may damage the device's soft silicone touchpoints. Pat dry with a lint-free cloth or towel. After use, we recommend spraying the device with FOREO Silicone Cleaning Spray and rinsing with warm water for optimal results.

NOTE: Never use cleaning products containing alcohol, petrol, or acetone, as they may irritate the skin and damage the silicone.

IMPORTANT FOR OPTIMUM SAFETY:

- If you have a skin condition or any medical concerns, please consult a dermatologist before use.
- Cleansing with LUNA™ 4 body (gen 2) should be comfortable – if you experience discomfort, discontinue use immediately and consult a physician.
- For reasons of hygiene, we do not recommend sharing your LUNA™ 4 body (gen 2) with anyone else.
- Avoid leaving your LUNA™ 4 body (gen 2) in direct sunlight and never expose it to extreme heat or boiling water.
- Close supervision is necessary when this device is used by, on, or near children and those with reduced physical and mental abilities.
- Discontinue use if this product appears damaged in any way. This product contains no serviceable parts.
- Use this device only for its intended use as described in this manual. If you do not find the answer to your specific question, or if you have any other questions regarding the device's operation, please visit www.foreo.com

TROUBLESHOOTING

PRECAUTIONS TO BE TAKEN IN THE EVENT OF CHANGES IN THE PERFORMANCE OF LUNA™ 4

body (gen 2). If LUNA™ 4 body (gen 2) is not activated when pressing the center button:

- Battery is dead, Recharge using USB charging cable for up to 2 hours until fully charged, and then restart your device by holding down the power button.

If LUNA™ 4 body (gen 2) cannot be switched off and/or interface buttons do not respond:

- Microprocessor is temporarily malfunctioning. Press and hold power button to restart the device.

WARRANTY TERMS & CONDITIONS

REGISTER WARRANTY

To activate your 2-Year Limited Warranty register through the FOREO app, or visit foreo.com/product-registration for more information.

2-YEAR LIMITED WARRANTY

FOREO warrants this device for a period of TWO (2) YEARS (except in countries where national law requires longer minimum guarantee) after the original date of purchase against defects due to faulty workmanship or materials arising from normal use of the device. The warranty covers working parts that affect the function of the device. It does NOT cover cosmetic deterioration caused by fair wear and tear, or damage caused by accident, misuse, or neglect. Any attempt to open or take apart the device (or its accessories) will void the warranty.

If you discover a defect and notify FOREO during the warranty period, FOREO will, at its discretion, replace the device free of charge. Claims under warranty must be supported by reasonable evidence that the date of the claim is within the warranty period. To validate your warranty, please keep your original purchase receipt together with these warranty conditions for the duration of the warranty period.

To claim your warranty, you must log in to your account at www.foreo.com and select the option to make a warranty claim. Shipping costs are nonrefundable. This undertaking is in addition to your statutory rights as a consumer and does not affect those rights in any way.

DISPOSAL INFORMATION

Disposal of old electronic equipment (applicable in the EU and other European countries with separate waste collection systems).



The crossed-out dustbin symbol indicates that this device should not be treated as household waste, but rather be brought to the appropriate collection point for recycling of electrical and electronic equipment. By ensuring this device is disposed of correctly, you will help prevent the potential negative consequences for the environment and human health which could be caused by inappropriate waste handling of the product. The recycling of materials will also help conserve natural resources.

For more information about the recycling of your device, please contact your local household waste disposal service or your place of purchase.

BATTERY REMOVAL

NOTE: This process is not reversible. Opening the device will void its warranty. This action must only be undertaken when the device is ready to be disposed of.

Because this device contains a lithium-ion battery, the battery must be removed before disposal and should not be thrown away with household waste. To remove the battery, open the inner plastic shell after removing silicone outer layer and remove the battery to be disposed of in accordance with your local environmental regulations. Wear gloves during this process for your safety. Detailed visual instructions are provided below:

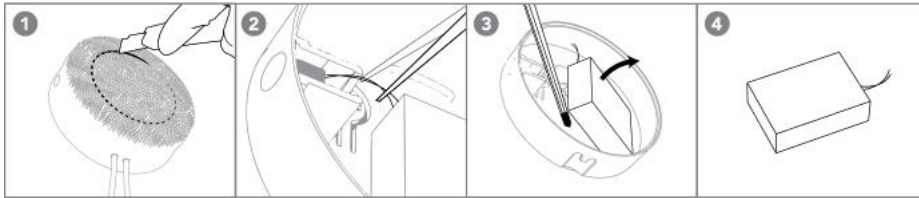

SPECIFICATIONS

MATERIALS: Body-safe silicone & ABS plastic

COLOR: Lavender, Apricot, Evergreen

SIZE: 79.5*78*37mm

WEIGHT: 89g

BATTERY: Li-ion 520mAh 3.7V

USAGE: Up to 300 minutes

STANDBY: 90 days

FREQUENCY: 100 Hz

MAX NOISE LEVEL: <50dB

INTERFACE: 3-button

DISCLAIMER: Users of this device do so at their own risk. Neither FOREO nor its retailers assume any responsibility or liability for any injuries or damages, physical or otherwise, resulting, directly or indirectly, from the use of this device. Further, FOREO reserves the right to revise this publication and to make changes from time to time in the contents thereof without obligation to notify any person of such revision or changes.

Any changes or modifications not expressly approved by the party responsible for compliance could void the user's authority to operate the equipment. This device complies with part 15 of the FCC Rules. Operation is subject to the following two conditions: (1) This device may not cause harmful interference, and (2) this device must accept any interference received, including interference that may cause undesired operation.

This device contains licence-exempt transmitter(s)/receiver(s) that comply with Innovation, Science and Economic Development Canada's licence-exempt RSS(s). Operation is subject to the following two conditions:

- (1) This device may not cause interference.
- (2) This device must accept any interference, including interference that may cause undesired operation of the device.

l'appareil contient des émetteurs/récepteurs exempts de licence qui sont conformes aux CNR exempts de licence d'Innovation, Sciences et Développement économique Canada. L'exploitation est soumise aux deux conditions suivantes :

- (1) l'appareil ne doit pas produire de brouillage,
- (2) l'utilisateur de l'appareil doit accepter tout brouillage radioélectrique subi, même si le brouillage est susceptible d'en compromettre le fonctionnement.

FREQUENTLY ASKED QUESTIONS

BASICS

1. WHAT SHOULD I DO AFTER I RECEIVE MY LUNA™ 4 body (gen 2) DEVICE?
Congratulations on discovering smarter skincare! First things first - download the FOREO For You app for free to register your device.
2. WHAT COMES WITH MY LUNA™ 4 body (gen 2) DEVICE?
1 LUNA™ 4 body (gen 2) Device, 1 USB Charging Cable, 1 User Manual.
3. HOW DO I TURN MY LUNA™ 4 body (gen 2) DEVICE ON AND OFF?
Press the power button on your LUNA™ 4 body device to turn it on, and hold it for 3 seconds to turn off the device.
4. MY DEVICE IS NOT ACTIVATED WHEN PRESSING THE POWER BUTTON?
The battery is dead. Recharge using a USB charging cable until fully charged and then restart your device by holding down the power button.
5. HOW DO I CHARGE MY LUNA™ 4 body (gen 2)?
LUNA™ 4 body (gen 2) is USB-rechargeable, with a 2-hour charge delivering up to 300 minutes of use. The USB charging cable is provided with the device.
6. WHY DOESN'T MY CHARGER GO ALL THE WAY IN?
The charging cable for your LUNA™ 4 body (gen 2) is not supposed to go all the way into the device. It is completely normal for it to stick out a bit from the device.
7. IS THE CHARGING POINT ON LUNA™ 4 body (gen 2) WATERPROOF?
Yes, the charging point is waterproof which means you can safely use the device in the shower. Make sure the device is completely dry before charging and do not use it while charging. Once you are done using your device, store it in a dry area. Do not leave the device submerged in water.

USING LUNA™ 4 body (gen 2)

1. HOW OFTEN CAN I USE MY LUNA™ 4 body (gen 2) DEVICE?
LUNA™ 4 devices are safe and gentle enough to use every day, either morning or night. We recommend using your LUNA™ 4 body (gen 2) any time your skin needs a deeper cleanse.
2. CAN I SHARE MY LUNA™ body WITH OTHER PEOPLE, SUCH AS FAMILY MEMBERS?
For hygiene reasons, we do not recommend sharing your LUNA™ 4 body (gen 2) with anyone else.
3. HOW HARD SHOULD I PRESS WHEN I MOVE MY LUNA™ 4 body (gen 2)?
There is no need to use any pressure when using LUNA™ 4 body (gen 2). Gently cleanse your body using circular movements.
4. CAN I USE FOREO LUNA™ 4 body (gen 2) AROUND THE GENITAL AREA?
Yes, LUNA™ 4 body (gen 2) is completely safe to be used around the genital area.
5. WHAT KIND OF BODY WASH CAN I USE?
You can use the cleanser of your preference as long as it does not contain an ingredient that can damage the silicone of your device. Please avoid using clay-based, silicone-based or grainy cleansers, exfoliators, or scrubs, as they may damage the device's soft silicone touchpoints.

6. CAN I USE LUNA™ 4 body (gen 2) IF I HAVE SKIN CONDITIONS SUCH AS ECZEMA?

We suggest that anyone who suffers from a serious skin condition or has undergone a cosmetic procedure consults their physician or skincare professional before using the device.

7. CAN I USE MY LUNA™ 4 body (gen 2) DURING PREGNANCY?

Yes, LUNA™ 4 body (gen 2) is safe to use while pregnant or breastfeeding.

8. HOW DO I ADJUST THE INTENSITY OF THE T-SONIC™ PULSATIONS?

LUNA™ 4 body (gen 2) is designed with 8 different cleansing intensities for your selection. Simply use the plus and minus buttons to adjust your cleanse and massage, according to your preferences.

©2024 FOREO AB. ALL RIGHTS RESERVED.

EU DISTR.: FOREO AB, KARLAVÄGEN 41, 114 31 STOCKHOLM, SWEDEN.

US DISTR.: FOREO INC., 1525 E PAMA LANE, LAS VEGAS, NV 89119, USA.

AUS DISTR.: 6 PROHASKY STREET, PORT MELBOURNE, VIC, 3207 AUSTRALIA.

DESIGNED AND DEVELOPED BY FOREO SWEDEN.

MANUFACTURED FOR FOREO AB.

WWW.FOREO.COM

EN-P2-20240117